

**MAIN ROAD-NORTH
PLAN AND PROFILE**
SCALE
HORIZ. 1" = 30'
VERT. 1" = 3'

ENGINEER-SEALING
STEPHAN KONG
Exp. 06/30/2011
CIVIL
Professional No. 19548
4/22/09
For Rev. ONLY

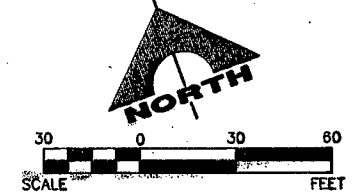

ENGINEER-SEALING
DR. HORTON
Exp. 06/30/2011
CIVIL
Professional No. 17700
DATE: 05/04/09

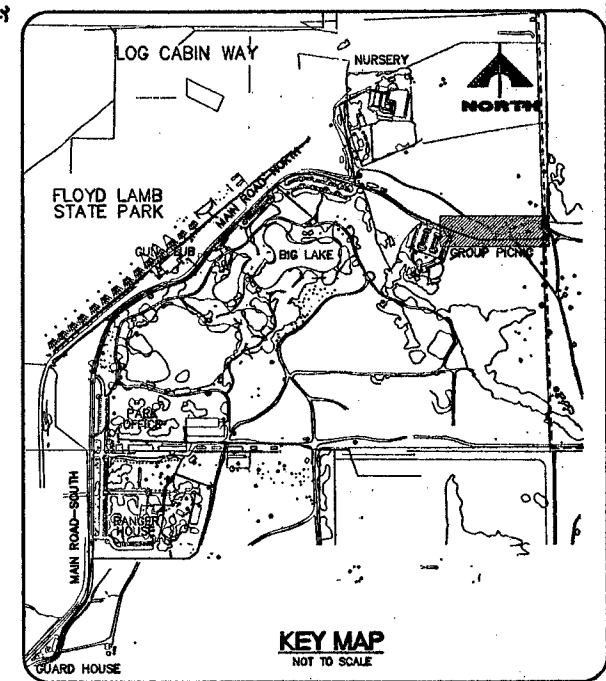

KEY MAP
NOT TO SCALE

- SEWER NOTES**
- ◆ INSTALL SEWER MAIN TRENCH SECTION BACKFILL PER CORD DWG. S016
 - ◆ INSTALL 48" SANITARY SEWER MANHOLE PER CORD DWG. S01.
 - ◆ STUB AND PLUG FOR FUTURE USE.
 - ◆ CONNECT TO EXISTING 8" PVC SEWER
 - ◆ REMOVE EXISTING MANHOLE AND SEPTIC TANK. INSTALL NEW CLEAN OUT. CONTRACTOR TO VERIFY ELEVATION OF EXISTING CONNECTION POINT PRIOR TO CONSTRUCTION
 - ◆ CONNECT TO EXISTING CLEAN OUT. CONTRACTOR TO VERIFY ELEVATION OF EXISTING CONNECTION POINT PRIOR TO CONSTRUCTION
 - ◆ STRAIGHT GRADE BETWEEN MANHOLES AT 1% MINIMUM.
 - ◆ STRAIGHT GRADE BETWEEN MANHOLE AND CLEAN OUT AT 1% MINIMUM.

SEWER CONNECTION NOTE

A SEGMENT OF THE DOWNSTREAM SEWER SYSTEM THAT WILL SERVE THIS PROJECT HAS NOT BEEN COMPLETED AND/OR ACCEPTED FOR MAINTENANCE BY THE CITY OF LAS VEGAS. ANY WORK DONE ON THIS PROJECT PRIOR TO COMPLETION AND/OR ACCEPTANCE OF THE DOWNSTREAM SEWER SYSTEM(S) SHALL BE DONE AT THE DEVELOPER'S OWN RISK. THE CITY OF LAS VEGAS RESERVES THE RIGHT TO PREVENT THE PHYSICAL CONNECTION OF THIS PROJECT INTO THE DOWNSTREAM SEWER SYSTEM UNTIL ALL SEGMENTS HAVE BEEN COMPLETED AND ACCEPTED FOR MAINTENANCE, OR UNTIL SUCH TIME AS THEY HAVE BEEN REDEEMED AVAILABLE FOR SERVICE.

ALL SEWER/STORM DRAINS CROSSING WATER LINES MUST CONFORM TO SECTION 2.19 OF THE UNIFORM DESIGN AND CONSTRUCTION STANDARDS FOR POTABLE WATER SYSTEMS (UDACS) FOR WATER AND STORM MAIN CROSSING AND CLEARANCES. ESN.064

NOTICE

G.C. WALLACE, INC. ASSUME NO RESPONSIBILITY FOR EXISTING UTILITY SHOWN OR NOT SHOWN. THE UTILITIES SHOWN ON THIS DRAWING HAVE BEEN PLOTTED FROM RECORD INFORMATION AND ARE FOR THE CONVENIENCE OF THE CONTRACTOR ONLY. IT IS THE CONTRACTOR'S RESPONSIBILITY TO FIELD VERIFY THE LOCATION AND DEPTH OF ALL RELEVANT UTILITIES PRIOR TO COMMENCEMENT OF CONSTRUCTION. IF A CONFLICT OR DISCREPANCY IS DISCOVERED, THE CONTRACTOR SHALL NOTIFY THE ENGINEER IN WRITING IMMEDIATELY.

BENCHMARK

CITY OF LAS VEGAS VERTICAL CONTROL
CITY OF LAS VEGAS BM #11V50444 1/4 CORNER, BLM 1990 D
MOCCASIN AND CIMMARON
ELEVATION: 759.8707 METERS (NAV83)
2493.01 FEET

BASIS OF BEARINGS

NORTH 00°28'28" WEST BEING THE BEARING OF THE WEST LINE OF THE NORTHWEST QUARTER (NW1/4) OF SECTION 4, TOWNSHIP 19 SOUTH, RANGE 60 EAST, M.D.M. CITY OF LAS VEGAS, CLARK COUNTY, NEVADA, AS SHOWN BY MAP THEREOF ON FILE IN FILE 105, PAGE 09 OF PARCEL MAPS IN THE CLARK COUNTY RECORDER'S OFFICE, CLARK COUNTY, NEVADA.

Avoid cutting underground utility lines. IT'S COSTLY.
Call before you Dig.
1-800-227-2600
UNDERGROUND SERVICE (USA)

Avoid hitting overhead power lines. IT'S COSTLY.
CALL BEFORE YOU DIG OVERHEAD
1-702-227-2929

Avoid hitting underground traffic signal systems and street light system conduits. IT'S COSTLY. CALL BEFORE YOU DO UNDERGROUND.
Call before you UnderGround
1-702-455-7511
CLARK COUNTY TRAFFIC OPERATIONS
1-702-229-6611
LAS VEGAS AREA COMPUTERIZED TRAFFIC SYSTEM

MATCHLINE
STA: 30+00
SEE SHEET PP3

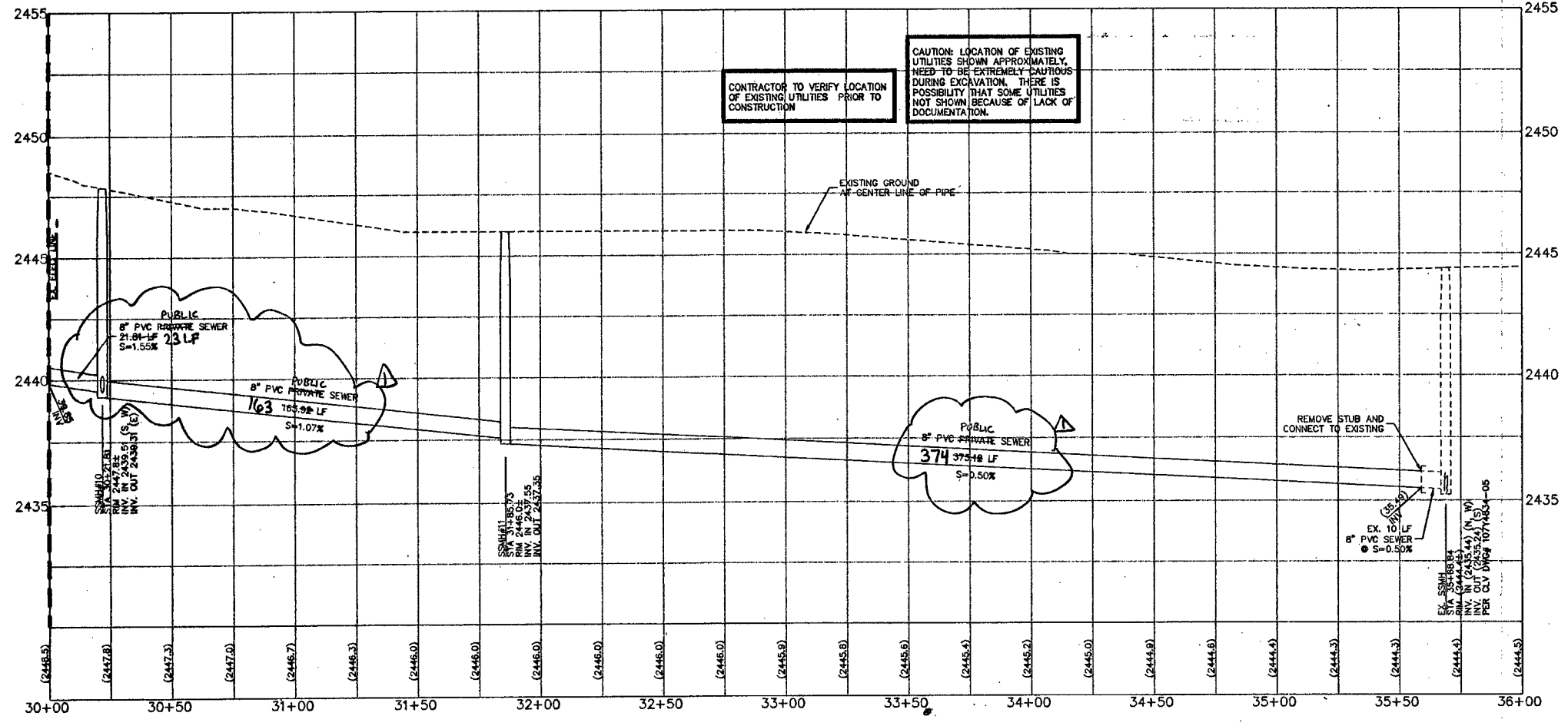

CAUTION: LOCATION OF EXISTING UTILITIES SHOWN APPROXIMATELY. NEED TO BE EXTREMELY CAUTIOUS DURING EXCAVATION. THERE IS POSSIBILITY THAT SOME UTILITIES NOT SHOWN BECAUSE OF LACK OF DOCUMENTATION.

CONTRACTOR TO VERIFY LOCATION OF EXISTING UTILITIES PRIOR TO CONSTRUCTION

REMOVE STUB AND CONNECT TO EXISTING

119688

LOG CABIN RANCH - SEWER THRU FLOYD LAMB STATE PARK
DR. HORTON, INC.
MAIN ROAD-NORTH - PLAN AND PROFILE 4 OF 4
87A, 90+00 TO STA. 96+00
RECORD DRAWINGS
DRAWING PP4
6 OF 14 SHEETS
CLV DWG# 11654
307 V 14 3