

PRIVATE STORM DRAIN (SOUTH)
STA:12+42.70 - 14+67.17
(PRIVATE)

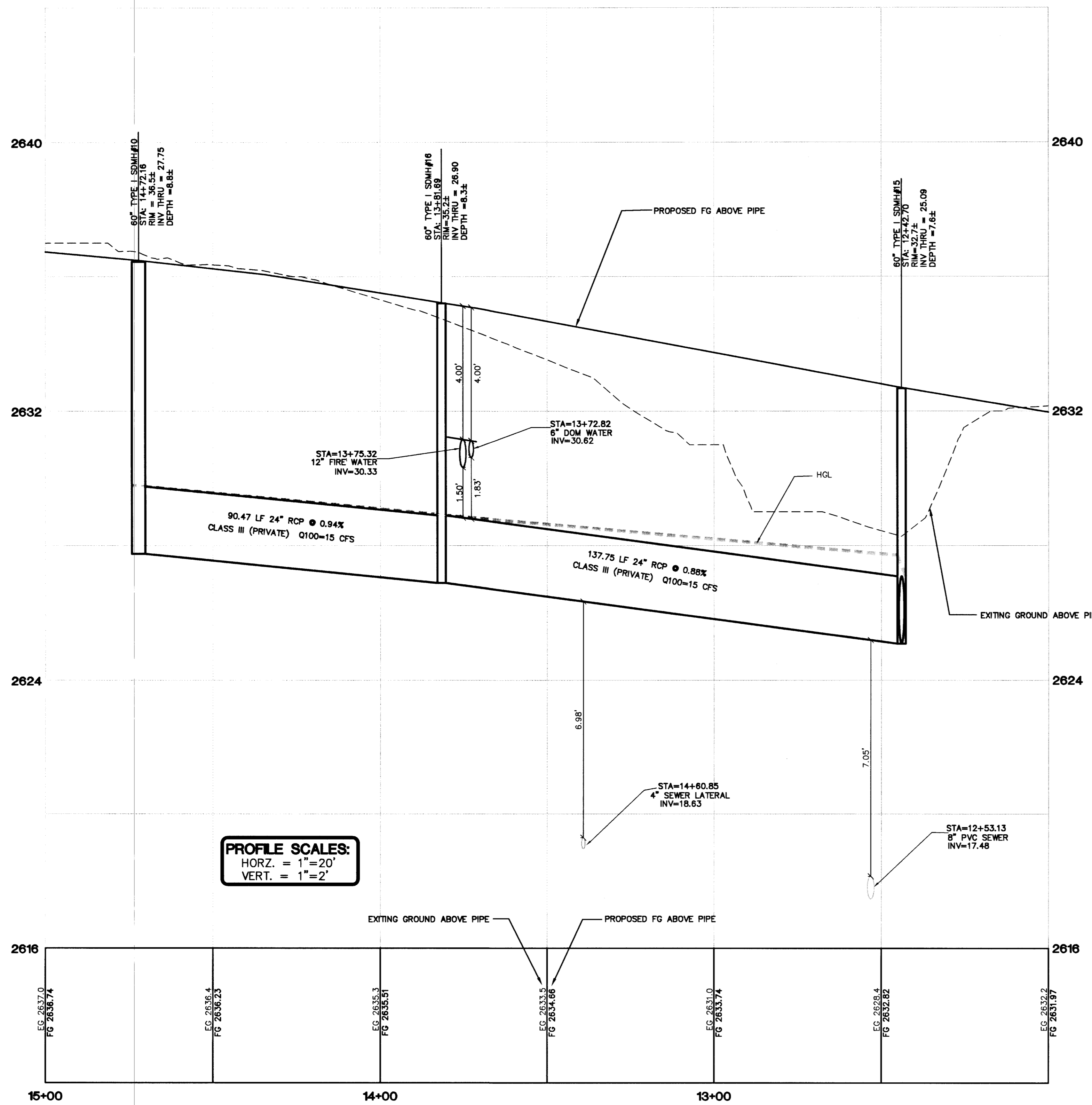

PROFILE SCALES:
 HORZ. = 1"=20'
 VERT. = 1"=2'

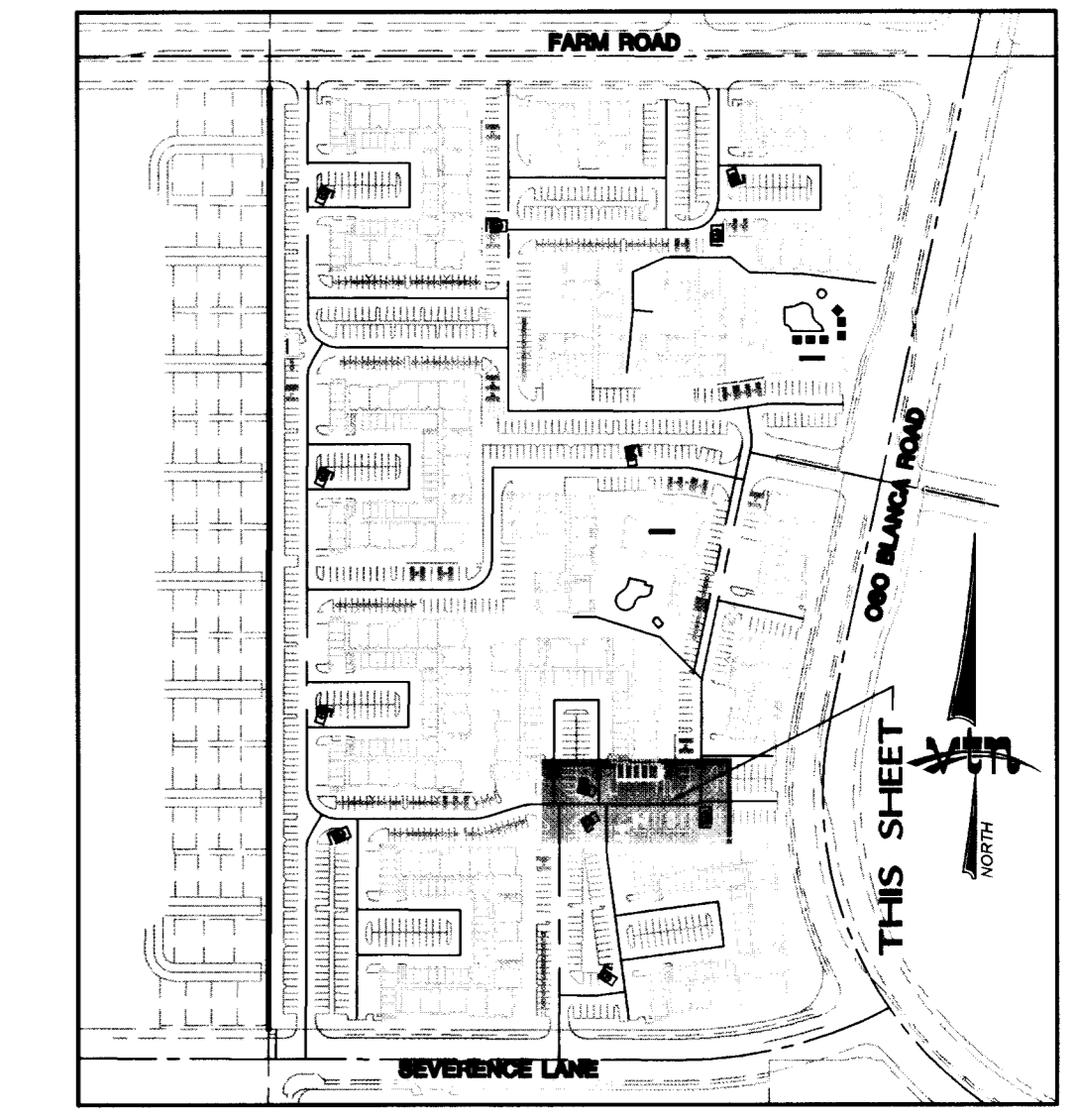
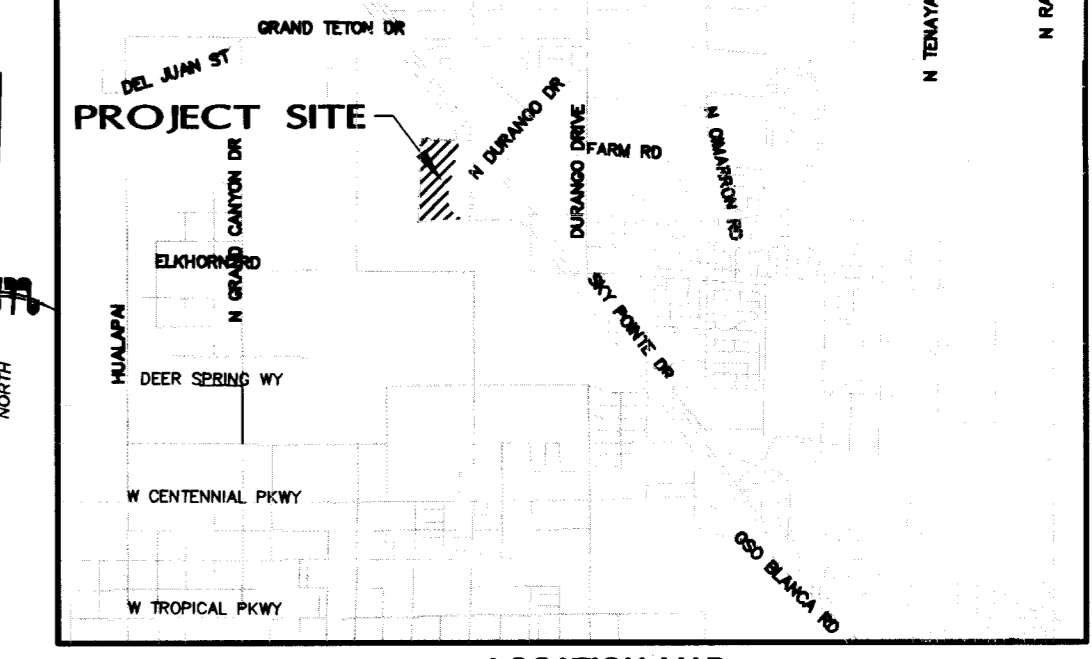
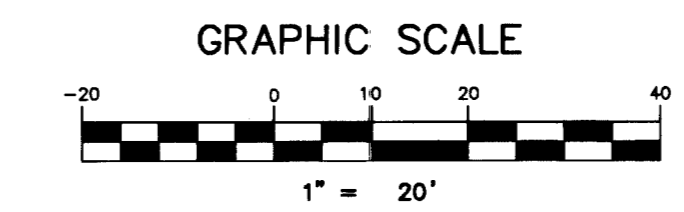

NOTE: ALL ONSITE STORM DRAINS ARE PRIVATELY OWNED AND TO BE PRIVATELY MAINTAINED BY THE HOMEOWNERS ASSOCIATION.

FLOOD ZONE NOTE
 SITE IS LOCATED IN A ZONE X AS SHOWN IN FIRM MAP 32003C1745E DATED: SEPTEMBER 27, 2002
 A ZONE X IS DETERMINED TO BE OUTSIDE THE 0.2% ANNUAL CHANCE FLOOD PLAIN.

NOTE: CONTRACTOR SHALL VERIFY HORIZONTAL AND VERTICAL LOCATION OF EXISTING UTILITIES AND NOTIFY THE DESIGN ENGINEER IMMEDIATELY OF ANY DISCREPANCIES PRIOR TO CONSTRUCTION.

DRAINAGE EASEMENT NOTE:
 ALL AREAS NOT OCCUPIED BY THE BUILDINGS MUST BE PUBLIC DRAINAGE EASEMENTS TO BE PRIVATELY MAINTAINED BY THE HOMEOWNERS ASSOCIATION.

BENCHMARK
 PROJECT DATUM: NORTH AMERICAN VERTICAL DATUM OF 1988 (NAVD88) CITY OF LAS VEGAS BENCHMARK: BLV90-17SES NAVD88 ELEVATION: 778.950 METERS (2555.61 FEET) RIVET AND PLATE IN TOP OF SOUTH END OF HEADWALL ON THE WEST SIDE OF WEST FRONTAGE RD. +/- 400 FT NORTH OF ELKHORN @ MP 89.4

BASIS OF BEARING
 NORTH 89°54'28" WEST, BEING THE BEARING OF THE NORTH LINE OF THE NORTHEAST QUARTER (NE 1/4) OF THE SOUTHWEST QUARTER (SW 1/4) OF SECTION 17, TOWNSHIP 19 SOUTH, RANGE 60 EAST, M.D.M., CITY OF LAS VEGAS, CLARK COUNTY, NEVADA, AS SHOWN ON THAT CERTAIN RECORD OF SURVEY IN FILE IN THE OFFICE OF THE COUNTY RECORDER, CLARK COUNTY, NEVADA, IN FILE 114 OF SURVEYS, AT PAGE 57.

Call before you Dig
 1-702-455-7511
 1-702-229-6611

Call before you Dig
 1-800-227-2600

Call before you Overhead
 1-702-227-2929

FAIRFIELD DEVELOPMENT, LP
 CITY OF LAS VEGAS, NEVADA
 2727 SOUTH RAINBOW BOULEVARD
 LAS VEGAS, NEVADA 89146-5148
 PH. (702) 873-7550 FAX (702) 362-2997 WEB WWW.VTNV.COM
 CONSULTING ENGINEERS • PLANNERS • LAND SURVEYORS

STORM DRAIN PLAN AND PROFILE
PRIVATE STORM DRAIN (SOUTH)
STA:12+42.70 - 14+67.17

FARM ROAD / US 95
CONDOMINIUMS

DRAWN BY: RV 4/1/07
 DESIGNED BY: DEH 4/1/07
 CHECKED BY: TBR 4/1/07
 PROJECT NO: 6622-1
 SCALE: 1"=20' HORZ. 1"=2' VERT.

PROFESSIONAL ENGINEER - STATE OF NEVADA
 DEBORAH KALEKIN-JOHNSON
 CIVIL
 NO. 14671
 EXPIRES 06-30-09

SHEET SD9
 32 OF 73 SHEETS
 DRAWING NO. 10744963