

VILLAGE 7

TOWN CENTER DRIVE

VILLAGE 1

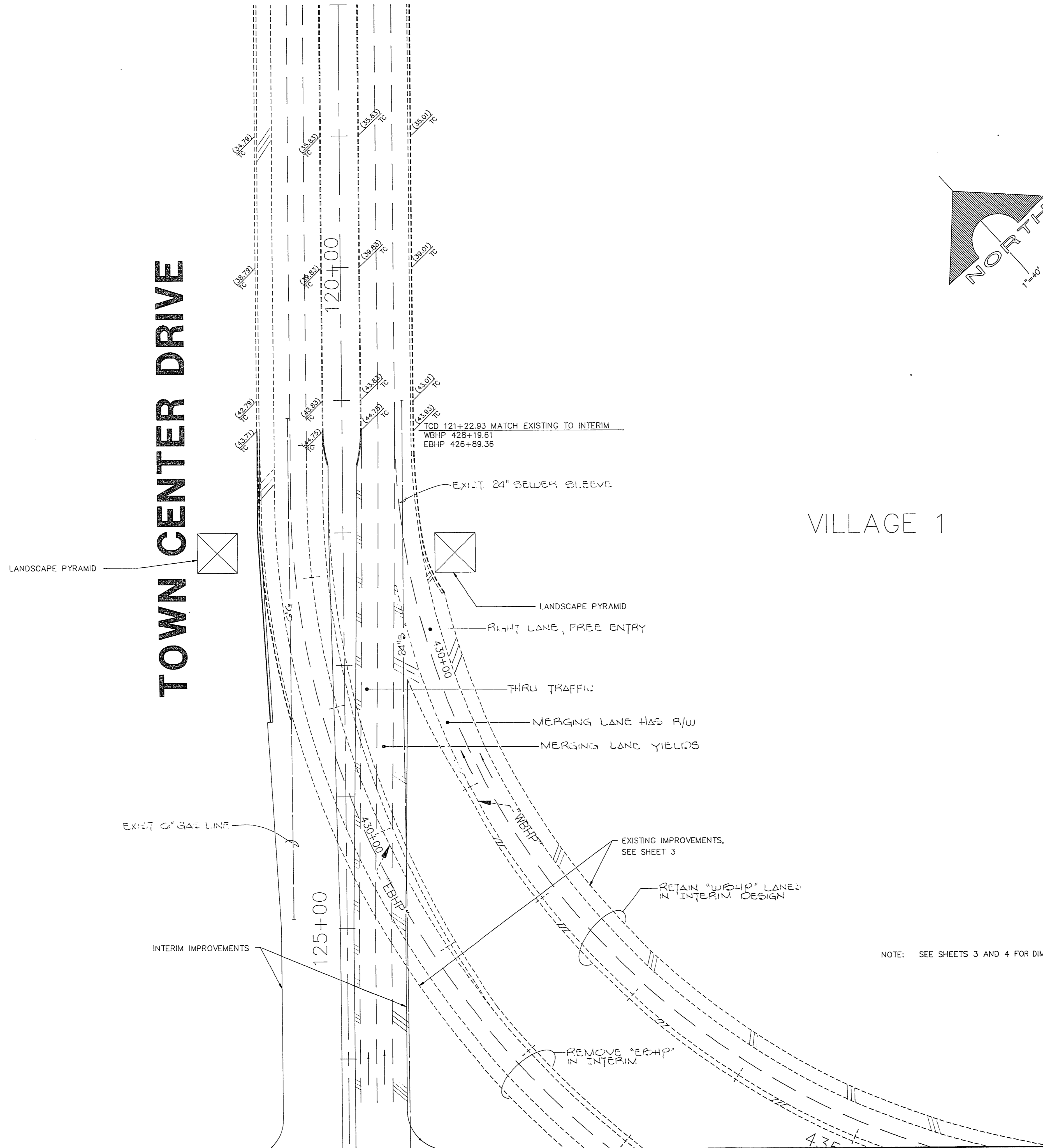

NOTE: SEE SHEETS 3 AND 4 FOR DIMENSIONS

REV. DATE	DESCRIPTION

RECOMMENDED BY: *[Signature]*
 JAMES R. HASTINGS, CIVIL ENGINEER, P.E. No. 3874

AREA: R.F.E. No. DATE: *[Signature]*

G.C. WALLACE, INC.
 Engineering/Architecture
 1555 SOUTH RAINBOW BLVD., LAS VEGAS, NEVADA 89102

HOWARD HUGHES PROPERTIES
 TOWN CENTER DRIVE-SUMMERLIN PARKWAY INTERCHANGE
 PRELIMINARY EXISTING:
 INTERIM INTERFACE NORTH PLAN

SHEET
5
 OF 9 SHEETS

6/30/89

107-11709