

HUALAPAI WAY (PUBLIC)

SIDEWALK RAMP			
NO.	"A"	"B"	CASE
1	15.0'	4.5'	II

- CONSTRUCTION NOTES**
- (A) CONSTRUCT "L" TYPE CURB & GUTTER PER STD. DWG. NO. 216
 - (B) CONSTRUCT "A" TYPE ISLAND CURB PER STD. DWG. NO. 219
 - (C) ADJUST SEWER MAN HOLES TO FINISH GRADE

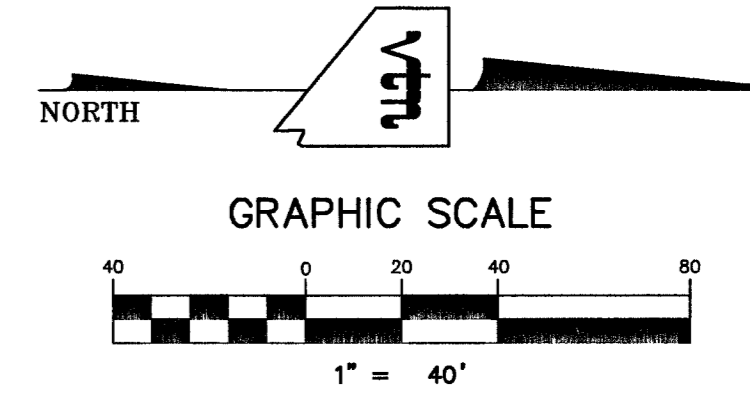
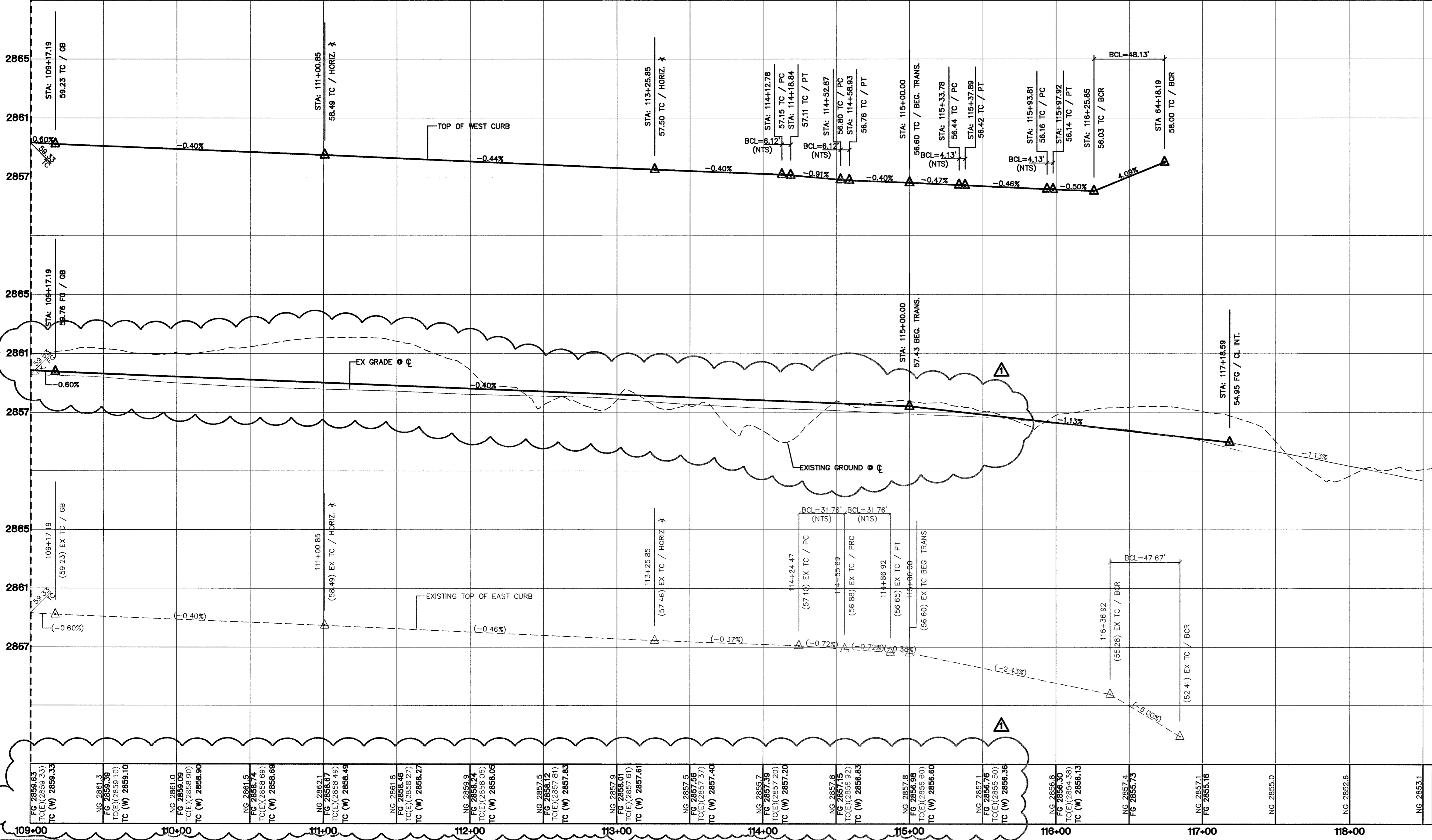

CONTRACTOR NOTE
CONTRACTOR SHALL VERIFY HORIZONTAL AND VERTICAL LOCATION OF EXISTING UTILITIES AND NOTIFY THE DESIGN ENGINEER IMMEDIATELY OF ANY DISCREPANCIES PRIOR TO CONSTRUCTION.

BACK OF CURB CURVE TABLE

CURVE	LENGTH	RADIUS	TANGENT	L ² TA
C1	6.12'	23.00'	3.08'	1432.10"
C2	6.12'	23.00'	3.08'	1432.10"
C3	4.13'	25.00'	2.07'	927.44"
C4	4.13'	25.00'	2.07'	927.44"
C5	48.13'	30.00'	31.02'	9155.19"
C6	47.68'	30.00'	30.56'	9103.15"
C7	31.76'	100.00'	16.01'	1811.42"
C8	31.76'	100.00'	16.01'	1811.42"
C9	63.33'	199.25'	31.93'	1813.00"
C10	59.35'	200.75'	29.89'	1656.00"
C11	3.93'	1.25'	INFINITE	1800.00"

Call before you Dig
1-702-455-7511
CLARK COUNTY TRAFFIC OPERATIONS AND 1-702-229-5611
LAS VEGAS AREA COMPUTERIZED TRAFFIC SYSTEM

Call before you Dig
1-800-227-2600

Call before you Overhead
1-702-227-2929

BASIS OF BEARINGS
THE BASIS OF BEARINGS FOR THIS PROJECT IS NORTH 00°08'16" EAST BEING THE EAST LINE OF THE NORTHWEST QUARTER (NE 1/4) OF THE SECTION 24, TOWNSHIP 19 SOUTH, RANGE 59 EAST, M.D.M., CLARK COUNTY, NEVADA, AS SHOWN ON A RECORD OF SURVEY ON FILE IN THE CLARK COUNTY, NEVADA, RECORDER'S OFFICE IN FILE 123 AT PAGE 32.

PROJECT BENCHMARK
PROJECT DATUM: NORTH AMERICAN VERTICAL DATUM OF 1988 (NAVD88)
CLARK COUNTY VERTICAL CONTROL: 1000-6N8
NAVD88 ELEVATION: 787.794 METERS (2584.62 FEET)

RIVET AND SQUARE ALUMINUM PLATE IN A CONCRETE CYLINDER, LOCATED 25' SOUTH & 50' EAST OF GRAND CANYON DRIVE AND RED COACH AVENUE, 1' WEST OF ELECTRICAL VAULT.

CITY OF LAS VEGAS BENCHMARK
DATUM: NORTH AMERICAN VERTICAL DATUM OF 1988 (NAVD88)
CITY OF LAS VEGAS BENCHMARK: BLV99-13SES
NAVD88 ELEVATION: 869.606 METERS (2853.03 FEET)

RIVET AND PLATE IN CONCRETE CYLINDER NW CORNER OF HUALAPAI AND ELKHORN

NOTE: ADD 0.34' TO ABOVE CITY OF LAS VEGAS BENCHMARK BLV99-13SES TO MATCH ORIGINAL PROJECT BENCHMARK, CLARK COUNTY BENCHMARK 1000-6N8 (2584.62 FEET) AS SHOWN ON RECORD OF SURVEY FILE 124 PAGE 94.

I CERTIFY THAT THIS PLAN IS IN CONFORMANCE WITH THE APPROVED DRAINAGE STUDY ON FILE AT CITY OF LAS VEGAS FOR THIS PROJECT.

DANIEL J. HOOD NO. 12811 DATE: 8.1.06 HTE# 05-19169 1074816-4WY

CLIFFS EDGE LLC
3450 W. HUALAPAI BOULEVARD, SUITE 280
LAS VEGAS, NEVADA 89123
(702) 771-1221

STREET PLAN & PROFILE
HUALAPAI WAY
STA. 109+00.00 TO 117+18.59

CLIFFS EDGE / PROVIDENCE
HUALAPAI WAY
DEER SPRINGS TO GRAND TETON

CITY OF LAS VEGAS, NEVADA
REV. DATE BY

7 6 5 4 3 2 1

REVISION

7/24/06 JP REV. MEDIAN T/C GRADES & REV. EX. CL. F.G. & SANITARY LINE

2727 SOUTH RAINBOW BOULEVARD LAS VEGAS, NEVADA 89146-5148
PH. (702) 973-7550 FAX (702) 382-2397
nevada CONSULTING ENGINEERS • PLANNERS • LAND SURVEYORS

PROFESSIONAL ENGINEER STATE OF NEVADA
DANIEL J. HOOD
NO. 12811
CIVIL

EXPIRES 06-30-07

DRAWN BY: MAR_03
DESIGNED BY: MAR_03
CHECKED BY: MAR_03
PROJECT NO: 5989
SCALE: 1"=40' HORIZ.
1"=4' VERT.

SHEET 12 OF 29 SHEETS
DRAWING NO. 1074816-4WY