

NOTE: ALL PRIVATE STREETS ARE P.U.E.A. CLV PUBLIC SEWER EASEMENTS AND PUBLIC DRAINAGE EASEMENTS TO BE PRIVATELY MAINTAINED

NO.	RADIUS	DELTA	LENGTH	TANGENT
C1	52.00'	49°02'27"	44.51'	23.72'
C2	52.00'	51°16'42"	46.54'	24.96'
C3	52.00'	38°22'14"	34.82'	18.09'
C4	30.00'	88°30'53"	46.35'	29.23'
C5	52.00'	138°41'23"	125.87'	137.94'
C6	20.00'	91°29'07"	31.93'	20.53'
C7	52.00'	42°08'08"	38.24'	20.03'
C8	52.00'	53°34'03"	48.62'	26.25'
C9	52.00'	46°45'22"	42.43'	22.48'
C10	54.00'	25°05'15"	23.64'	12.01'
C11	30.00'	92°17'02"	48.32'	31.22'
C12	52.00'	142°27'33"	129.29'	153.01'
C13	20.00'	87°42'58"	30.62'	19.22'
C14	20.00'	92°17'02"	32.21'	20.81'
C15	34.00'	51°25'32"	30.52'	16.37'
C16	51.00'	96°25'29"	85.83'	57.07'
C17	51.00'	45°00'03"	40.06'	21.13'
C18	51.00'	54°38'15"	48.63'	26.34'
C19	51.00'	86°47'17"	77.25'	48.22'
C20	51.00'	282°51'05"	251.77'	
C21	25.00'	88°30'53"	36.62'	24.36'

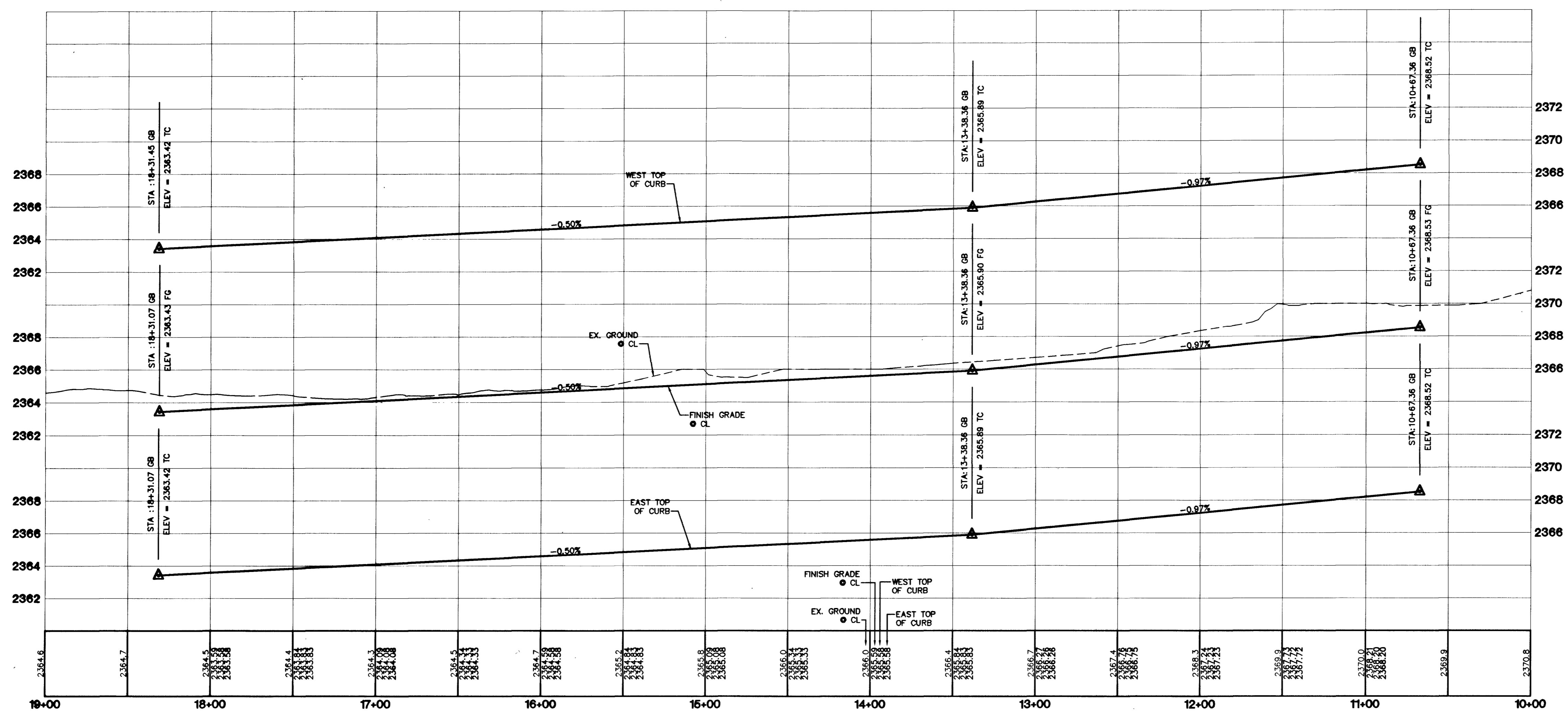

DISCLAIMER NOTE
 UTILITY LOCATIONS SHOWN HEREON ARE APPROXIMATE ONLY. IT SHALL BE THE CONTRACTOR'S RESPONSIBILITY TO DETERMINE THE EXACT HORIZONTAL AND VERTICAL LOCATION OF ALL EXISTING UNDERGROUND AND OVERHEAD UTILITIES PRIOR TO COMMENCING CONSTRUCTION. NO REPRESENTATION IS MADE THAT ALL EXISTING UTILITIES ARE SHOWN HEREON. THE ENGINEER ASSUMES NO RESPONSIBILITY FOR UTILITIES NOT SHOWN OR UTILITIES NOT SHOWN IN THEIR PROPER LOCATION.

- CONSTRUCTION NOTES**
- (A) CONSTRUCT "L" CURB & GUTTER PER STD. # 216
 - (B) CONSTRUCT SIDEWALK PER STD. # 234
 - (C) CONSTRUCT CROSS GUTTER PER STD. # 228
 - (D) CONSTRUCT SIDEWALK DRAIN PER STD. # 235
 - (E) CONSTRUCT SIDEWALK DRAIN PER STD. # 236
 - (F) EDGE OF PAVEMENT
 - (G) CONSTRUCT "A" TYPE ISLAND CURB PER STD. # 219

PROJECT BENCHMARK
 PROJECT DATUM: NAVD88
 (OLD) CITY OF LAS VEGAS BENCHMARK 11V90-13NES
 NAVD88 ELEVATION: 710.9608 METERS (2332.54 FEET)
 PROJECT DESIGNED USING OLD BENCHMARK
 (NEW) CITY OF LAS VEGAS BENCHMARK 11V90-13NES
 NAVD88 ELEVATION: 710.9181 METERS (2332.40 FEET)
 (-0.14 FEET) TO GET NEW PUBLISHED DATUM
 ONLY BM 413148 NAVD 88 ELEV=710.953 METERS (2332.52 FEET) DIAMETER 10" CONCRETE MONUMENT 77 FEET SOUTH & 54 FEET WEST OF N.E. CORNER SEC. 13T19R60E 10" EAST OF LARGE POWER POLE.

BASIS OF BEARINGS
 THE BASIS OF BEARINGS FOR THIS PROJECT IS GRID NORTH AS DEFINED BY THE NEVADA COORDINATE SYSTEM OF 1983 (NCS83), EAST ZONE (2701), DETERMINED BY CLARK COUNTY GIS CONTROL POINTS 802, 803, 804, AND 805, AS SHOWN ON A RECORD OF SURVEY ON FILE IN THE CLARK COUNTY, NEVADA, RECORDER'S OFFICE, IN BOOK 88 OF SURVEYS, AT PAGE 53.

Avoid cutting underground utility lines. It's costly.
Call before you Dig
 1-800-227-2600

Avoid overhead power line contact. It's costly.
Call before you Overhead
 1-702-593-6111

7	6	5	4	3	2	1
REV	DATE	BY	NAME	REVISION	DATE	BY

CITY OF LAS VEGAS
 2727 SOUTH RAINBOW BOULEVARD LAS VEGAS, NEVADA 89146-5148
 PH. (702) 873-7550 FAX (702) 362-2597
nevada CONSULTING ENGINEERS • PLANNERS • LAND SURVEYORS

KB HOME
 750 PILOT ROAD, SUITE F
 LAS VEGAS, NV 89119
 (702) 614-2500

STREET PLAN AND PROFILE
 SEDONA FLATS STREET

IRON MOUNTAIN RANCH
 VILLAGE 8
 UNIT 2

DRAWN BY: MKO JULY 2002
 DESIGNED BY: JULY 2002
 CHECKED BY: KFN JULY 2002
 PROJECT NO: 8027-02
 SCALE: 1"=40' HORIZ. VERT.

PROFESSIONAL ENGINEER
 KENNETH W. HANCOCK
 CIVIL
 No. 10639 NOV 1978
 EXPIRES 12-31-03

SHEET
23
 12 OF 24 SHEETS
 DRAWING NO.
 1674-4624-8-2

46343 R.G. 50590