

**FULTON RANCH STREET (PRIVATE)**  
 PRIVATE STREET, P.U.E., CLV SEWER EASEMENT  
 PUBLIC DRAINAGE EASEMENT TO BE PRIVATELY MAINTAINED  
 BY HOME OWNERS ASSOCIATION

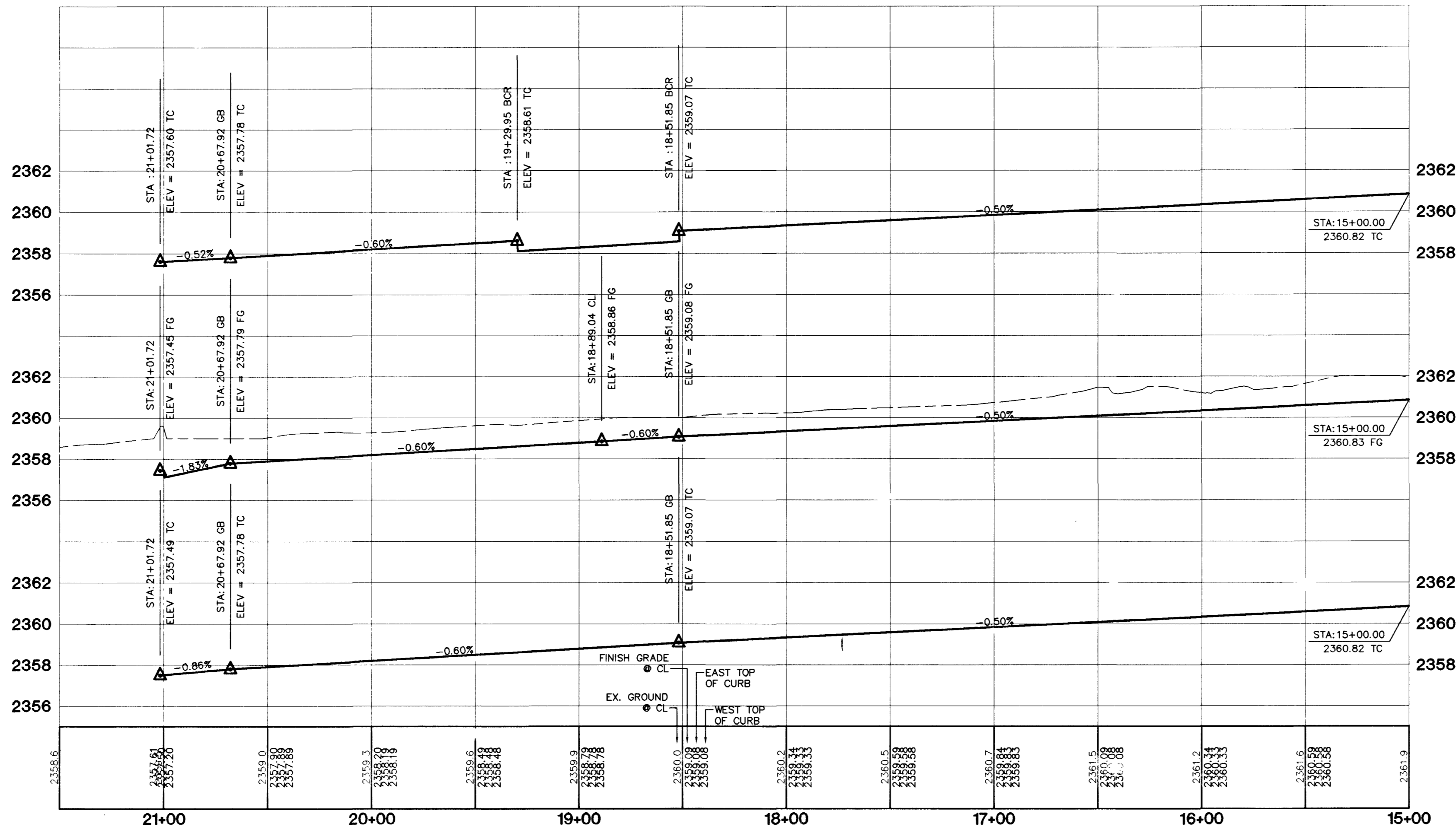

**KEY MAP**  
 GRAPHIC SCALE

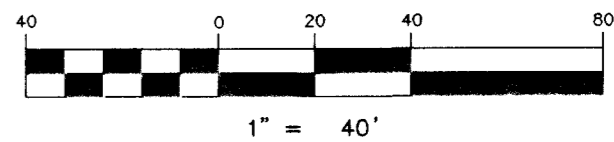

**PROFILE SCALE:**  
 HORIZ. 1" = 40'  
 VERT. 1" = 4'

NO.	RADIUS	DELTA	LENGTH	TANGENT
C1	15.00'	48°11'23"	12.62'	6.71'
C2	15.00'	41°48'37"	10.95'	5.73'
C5	25.00'	90°00'00"	39.27'	25.00'
C6	15.00'	90°00'00"	23.56'	15.00'
C7	52.00'	68°58'30"	62.60'	35.72'
C8	52.00'	73°14'39"	66.47'	38.65'
C9	54.00'	25°05'15"	23.64'	12.01'
C10	30.00'	92°02'37"	48.19'	31.09'
C11	20.00'	87°09'28"	30.42'	19.03'
C12	52.00'	142°13'08"	129.07'	151.96'
C13	519.00'	03°41'40"	33.46'	16.74'
C14	519.00'	02°47'22"	25.27'	12.64'
C15	20.00'	92°50'32"	32.41'	21.02'
C16	500.00'	06°29'02"	56.58'	28.32'
C17	481.00'	06°29'02"	54.43'	27.25'
C18	481.00'	09°19'34"	78.29'	39.23'
C19	500.00'	09°19'34"	81.39'	40.78'
C20	519.00'	09°19'34"	84.48'	42.33'
C21	519.00'	06°29'02"	58.73'	29.40'

**DISCLAIMER NOTE**  
 UTILITY LOCATIONS SHOWN HEREON ARE APPROXIMATE ONLY. IT SHALL BE THE CONTRACTOR'S RESPONSIBILITY TO DETERMINE THE EXACT HORIZONTAL AND VERTICAL LOCATION OF ALL EXISTING UNDERGROUND AND OVERHEAD UTILITIES PRIOR TO COMMENCING CONSTRUCTION. NO REPRESENTATION IS MADE THAT ALL EXISTING UTILITIES ARE SHOWN HEREON. THE ENGINEER ASSUMES NO RESPONSIBILITY FOR UTILITIES NOT SHOWN OR UTILITIES NOT SHOWN IN THEIR PROPER LOCATION.

- CONSTRUCTION NOTES**
- (A) CONSTRUCT "L" CURB & GUTTER PER STD. # 216
  - (B) CONSTRUCT SIDEWALK PER STD. # 234
  - (C) CONSTRUCT CROSS GUTTER PER STD. # 228
  - (D) CONSTRUCT SIDEWALK RAMP PER STD. # 235
  - (E) CONSTRUCT SIDEWALK DRAIN PER STD. # 236
  - (F) EDGE OF PAVEMENT
  - (G) CONSTRUCT "A" TYPE ISLAND CURB PER STD. # 219

Avoid overhead power line contact. It's costly.

**Call before you Overhead**  
 1-702-593-6111

Avoid cutting underground utility lines. It's costly.

**Call before you Dig**  
 1-800-227-2600

**BENCHMARK**  
 PROJECT DATUM: NAVD88  
 CITY OF LAS VEGAS BENCHMARK 1LV90-13NES  
 NAVD88 ELEVATION: 710.9608 METERS (2332.54 FEET)  
 ONLY BM 413148, DECATUR BLVD & GRAND TETON DRIVE  
 100' SW OF SECTION CORNER, NEXT TO METAL POWER POLE

**BASIS OF BEARINGS**  
 THE BASIS OF BEARINGS FOR THIS PROJECT IS GRID NORTH AS DEFINED BY THE NEVADA COORDINATE SYSTEM OF 1983 (NCS83), EAST ZONE, (2701), DETERMINED BY CLARK COUNTY GIS CONTROL POINTS 802, 803, 804, AND 805, AS SHOWN ON A RECORD OF SURVEY ON FILE IN THE CLARK COUNTY, NEVADA, RECORDER'S OFFICE, IN BOOK 88 OF SURVEYS, AT PAGE 53.

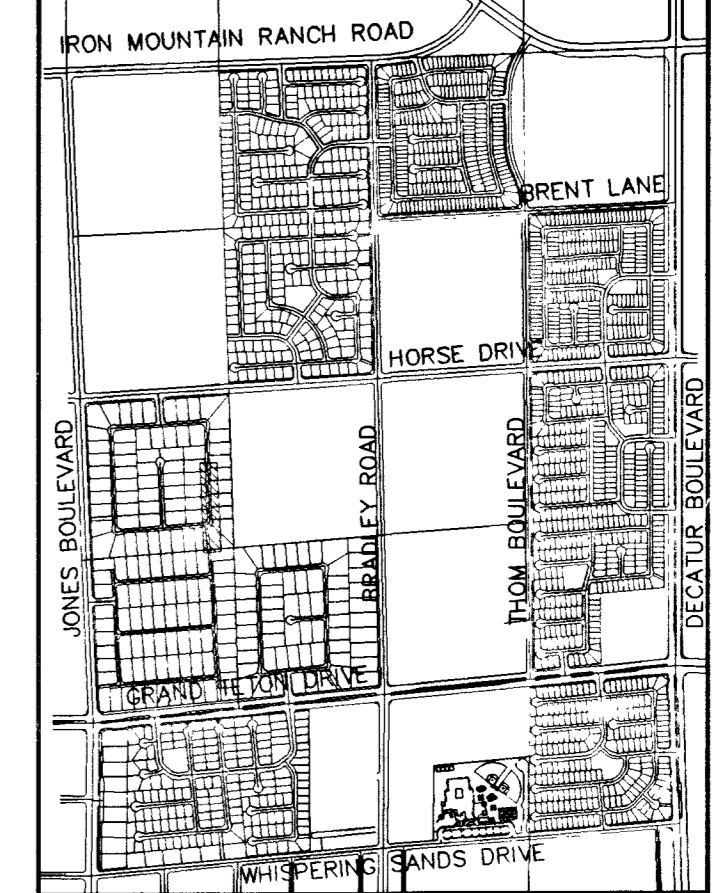

**KB HOME**  
 750 PILOT ROAD, SUITE F  
 LAS VEGAS, NV 89119  
 (702) 614-2500

**novada**  
 2727 SOUTH RAINBOW BOULEVARD LAS VEGAS, NEVADA 89146-5148  
 PH. (702) 873-7550 FAX (702) 362-2597

**PROFESSIONAL ENGINEER STATE OF NEVADA**  
 KENNETH J. JOHNSON  
 CIVIL  
 70539  
 EXPIRES 12-31-03

**STREET PLAN AND PROFILE**  
**FULTON RANCH STREET**  
 STA: 15+00 TO 21+01.72

**IRON MOUNTAIN RANCH**  
 VILLAGE 8 UNIT 1

**CITY OF LAS VEGAS**

DRAWN BY: MWD MAR '02  
 DESIGNED BY: RMS MAR '02  
 CHECKED BY: KFN MAR '02  
 PROJECT NO: 8027-1 SCALE: 1"=40' HORIZ. 1"=40' VERT.  
 SHEET NO. 15 OF 20 SHEETS  
 DRAWING NO. 1074-4604-B-1

45142 Rgm 63746