

JONES BOULEVARD
SEE IRON MOUNTAIN RANCH VILLAGE 8, UNIT 2 FOR CONTINUATION

STEWART MADRE STREET
SEE SHEET ST3 FOR CONTINUATION

HORSE DRIVE (PUBLIC)

200 AMP 240V PAD MOUNT SERVICE:
60 AMP DOUBLE POLE/240V - STREETLIGHT CIRCUIT "A"
60 AMP DOUBLE POLE/240V - STREETLIGHT CIRCUIT "B"
15 AMP SINGLE POLE/120V - PHOTO CELL
60 AMP SINGLE POLE/120V - TRAFFIC SIGNAL
40 AMP SINGLE POLE/120V - INTERSECTION LIGHTS

PROFILE SCALE:
HORIZ. 1" = 40'
VERT. 1" = 4'

SIDEWALK RAMPS TABLE
PER STD. DWG 235 CASE 1

NO.	DIM "A"	DIM "B"	CASE
1	8.0'	8.0'	I

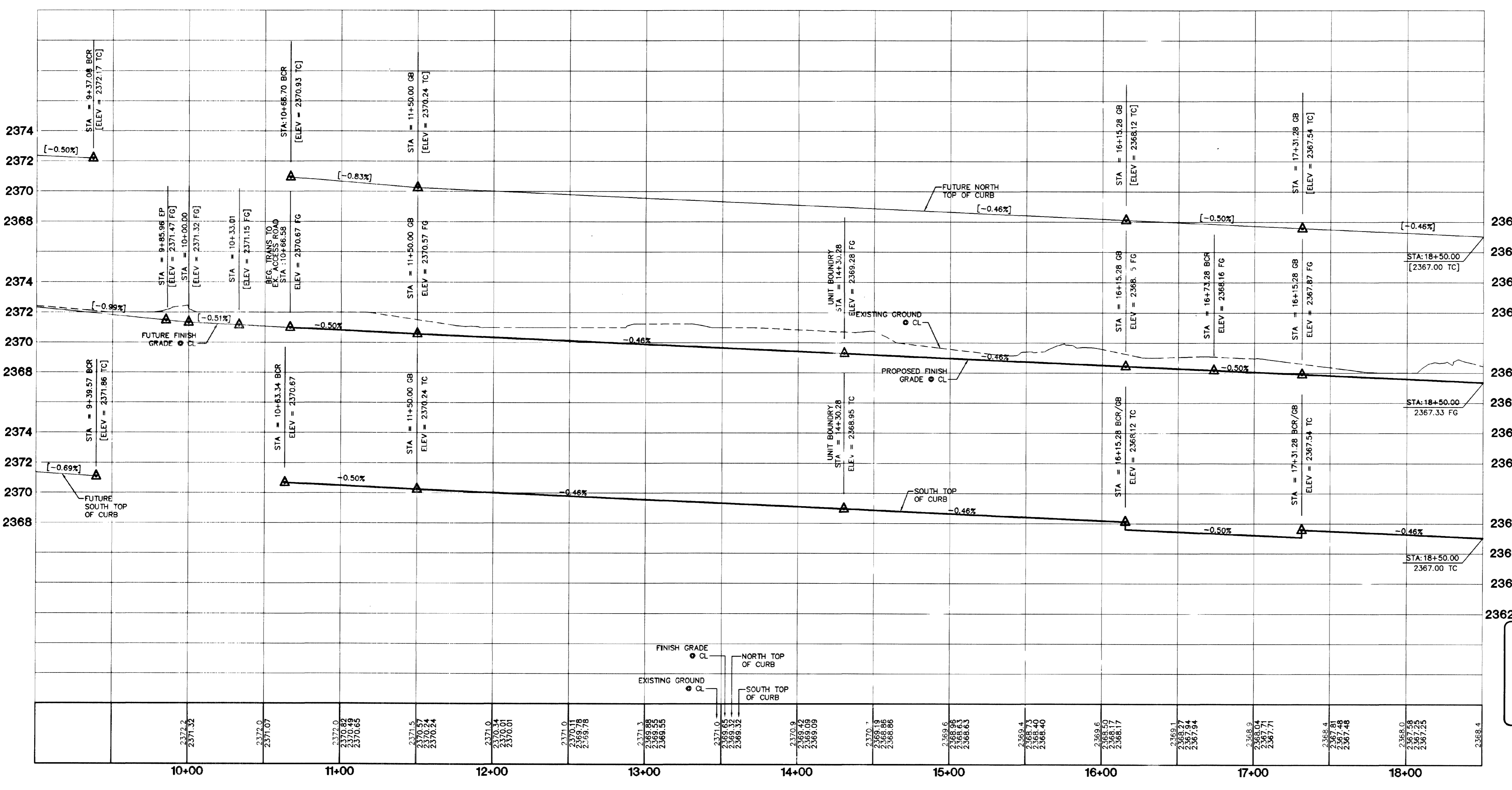

CURVE TABLE

NO.	RADIUS	DELTA	LENGTH	TANGENT
C1	15.00'	48°11'23"	12.62'	6.71'
C2	15.00'	41°48'37"	10.95'	5.73'
C5	25.00'	90°00'00"	39.27'	25.00'
C6	15.00'	90°00'00"	23.56'	15.00'
C7	52.00'	68°58'30"	52.00'	35.72'
C8	52.00'	73°14'39"	56.47'	38.65'
C9	54.00'	25°05'15"	23.64'	12.01'
C10	30.00'	92°02'37"	48.19'	31.09'
C11	20.00'	87°09'28"	30.42'	19.03'
C12	52.00'	142°13'08"	129.07'	151.96'
C13	519.00'	03°41'40"	33.46'	16.74'
C14	519.00'	02°47'22"	25.27'	12.64'
C15	20.00'	92°50'32"	32.41'	21.02'
C16	500.00'	06°29'02"	56.58'	28.32'
C17	481.00'	06°29'02"	54.43'	27.25'
C18	481.00'	09°19'34"	78.29'	39.23'
C19	500.00'	09°19'34"	81.39'	40.78'
C20	519.00'	09°19'34"	84.48'	42.33'
C21	519.00'	06°29'02"	58.73'	29.40'

Sean Miller 9/27/02
DATE
SOUTHERN NEVADA WATER AUTHORITY
SNWA APPROVAL IS VALID FOR ONE YEAR FROM THE SIGNATURE DATE. IF CONSTRUCTION WITHIN THE EASEMENT OF RESTRICTED PIPE SAFETY ZONE IS NOT COMPLETE, PLANS MUST BE RESUBMITTED TO SNWA FOR APPROVAL.

DISCLAIMER NOTE
UTILITY LOCATIONS SHOWN HEREON ARE APPROXIMATE ONLY. IT SHALL BE THE CONTRACTOR'S RESPONSIBILITY TO DETERMINE THE EXACT HORIZONTAL AND VERTICAL LOCATION OF ALL EXISTING UNDERGROUND AND OVERHEAD UTILITIES PRIOR TO COMMENCING CONSTRUCTION. NO REPRESENTATION IS MADE THAT ALL EXISTING UTILITIES ARE SHOWN HEREON. THE ENGINEER ASSUMES NO RESPONSIBILITY FOR UTILITIES NOT SHOWN OR UTILITIES NOT SHOWN IN THEIR PROPER LOCATION.

SNWA CONSTRUCTION NOTES:
CONTRACTOR SHALL FIELD LOCATE AND PROTECT ALL SNWA/SNWS APPURTENANCES INCLUDING, BUT NOT LIMITED TO AV/AR, ACCESS MAINWAYS AND CATHODIC PROTECTION SYSTEMS. ALL ABOVE GROUND STRUCTURES AND AT GRADE STRUCTURES MUST BE ADJUSTED TO NEW GRADE AT CONTRACTOR'S EXPENSE. CATHODIC PROTECTION TEST STATIONS, RECTIFIERS, AND AV/AR'S MUST BE RELOCATED TO THE SIDEWALK PER SNWA STANDARDS AND AT THE CONTRACTOR'S EXPENSE. CONTRACTOR TO NOTIFY SOUTHERN NEVADA WATER AUTHORITY, DEVELOPMENT PLAN REVIEW, AT (702) 862-3444 AT LEAST 48 HOURS PRIOR TO CONSTRUCTION ACTIVITY.

CONSTRUCTION NOTES
A) CONSTRUCT "L" CURB & GUTTER PER STD. # 216
B) CONSTRUCT SIDEWALK PER STD. # 234
C) CONSTRUCT CROSS GUTTER PER STD. # 228
D) CONSTRUCT SIDEWALK RAMP PER STD. # 235
E) CONSTRUCT SIDEWALK DRAIN PER STD. # 236
F) EDGE OF PAVEMENT
G) CONSTRUCT "A" TYPE ISLAND CURB PER STD. # 219

Call before you Overhead
1-702-593-6111

Call before you Dig
1-800-227-2600

BENCHMARK
PROJECT DATUM: NAVD88
CITY OF LAS VEGAS BENCHMARK 11V90-13NES
NAV88 ELEVATION: 710.9608 METERS (2332.54 FEET)
ONLY BM 413148, DECATUR BLVD & GRAND TETON DRIVE
100' SW OF SECTION CORNER, NEXT TO METAL POWER POLE

BASIS OF BEARINGS
THE BASIS OF BEARINGS FOR THIS PROJECT IS GRID NORTH AS DEFINED BY THE NEVADA COORDINATE SYSTEM OF 1983 (NCS) - EAST ZONE, (2701), DETERMINED BY CLARK COUNTY GIS CONTROL POINTS 802, 803, 804, AND 805, AS SHOWN ON A RECORD OF SURVEY ON FILE IN THE CLARK COUNTY, NEVADA, RECORDER'S OFFICE, IN BOOK 88 OF SURVEYS, AT PAGE 53.

CITY OF LAS VEGAS

KB HOME
750 PILOT ROAD, SUITE F
LAS VEGAS, NV 89119
(702) 814-2500

STREET PLAN AND PROFILE
HORSE DRIVE
STA: 10+00.00 TO 18+50.00

IRON MOUNTAIN RANCH
VILLAGE 8 UNIT 1

2727 SOUTH RAINBOW BOULEVARD LAS VEGAS, NEVADA 89146-5148
PH. (702) 873-7550 FAX (702) 362-2597

novada
CONSULTING ENGINEERS • PLANNERS • LAND SURVEYORS

DRAWN BY: MAR '02
DESIGNED BY: RMS
CHECKED BY: NKN
PROJECT NO: 10539 VILLAGE 8 UNIT 1
SCALE: 1"=40' HORIZ. VERT. NA

EXPIRES 12-31-07

SHEET
ST1
11 OF 20 SHEETS
DRAWING NO.
107Y-4604-B-1