

EXISTING IRON MOUNTAIN RANCH VILLAGE 7 UNIT 1

REFER TO PLANS BY VIN DWG #307Y-4604-7-7

SERVICE LATERALS FOR LOTS: 966 & 967 WILL BE TAPPED ON EXISTING MAIN BY OWNER'S CONTRACTOR UNDER DIRECTION OF THE LVVWD.

INSTALL MARKER BALLS OVER ALL 11-1/4", 22-1/2", 45", & 90" BENDS.

LOTS 794-810, 824-828, 917-946, AND 954-974 MAY HAVE STATIC WATER PRESSURE IN EXCESS OF 80 PSI. THE UNIFORM PLUMBING CODE REQUIRES THAT INDIVIDUAL ON-SITE (PRIVATE) PRESSURE REDUCING VALVES BE INSTALLED WHENEVER THE PRESSURE EXCEEDS 80 PSI. PRVs ARE THE DEVELOPER'S RESPONSIBILITY AND WILL NOT BE INSPECTED OR INCLUDED IN THE ACCEPTANCE OF LVVWD FACILITIES.

BASIS OF BEARINGS

THE BASIS OF BEARINGS FOR THIS PROJECT IS GRID NORTH AS DEFINED BY THE NEVADA COORDINATE SYSTEM OF 1983 (NCS83) ZONE (270) DETERMINED BY CLARK COUNTY GIS CONTROL POINTS 802, 803, 804 AND 805, AS SHOWN ON A RECORD OF SURVEY ON FILE IN THE CLARK COUNTY NEVADA RECORDER'S OFFICE, IN BOOK 88 OF SURVEYS, AT PAGE 53.

NOTE: CONTRACTOR SHALL VERIFY HORIZONTAL AND VERTICAL LOCATION OF EXISTING UTILITIES AND NOTIFY THE DESIGN ENGINEER IMMEDIATELY OF ANY DISCREPANCIES PRIOR TO CONSTRUCTION.

PROJECT BENCHMARK

PROJECT DATUM: NAVD88
 CITY OF LAS VEGAS BENCHMARK 11V90-13NES
 NAVD88 ELEVATION: 710.9608 METERS (2332.54 FEET)
 ONLY BM 413148, NAVD 88 ELEV=710.953 METERS (2332.52 FEET) 1" DIAMETER CONCRETE MONUMENT 1/2 FEET SOUTH & 54 FEET WEST OF N.E. CORNER SEC. 13T19R60E 10" EAST OF LARGE POWER POLE.

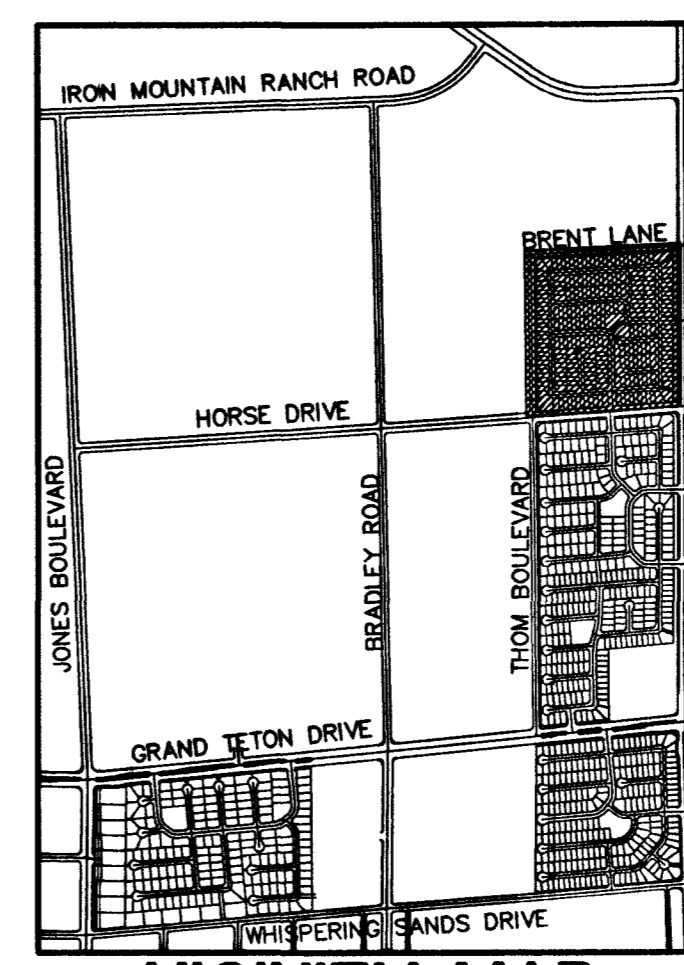

VICINITY MAP
NOT TO SCALE

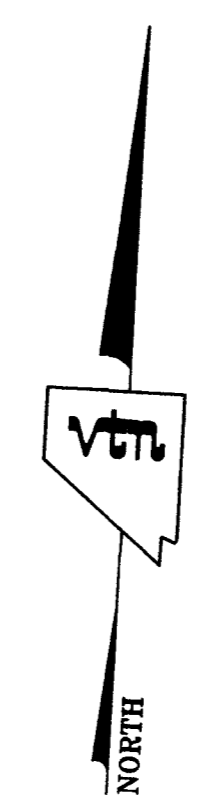
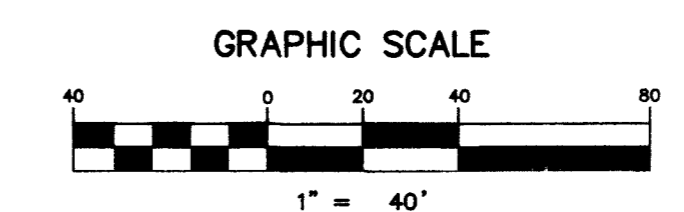

Call before you Dig
1-800-227-2600

Call before you OVERHEAD
1-702-593-6111

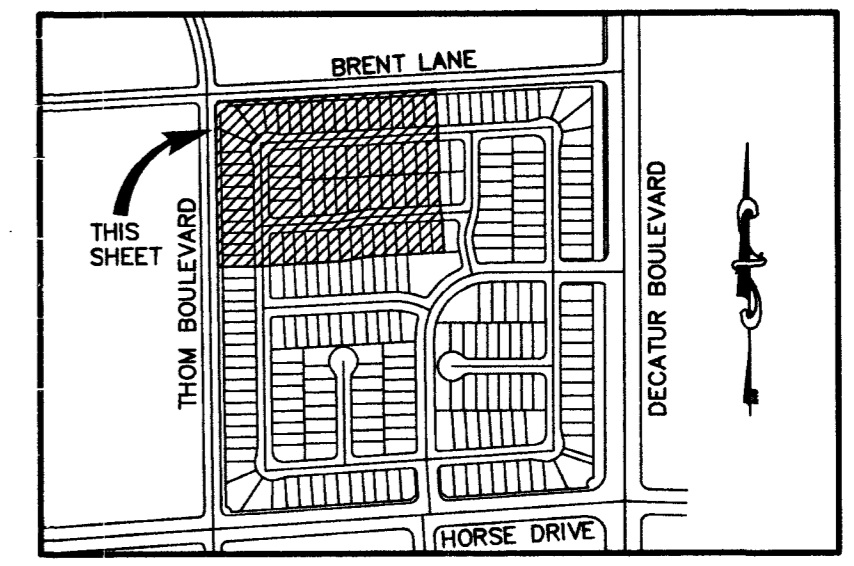

VILLAGE 7 - KEY MAP
NOT TO SCALE

ESTIMATE OF QUANTITIES / LEGEND

WATER	PUBLIC
① FIRE HYDRANT ASSEMBLY (PER UDACS PLATE NO. 7)	6 EA.
② 12" 12'x12' TEE	0 EA.
③ 8" 8'x8' TEE	3 EA.
④ 8" 8' REDUCER	1 EA.
⑤ 8" 90° ELBOW	1 EA.
⑥ 8" 8' CROSS	0 EA.
⑦ 8" GATE VALVE	6 EA.
⑧ 8" 22.5' ELBOW	2 EA.
⑨ CAP ONLY	2 EA.
⑩ CAP W/ 2" B.O. ASSEMBLY (PER UDACS PLATE NO. 4)	1 EA.
⑪ 8" 11.25' ELBOW	1 EA.
⑫ W/ 5/8" METER (PER UDACS PLATE 1B)	93 EA.
⑬ 6" WATER MAIN	0 LF.
⑭ 8" WATER MAIN	2,189 LF.

SEWER	PUBLIC
① STANDARD MANHOLE (PUBLIC)	15 EA.
② 4" SEWER LATERALS (PRIVATE)	2,758 LF.
③ 4" SEWER WYES (PRIVATE)	95 EA.
④ BACKWATER VALVES (PRIVATE)	2 EA.
⑤ 8" SEWER MAIN (PUBLIC)	3,094 LF.

SEWER CONTRIBUTION (BASED ON 17 LOTS)
 AVERAGE DAILY FLOW = 0.00425 MGD.
 PEAK FLOW (PF=3.5) = 0.014875 MGD.

STREET LIGHT & SIGNAGE

① 70WATT H.P.S. (PUBLIC)	4 EA.
② SUMMERLIN TYPE 3C POLES WITH 8.0' ARMS	5 EA.
③ 100 WATT H.P.S. (PUBLIC) SUMMERLIN TYPE 2C POLES WITH 8.0' ARMS	1 EA.
④ 150 WATT H.P.S. (PUBLIC) SUMMERLIN TYPE 2B POLES WITH 8.0' ARMS	3,214 LF.
⑤ 200 AMP SERVICE POINT	1 EA.
⑥ 3-1/2" PULLBOX	13 EA.
⑦ R1-1 "STOP" SIGN & (2) D3 "STREET NAME" SIGNS	3 EA.
⑧ (2) D3 "STREET NAME" SIGNS	1 EA.
⑨ DRIVEWAY LOCATION (SCHEMATIC)	93 EA.
⑩ POINT OF CONNECTION	4 EA.

LAS VEGAS FIRE DEPARTMENT

FIRE FLOW REQUIREMENT IS 1,500 GALLONS/MIN. AT 20 LBS./SQ.IN. RESIDUAL.
 BASED ON:
 SQUARE FOOTAGE: 2600
 LARGEST AREA BETWEEN SEPERATION WALLS:
 HEIGHT: 2 STORY
 TYPE OF CONSTRUCTION:
 EXPOSURES: 10' MIN.
 SPRINKLER SYSTEM: NONE
 OCCUPANCY: SINGLE FAMILY RESIDENCE
 ROOF CONSTRUCTION: CONCRETE TILE
 REVIEWED BY: _____

APPROVAL:

LAS VEGAS VALLEY WATER DISTRICT DATE _____
 CITY OF LAS VEGAS FIRE MARSHAL DATE _____
 NEVADA POWER COMPANY DATE _____
 SHEET 1 OF 2 SHEETS
 DRAWING NO. 307Y-4604-7-2

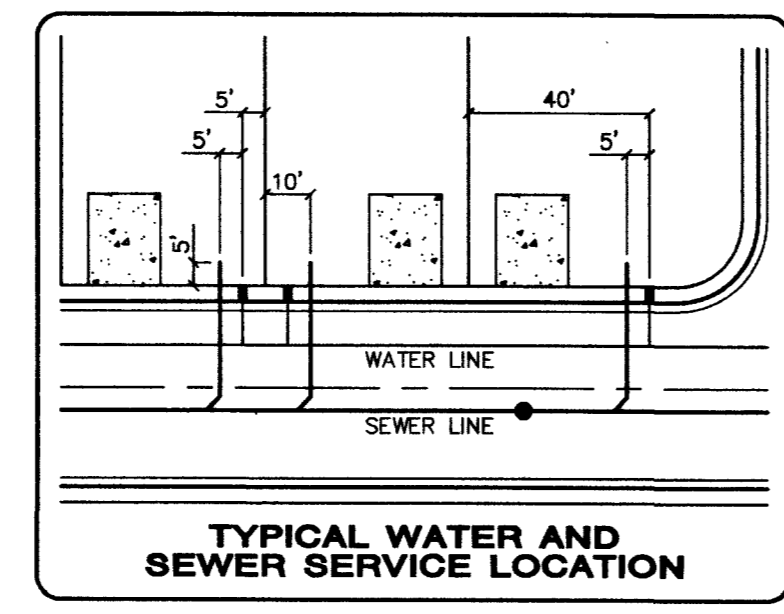
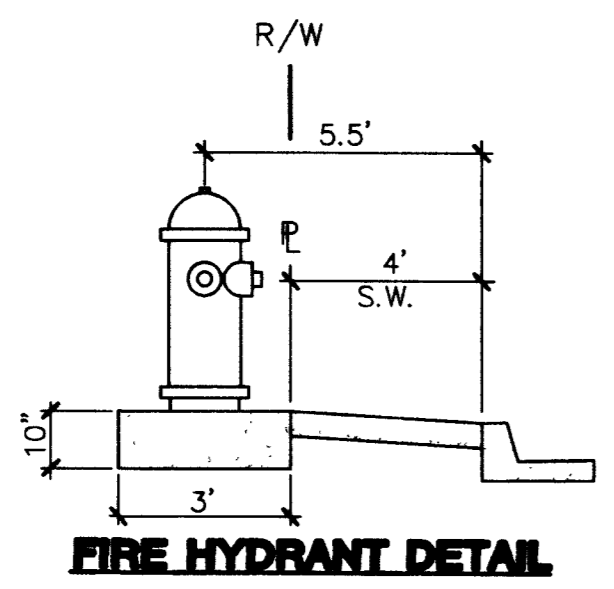
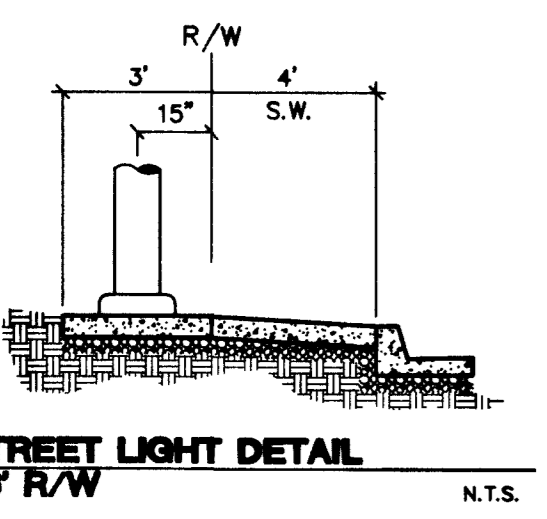

KB HOME
 750 PILOT ROAD, SUITE F
 LAS VEGAS, NV 89118
 (702) 614-2500

VTI nevada
 CONSULTING ENGINEERS • PLANNERS • LAND SURVEYORS

CITY OF LAS VEGAS
 2727 SOUTH RAINBOW BOULEVARD LAS VEGAS, NEVADA 89146-5148
 PH. (702) 875-7550 FAX (702) 362-2597

SEWER AS-BUILT

IRON MOUNTAIN RANCH VILLAGE 7 UNIT 2

DRAWN BY: FEBRUARY 11, 2004
 DESIGNED BY:
 CHECKED BY:
 PROJECT NO: 5925-2
 SCALE: 1"=40' HORIZ. VERT. NA

SHEET 1 OF 2 SHEETS
 DRAWING NO. 307Y-4604-7-2