

**WHISTLING ACRES AVENUE
(PUBLIC)**

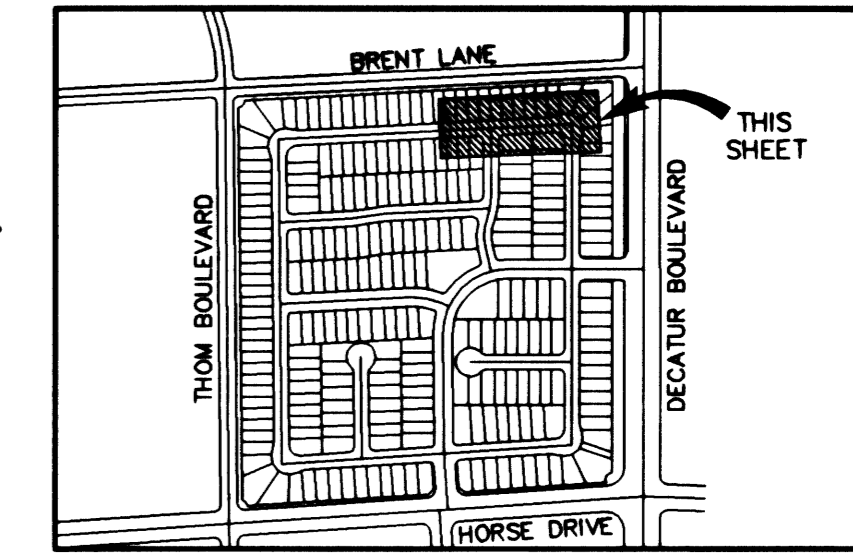

VILLAGE 7 - KEY MAP

NOT TO SCALE

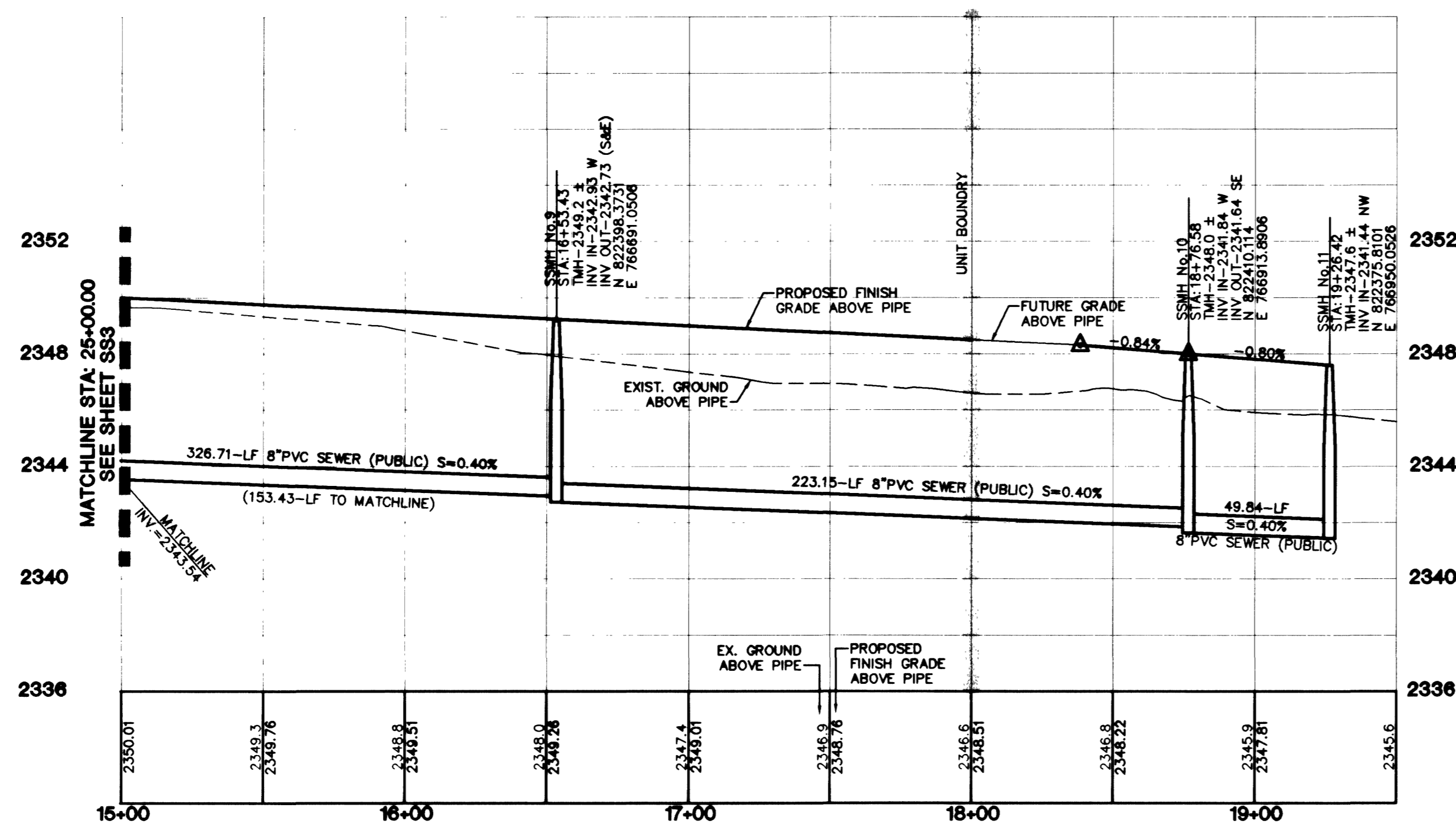
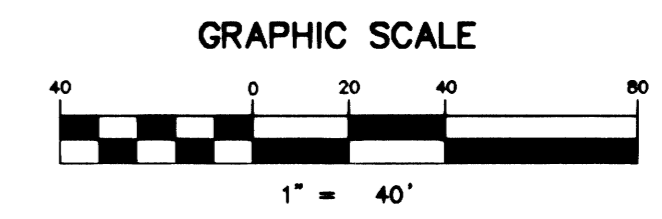

PROFILE SCALE:
HORIZ. 1" = 40'
VERT. 1" = 4'

PROJECT BENCHMARK

PROJECT DATUM: NAVD88
CITY OF LAS VEGAS BENCHMARK 1LV90-13NES
NAVD88 ELEVATION: 710.9608 METERS (2332.54 FEET)
ONLY BM 413148, NAVD 88 ELEV=710.953
METERS (2332.52 FEET) DIAMETER CONCRETE MONUMENT
77 FEET SOUTH & 54 FEET WEST OF N.E. CORNER
SEC. 13T19R60E 10' EAST OF LARGE POWER POLE.

BASIS OF BEARINGS

THE BASIS OF BEARINGS FOR THIS PROJECT IS GRID NORTH AS DEFINED BY THE NEVADA COORDINATE SYSTEM OF 1983 (NCS83), EAST ZONE, (2701), DETERMINED BY CLARK COUNTY GIS CONTROL POINTS 802, 803, 804, AND 805, AS SHOWN ON A RECORD OF SURVEY ON FILE IN THE CLARK COUNTY, NEVADA, RECORDER'S OFFICE, IN BOOK 88 OF SURVEYS, AT PAGE 33.

NOTE: CONTRACTOR SHALL VERIFY HORIZONTAL AND VERTICAL LOCATION OF EXISTING UTILITIES AND NOTIFY THE DESIGN ENGINEER IMMEDIATELY OF ANY DISCREPANCIES PRIOR TO CONSTRUCTION.

<p>KB HOME 750 PILOT ROAD, SUITE F LAS VEGAS, NV 89119 (702) 511-2500</p>		<p>mtm nevada 2727 SOUTH RAINBOW BOULEVARD LAS VEGAS, NEVADA 89146-5148 PH. (702) 873-7500 FAX (702) 362-2597 CONSULTING ENGINEERS • PLANNERS • LAND SURVEYORS</p>	
<p>SEWER PLAN & PROFILE WHISTLING ACRES AVENUE STA: 15+00.00 - 19+50.00</p>		<p>IRON MOUNTAIN RANCH VILLAGE 7 UNIT 2</p>	
<p>DRAWN BY: J.P.</p>	<p>DESIGNED BY: RHS</p>	<p>CHECKED BY: RHN</p>	<p>PROJECT NO: 5920-2</p>
<p>DATE: DEC '01</p>	<p>DATE: DEC '01</p>	<p>DATE: DEC '01</p>	<p>SCALE: 1"=40' HORIZ. 1"=4' VERT.</p>
<p>PROFESSIONAL ENGINEER KENNETH M. NICHOLSON NO. 10539</p>		<p>PROFESSIONAL ENGINEER JOYCE L. TOYER NO. 11602</p>	
<p>SHEET SS4 22 OF 29 SHEETS</p>		<p>DRAWING NO. 3074-4604-7-2</p>	

Call before you Dig
1-800-227-2800

Call before you OVERHEAD
1-702-593-6111