

VILLAGE 7 - KEY MAP
NOT TO SCALE

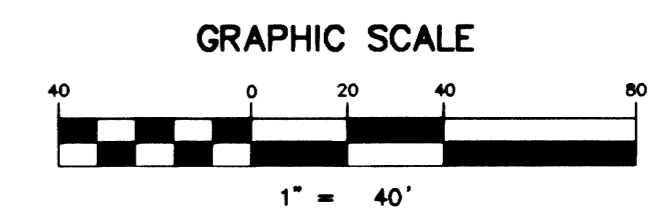

PROFILE SCALE:
HORIZ. 1" = 40'
VERT. 1" = 4'

HORSESHOE HILLS AVENUE
(PUBLIC)

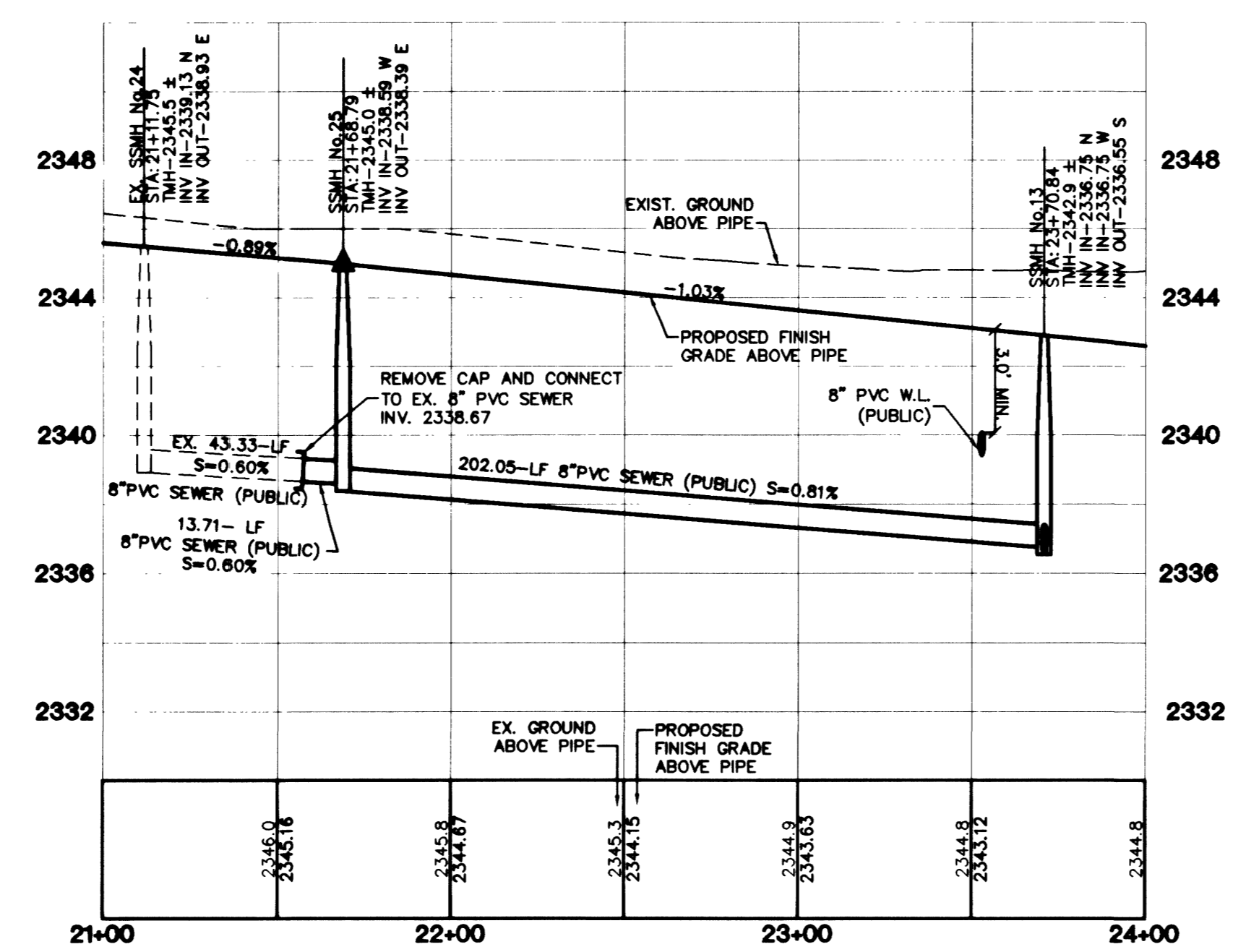

PROJECT BENCHMARK

PROJECT DATUM: NAVD88
CITY OF LAS VEGAS BENCHMARK 1LV90-13NES
NAVD88 ELEVATION: 710.9608 METERS (2332.54 FEET)
ONLY BM 413148, NAVD 88 ELEV=710.953 METERS (2332.52 FEET) 1" DIAMETER CONCRETE MONUMENT 77 FEET SOUTH & 54 FEET WEST OF N.E. CORNER SEC. 13T19R60E 10' EAST OF LARGE POWER POLE.

BASIS OF BEARINGS

THE BASIS OF BEARINGS FOR THIS PROJECT IS GRID NORTH AS DEFINED BY THE NEVADA COORDINATE SYSTEM OF 1983 (NCS83) EAST ZONE (2701) DETERMINED BY CLARK COUNTY GIS CONTROL POINTS 802, 803, 804, AND 805, AS SHOWN ON A RECORD OF SURVEY ON FILE IN THE CLARK COUNTY, NEVADA, RECORDER'S OFFICE, IN BOOK 88 OF SURVEYS, AT PAGE 53.

NOTE: CONTRACTOR SHALL VERIFY HORIZONTAL AND VERTICAL LOCATION OF EXISTING UTILITIES AND NOTIFY THE DESIGN ENGINEER IMMEDIATELY OF ANY DISCREPANCIES PRIOR TO CONSTRUCTION.

KB HOME
700 SOUTH RAINBOW BOULEVARD, LAS VEGAS, NEVADA 89146-5148
PH: (702) 875-7550 FAX (702) 365-2397
LAS VEGAS, NV 89118
(702) 814-2500

SEWER PLAN & PROFILE
HORSESHOE HILLS AVENUE
STA: 21+00.00 - 24+00.00
IRON MOUNTAIN RANCH
VILLAGE 7
UNIT 2

DRAWN BY:	DEC '01
DESIGNED BY:	DEC '01
CHECKED BY:	DEC '01
PROJECT NO:	SCALE: 1"=40' HORIZ. VERT.

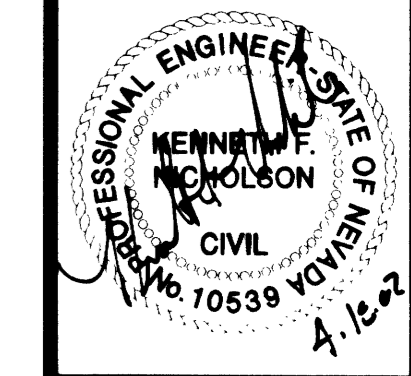

SHEET
SS8
28 OF 29 SHEETS
DRAWING NO.
3074-4604-7-2

Avoid cutting underground utility lines. If you do, call before you dig.
1-800-227-2800

Avoid overhead power line contact.
Call before you overhead.
1-702-593-6111