

ROCKY RAVINE AVENUE (PUBLIC)

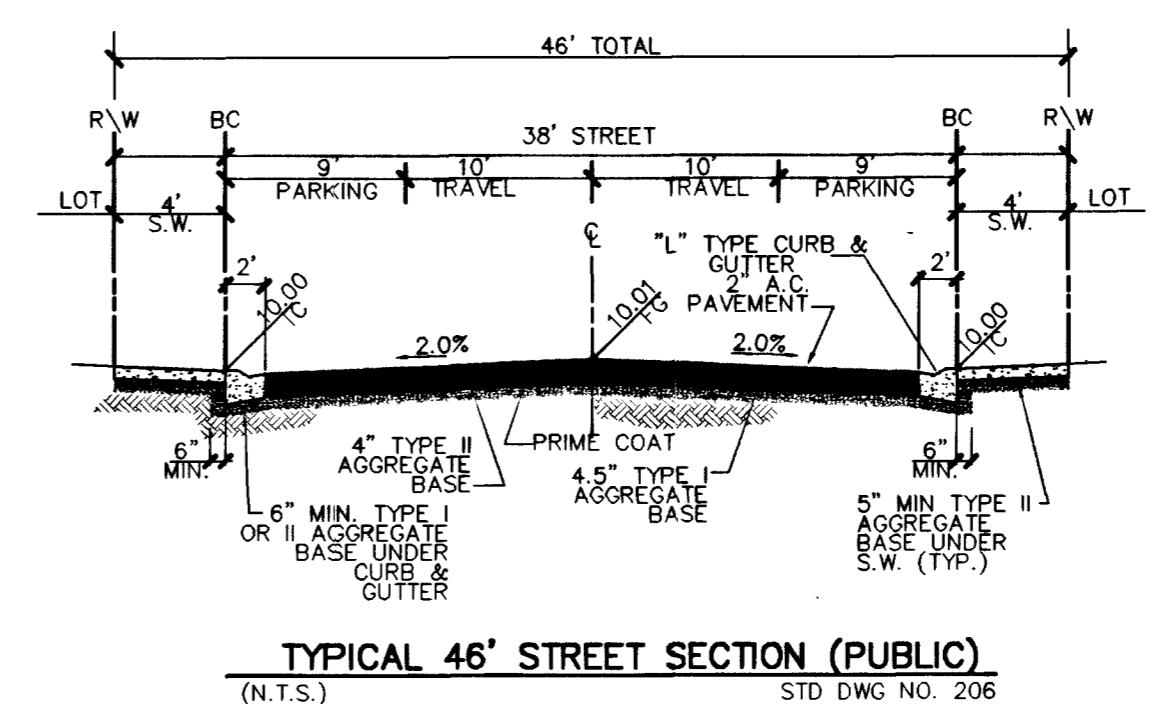
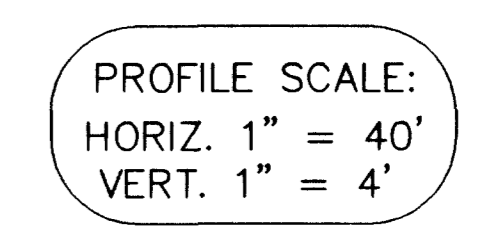
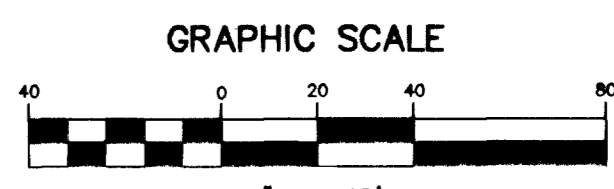
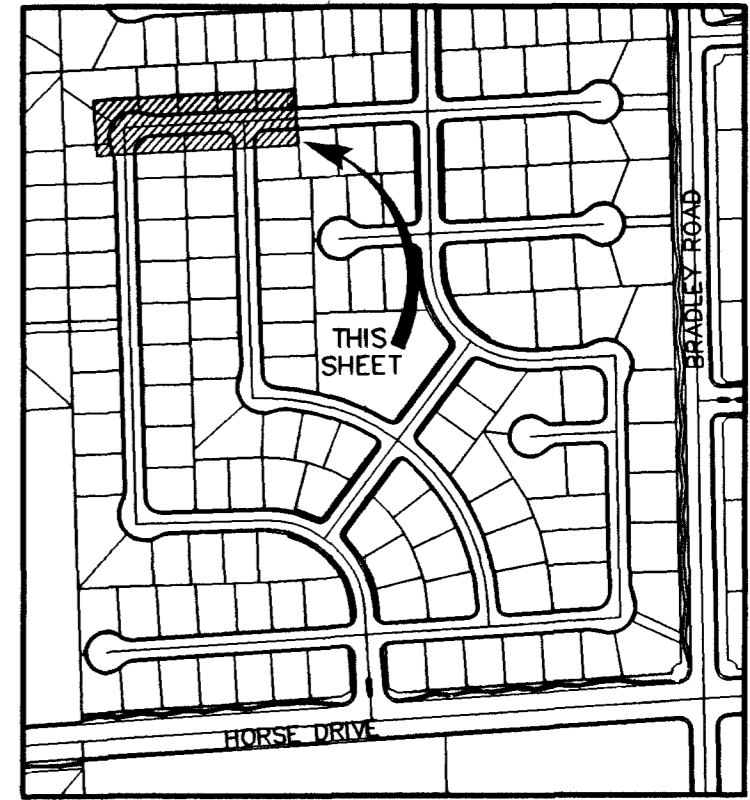
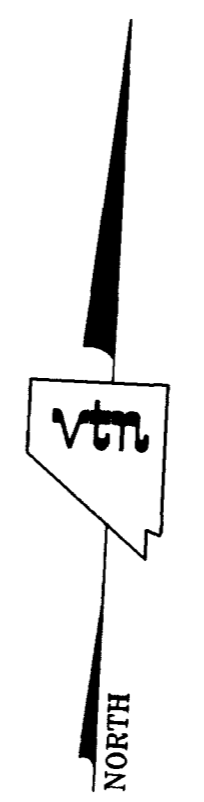

SIDEWALK RAMP TABLE
PER STD. DWG 235 CASE 1

NO.	DIM "A"	DIM "B"	CASE
1	8.0'	8.0'	I

CURVE TABLE

CURVE	LENGTH	RADIUS	DELTA	TANGENT
C1	30.98	20.00	88°45'10"	19.57
C2	31.85	20.00	91°14'50"	20.44
C3	52.67	34.00	88°45'10"	33.27
C4	23.64	54.00	28°02'15"	12.01
C5	126.09	52.00	138°55'40"	138.81
C6	23.64	54.00	28°02'15"	12.01
C7	50.90	34.00	85°46'16"	31.58
C8	84.01	471.00	10°13'11"	42.12
C9	23.64	54.00	28°02'15"	12.01
C10	123.63	52.00	138°28'14"	130.13
C11	26.67	54.00	28°17'42"	13.61
C12	56.71	433.00	7°30'12"	28.39
C13	53.41	34.00	90°00'00"	34.00
C14	28.07	54.00	29°46'54"	14.36
C15	135.74	52.00	149°33'48"	191.15
C16	28.07	54.00	29°46'54"	14.36
C17	62.24	213.00	16°17'02"	31.33
C18	51.44	181.00	16°17'02"	25.90
C19	26.50	34.00	44°39'01"	13.98
C20	190.36	40.50	269°18'02"	41.00
C21	26.50	34.00	44°39'01"	13.98

DISCLAIMER NOTE
UTILITY LOCATIONS SHOWN HEREON ARE APPROXIMATE ONLY. IT SHALL BE THE CONTRACTOR'S RESPONSIBILITY TO DETERMINE THE EXACT HORIZONTAL AND VERTICAL LOCATION OF ALL EXISTING UNDERGROUND AND OVERHEAD UTILITIES PRIOR TO COMMENCING CONSTRUCTION. NO REPRESENTATION IS MADE THAT ALL EXISTING UTILITIES ARE SHOWN HEREON. THE ENGINEER ASSUMES NO RESPONSIBILITY FOR UTILITIES NOT SHOWN OR UTILITIES NOT SHOWN IN THEIR PROPER LOCATION.

- CONSTRUCTION NOTES**
- (A) CONSTRUCT "L" CURB & GUTTER PER STD. # 216
 - (B) CONSTRUCT SIDEWALK PER STD. # 234
 - (C) CONSTRUCT CROSS GUTTER PER STD. # 228
 - (D) CONSTRUCT SIDEWALK RAMP PER STD. # 235
 - (E) CONSTRUCT SIDEWALK DRAIN PER STD. # 236
 - (F) SAW-CUT & MATCH EXIST. A.C.
 - (G) CONSTRUCT "A" TYPE ISLAND CURB PER STD. # 219

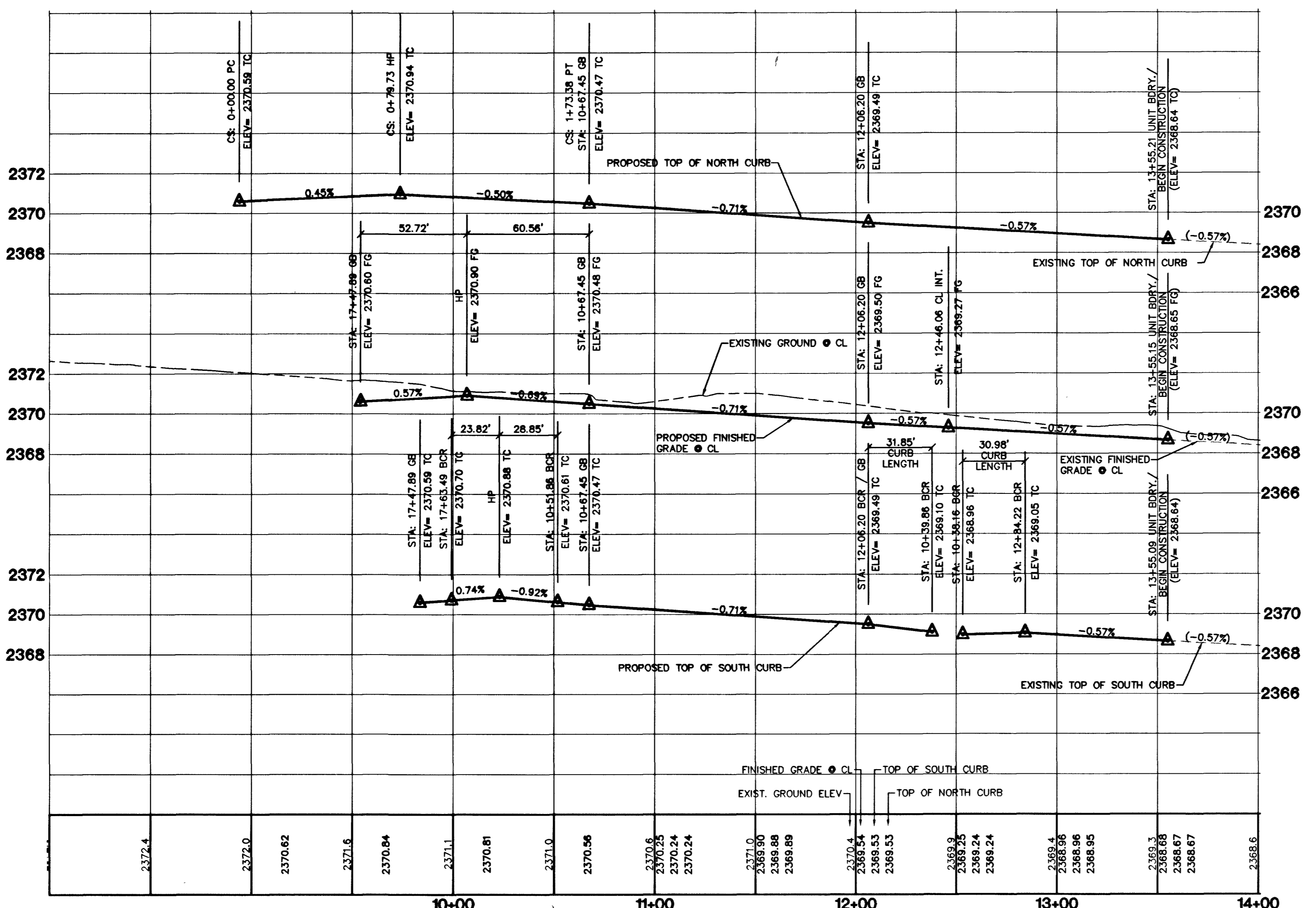

PROJECT BENCHMARK
PROJECT DATUM: NAVD88
(OLD) CITY OF LAS VEGAS BENCHMARK 1LV90-13NES NAVD88 ELEVATION: 710.9608 METERS (2332.54 FEET)
PROJECT DESIGNED USING OLD BENCHMARK
(NEW) CITY OF LAS VEGAS BENCHMARK 1LV90-13NES NAVD88 ELEVATION: 710.9181 METERS (2332.40 FEET)
(-0.14 FEET) TO GET NEW PUBLISHED DATUM

ONLY BM 413148, NAVD 88 ELEV=710.953 METERS (2332.52 FEET) 1" DIAMETER CONCRETE MONUMENT 77 FEET SOUTH & 54 FEET WEST OF N.E. CORNER SEC. 13T19S06E 10' EAST OF LARGE POWER POLE.

BASIS OF BEARINGS
THE BASIS OF BEARINGS FOR THIS PROJECT IS GRID NORTH AS DEFINED BY THE NEVADA COORDINATE SYSTEM OF 1983 (NCS83), EAST ZONE, (2701) DETERMINED BY CLARK COUNTY GIS CONTROL POINTS 807, 803, 804, AND 805, AS SHOWN ON A RECORD OF SURVEY ON FILE IN THE CLARK COUNTY, NEVADA, RECORDER'S OFFICE, IN BOOK 88 OF SURVEYS, AT PAGE 53.

Call before you Overhead
1-702-593-6111

Call before you Dig
1-800-227-2600

CITY OF LAS VEGAS
2727 SOUTH RAINBOW BOULEVARD LAS VEGAS, NEVADA 89146-5148
PH. (702) 873-7550 FAX (702) 362-2597
neveda CONSULTING ENGINEERS & PLANNERS • LAND SURVEYORS

KB HOME
750 PILOT ROAD, SUITE F
LAS VEGAS, NV 89119
(702) 814-2500

STREET PLAN & PROFILE
ROCKY RAVINE AVENUE
STA: 10+00.00 - 13+56.21

IRON MOUNTAIN RANCH
VILLAGE 6
UNIT 2

DRAWN BY: MAR. 02
DESIGNED BY: MAR. 02
CHECKED BY: MAR. 02
PROJECT NO. 5974-2
SCALE: 1" = 40' HORIZ.
1" = 8' VERT.

EXPIRES 12-31-03
SHEET
ST1
11 OF 25 SHEETS
DRAWING NO.
1074-4604-6-2

50183 51645