

APN# 125-12-202-001

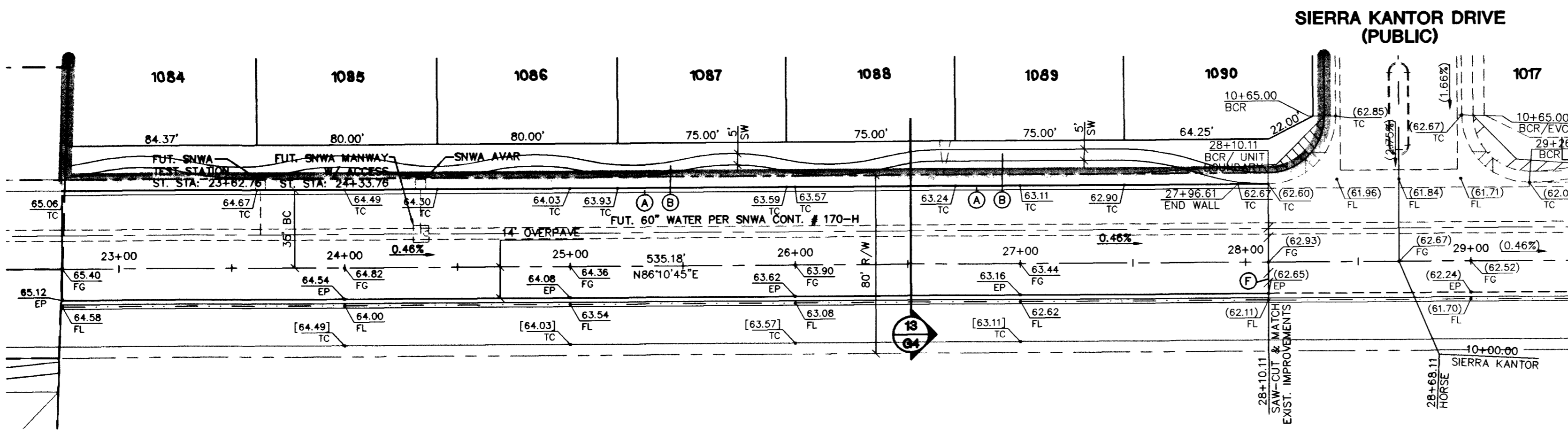

EXISTING IRON MOUNTAIN RANCH VILLAGE 6 - UNIT 1  
REFER TO IMPROVEMENT PLANS PER VTN NEVADA  
CLV DWG # 1071-4604-6-1

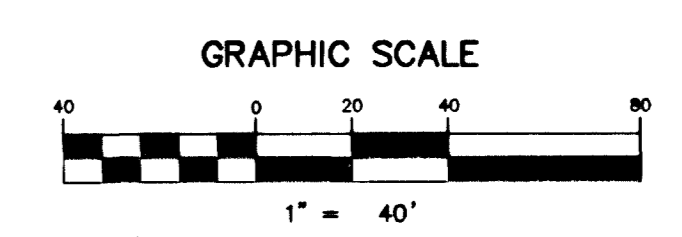
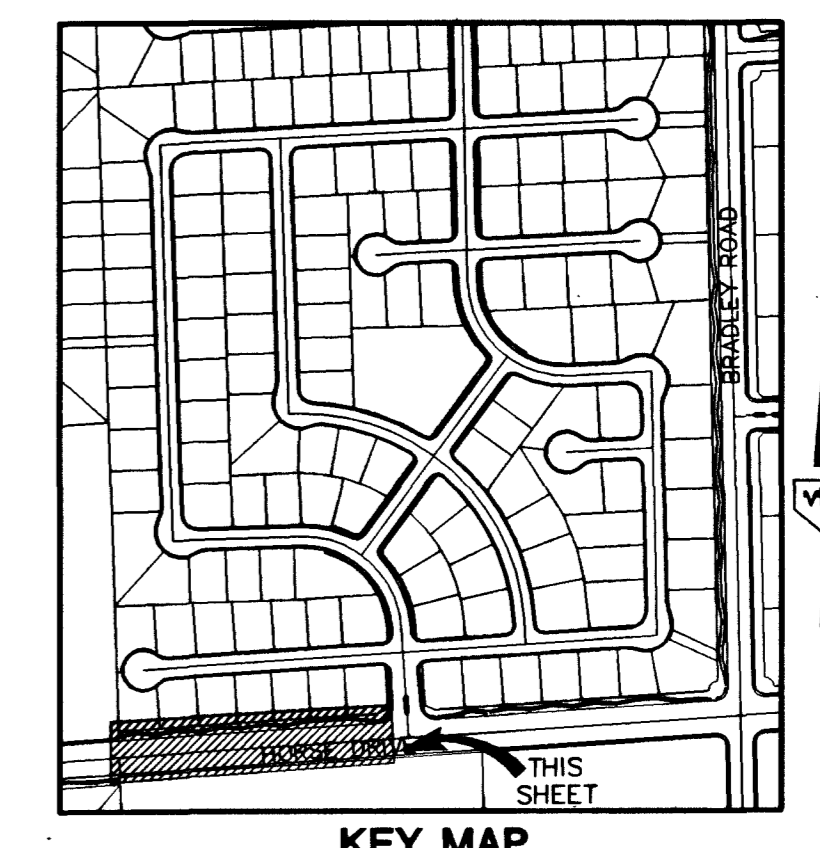
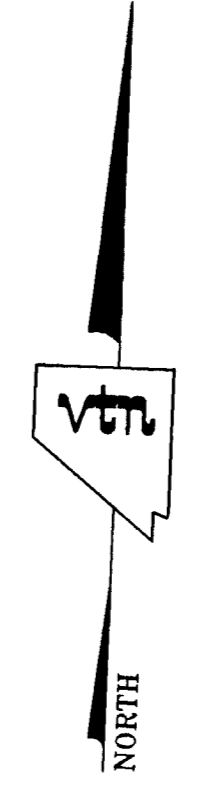

PROFILE SCALE:  
HORIZ. 1" = 40'  
VERT. 1" = 4'

**SIDEWALK RAMPS TABLE**  
PER STD. DWG 235 CASE 1

NO.	DIM "A"	DIM "B"	CASE
1	8.0'	8.0'	I

**CURVE TABLE**

CURVE	LENGTH	RADIUS	DELTA	TANGENT
C1	30.98	20.00	88°45'10"	19.57
C2	31.85	20.00	91°14'50"	20.44
C3	52.67	34.00	88°45'07"	33.27
C4	23.64	54.00	25°05'15"	12.01
C5	126.09	52.00	138°55'40"	138.81
C6	23.64	54.00	25°05'15"	12.01
C7	50.90	34.00	85°46'16"	31.58
C8	84.01	47.00	101°31'11"	42.12
C9	23.64	54.00	25°05'15"	12.01
C10	123.83	52.00	138°55'40"	130.13
C11	26.67	54.00	28°17'42"	13.61
C12	56.71	43.00	73°01'12"	28.39
C13	53.41	34.00	90°00'00"	34.00
C14	28.07	54.00	29°46'54"	14.36
C15	135.74	52.00	149°33'48"	191.13
C16	28.07	54.00	29°46'54"	14.36
C17	62.24	219.00	161°7'02"	31.33
C18	51.44	181.00	161°7'02"	25.90
C19	26.50	34.00	44°39'01"	13.96
C20	190.36	40.50	269°18'02"	41.00
C21	26.50	34.00	44°39'01"	13.96

**DISCLAIMER NOTE**  
UTILITY LOCATIONS SHOWN HEREON ARE APPROXIMATE ONLY. IT SHALL BE THE CONTRACTOR'S RESPONSIBILITY TO DETERMINE THE EXACT HORIZONTAL AND VERTICAL LOCATION OF ALL EXISTING UNDERGROUND AND OVERHEAD UTILITIES PRIOR TO COMMENCING CONSTRUCTION. NO REPRESENTATION IS MADE THAT ALL EXISTING UTILITIES ARE SHOWN HEREON. THE ENGINEER ASSUMES NO RESPONSIBILITY FOR UTILITIES NOT SHOWN OR UTILITIES NOT SHOWN IN THEIR PROPER LOCATION.

**CONSTRUCTION NOTES**

- (A) CONSTRUCT "L" CURB & GUTTER PER STD. # 216
- (B) CONSTRUCT SIDEWALK PER STD. # 234
- (C) CONSTRUCT CROSS GUTTER PER STD. # 228
- (D) CONSTRUCT SIDEWALK RAMP PER STD. # 235
- (E) CONSTRUCT SIDEWALK DRAIN PER STD. # 236
- (F) SAW-CUT & MATCH EXIST. A.C.
- (G) CONSTRUCT "A" TYPE ISLAND CURB PER STD. # 219

**HORSE DRIVE (PUBLIC)**

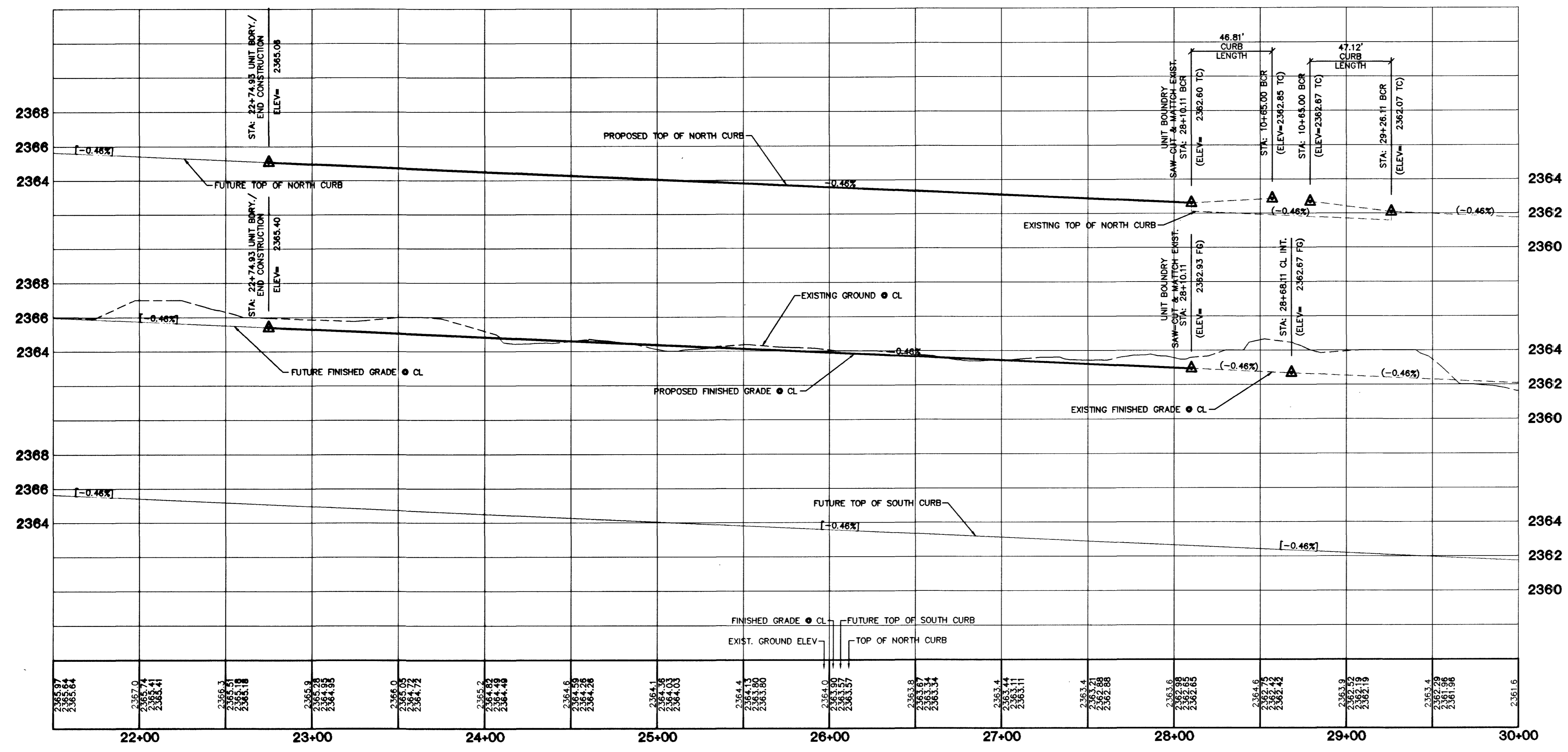

**PROJECT BENCHMARK**

PROJECT DATUM: NAVD88  
(OLD) CITY OF LAS VEGAS BENCHMARK 1LV90-13NES  
NAVD88 ELEVATION: 710.9608 METERS (2332.54 FEET)  
PROJECT DESIGNED USING OLD BENCHMARK  
(NEW) CITY OF LAS VEGAS BENCHMARK 1LV90-13NES  
NAVD88 ELEVATION: 710.9181 METERS (2332.40 FEET)  
(-0.14 FEET) TO GET NEW PUBLISHED DATUM  
ONLY BM 413148, NAVD 88 ELEV=710.953  
METERS (2332.52 FEET) 1.5 DIAMETER CONCRETE MONUMENT  
77 FEET SOUTH & 54 FEET WEST OF N.E. CORNER  
SEC. 13T19R60E TO EAST OF LARGE POWER POLE.

**BASIS OF BEARINGS**

THE BASIS OF BEARINGS FOR THIS PROJECT IS GRID NORTH AS DEFINED BY THE NEVADA COORDINATE SYSTEM OF 1983 (NCS83), EAST ZONE (2701) DETERMINED BY CLARK COUNTY GIS CONTROL POINTS 802, 803, 804 AND 805, AS SHOWN ON A RECORD OF SURVEY ON FILE IN THE CLARK COUNTY, NEVADA RECORDER'S OFFICE, IN BOOK 88 OF SURVEYS, AT PAGE 53.

Avoid overhead cover the contact. It's costly.  
**Call before you Overhead**  
1-702-593-6111

Avoid cutting underground utility lines. It's costly.  
**Call before you Dig**  
1-800-227-2600

7	6	5	4	3	2	1
REV	DATE	BY	DATE	BY	DATE	BY

**CITY OF LAS VEGAS**

**KB HOME**  
750 PILOT ROAD, SUITE F  
LAS VEGAS, NV 89119  
(702) 614-5500

**STREET PLAN & PROFILE**  
**HORSE DRIVE**  
STA: 22+74.93 - 28+10.11

**IRON MOUNTAIN RANCH**  
**VILLAGE 6**  
**UNIT 2**

2227 SOUTH RAINBOW BOULEVARD LAS VEGAS, NEVADA 89146-5148  
PH. (702) 873-7500 FAX (702) 362-2597

**VTN nevada**  
CONSULTING ENGINEERS • PLANNERS • LAND SURVEYORS

DRAWN BY: MAR '02  
M.C.D.  
DESIGNED BY: MAR '02  
R.M.S.  
CHECKED BY: MAR '02  
KFN  
PROJECT NO: 5974-2  
SCALE: 1"=40' HORIZ.  
1"=4' VERT.

**PROFESSIONAL ENGINEER**  
KENNETH W. DOUGLASS  
CIVIL  
NO. 10539  
EXPIRES 12-31-03

SHEET  
**ST7**  
17 OF 25 SHEETS  
DRAWING NO.  
1071-4604-6-2

5048

I:\S407\VILLAGE6\UNIT2\5974ST02.DWG (ST7)