

PROFILE SCALE:  
HORIZ. 1" = 40'  
VERT. 1" = 4'

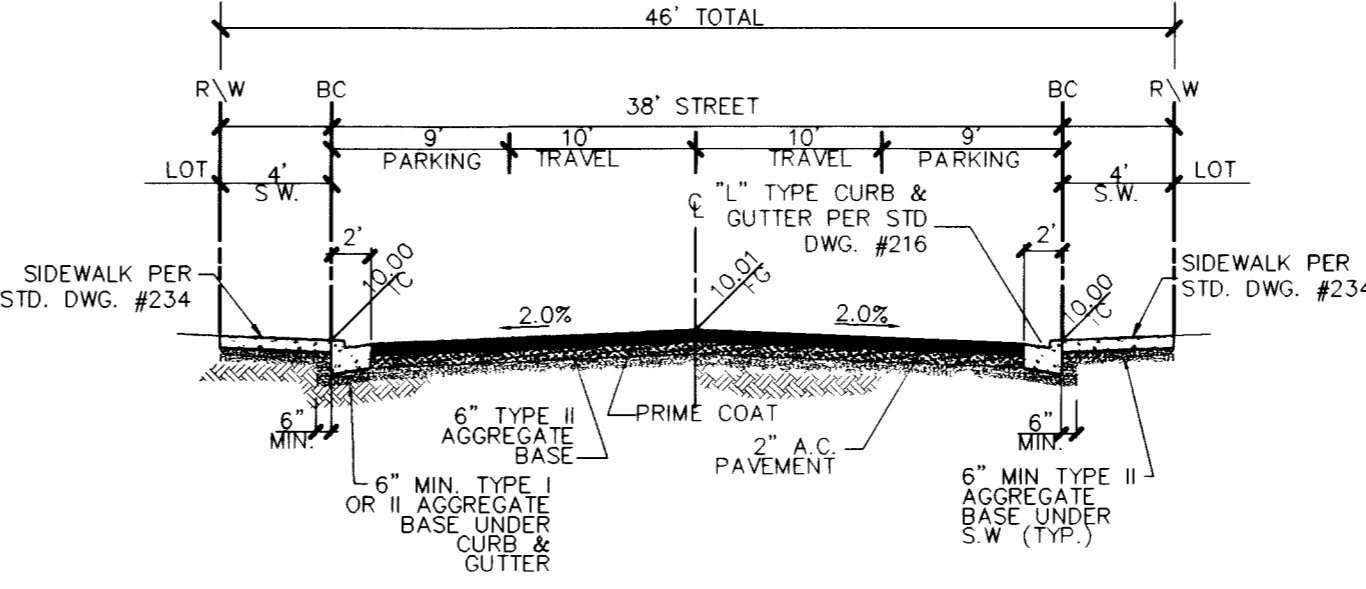
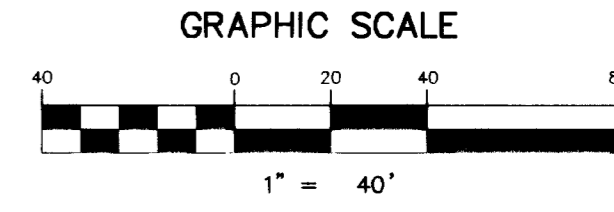

TYPICAL 46' STREET SECTION (PUBLIC)  
(N.T.S.) STD DWG NO. 206

**SIDEWALK RAMP TABLE**  
PER STD. DWG 235 CASE

NO.	DIM "A"	DIM "B"	CASE
1	8.0'	8.0'	I

CURVE TABLE				CURVE TABLE					
CURVE	LENGTH	RADIUS	DELTA	TANGENT	CURVE	LENGTH	RADIUS	DELTA	TANGENT
C1	30.78	20.00	88°10'18"	19.37	C30	26.50	34.00	44°39'01"	13.96
C2	32.05	20.00	91°49'42"	20.65	C31	32.05	20.00	91°49'42"	20.65
C3	32.05	20.00	91°49'42"	20.65	C32	51.85	34.00	87°22'57"	32.48
C4	30.78	20.00	88°10'18"	19.37	C33	23.64	54.00	25°05'15"	12.01
C5	26.50	34.00	44°39'01"	13.96	C34	124.84	52.00	137°33'28"	133.92
C6	190.36	40.50	269°18'02"	41.00	C35	23.64	54.00	25°05'15"	12.01
C7	26.50	34.00	44°39'01"	13.96	C36	31.42	20.00	90°00'00"	20.00
C8	30.78	20.00	88°10'18"	19.37	C37	31.42	20.00	90°00'00"	20.00
C9	26.50	34.00	44°39'01"	13.96	C38	372.44	471.00	45°18'20"	196.57
C10	190.36	40.50	269°18'02"	41.00	C39	335.87	433.00	44°26'34"	176.89
C11	26.50	34.00	44°39'01"	13.96	C40	29.83	20.00	85°26'39"	18.47
C12	32.05	20.00	91°49'42"	20.65	C41	33.31	20.00	95°25'07"	21.99
C13	32.05	20.00	91°49'42"	20.65	C42	29.83	20.00	85°26'39"	18.47
C14	30.78	20.00	88°10'20"	19.37	C43	33.31	20.00	95°25'07"	21.99
C15	26.50	34.00	44°39'01"	13.96	C44	156.99	471.00	19°05'51"	79.23
C16	190.36	40.50	269°18'02"	41.00	C45	137.81	433.00	18°14'05"	69.49
C17	26.50	34.00	44°39'01"	13.96	C46	47.50	219.00	12°25'35"	23.84
C18	164.69	219.00	43°05'15"	86.46	C47	28.14	20.00	80°36'31"	16.96
C19	28.14	20.00	80°36'31"	16.96	C48	28.14	20.00	80°36'31"	16.96
C20	280.09	181.00	91°49'42"	186.87	C49	154.69	219.00	40°28'12"	80.73
C21	28.14	20.00	80°36'31"	16.96	C50	226.44	181.00	71°40'46"	130.73
C22	114.51	219.00	29°57'28"	58.59	C51	31.42	20.00	90°00'00"	20.00
C23	28.07	54.00	29°46'54"	14.36	C52	31.42	20.00	90°00'00"	20.00
C24	137.40	52.00	151°23'30"	203.94	C53	34.49	20.00	98°47'51"	23.33
C25	28.07	54.00	29°46'54"	14.36	C54	34.49	20.00	98°47'51"	23.33
C26	54.49	34.00	91°49'42"	35.10	C55	23.03	150.00	8°47'51"	11.54
C27	30.78	20.00	88°10'18"	19.37	C56	23.03	150.00	8°47'51"	11.54
C28	26.50	34.00	44°39'01"	13.96	C57	47.12	30.00	90°00'00"	30.00
C29	190.36	40.50	269°18'02"	41.00	C58	47.12	30.00	90°00'00"	30.00

**BENCHMARK**  
PROJECT DATUM: NAVD88  
CITY OF LAS VEGAS BENCHMARK 1LV90-13NES  
NAVD88 ELEVATION: 710.9181 METERS (2332.40 FEET)  
ONLY BM 413148, DECATUR BLVD & GRAND TETON DRIVE  
100' SW OF SECTION CORNER, NEXT TO METAL POWER POLE

**BASIS OF BEARINGS**  
THE BASIS OF BEARINGS FOR THIS PROJECT IS GRID NORTH AS DEFINED BY THE NEVADA COORDINATE SYSTEM OF 1983 (NCS83), EAST ZONE, (2701), DETERMINED BY CLARK COUNTY GIS CONTROL POINTS 802, 803, 804, AND 805, AS SHOWN ON A RECORD OF SURVEY ON FILE IN THE CLARK COUNTY, NEVADA, RECORDER'S OFFICE, IN BOOK 88 OF SURVEYS, AT PAGE 53.

- CONSTRUCTION NOTES**
- (A) CONSTRUCT "L" CURB & GUTTER PER STD. # 216
  - (B) CONSTRUCT SIDEWALK PER STD. # 234
  - (C) CONSTRUCT CROSS GUTTER PER STD. # 228
  - (D) CONSTRUCT SIDEWALK RAMP PER STD. # 235
  - (E) CONSTRUCT SIDEWALK DRAIN PER STD. # 236
  - (F) CUT & MATCH EXIST. A.C.
  - (G) CONSTRUCT "A" TYPE ISLAND CURB PER STD. # 219

**DISCLAIMER NOTE**  
UTILITY LOCATIONS SHOWN HEREON ARE APPROXIMATE ONLY. IT SHALL BE THE CONTRACTOR'S RESPONSIBILITY TO DETERMINE THE EXACT HORIZONTAL AND VERTICAL LOCATION OF ALL EXISTING UNDERGROUND AND OVERHEAD UTILITIES PRIOR TO COMMENCING CONSTRUCTION. NO REPRESENTATION IS MADE THAT ALL EXISTING UTILITIES ARE SHOWN HEREON. THE ENGINEER ASSUMES NO RESPONSIBILITY FOR UTILITIES NOT SHOWN OR UTILITIES NOT SHOWN IN THEIR PROPER LOCATION.

Avoid cutting underground utility lines. It's costly.  
**Call before you Dig**  
1-800-227-2600

Avoid overhead power line contact. It's costly.  
**Call before you Overhead**  
1-702-593-6111

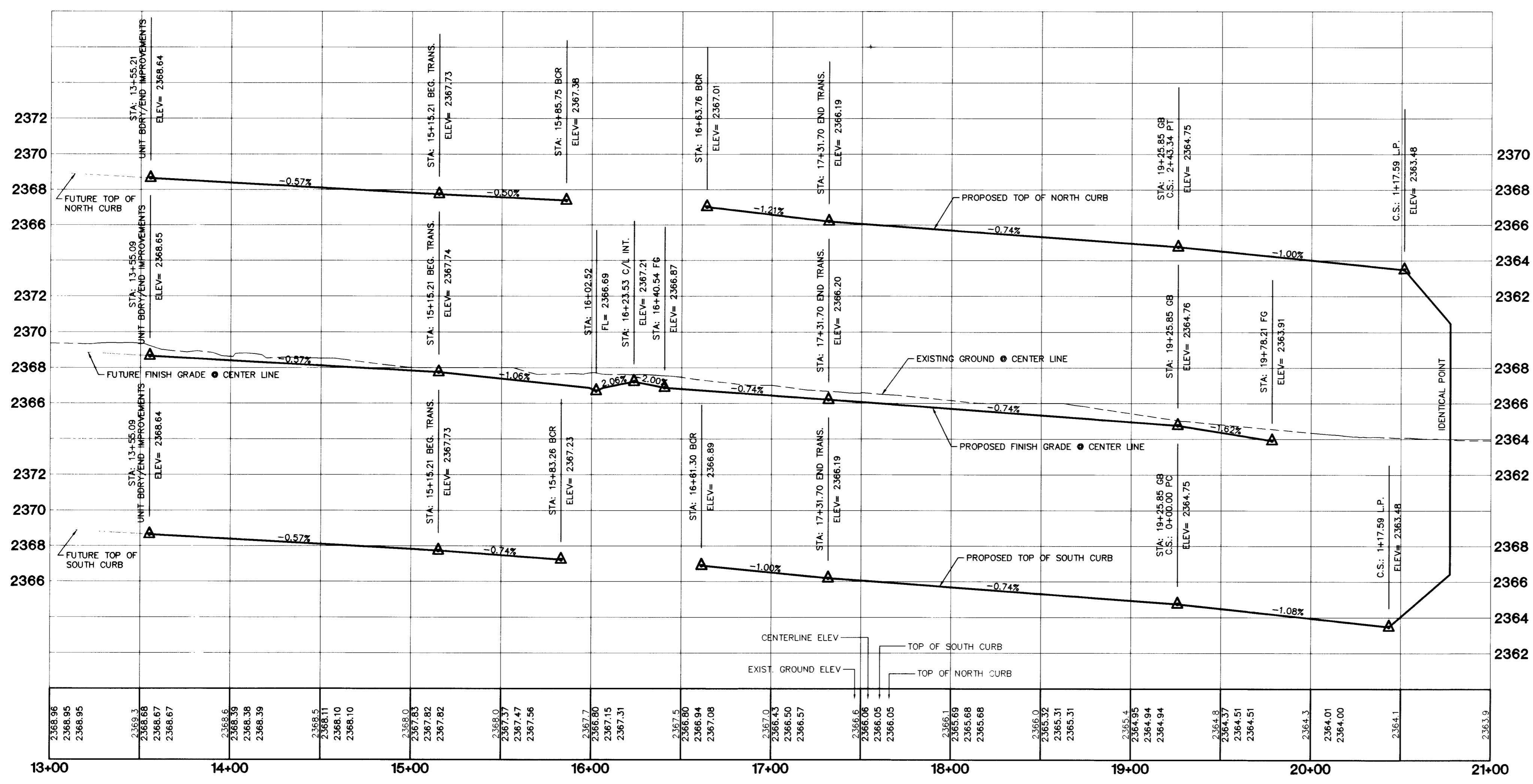

7	6	5	4	3	2	1	
REV	DATE	BY	REVISION				

**CITY OF LAS VEGAS**  
2727 SOUTH RAINBOW BOULEVARD LAS VEGAS, NEVADA 89146-5148  
PH. (702) 873-7550 FAX (702) 362-2597  
neveda CONSULTING ENGINEERS • PLANNERS • LAND SURVEYORS

**KB HOME**  
750 PILOT ROAD, SUITE F  
LAS VEGAS, NV 89119  
(702) 914-2500

**STREET PLAN & PROFILE**  
**ROCKY RAVINE AVENUE**  
STA: 13+55.09 - 19+78.21

**IRON MOUNTAIN RANCH**  
**VILLAGE 6**  
**UNIT 1**

DRAWN BY: \_\_\_\_\_ JAN. '02  
R.M.S.  
DESIGNED BY: \_\_\_\_\_ JAN. '02  
R.M.S.  
CHECKED BY: \_\_\_\_\_ JAN. '02  
R.M.S.  
PROJECT NO.: \_\_\_\_\_  
5974-1  
SCALE: 1"=40' HORIZ.  
1"=4' VERT.

**PROFESSIONAL ENGINEER**  
KENNETH R. MOULSON  
CIVIL  
NO. 10539  
EXPIRES 12-31-03

SHEET  
**S15**  
24 OF 39 SHEETS  
DRAWING NO.  
1074-4604-4-1

46598