

MATCHLINE - SEE SHEET UT1 FOR CONTINUATION

**EXISTING IRON MOUNTAIN RANCH VILLAGE 7 UNIT 3**  
REFER TO PLANS PER VTN NV  
CLV # 307Y-4604-7-3

**EXISTING IRON MOUNTAIN RANCH VILLAGE 5 UNIT 2**  
CLV # 307Y-4604-5-2

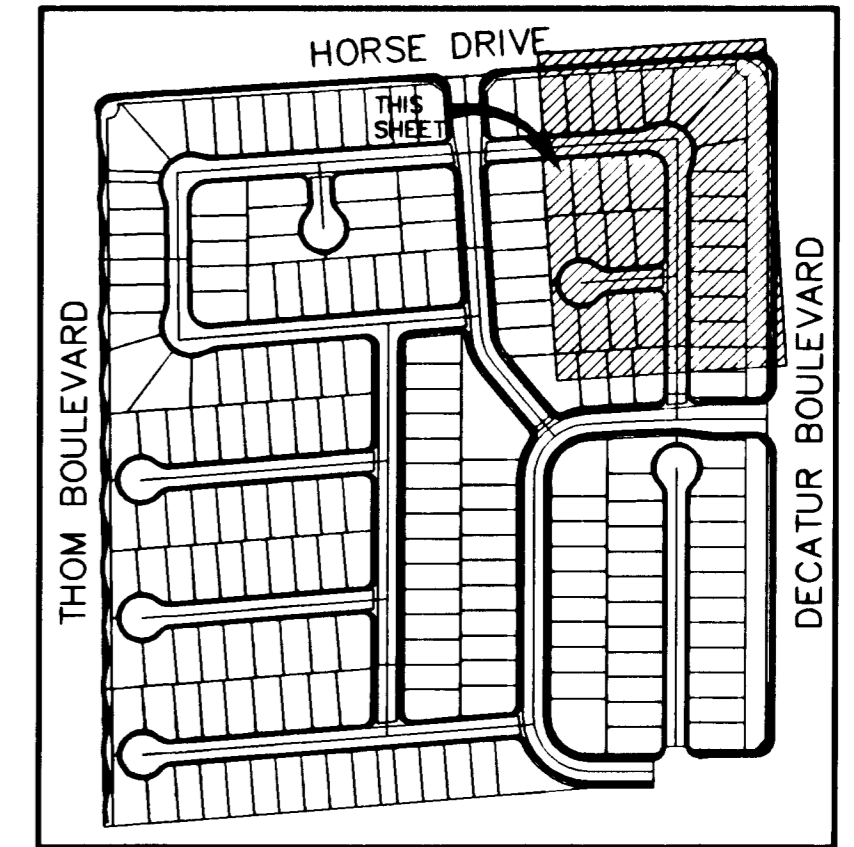

**VILLAGE 5 - KEY MAP**  
NOT TO SCALE

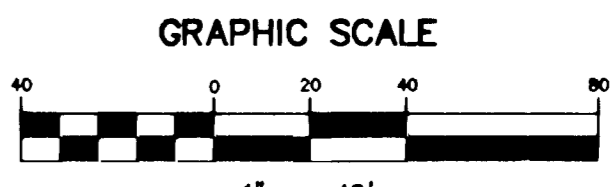

**LEGEND**

- WATER**
- ① FIRE HYDRANT ASSEMBLY (PER UDACS PLATE No. 7)
  - ② 8" GATE VALVE
  - ③ 8" x 6" TEE
  - ④ 8" 45° ELBOW
  - ⑤ 8" 22.5° ELBOW
  - ⑥ 8" GATE VALVE
  - ⑦ 8" 90° ELBOW
  - ⑧ CAP ONLY (PER UDACS PLATE No. 4)
  - ⑨ CAP W/ 2" B.O. ASSEMBLY (PER UDACS PLATE No. 4)
  - ⑩ 8" x 6" REDUCE
  - ⑪ W/ 5/8" METER (PER UDACS PLATE 1D)
  - ⑫ 3/4" METER (PER UDACS PLATE 1D)
  - ⑬ 8" WATER MAIN
- SEWER**
- ⑭ STANDARD MANHOLE (PUBLIC)
  - ⑮ 4" SEWER LATERALS (PRIVATE)
  - ⑯ 4" SEWER WYES (PRIVATE)
  - ⑰ (BWV) BACKWATER VALVES (PRIVATE)
  - ⑱ 8" SEWER MAIN (PUBLIC)

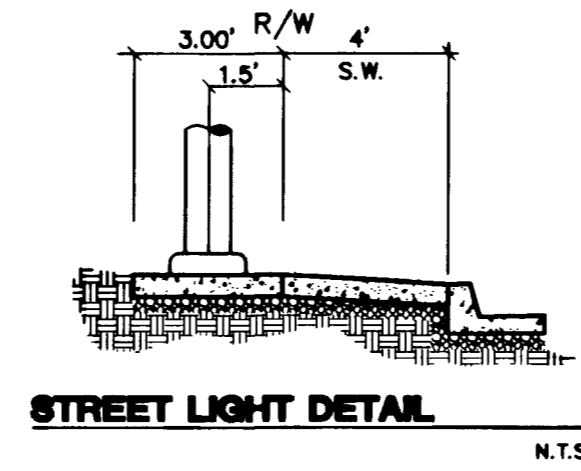

**STREET LIGHT DETAIL**  
N.T.S.

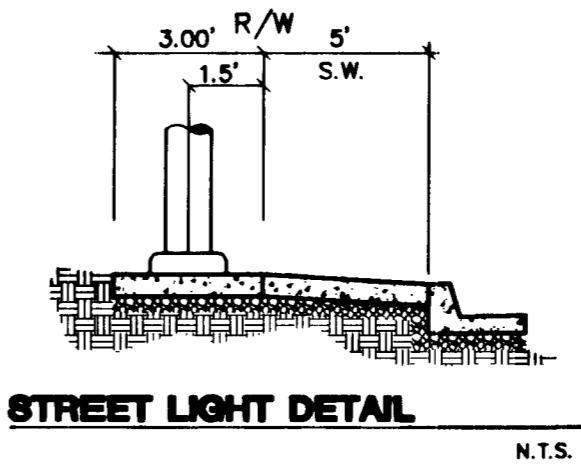

**STREET LIGHT DETAIL**  
N.T.S.

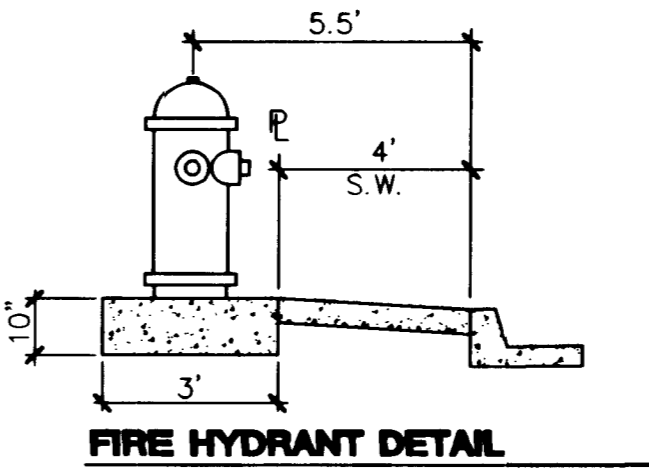

**FIRE HYDRANT DETAIL**

**SNWA CONSTRUCTION NOTES.**  
CONTRACTOR SHALL FIELD LOCATE AND PROTECT ALL SNWA/SNWS APPURTENANCES INCLUDING, BUT NOT LIMITED TO AV/AR, ACCESS MANWAYS AND CATHODIC PROTECTION SYSTEMS. ALL ABOVE GROUND STRUCTURES AND AT GRADE STRUCTURES MUST BE ADJUSTED TO NEW GRADE AT CONTRACTOR'S EXPENSE. CATHODIC PROTECTION TEST STATIONS, RECTIFIERS, AND AV/AR'S MUST BE RELOCATED TO THE SIDEWALK PER SNWA STANDARDS AND AT THE CONTRACTOR'S EXPENSE. CONTRACTOR TO NOTIFY SOUTHERN NEVADA WATER AUTHORITY, DEVELOPMENT PLAN REVIEW, AT (702) 862-3444 AT LEAST 48 HOURS PRIOR TO CONSTRUCTION ACTIVITY.

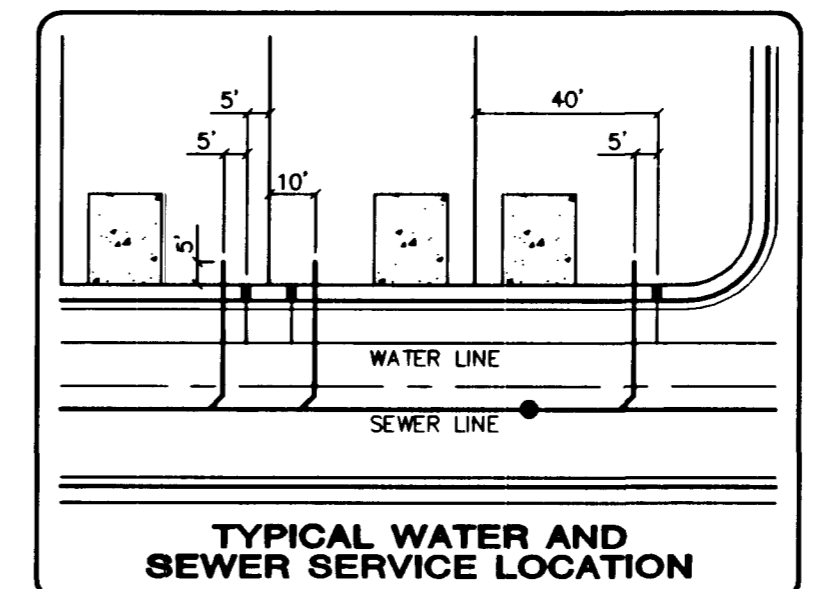

**TYPICAL WATER AND SEWER SERVICE LOCATION**

**DISCLAIMER NOTE**  
UTILITY LOCATIONS SHOWN HEREON ARE APPROXIMATE ONLY. IT SHALL BE THE CONTRACTOR'S RESPONSIBILITY TO DETERMINE THE EXACT HORIZONTAL AND VERTICAL LOCATION OF ALL EXISTING UNDERGROUND AND OVERHEAD UTILITIES PRIOR TO COMMENCING CONSTRUCTION. NO REPRESENTATION IS MADE THAT ALL EXISTING UTILITIES ARE SHOWN HEREON. THE ENGINEER ASSUMES NO RESPONSIBILITY FOR UTILITIES NOT SHOWN OR UTILITIES NOT SHOWN IN THEIR PROPER LOCATION.

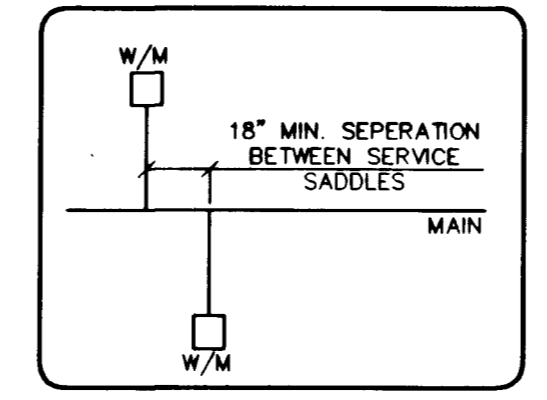

Call before you Dig  
1-800-227-2600

Call before you Overhead  
1-702-593-6111

- STREET LIGHT & SIGNAGE**
- ① 70 WATT H.P.S. (PUBLIC) SUMMERLIN TYPE SC POLES WITH 8.0' ARMS
  - ② 150 WATT H.P.S. (PUBLIC) SUMMERLIN TYPE 2B POLES WITH 8.0' ARMS
  - ③ 1 1/4" ST. LT. CONDUIT
  - ④ 3 1/2" PULLBOX (PUBLIC)
  - ⑤ R1-1 "STOP" SIGN & (2) D3 "STREET NAME" SIGNS
  - ⑥ DRIVEWAY LOCATION (SCHEMATIC)
  - ⑦ POINT OF CONNECTION

**LAS VEGAS FIRE DEPARTMENT**  
FIRE FLOW REQUIREMENT IS 1,500 GALLONS/MIN. AT 20 LBS./SQ.IN. RESIDUAL.  
BASED ON:  
SQUARE FOOTAGE: 2600  
LARGEST AREA BETWEEN SEPERATION WALLS:  
HEIGHT: 2 STORY  
TYPE OF CONSTRUCTION:  
EXPOSURES: 10' MIN.  
SPRINKLER SYSTEM: NONE  
OCCUPANCY: SINGLE FAMILY RESIDENCE  
ROOF CONSTRUCTION: CONCRETE TILE  
REVIEWED BY: [Signature]  
DATE: 12/8/02  
PROJECT NO.: 5918-3  
PROVIDE FIRE LANE IDENTIFICATION PER CITY ORD. 3677

**APPROVAL:**

[Signature] 11/14/03 DATE  
LAS VEGAS VALLEY WATER DISTRICT  
[Signature] 12/8/02 DATE  
CITY OF LAS VEGAS FIRE MARSHAL

NEVADA POWER COMPANY DATE  
NEVADA POWER COMPANY APPROVAL IS ONLY FOR THE PLACEMENT AND CLEARANCE OF STREET LIGHT AND SIGNAL LIGHT INSTALLATION. AND CLEARANCE OF STREET LIGHT AND SIGNAL LIGHT INSTALLATION.

**BASIS OF BEARINGS**  
THE BASIS OF BEARINGS FOR THIS PROJECT IS GRID NORTH AS DEFINED BY THE NEVADA COORDINATE SYSTEM OF 1983 (NCSB), EAST ZONE (2701) DETERMINED BY CLARK COUNTY GIS CONTROL POINTS 802, 803, 804, AND 805, AS SHOWN ON A RECORD OF SURVEY ON FILE WITH THE CLARK COUNTY, NEVADA, RECORDER'S OFFICE, IN BOOK 88 OF SURVEYS, AT PAGE 53.

**PROJECT BENCHMARK**  
PROJECT DATUM: NAVD88  
(OLD) CITY OF LAS VEGAS BENCHMARK 1LV90-13NES, NAVD88 ELEVATION: 710.9608 METERS (2332.54 FEET) PROJECT DESIGNED USING OLD BENCHMARK  
(NEW) CITY OF LAS VEGAS BENCHMARK 1LV90-13NES, NAVD88 ELEVATION: 710.9181 METERS (2332.40 FEET) (-0.14 FEET) TO GET NEW PUBLISHED DATUM  
ONLY BM 413148, NAVD 88 ELEV=710.953 METERS (2332.52 FEET) 1/2" DIAMETER CONCRETE MONUMENT 77 FEET SOUTH & 54 FEET WEST OF N.E. CORNER SEC. 13T19R80E TO EAST OF LARGE POWER POLE.

7	6	5	4	3	2	1
DATE	BY	REVISION				
<p><b>KB HOME</b> 750 PILOT ROAD, SUITE F LAS VEGAS, NV 89119 (702) 914-2500</p> <p><b>CITY OF LAS VEGAS</b> 2727 SOUTH RAINBOW BOULEVARD LAS VEGAS, NEVADA 89146-5148 PH. (702) 873-7550 FAX (702) 362-2597 nevaada CONSULTING ENGINEERS PLANNERS LAND SURVEYORS</p> <p><b>MASTER UTILITY PLAN &amp; STREETLIGHT PLAN</b> <b>IRON MOUNTAIN RANCH VILLAGE 5 UNIT 3</b></p> <p>DESIGNED BY: [Signature] DATE: 11/14/03 CHECKED BY: [Signature] DATE: 12/8/02 PROJECT NO.: 5918-3 SCALE: 1"=40' HORZ. N/A VERT.</p> <p>APPROVAL: [Signature] DATE: 11/14/03 [Signature] DATE: 12/8/02</p> <p>NEVADA POWER COMPANY DATE: _____ NEVADA POWER COMPANY APPROVAL IS ONLY FOR THE PLACEMENT AND CLEARANCE OF STREET LIGHT AND SIGNAL LIGHT INSTALLATION. AND CLEARANCE OF STREET LIGHT AND SIGNAL LIGHT INSTALLATION.</p> <p>PROFESSIONAL ENGINEER KEITH F. POLSON CIVIL No. 10539 EXPIRES 12-31-03</p> <p>SHEET <b>UT2</b> 6 OF 14 SHEETS DRAWING NO. 307Y-4604-5-3</p>						