

INDIGO GORGE AVENUE
(PUBLIC)

REFER TO IRON MOUNTAIN RANCH VILLAGE 2 UNIT 1
FOR OFF-SITE SEWER

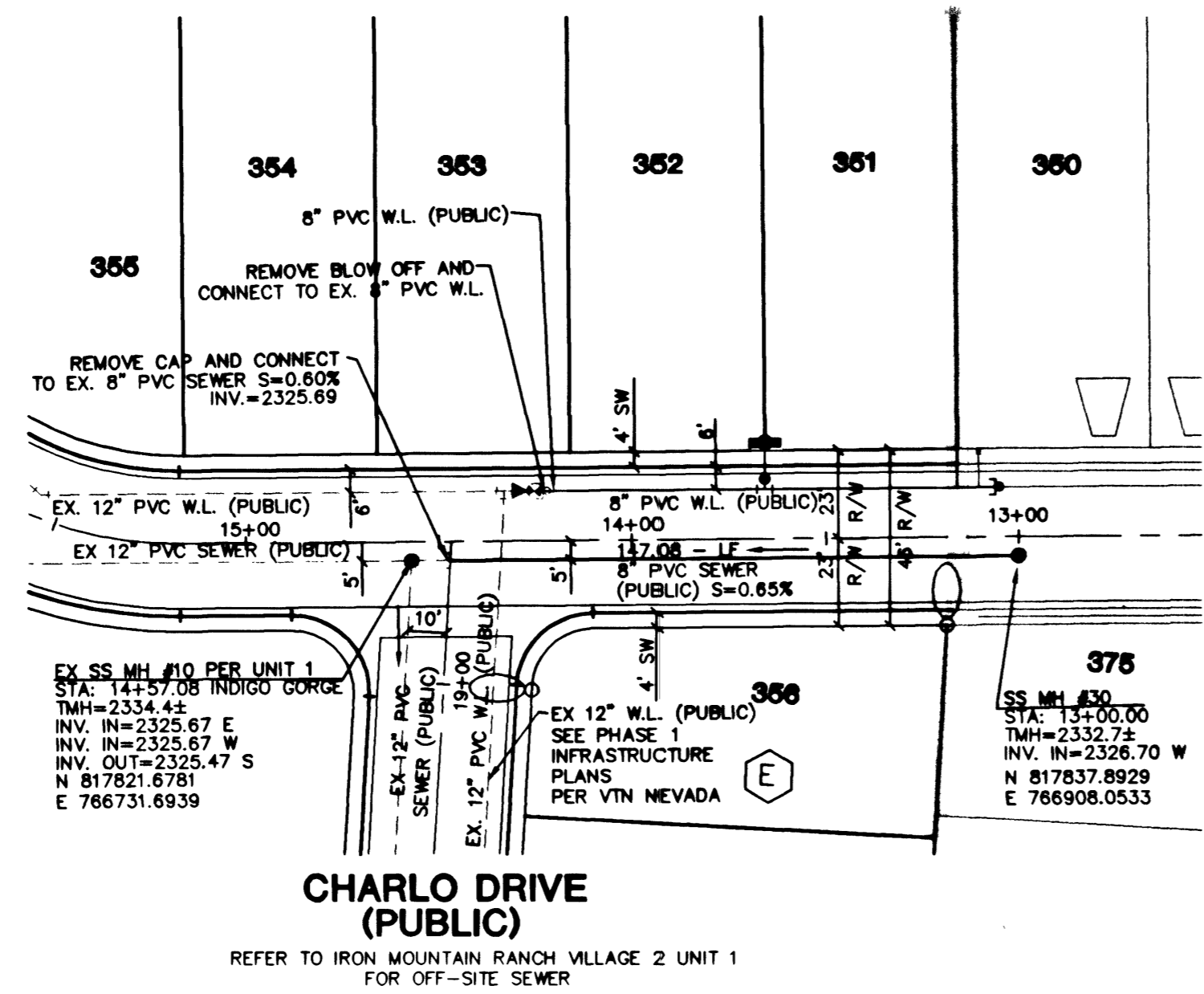

FUTURE IRON MOUNTAIN RANCH VILLAGE 2 UNIT 3

INDIGO GORGE AVENUE
(PUBLIC)

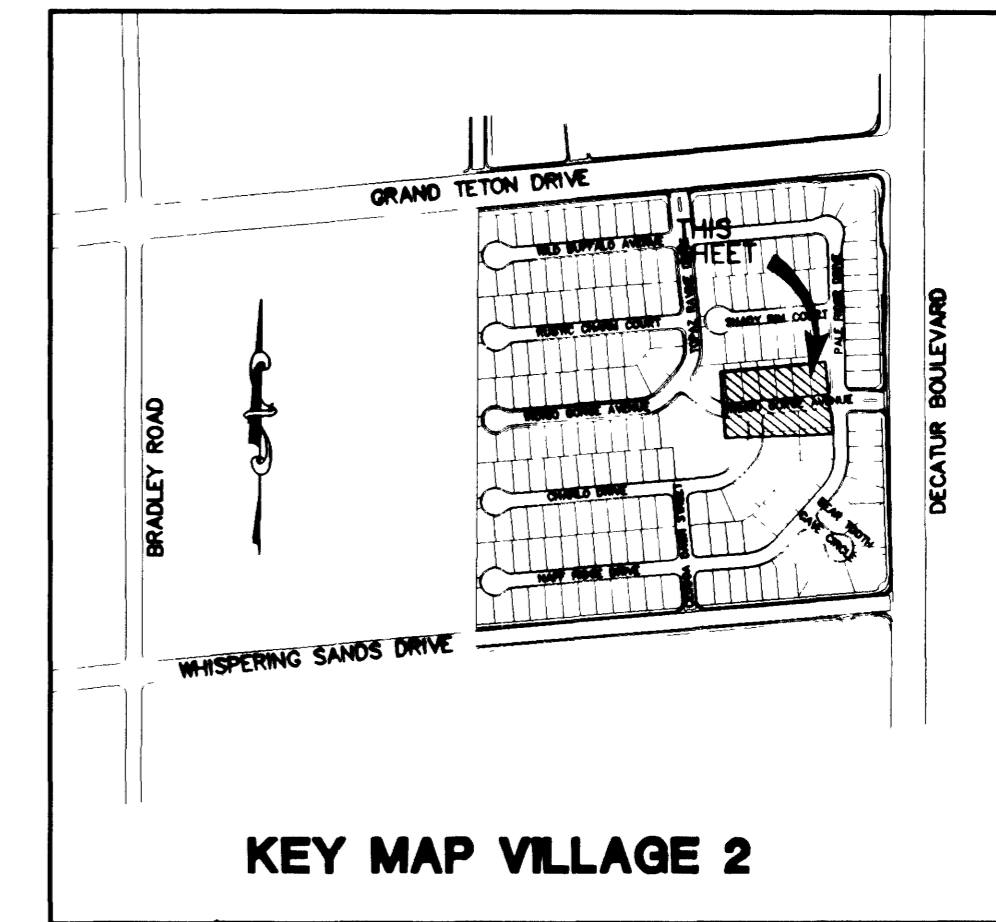
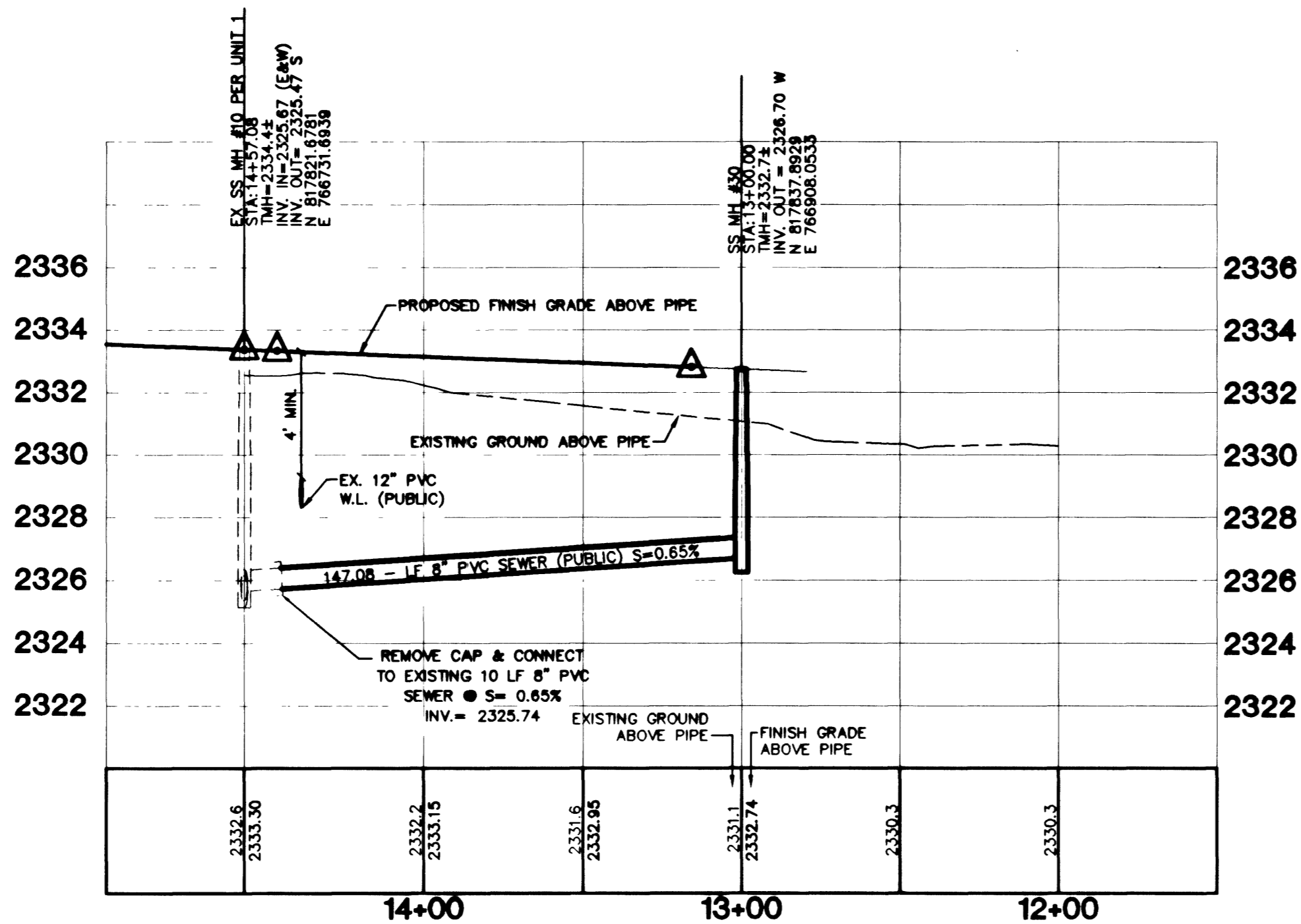

KEY MAP VILLAGE 2

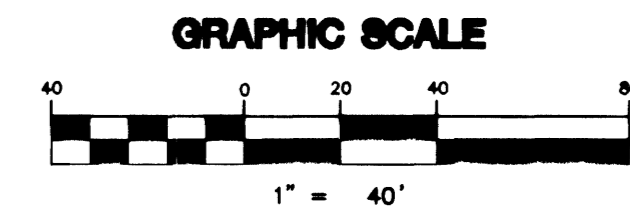

PROFILE SCALE:
HORIZ. 1" = 40'
VERT. 1" = 4'

BASIS OF BEARINGS

THE BASIS OF BEARINGS FOR THIS PROJECT IS GRID NORTH AS DEFINED BY THE NEVADA COORDINATE SYSTEM OF 1983 (NCS83), EAST ZONE, (2701) DETERMINED BY CLARK COUNTY GIS CONTROL POINTS 802, 803, 804, AND 805, AS SHOWN ON A RECORD OF SURVEY ON FILE IN THE CLARK COUNTY, NEVADA, RECORDER'S OFFICE, IN BOOK 88 OF SURVEYS, AT PAGE 53.

PROJECT BENCHMARK

PROJECT DATUM: NAVD88
CITY OF LAS VEGAS BENCHMARK 1LV90-13NES
NAVD88 ELEVATION: 710.9608 METERS (2332.54 FEET)
ONLY BM 413148, NAVD 88 ELEV=710.953 METERS (2332.52 FEET) 1" DIAMETER CONCRETE MONUMENT 77 FEET SOUTH & 54 FEET WEST OF N.E. CORNER SEC. 13T19R60E 10' EAST OF LARGE POWER POLE.

Avoid cutting underground utility lines. It's costly.
Call before you Dig
1-800-227-2600

Avoid overhead power line contact.
Call before you OVERHEAD
1-702-593-6111

NOTE: CONTRACTOR SHALL VERIFY HORIZONTAL AND VERTICAL LOCATION OF EXISTING UTILITIES AND NOTIFY THE DESIGN ENGINEER IMMEDIATELY OF ANY DISCREPANCIES PRIOR TO CONSTRUCTION.

7	6	5	4	3	2	1	REV	DATE	BY

KB HOME
750 PILOT ROAD SUITE F
LAS VEGAS, NV. 89119
(702) 814-2500

vtm nevada
CONSULTING ENGINEERS • PLANNERS • LAND SURVEYORS
2727 SOUTH RAINBOW BOULEVARD LAS VEGAS, NEVADA 89102-5148
PH. (702) 873-7550 FAX (702) 362-2597

SEWER PLAN & PROFILE
INDIGO GORGE
STA : 10+79.40 - 12+58.50

IRON MOUNTAIN RANCH
VILLAGE 2 - UNIT 2

SHEET: APRIL '01
DESIGNED BY: APRIL '01
CHECKED BY:
PROJECT NO: 5917-2
SCALE: 1"=40'
HORIZ. NA
VERT.

SEAL
PROFESSIONAL ENGINEER
KENNETH J. NELSON
NO. 10539
CIVIL
P.A.E.

SHEET
334
20 OF 25 SHEETS
DRAWING NO.
307Y-4604-2-2

H:\5823\VILLAGE2\UNIT2\5917.mxd (BR-SS04)