

EX. CARMEL CANYON SUBDIVISION
PER CARTER BURGESS ENGINEERING
CLV DWG. NO. 107Y-4757-1

PROJECT BENCHMARK

PROJECT DATUM: NAVD88
(OLD) CITY OF LAS VEGAS BENCHMARK 1LV90-13NES
NAVD88 ELEVATION: 710.9608 METERS (2332.54 FEET)
PROJECT DESIGNED USING OLD BENCHMARK
(NEW) CITY OF LAS VEGAS BENCHMARK 1LV90-13NES
NAVD88 ELEVATION: 710.9181 METERS (2332.40 FEET)
BRASS CAP IN CONCRETE AT S.W. CORNER OF DECATUR
AND GRAND TETON
ONLY BM 413148, NAVD 88 ELEV=710.953
METERS (2332.52 FEET) 1" DIAMETER CONCRETE MONUMENT
77 FEET SOUTH & 54 FEET WEST N.E. CORNER
SEC. 13T19R80E 10' EAST OF LARGE POWER POLE
(-0.14 FEET) TO GET NEW PUBLISHED DATUM

BASIS OF BEARINGS

THE BASIS OF BEARINGS FOR THIS PROJECT IS GRID NORTH AS DEFINED BY THE NEVADA COORDINATE SYSTEM OF 1983 (NCS83), EAST ZONE, (2701), DETERMINED BY CLARK COUNTY GIS CONTROL POINTS 803, 804, AND 805, AS SHOWN ON A RECORD OF SURVEY ON FILE IN THE CLARK COUNTY, NEVADA, RECORDER'S OFFICE, IN BOOK 88 OF SURVEYS, AT PAGE 53.

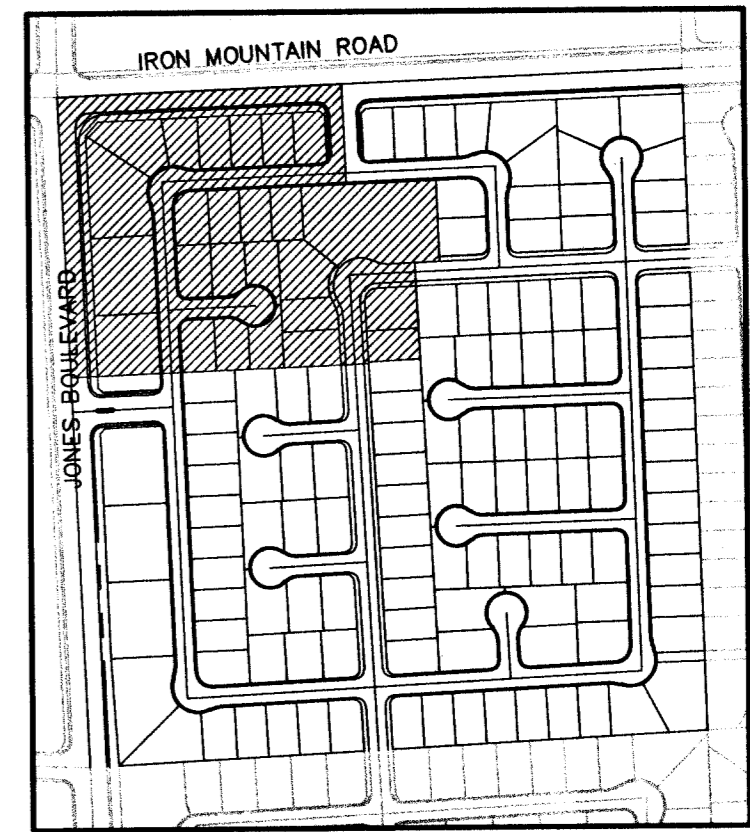

GRAPHIC SCALE

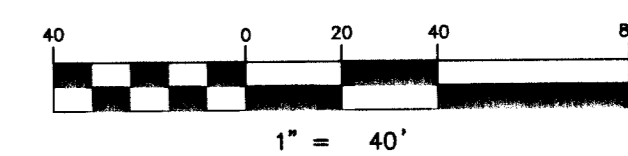

NOTE

TRAFFIC LUMINAIRES ARE TO BE WIRED CONTINUOUSLY TO CABINET USING 2-#10 STR & 1-#8 GREEN T.H.W. WIRE. 10' OF SLACK SHALL BE LEFT IN POLE. EACH LUMINAIRE SHALL BE FUSED INDIVIDUALLY WITH A 10 AMP FUSE IN BOTTOM OF CABINET.

DISCLAIMER NOTE

UTILITY LOCATIONS SHOWN HEREON ARE APPROXIMATE ONLY. IT SHALL BE THE CONTRACTOR'S RESPONSIBILITY TO DETERMINE THE EXACT HORIZONTAL AND VERTICAL LOCATION OF ALL EXISTING UNDERGROUND AND OVERHEAD UTILITIES PRIOR TO COMMENCING CONSTRUCTION. NO REPRESENTATION IS MADE THAT ALL EXISTING UTILITIES ARE SHOWN HEREON. THE ENGINEER ASSUMES NO RESPONSIBILITY FOR UTILITIES NOT SHOWN OR UTILITIES NOT SHOWN IN THEIR PROPER LOCATION.

STREET LIGHT & SIGNAGE LEGEND/ QUANTITIES

	70 WATT H.P.S. (PUBLIC) SUMMERLIN TYPE 5C POLES WITH 8.0' ARMS	10 EA.
	100 WATT H.P.S. (PUBLIC) SUMMERLIN TYPE 2C POLES WITH 8.0' ARMS	7 EA.
	150 WATT H.P.S. (PUBLIC) SUMMERLIN TYPE 2B POLES WITH 8.0' ARMS	13 EA.
	400W STREET LIGHT	1 EA.
	3 1/2 PULBOX FOR FUTURE STREETLIGHT	18 EA.
	1 1/4" ST. LT. CONDUIT	1526 LF
	3" FIBER OPTIC CONDUIT	1934 LF
	TS (TRAFFIC SIGNAL)	220 LF
	EX. CONDUITS	
	200 AMP SERVICE POINT	1 EA.
	125 AMP SERVICE POINT	1 EA.
	# 3-1/2 PULLBOX	5 EA.
	No. 7 PULLBOX	1 EA.
	No. 5 PULLBOX	1 EA.
	P-30 PULLBOX	2 EA.
	INSTALL YELLOW TYPE 1 CENTERLINE DELINEATION PER USD# 244	
	INSTALL YELLOW TYPE 2 CENTERLINE DELINEATION PER USD# 244	
	INSTALL 4" WHITE PAINTED EDGE LINE	
	INSTALL 36" R1-1 "STOP" SIGN & (2) 12" D3 "STREET NAME" SIGNS	3 EA.
	INSTALL 30" R1-1 "STOP" SIGN & (2) 9" D3 "STREET NAME" SIGNS	5 EA.
	INSTALL R8-3A "NO PARKING" SIGNS	6 EA.
	INSTALL OM-3R SIGNS AT 25' SPACINGS	0 EA.
	INSTALL (2) 12" D3 "STREET NAME" SIGNS	3 EA.
	INSTALL 4" LANE LINE	
	INSTALL END OF ROAD MARKERS	
	DRIVEWAY LOCATION (SCHEMATIC)	

PAD MOUNT SERVICE
200 AMP 240V PAD MOUNT SERVICE WITH

- 2 2 POLE 60 AMP CIRCUIT BREAKERS
- 1 1 POLE 15 AMP CIRCUIT BREAKERS
- 1 1 POLE 40 AMP CIRCUIT BREAKERS
- 1 1 POLE 60 AMP CIRCUIT BREAKERS
- 2 2 POLE 60 AMP CONTACTORS
- 1 BY-PASS SWITCH PER CONTACTORS

Call before you Dig
1-800-227-2600

Call before you Overhead
1-702-593-6111

Avoid cutting underground utility lines. It's costly.

Avoid overhead power line contact. It's costly.

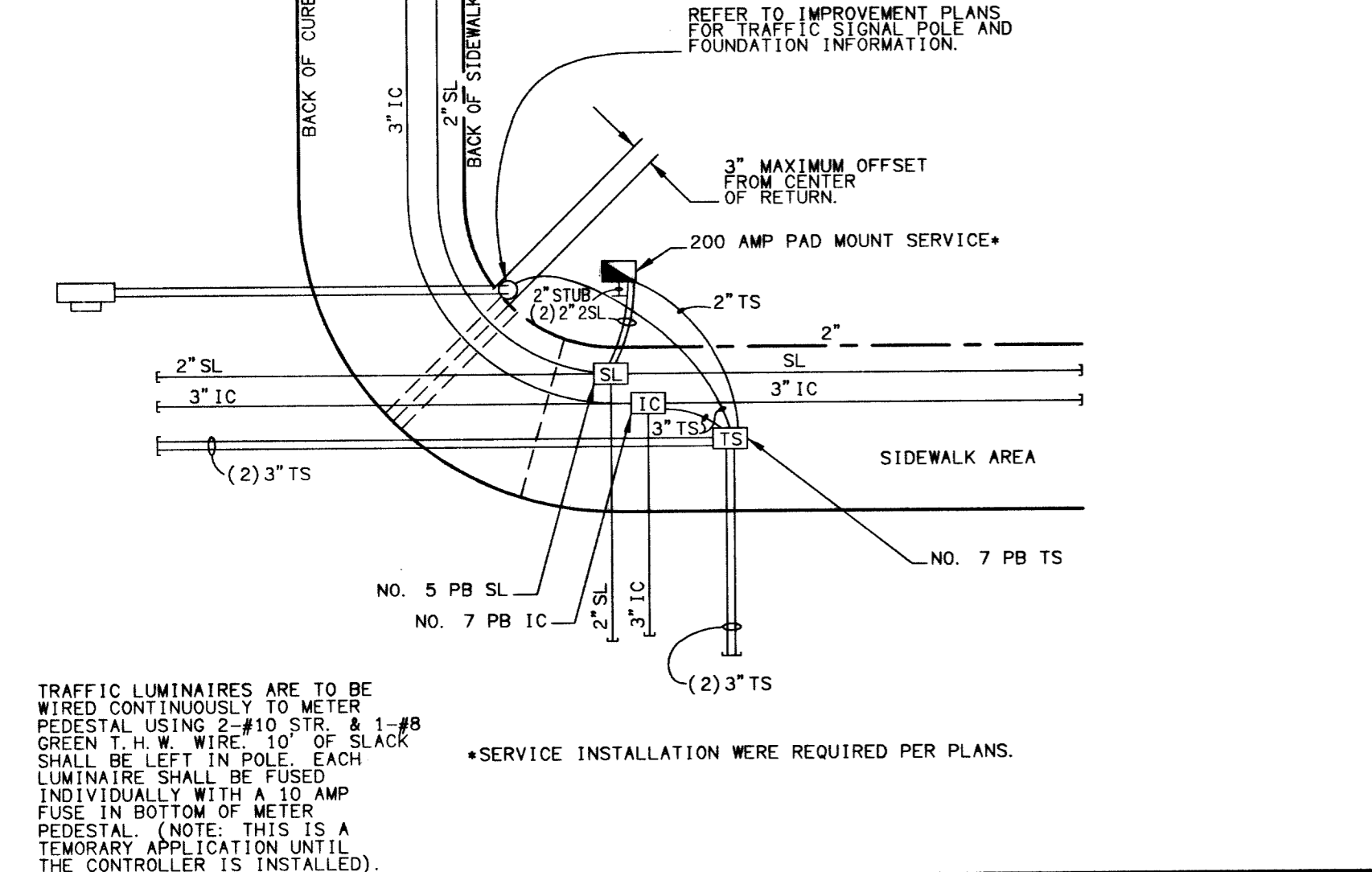
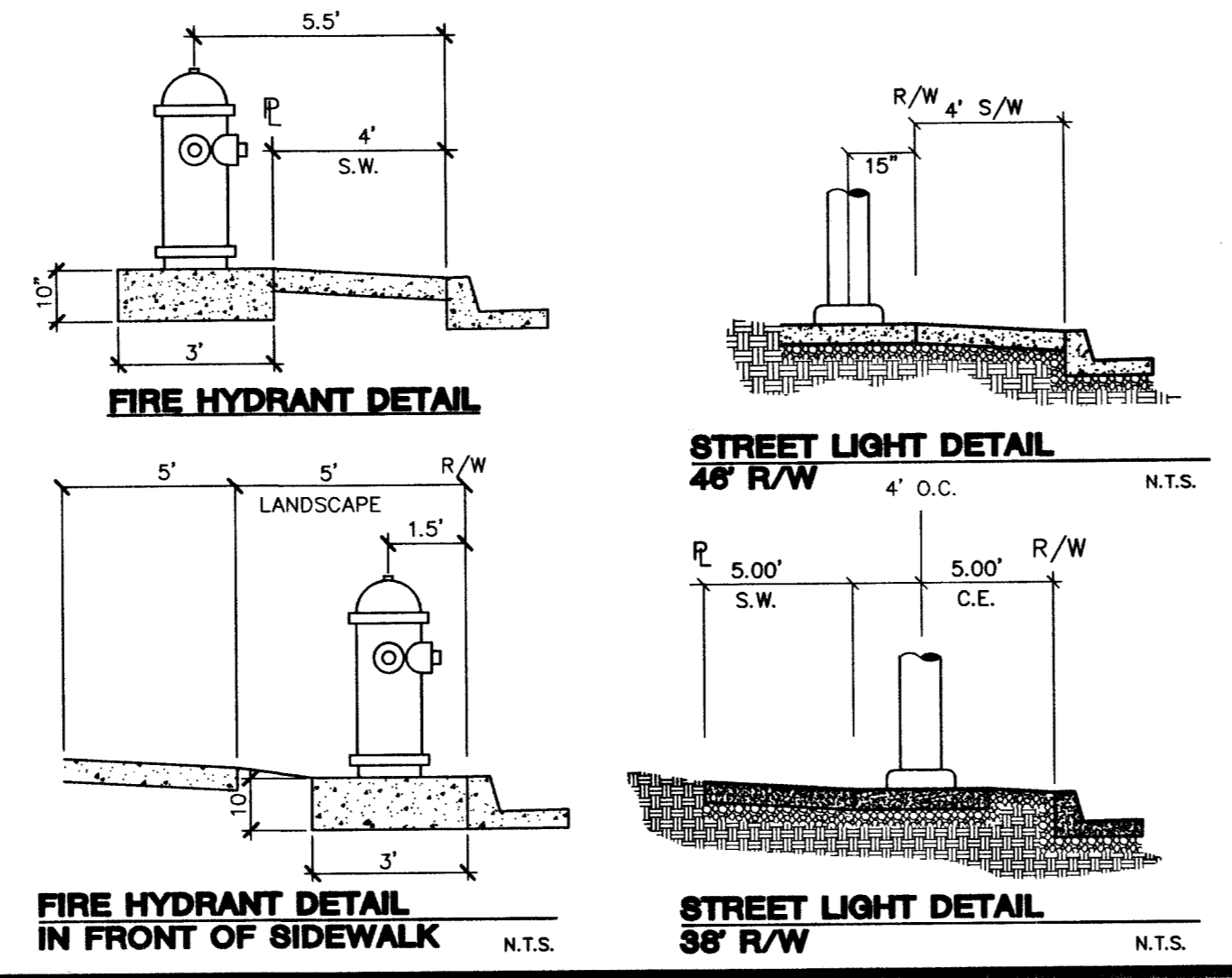

TRAFFIC LUMINAIRES ARE TO BE WIRED CONTINUOUSLY TO METER PEDESTAL USING 2-#10 STR & 1-#8 GREEN T.H.W. WIRE. 10' OF SLACK SHALL BE LEFT IN POLE. EACH LUMINAIRE SHALL BE FUSED INDIVIDUALLY WITH A 10 AMP FUSE IN BOTTOM OF METER PEDESTAL. (NOTE: THIS IS A TEMPORARY APPLICATION UNTIL THE CONTROLLER IS INSTALLED).

*SERVICE INSTALLATION WERE REQUIRED PER PLANS.

KB HOMES
750 PILOT ROAD, SUITE F
LAS VEGAS, NEVADA 89119
(702) 814-2550

PROJECT BENCHMARK
PROJECT DATUM: NAVD88
(OLD) CITY OF LAS VEGAS BENCHMARK 1LV90-13NES
NAVD88 ELEVATION: 710.9608 METERS (2332.54 FEET)
PROJECT DESIGNED USING OLD BENCHMARK
(NEW) CITY OF LAS VEGAS BENCHMARK 1LV90-13NES
NAVD88 ELEVATION: 710.9181 METERS (2332.40 FEET)
BRASS CAP IN CONCRETE AT S.W. CORNER OF DECATUR
AND GRAND TETON
ONLY BM 413148, NAVD 88 ELEV=710.953
METERS (2332.52 FEET) 1" DIAMETER CONCRETE MONUMENT
77 FEET SOUTH & 54 FEET WEST N.E. CORNER
SEC. 13T19R80E 10' EAST OF LARGE POWER POLE
(-0.14 FEET) TO GET NEW PUBLISHED DATUM

BASIS OF BEARINGS
THE BASIS OF BEARINGS FOR THIS PROJECT IS GRID NORTH AS DEFINED BY THE NEVADA COORDINATE SYSTEM OF 1983 (NCS83), EAST ZONE, (2701), DETERMINED BY CLARK COUNTY GIS CONTROL POINTS 803, 804, AND 805, AS SHOWN ON A RECORD OF SURVEY ON FILE IN THE CLARK COUNTY, NEVADA, RECORDER'S OFFICE, IN BOOK 88 OF SURVEYS, AT PAGE 53.

KEY MAP

GRAPHIC SCALE
1" = 40'

NOTE
TRAFFIC LUMINAIRES ARE TO BE WIRED CONTINUOUSLY TO CABINET USING 2-#10 STR & 1-#8 GREEN T.H.W. WIRE. 10' OF SLACK SHALL BE LEFT IN POLE. EACH LUMINAIRE SHALL BE FUSED INDIVIDUALLY WITH A 10 AMP FUSE IN BOTTOM OF CABINET.

DISCLAIMER NOTE
UTILITY LOCATIONS SHOWN HEREON ARE APPROXIMATE ONLY. IT SHALL BE THE CONTRACTOR'S RESPONSIBILITY TO DETERMINE THE EXACT HORIZONTAL AND VERTICAL LOCATION OF ALL EXISTING UNDERGROUND AND OVERHEAD UTILITIES PRIOR TO COMMENCING CONSTRUCTION. NO REPRESENTATION IS MADE THAT ALL EXISTING UTILITIES ARE SHOWN HEREON. THE ENGINEER ASSUMES NO RESPONSIBILITY FOR UTILITIES NOT SHOWN OR UTILITIES NOT SHOWN IN THEIR PROPER LOCATION.

STREET LIGHTING AND STRIPING PLAN 1

IRON MOUNTAIN RANCH VILLAGE 11 UNIT 2

SCALE: 1"=40'

PROFESSIONAL ENGINEER
NATHANIEL W. POLSON
No. 10639 VOL. 10
EXPIRES 12-31-05

SHEET
SL1
20 OF 28 SHEETS

DRAWING NO.
107Y4604-1-2

DATE
JUNE 03

REVISION