

HIGHLAND DRIVE  
CONGESTED DUE TO  
CONSTRUCTION  
  
USE  
ALTERNATE ROUTE

(A)

30" x 36"

ROAD  
CONSTRUCTION  
AHEAD

ALTERNATE ROUTE  
  
NORTH ON H ST.  
WEST ON CAREY AVE.

(B)

ROAD  
CONSTRUCTION  
AHEAD

ALTERNATE ROUTE  
  
SOUTH ON STATEHOOD  
WEST ON  
CHARLESTON BLVD.

(C)

36" x 36" (TYP.)

CONSTRUCTION SIGNS TO BE ORANGE  
AND BLACK (TYP.)

48" x 60" (TYP.)

ROAD  
CONSTRUCTION  
AHEAD

ALTERNATE ROUTE  
  
SOUTH ON RANCHO DR.  
EAST ON  
CHARLESTON BLVD.

(D)

ROAD  
CONSTRUCTION  
AHEAD

ALTERNATE ROUTE  
  
SOUTH ON  
RANCHO DR.  
EAST ON EXPRESSWAY

(E)

ROAD  
CONSTRUCTION  
AHEAD

ALTERNATE ROUTE  
  
NORTH ON  
COMSTOCK ST.  
EAST ON CAREY AVE.

(F)

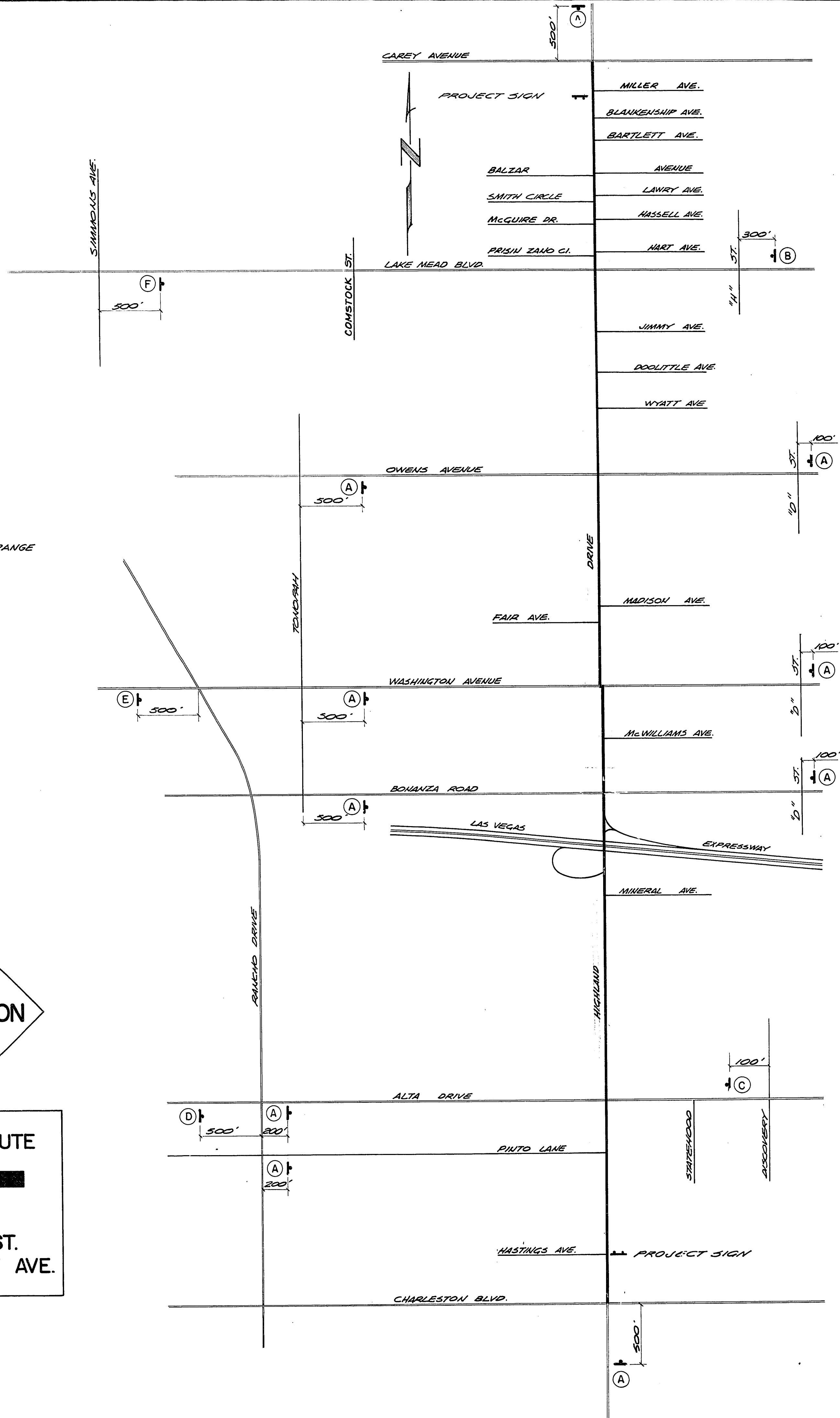

REVISIONS			
NO.	DESCRIPTION/DATE	BY	

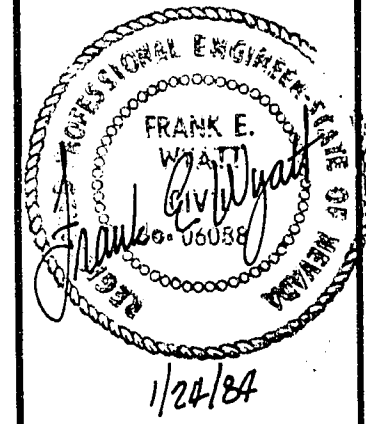

SPARKS, NEVADA  
LAS VEGAS, NEVADA  
SEATTLE, WASHINGTON  
**SEA**  
ENGINEERS/PLANNERS

CITY OF LAS VEGAS  
HIGHLAND DRIVE  
CHARLESTON BOULEVARD TO CAREY AVENUE  
CONSTRUCTION - PROJECT SIGN  
LOCATION MAP

JOB NO. 2-0241-004-B21  
DESIGNED DFP  
DRAWN TAM & SLE  
COMP.  
CHECKED  
DATE DECEMBER 1982

73

73 OF 75 SHEETS

19-4-917 107-V856A