

FED. RD. REG. NO.	STATE	PROJECT NO.	COUNTY	SHEET NO.
9	NEVADA	NH-DE-015-1(134)	CLARK	S1-1A

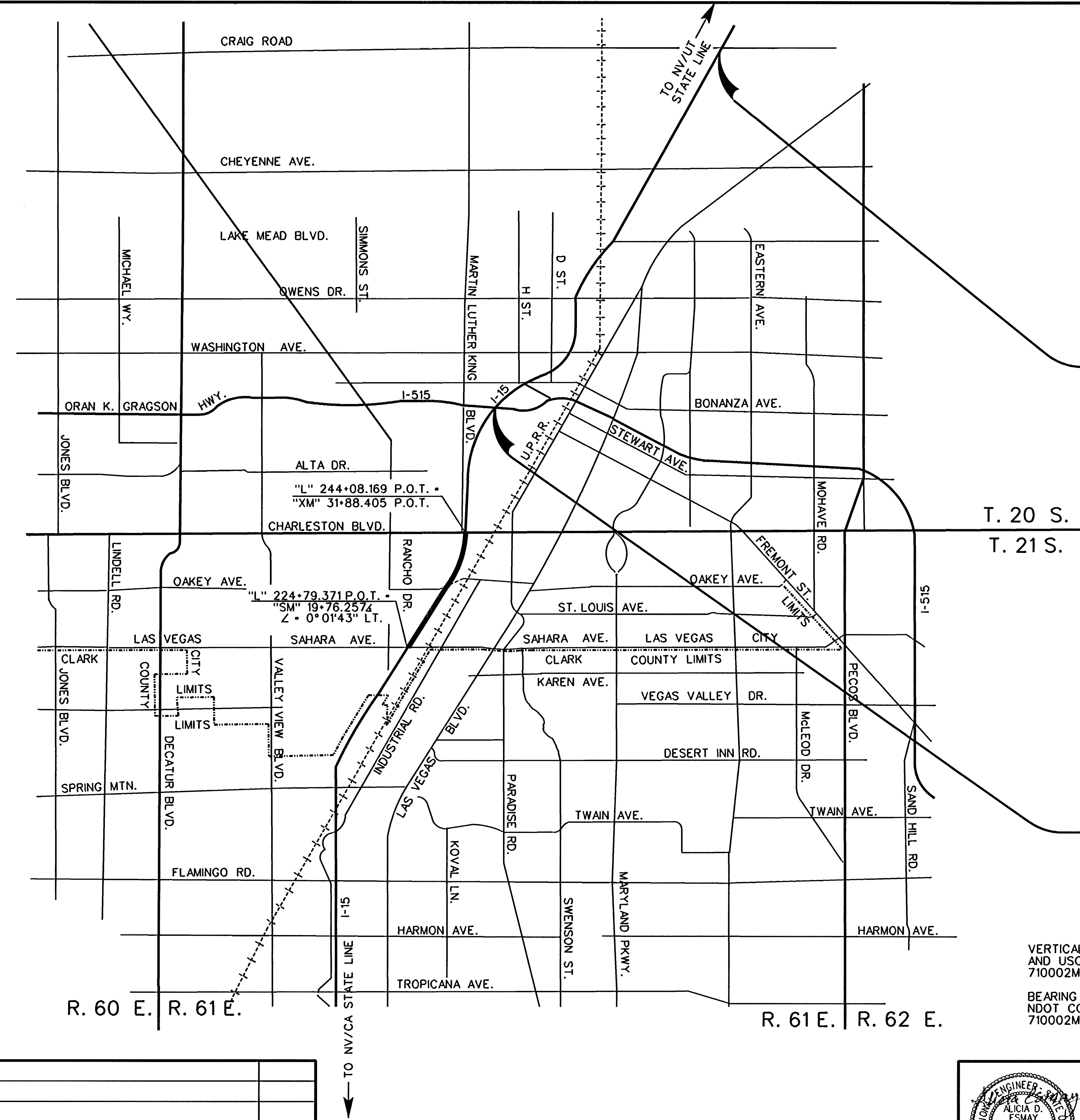
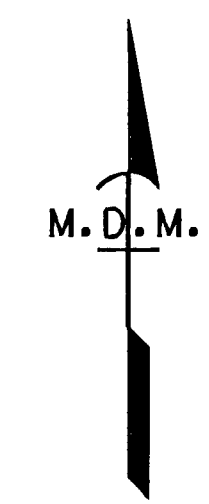

END PROJECT NH-DE-015-1(134)  
"L" 1162+50.00 P.O.T.

T. 20 S.  
T. 21 S.

BEGIN PROJECT NH-DE-015-1(134)  
"L1" 859+32.00 P.O.T.

VERTICAL DATUM: ELEVATIONS ARE BASED UPON HOLDING PUBLISHED NDOT AND USC&GS CONTROL POINTS 710002M, 710003M, 71008M, 761002M AND 744009M AS FIXED.

BEARING SOURCE: STATE PLANE COORDINATES NAD 83 NEVADA EAST. ADJUSTED TO NDOT CONTROL POINTS 710002M, 710003M, 71008M, 710011M, 744003M AND 761015M

FILENAME: \$FILENAME

Designed By:			
Detailed By:			
Checked By:			
A.ESMAY	NO.	DESCRIPTION	DATE
		ISSUE RECORD	

113015

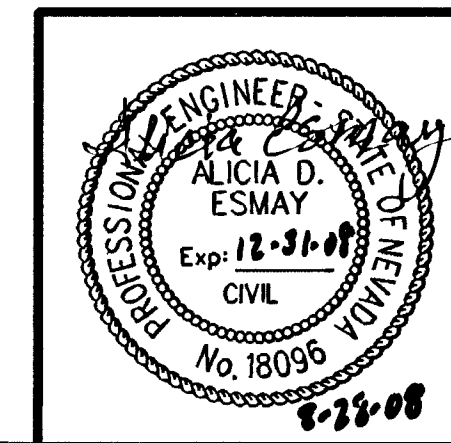

H\*28720 CLV#107V5097  
STATE OF NEVADA  
DEPARTMENT OF TRANSPORTATION  
I-15 North, US 95 to Craig Road Design-Build Project  
SEGMENT 1  
UTILITY RELOCATION  
LOCATION SKETCH