

SD 'A'
(PUBLIC)

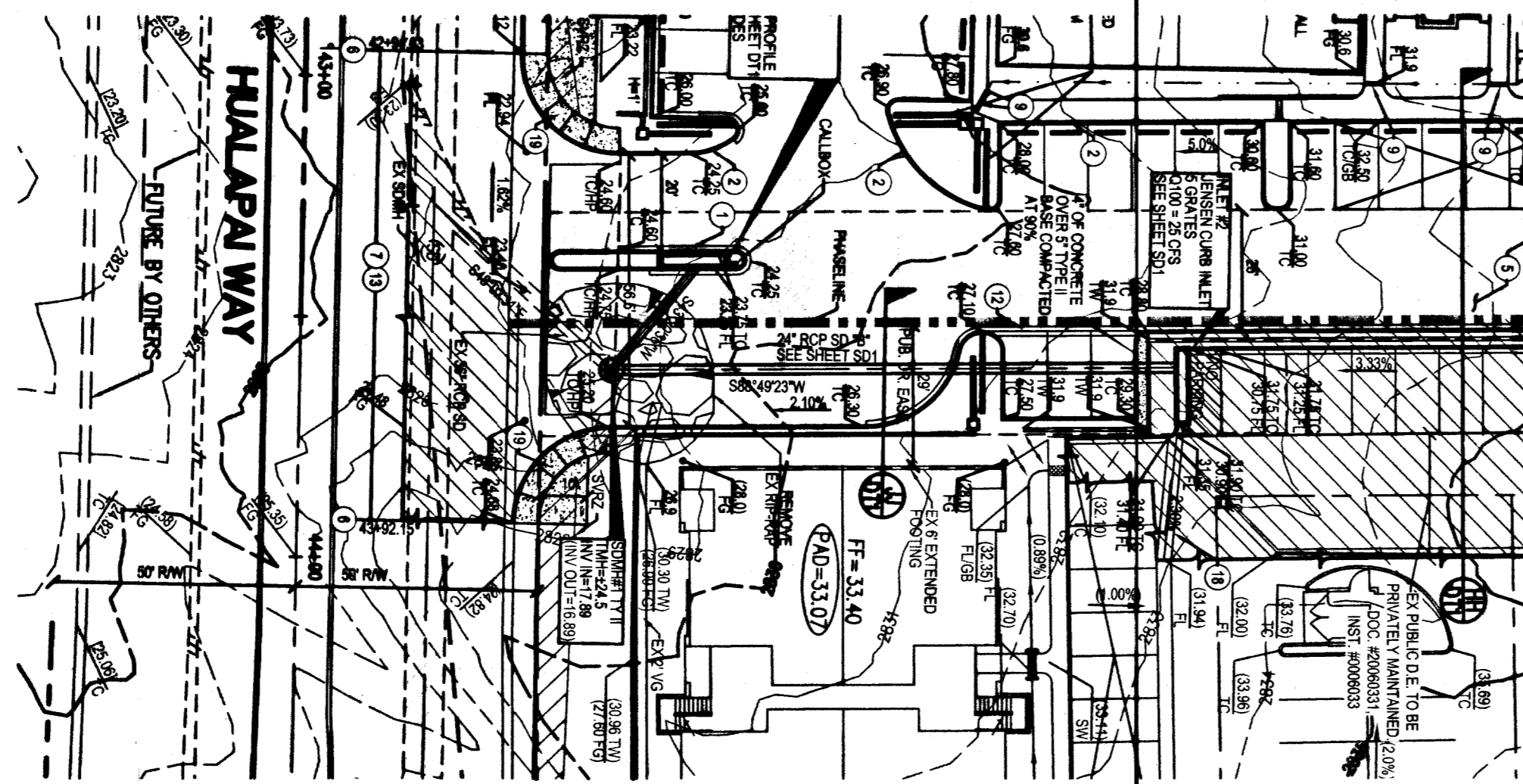

SD 'B'
(PUBLIC)

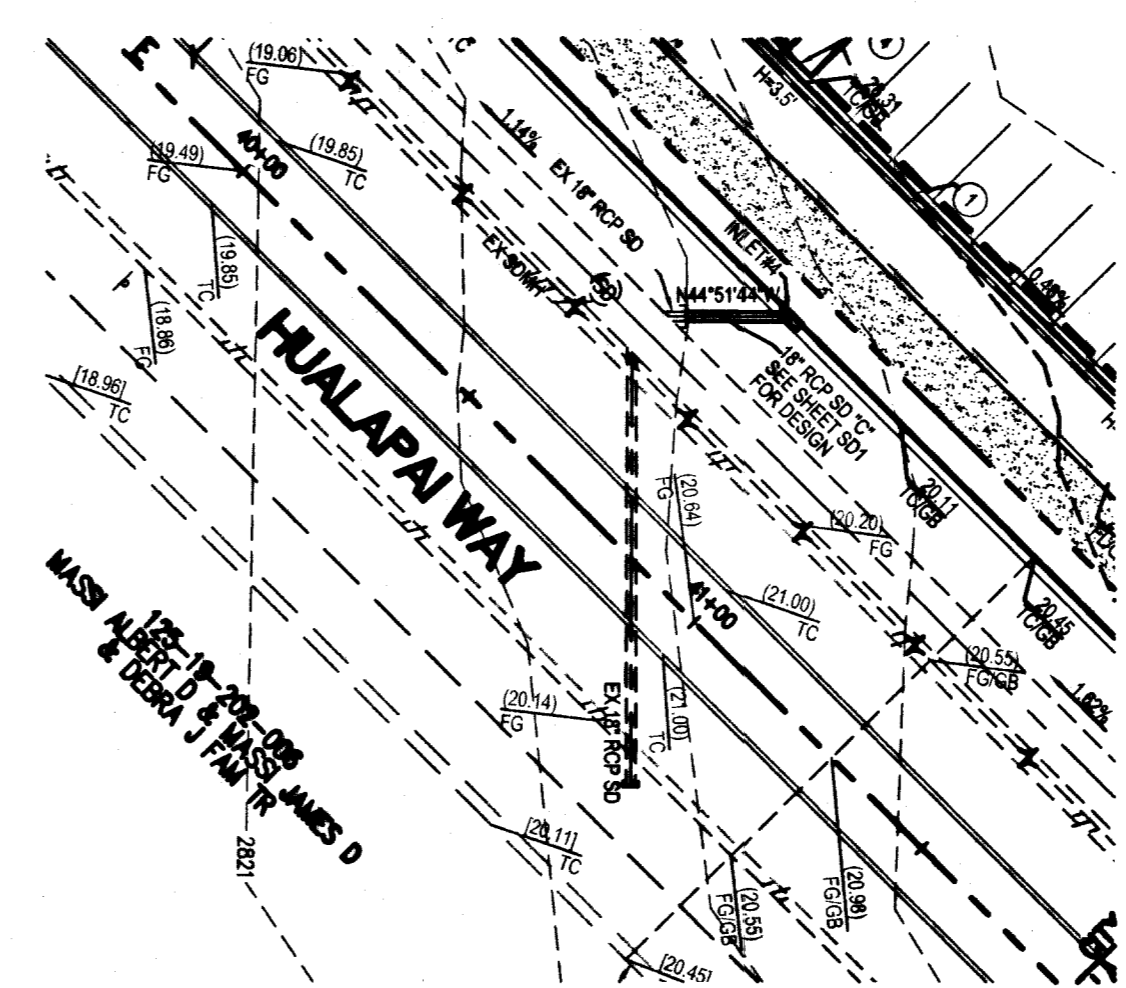

SD 'C'
(PUBLIC)

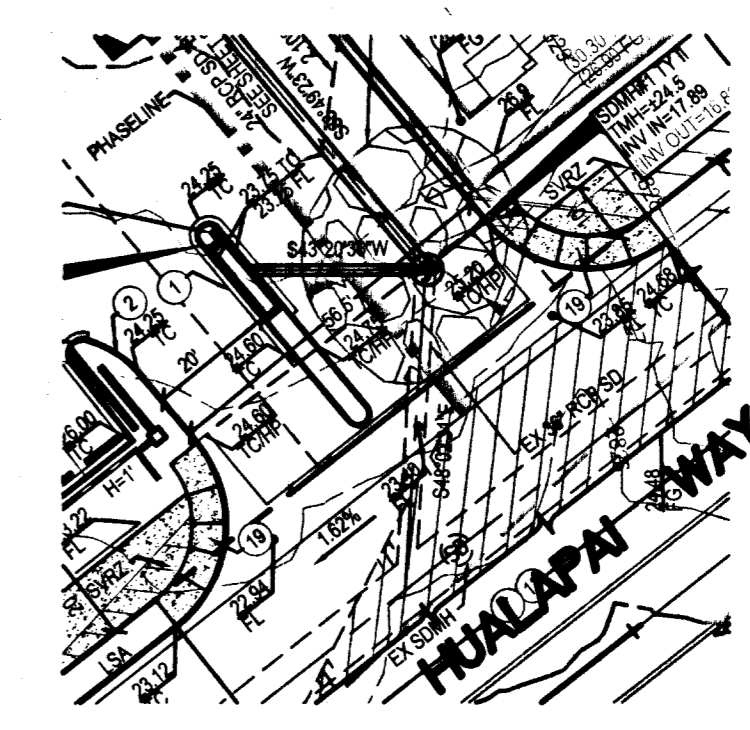

SD 'D'
(PUBLIC)

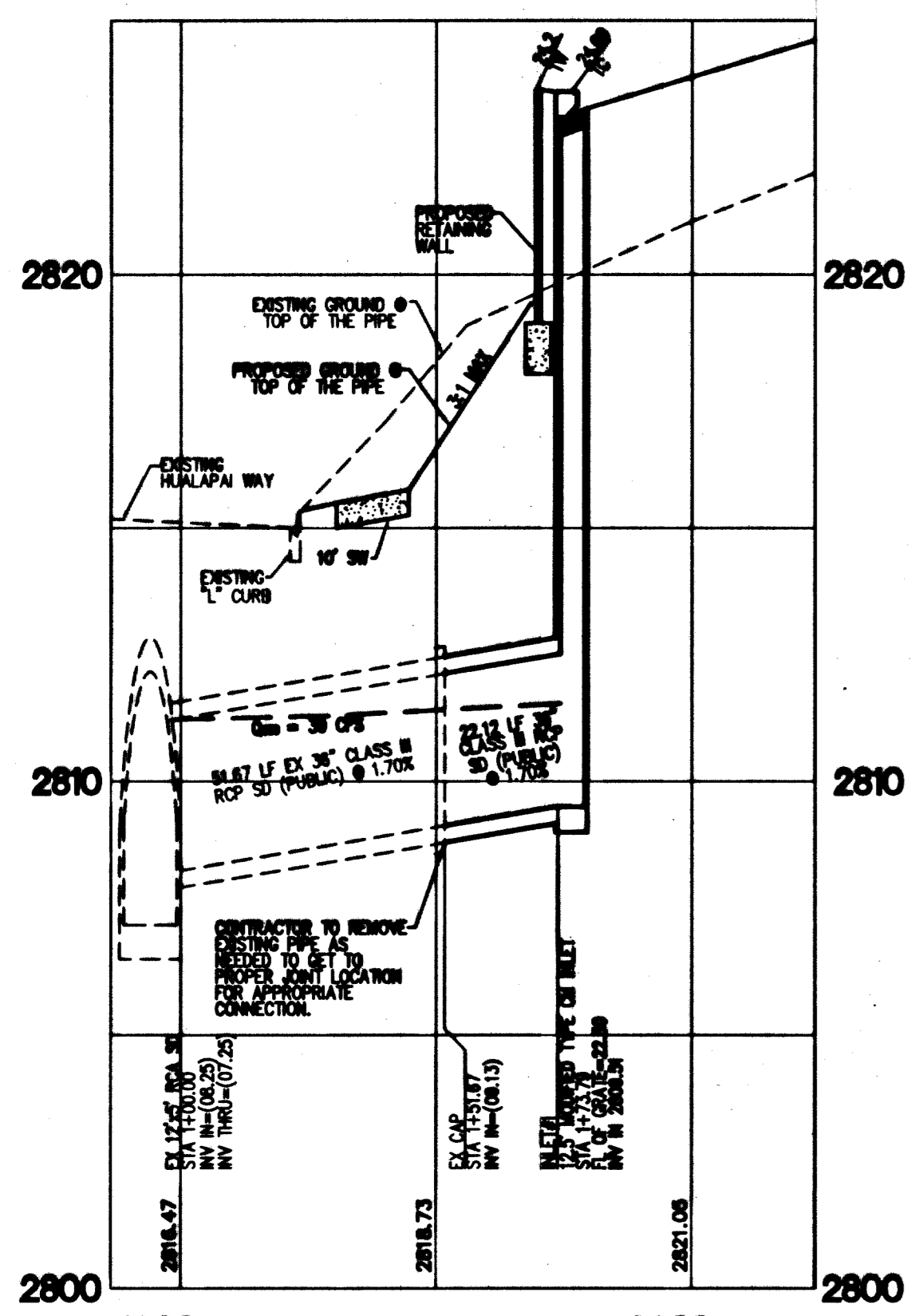

PROFILE
HORIZONTAL SCALE: 1"=30'
VERTICAL SCALE: 1"=3'

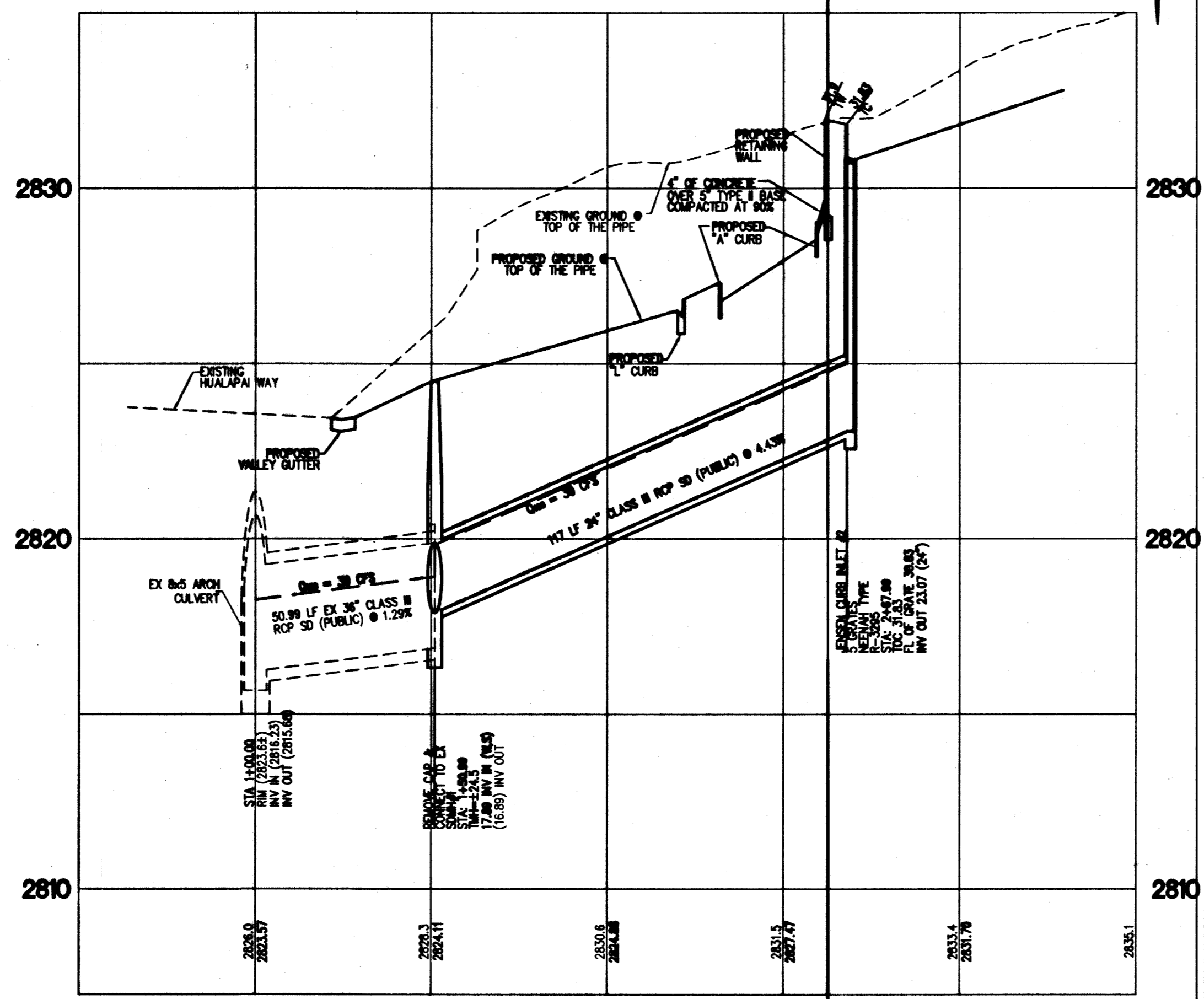

PROFILE
HORIZONTAL SCALE: 1"=30'
VERTICAL SCALE: 1"=3'

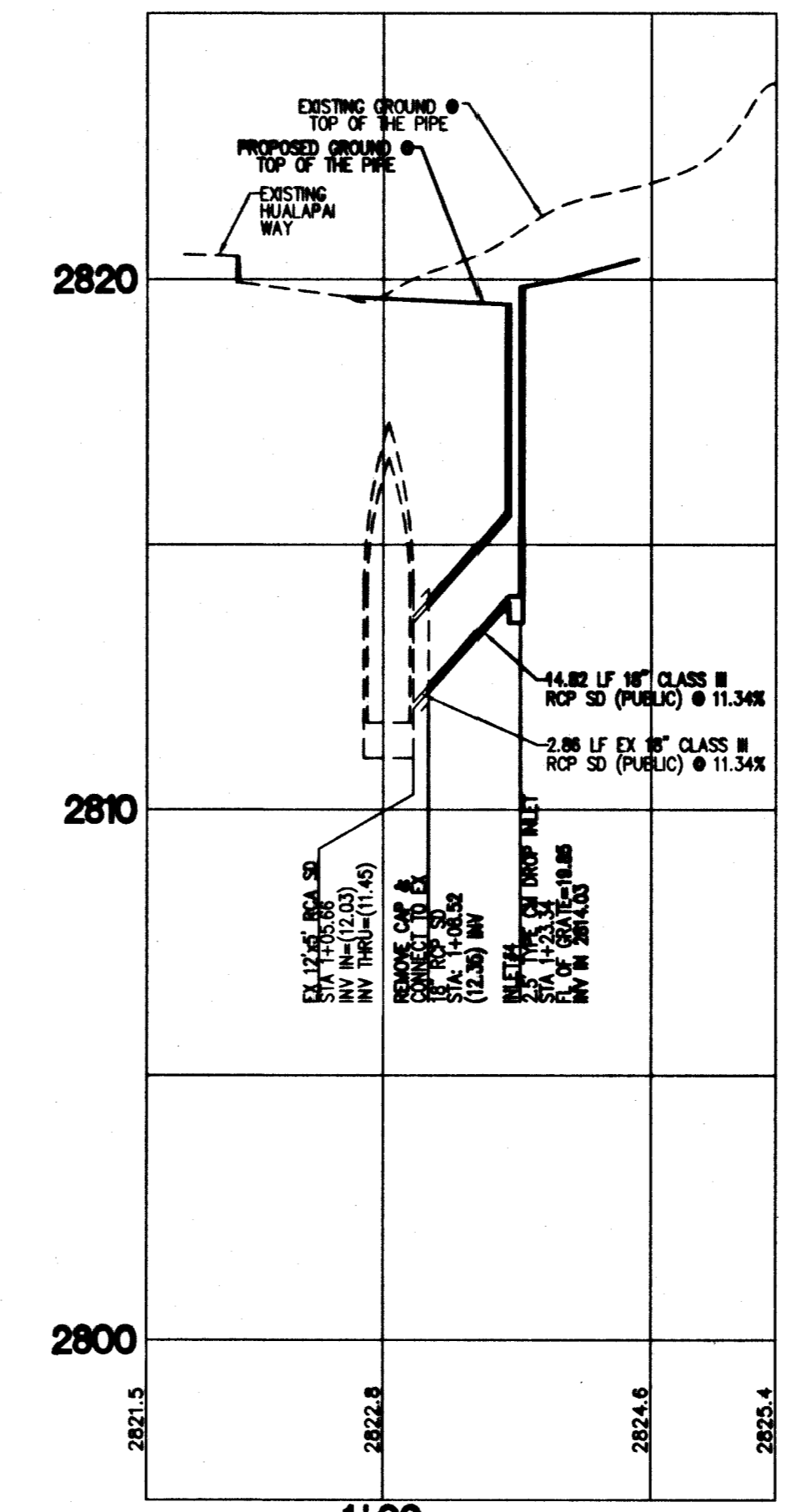

PROFILE
HORIZONTAL SCALE: 1"=30'
VERTICAL SCALE: 1"=3'

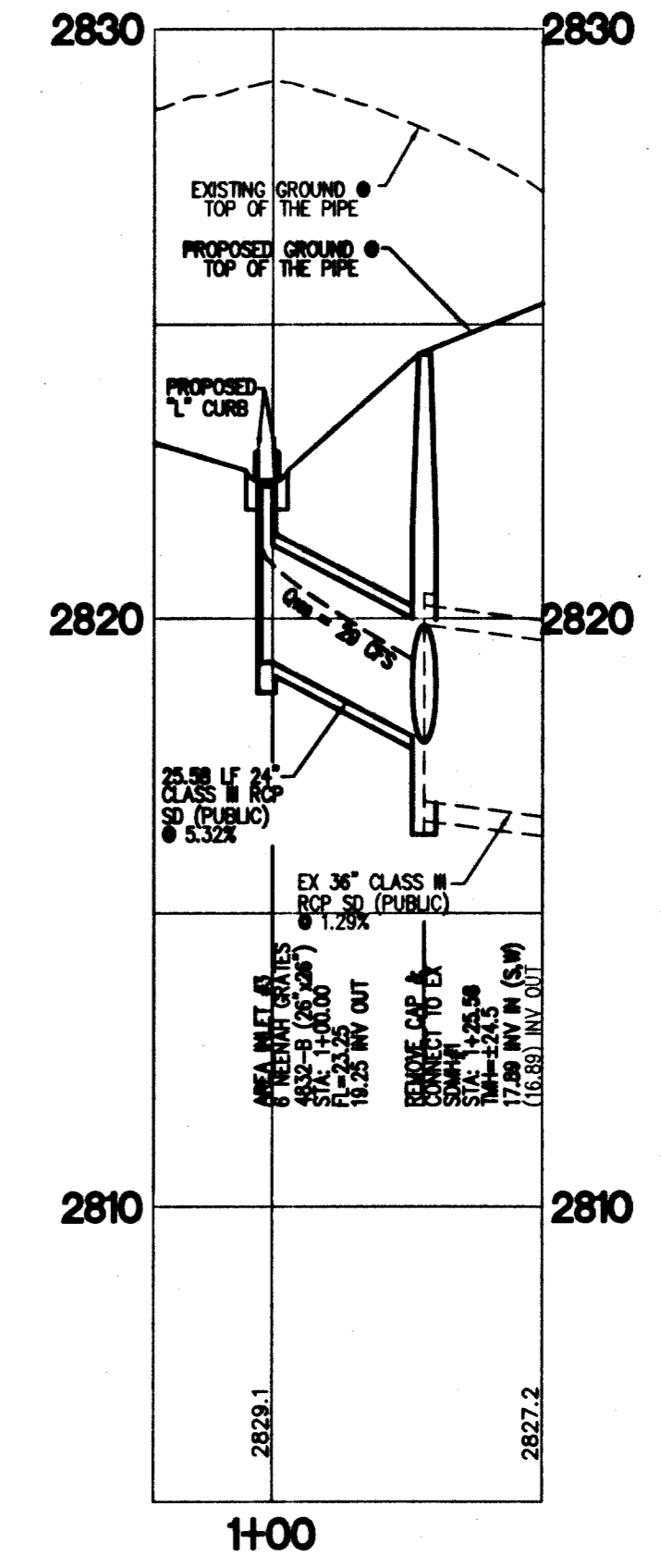

PROFILE
HORIZONTAL SCALE: 1"=30'
VERTICAL SCALE: 1"=3'

DISCLAIMER NOTE:
UTILITY LOCATIONS SHOWN HEREIN ARE APPROXIMATE ONLY. IT SHALL BE THE CONTRACTOR'S RESPONSIBILITY TO DETERMINE THE EXACT HORIZONTAL AND VERTICAL LOCATION OF ALL EXISTING UNDERGROUND OR OVERHEAD UTILITIES PRIOR TO COMMENCING CONSTRUCTION. NO REPRESENTATION IS MADE THAT ALL EXISTING UTILITIES ARE SHOWN HEREIN. THE ENGINEER ASSUMES NO RESPONSIBILITY FOR UTILITIES NOT SHOWN OR UTILITIES NOT SHOWN IN THEIR PROPER LOCATION. CONTRACTOR TO NOTIFY ENGINEER OF ANY CHANGES OR DISCREPANCIES.

Call before you Overhead
1-702-227-2329

Call before you Dig
1-800-221-2600

Call before you UnderGround
1-702-229-6611

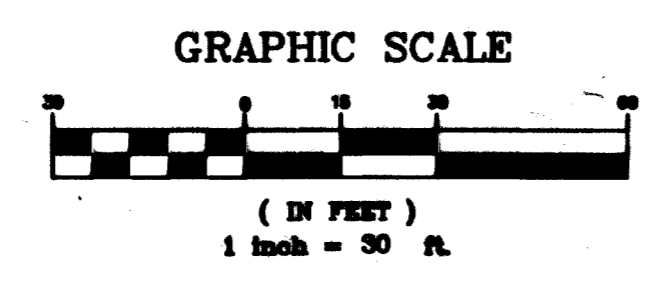

BENCHMARK:
CIVIL BLM 1899
RIVET & PLATE IN CONCRETE CYLINDER SOUTHWEST CORNER OF DEER SPRINGS & CONQUISTADOR
ELEVATION = 845.4167 (METERS) NAVD'83
= 2773.67 (US SURVEY FEET) NAVD'83

BASIS OF BEARING:
NORTH 00°04'41" EAST BEING THE BEARING OF THE WEST LINE OF THE SOUTHWEST QUARTER (SW 1/4) OF THE NORTHEAST QUARTER (NE 1/4) OF SECTION 24, TOWNSHIP 19 SOUTH, RANGE 59 EAST, M.D.M., CLARK COUNTY, NEVADA AS SHOWN ON THAT CERTAIN MAP ON FILE IN THE CLARK COUNTY RECORDER'S OFFICE IN FILE 123, PAGE 32 OF SURVEYS.

GENERAL NOTES:
1. SEE SHEET NY FOR ADDITIONAL NOTES, LEGEND AND QUANTITY ESTIMATE.
2. SEE SHEET D11 FOR CONSTRUCTION DETAILS.
3. THE CONTRACTOR SHALL VERIFY THE VERTICAL AND HORIZONTAL LOCATION OF ALL EXISTING UTILITIES AND SURFACE FEATURES PERTINENT TO THIS PROJECT PRIOR TO CONSTRUCTION. THE CONTRACTOR MUST NOTIFY THE DESIGN ENGINEER IF ANY DISCREPANCIES ARE ENCOUNTERED.

I CERTIFY THAT THIS GRADING PLAN IS IN CONFORMANCE WITH THE APPROVED DRAINAGE STUDY ON FILE AT CITY OF LAS VEGAS FOR THIS PROJECT. D.S. 63803
DENNIS P. WERTZLER, P.E. NO. 11970 DATE 7/9/07

REV	DESCRIPTION	SHEETS APP'D BY DATE

PICERNE DEVELOPMENT
1420 EAST MISSOURI AVENUE, SUITE 100, PHOENIX, AZ 85014-2469
TEL. 602 279-8464

DRC
Development Resource Consultants, Inc.
Civil Engineering • Land Surveying • Land Planning
9330 W. MARTIN AVENUE
LAS VEGAS, NV 89118 (702) 270-6145

PICERNE • PROVIDENCE PH 2

SD 'A', SD 'B', SD 'C' AND SD 'D'
PLAN AND PROFILE

DATE:	
DRAWN BY:	
CHECKED BY:	
AREA CHECKED:	
PROJECT NO.:	LWS-28

Professional Engineer Seal for DENNIS P. WERTZLER, CIVIL ENGINEER, No. 11970, State of Nevada.

SHEET
SD1
5 OF 28 SHEETS
DRAWING NO.
107V4934
4/20/07