

# IRON MOUNTAIN RANCH-VILLAGE 6-UNIT 1 MONUMENTATION TIE MAP

(A COMMON INTEREST COMMUNITY)  
BEING A SUBDIVISION OF A PORTION OF THE SOUTHEAST QUARTER (SE 1/4) OF THE NORTHWEST QUARTER (NW 1/4)  
OF SECTION 12, TOWNSHIP 19 SOUTH, RANGE 60 EAST, M.D.M., CITY OF LAS VEGAS, CLARK COUNTY, NEVADA

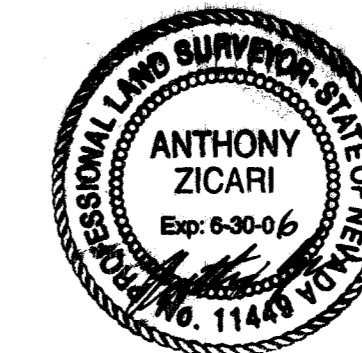

I, ANTHONY ZICARI, A PROFESSIONAL LAND SURVEYOR LICENSED IN THE STATE OF NEVADA, DO HEREBY CERTIFY THAT THE MONUMENTS HAVE BEEN SET AND THE TIE DISTANCES ESTABLISHED AS SHOWN HEREON. THIS SURVEY WAS COMPLETED ON OCTOBER 15, 2004.



ANTHONY ZICARI, P.L.S.  
NEVADA LICENSE NO. 11449

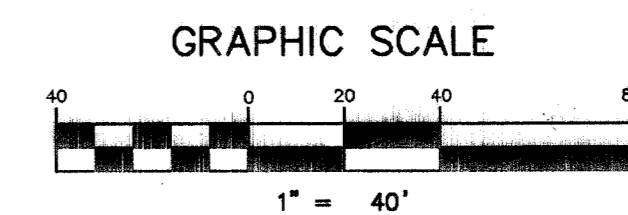
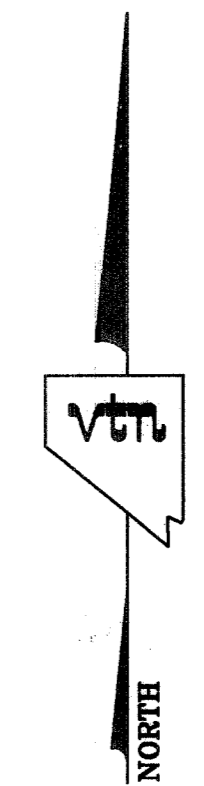

### NOTES

SEE FINAL MAP FOR BEARING AND DISTANCES.  
(BOOK 108, PAGE 0009)

### LEGEND

- 2 LOT NUMBER
- (X) BLOCK NUMBER
- RIGHT OF WAY
- LOT LINES
- SUBDIVISION BOUNDARY LINE
- STREET CENTERLINE
- BACK OF CURB LINE
- TYPE III MONUMENT - 5/8" REBAR AND AL. CAP STAMPED "VTN PLS 11449"
- TYPE IV-A REFERENCE MONUMENTS STAMPED "VTN PLS 11449" IN TOP OF CURB
- TYPE II MONUMENT - 2" BRASS CAP IN CONCRETE STAMPED "VTN PLS 11449"

SHEET 1 OF 3