

VALVE SHEET REQUIRED

YES NO

MSA- _____
 DESIGN LOAD: _____ CFM -5- _____
 SX-: _____

WELD PROCEDURES USED:

 SIGNATURE: _____
 DATE: _____

| PIG INFORMATION | | |
|-----------------|-------|-----------|
| MAKE | STYLE | CONDITION |
| | | |
| | | |

FOR STEEL ONLY:

PIPE TO SOIL: _____

ANODE INSTALLED? YES NO

IF YES, PIPE TO SOIL _____

TYPE OF PIPE COATING

TAR WRAP
 ASPHALT
 PRITEC
 FUSION BONDED EPOXY
 PLASTIC TAPE WRAP
 EXTRUDED POLY COATING
 OTHER _____

CONDITION OF PIPE COATING

EXCELLENT
 GOOD
 FAIR
 POOR
 NO COATING

CONDITION OF PIPE

IF EXPOSED, IF CUT OR COUPON,
 EXTERNAL INTERNAL
 EG GOOD IG
 ESC SLIGHT CORROSION ISC
 EHC HEAVY CORROSION IHC

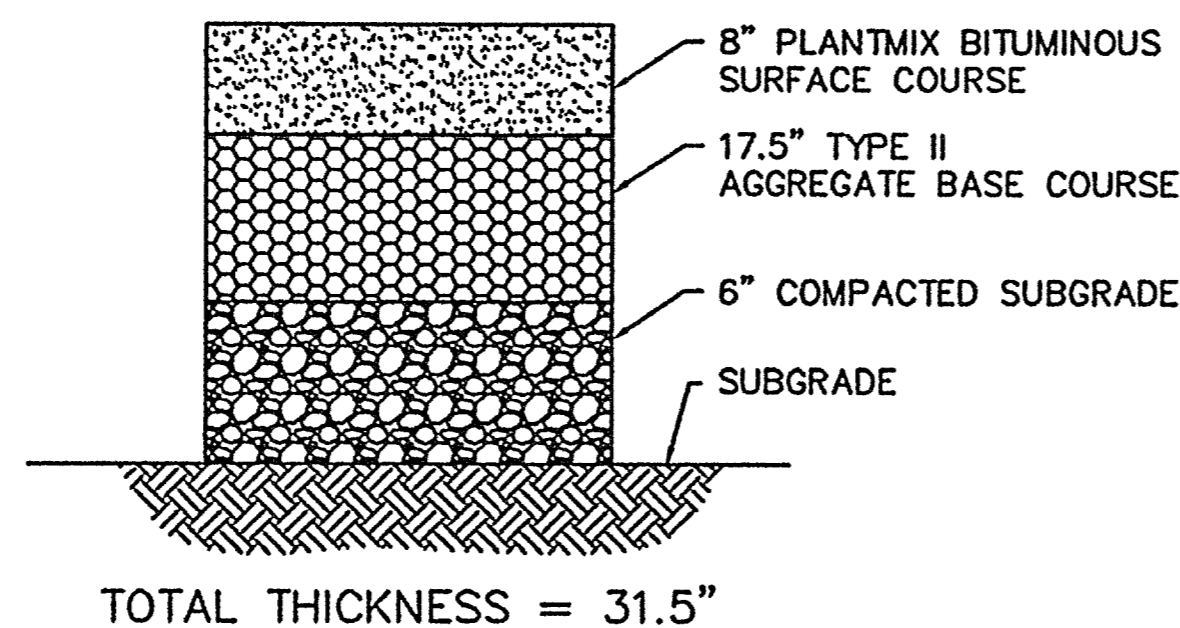

TYPICAL NEW PAVEMENT SECTION

(MARTIN L KING, LAKE MEAD, CAREY)

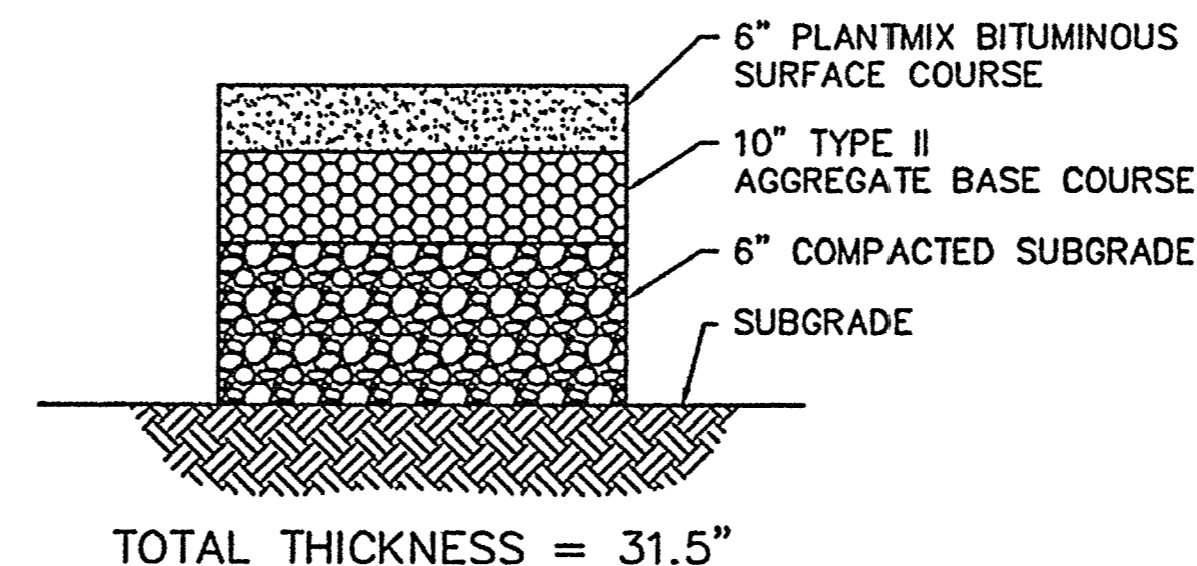

MINOR RESIDENTIAL SIDE STREET
 NEW PAVEMENT SECTION

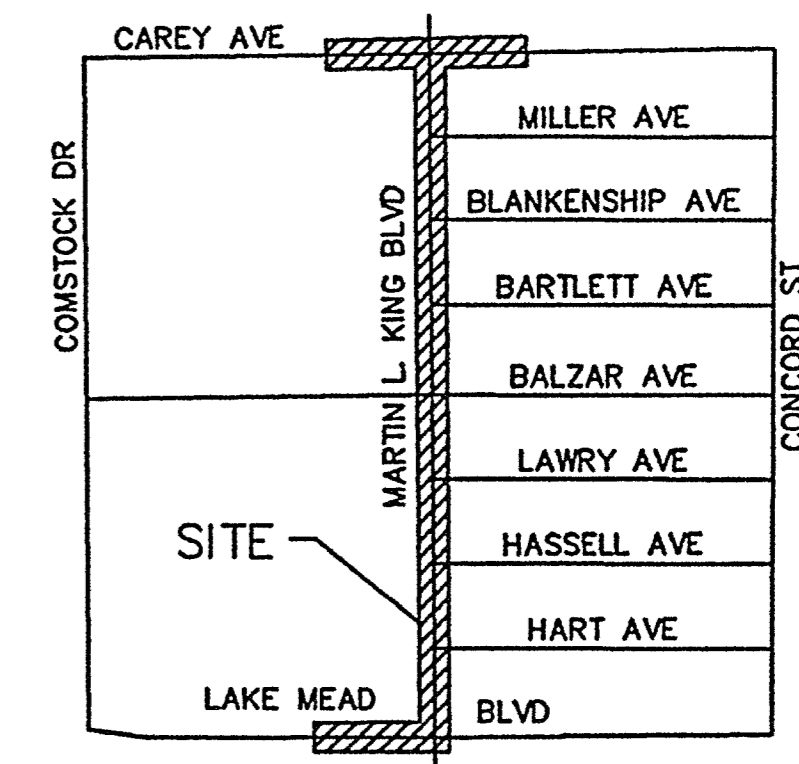

VICINITY MAP
 NTS

AC CONSTRUCTION NOTES:

SYMBOL ON EACH ADDRESSED LOT INDICATES THE FOLLOWING BASED ON RECORD INFORMATION. VERIFY INFORMATION.

- (20) NO SWG SERVICE
- (21) EXISTING SWG SERVICE, FOR INFORMATION ONLY, NO WORK REQUIRED.
- (22) TIE-OVER EXISTING 1" PE SERVICE TO NEW 2" PE MAIN IN STREET.
- (23) TIE-OVER EXISTING 2" PE SERVICE TO NEW 4" PE MAIN IN STREET.
- (24) REPLACE EXISTING 3/4" PVC SERVICE WITH 1/2" PE. INSERT 1/2" PE IN PVC WHEN PRACTICAL AND POSSIBLE. TIE-OVER SVC TO NEW MAIN IN STREET. REPLACE RISER WITH ANODELESS RISER IF EXISTING RISER IS ANODE (VERIFY).
- (25) REPLACE EXISTING 1/2" PVC SERVICE WITH 1/2" PE. INSERT 1/2" PE IN PVC WHEN PRACTICAL AND POSSIBLE. TIE-OVER SVC TO NEW MAIN IN STREET. REPLACE RISER WITH ANODELESS RISER IF RISER IS ANODE (VERIFY).
- (26) ABANDON EXISTING 3/4" STL SERVICE STUB WHEN MAIN IS ABANDONED.
- (27) ABANDON EXISTING 1" STL SERVICE STUB WHEN MAIN IS ABANDONED.

CONSTRUCTION NOTES:

1. SUGGESTED GAS LOCATIONS ARE TO CLEAR SUBSTRUCTURES. LOCATE IN FIELD.
2. GAS MAINS SHALL BE PURGED PER OPERATIONS MANUAL.
3. ALL PIPELINE CONSTRUCTION SHALL CONFORM TO APPLICABLE JURISDICTION SPECIFICATIONS.
4. DO NOT SCALE THIS DRAWING.
5. NOTIFY ENGINEERING PRIOR TO ANY DESIGN CHANGES.
6. PURGE ABANDONED LINES ACCORDING TO SWG OPERATIONS MANUAL.
7. CITY OF LAS VEGAS PERMIT REQUIRED
8. TUNNEL UNDER EXISTING CONCRETE IMPROVEMENTS, DO NOT CUT, PROTECT IN PLACE.
9. SWG IS AHEAD OF CLV MLK IMPROVEMENT PROJECT SCHEDULED FOR EARLY SUMMER 2007. SWG PAVEMENT REPAIR TO BE COLD MIX IN AREAS OF STREET RECONSTRUCTION AND MAINTAINED BY CONTRACTOR. IN AREAS OF PROPOSED COLD MILL AND OVERLAY, PAVEMENT REPAIR SHALL BE 6" MACHINE LAID, WHICH IS GENERALLY ON THE EAST SIDE OF CLV PAVING LIMITS, PAVEMENT REPAIR SHALL BE HAND PATCH. CONTRACTOR SHALL CALL ENGINEERING PRIOR TO ANY REQUEST TO UPGRADE PAVING REQUIREMENTS.
10. NEW PIPE SHALL BE INSTALLED WITH MINIMUM OF 4FT OF COVER.
11. INSTALL 5 TERMINAL C.P. TEST STATION WITH CONCRETE COLLAR. IT IS MANDATORY THAT TECHNICAL SERVICES BE PRESENT WHEN TEST STATION IS INSTALLED. CALL TECHNICAL SERVICES AT 365-2391 A MINIMUM OF 24 HOURS IN ADVANCE TO SCHEDULE.
12. INSTALL (6) 32 LB. ANODES ON EXISTING 4" STL. IT IS MANDATORY THAT TECHNICAL SERVICES BE PRESENT WHEN ANODES ARE INSTALLED. CALL TECHNICAL SERVICE AT 365-2391 A MINIMUM OF 24 HOURS IN ADVANCE TO SCHEDULE.
13. INSTALL ONE ESSENTIAL ISOLATION VALVE ON WR 585780: VALVE #1101719, 4" PE; VALVE INSPECTION WR 587815 MARTIN L. KING BLVD N/O LAKE MEAD BLVD.
14. ABANDON (1) EXISTING 4" STL ISOLATION VALVE #1101366 ON MARTIN L KING BLVD 152' N/O LAKE MEAD BLVD. ABANDON VALVE WR 606034.
15. INSTALL 5 TERM LOCATE TEST STATION ON 5" PE STUB WITH CONCRETE COLLAR. SEE SWG INSPECTOR FOR EXACT LOCATION.
16. BACK OF SIDEWALK IS NOT R/W ON SIDE STREETS DIMENSION GAS PIPE FROM CURB AND CENTERLINE OF STREET.
17. ALL STREETS ARE PUBLIC.

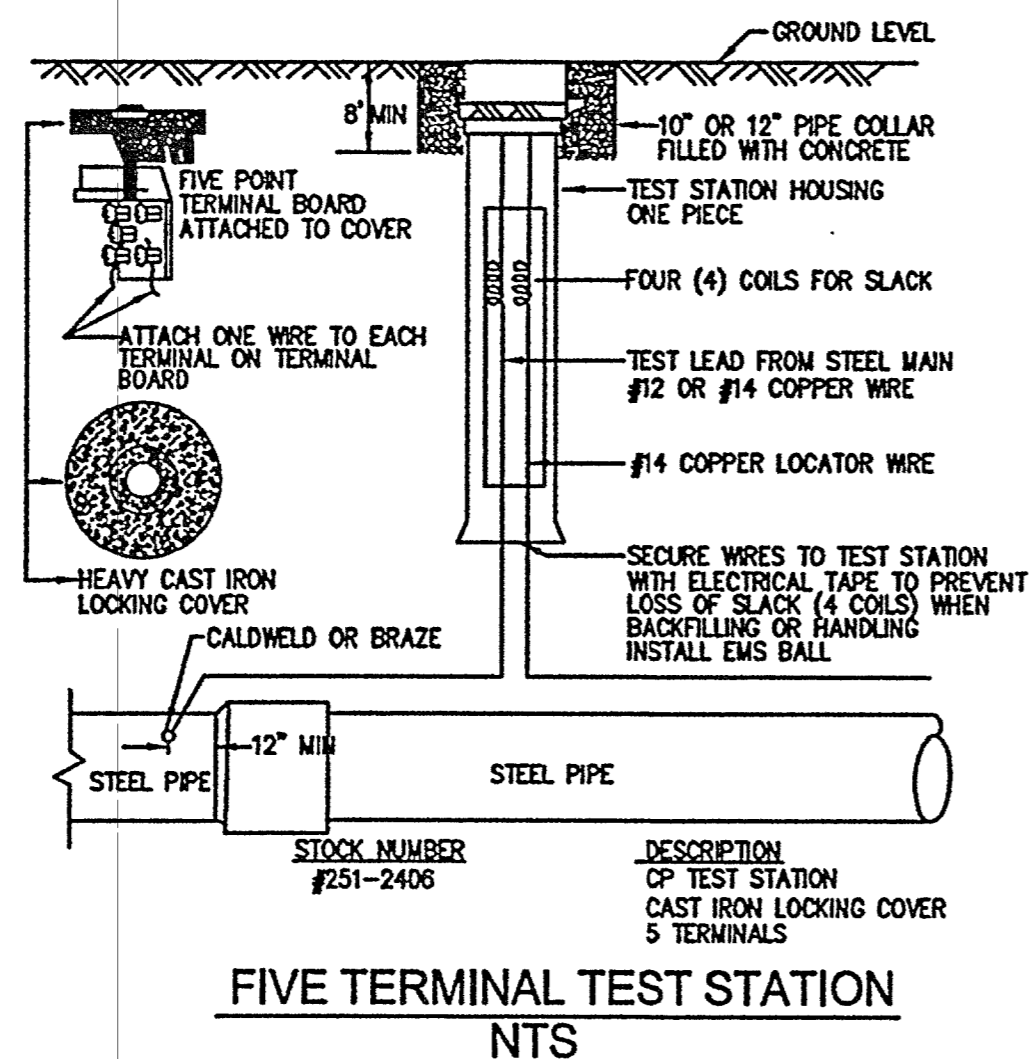

FIVE TERMINAL TEST STATION
 NTS

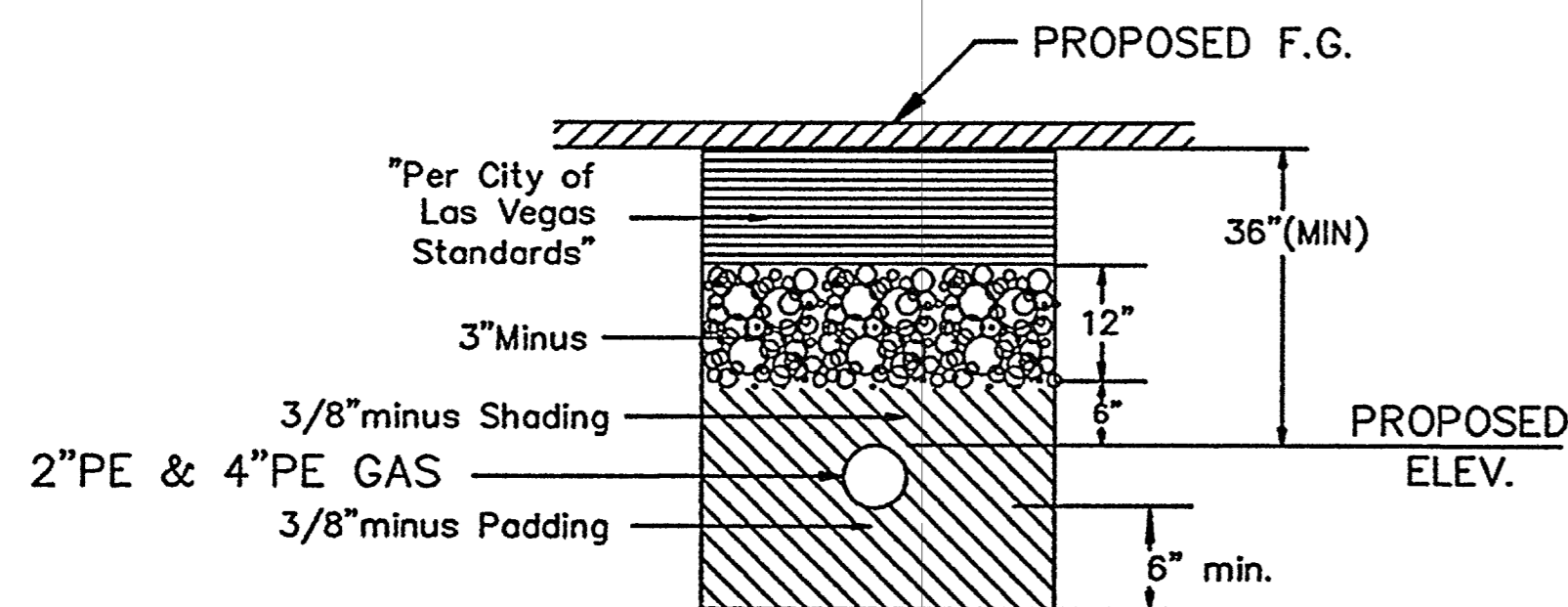

CLV TRENCH DETAIL
 FOR IMPROVED AREAS

PURGE PLAN WAS COMPLETED IN ACCORDANCE WITH THE OPERATIONS MANUAL GUIDELINES BY:

NAME _____

DATE _____

APPROVED FOR CONSTRUCTION

THIS APPROVAL IS FOR WORK IN CLV R/W OR CLV EASEMENTS ONLY. OBTAINING PERMISSIONS OR EASEMENTS FOR WORK SHOWN ON PRIVATE PROPERTY IS THE RESPONSIBILITY OF THE UTILITY.

Joe D. Christensen
 CITY ENGINEER

6-14-07
 DATE

TOTAL FOOTAGE LOCATED IN PUBLIC ROW 5,070'

| LEGEND | |
|--------|-------------------|
| ----- | Proposed gas main |
| _____ | Existing gas main |
| ----- | Right of way |
| /// | Curb/Gutter |

AREA 3S_LV_16

107N4655-SWG-PH 2

CALL BEFORE YOU DIG
 CAN YOU DIG IT!
 1-800-227-2600
 (48Hrs. Advance Notice Required)

| NO. | DESCRIPTION | BY | DATE | APPVD. | AS-BUILT DRAWING-PRESSURE TEST DATA | | VISUAL INSPECTION CERTIFICATION | | CONSTRUCTION | | ISOLATION AREA | | W. R. NO. | | ENGINEER/TECHNICIAN BOB MIDDAG | |
|-----------|-------------|----|------|--------|-------------------------------------|-------------|---------------------------------|------|------------------|-----------|----------------|--------|----------------|----------------|---|--|
| | | | | | PIPE DIA. | TEST MEDIUM | TEST METHOD | NAME | DATE | INSPECTOR | FOREMAN | 92, 83 | 585780 | PHONE 365-2071 | | |
| | | | | | 3760206 | 6" STL | 67' | | | | | | | | | |
| | | | | | 3760204 | 4" STL | 3461' | | | | | | | | | |
| | | | | | 3760202 | 2" STL | 5' | | | | | | | | | |
| | | | | | 3760104 | 4" PE | 4419' | 151' | | | | | | | | |
| | | | | | 3760102 | 2" PE | 651' | 60' | | | | | | | | |
| | | | | | 3760602 | 2" PVC | 1983' | | | | | | | | | |
| REVISIONS | | | | | TEST PRES. (PSIG) | | START | | END | | LOCATION | | ATLAS #/TILE # | | TITLE | |
| | | | | | TIME | | DATE | | DATE | | SEC 21 | | X624Y526 | | F - CLV - MARTIN L KING BLVD. IMPROVEMENTS PHASE II LAKE MEAD BLVD TO CAREY AVE | |
| | | | | | DATE | | PERFORMED BY | | DATE | | T20S R61E | | X624Y528 | | FILENAME: 21_155216 | |
| | | | | | UNIT NO. | | UNIT TYPE | | POSTING Q.C'D BY | | | | | | | |
| | | | | | INSTL. | | RET. | | | | | | | | | |
| | | | | | PROPOSED | | COMPLETED | | | | | | | | | |
| | | | | | | | | | | | | | | | | |

