

FOR CONTINUATION SEE SHEET C4.01

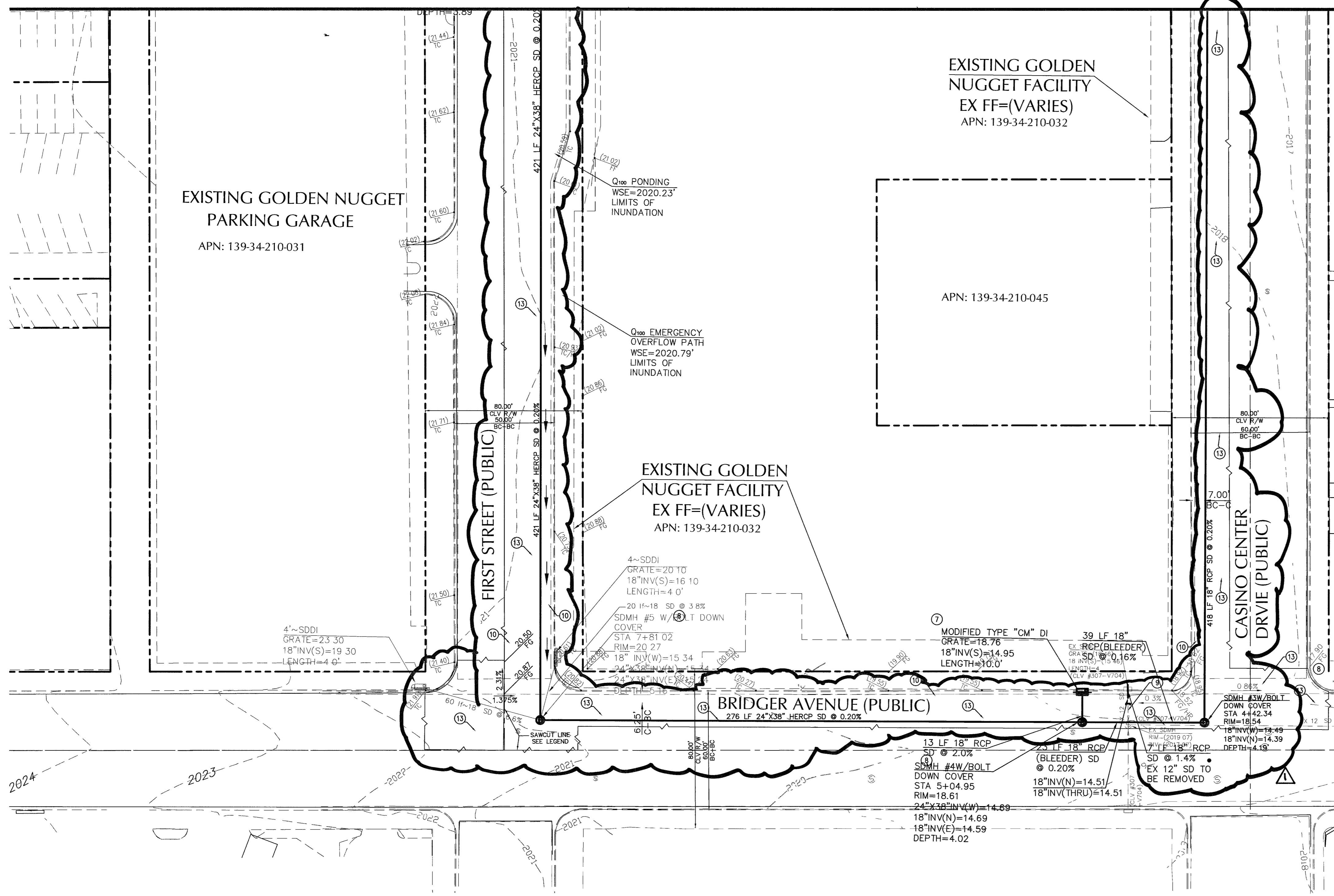

GRAPHIC SCALE

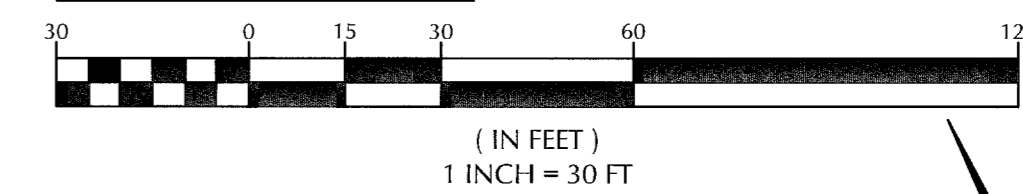

BASIS OF BEARING

S 62°04'31"E BEING THE CENTERLINE OF BRIDGER AVENUE AS DELINEATED ON THAT RECORD OF SURVEY IN FILE 67 PAGE 79, OFFICIAL RECORDS OF CLARK COUNTY, NEVADA

BENCHMARK

BM 1LV01 34NW6 - 3" NDOT BRASS CAP IN TOP OF CURB @ SE CORNER OF MAIN AND BRIDGER ELEVATION = 2025.50 (617.3727 N) (NAVD 88)

CONSTRUCTION NOTES

1. CONSTRUCT "L" TYPE CURB AND GUTTER PER CCUSD NO. 216.
2. CONSTRUCT "A" TYPE CURB ONLY PER CCUSD NO. 219.
3. CONSTRUCT SIDEWALK PER CCUSD NO. 234.
4. EXISTING STORM DRAIN LINES WITHIN PROPOSED BUILDING LIMITS TO BE ABANDONED. SEE MECHANICAL PLANS FOR MORE INFORMATION.
5. EXISTING STORM DRAIN DROP INLET TO BE REMOVED.
6. CONSTRUCT 2'X2' JENSEN PRECAST AREA DRAIN WITH 1' CONCRETE COLLAR PER DETAIL F OF SHEET C8.01.
7. CONSTRUCT TYPE "CM" DROP INLET PER DETAIL G OF SHEET C8.01.
8. CONSTRUCT STORM DRAIN MANHOLE PER PLAN AND CCUSD NO. 403.
9. CAP EXISTING STORM DRAIN LINE.
10. TRENCH, BACKFILL, AND REPLACE AC PAVEMENT PER CCUSD NO. 504.
11. CONSTRUCT 0" CURB.
12. CONSTRUCT 0" TO 6" CURB TRANSITION.
13. REMOVE EXISTING VALLEY GUTTER AND REPLACE WITH (5") AC PAVEMENT MIX DESIGN I-C-15R--5-PG2006 BY MMT.LLC

LEGEND

FUTURE	EXISTING	PROPOSED	DESCRIPTION	FUTURE	EXISTING	PROPOSED	DESCRIPTION
W	W	W	WATER LINE	SS	SS	SS	SLOPE
SS	SS	SS	SANITARY SEWER LINE	SD	SD	SD	ELEVATION/GRADING TAG
SD	SD	SD	GAS LINE	PL	PL	PL	RIGHT-OF-WAY-PL
SD	SD	SD	STORM DRAIN	PL	PL	PL	ADJACENT-PL
PL	PL	PL	POWER LINE/POLE	PL	PL	PL	CENTERLINE
PL	PL	PL	TELEPHONE LINE	PL	PL	PL	EASEMENT LINE
PL	PL	PL	FIRE HYDRANT	PL	PL	PL	FLOW LINE
PL	PL	PL	FIRE DEPARTMENT CONNECTION	PL	PL	PL	CONTOUR
PL	PL	PL	WATER VALVE	PL	PL	PL	SCREEN/RETAINING WALL
PL	PL	PL	GAS VALVE	PL	PL	PL	CHAIN LINK FENCE
PL	PL	PL	METERS/PULL BOXES	PL	PL	PL	WIRE FENCE
PL	PL	PL	REDUCER	PL	PL	PL	GUARDRAIL
PL	PL	PL	MANHOLE	PL	PL	PL	SIGN POLE
PL	PL	PL	CLEANOUT	PL	PL	PL	6" TYPE "A" CURB
PL	PL	PL	SEWER MANHOLE	PL	PL	PL	24" TYPE "L" CURB & GUTTER
PL	PL	PL	STORM MANHOLE	PL	PL	PL	30" ROLL CURB
PL	PL	PL	UTILITY POLE	PL	PL	PL	CONCRETE FINISH FLOOR
PL	PL	PL	DRAIN INLET	PL	PL	PL	MISCELLANEOUS
PL	PL	PL	AREA LIGHT	PL	PL	PL	SAWCUT LINE
PL	PL	PL		PL	PL	PL	GRADE BREAK
PL	PL	PL		PL	PL	PL	PROPOSED BUILDING DEMOLITION OF EX AC PAVEMENT AC PAVEMENT PATCH
PL	PL	PL		PL	PL	PL	100 W H.P.S.
PL	PL	PL		PL	PL	PL	150 W H.P.S.
PL	PL	PL		PL	PL	PL	200 W H.P.S.
PL	PL	PL		PL	PL	PL	250 W H.P.S.
PL	PL	PL		PL	PL	PL	100 YEAR OVERFLOW PATH

STORM DRAIN MANHOLE SCHEDULE

MH#	ID	TYPE	STATION	OFFSET	RIM EL	18"INV(S)	EX 18" INV(THRU)	18"INV(W)	18"INV(THRU)	18"INV(N)	18"INV(E)	24"X38" INV(W)	24"X38" INV(N)	24"X38" INV(E)	24"X38" INV(S)	18" INV(N/E)	COMMENTS
1	SD-1	STA: 0+00.00	PRIVATE		20.73±	15.01	15.01										NA
2	SD-1	STA: 0+32.98	CASINO CENTER	21.38' LT	17.65±			13.56	13.56								BOLT DOWN MH COVER
3	SD-1	STA: 4+42.34	BRIDGER AVE.	22.85' LT	18.54			14.45									BOLT DOWN MH COVER
4	SD-1	STA: 5+04.95	BRIDGER AVE.	23.11' LT	18.61					14.67	14.57	14.67					BOLT DOWN MH COVER
5	SD-1	STA: 7+81.02	BRIDGER AVE.	24.23' LT	20.27							15.21		15.11			BOLT DOWN MH COVER
6	SD-1	STA: 11+93.58	FIRST ST.	19.05' RT	19.84					16.05				15.95			BOLT DOWN MH COVER
7	SD-1	STA: 12+20.90	FIRST ST.	19.04' RT	19.65			16.34						16.10	16.10		BOLT DOWN MH COVER
8	SD-1	STA: 13+48.00	FIRST ST.	19.34' RT	20.09	16.27										16.37	NA

FLOOD ZONE NOTE:  
THE PROJECT SITE LIES WITHIN ZONE X AS PER FEMA FIRM PANEL 32003C2170E DATED SEPTEMBER 27, 2002.

GENERAL NOTE:  
IT IS THE CONTRACTOR'S RESPONSIBILITY TO FILE A NOTICE OF INTENT/REQUEST TO BE INCLUDED IN THE STORM WATER GENERAL PERMIT, AND SUBMIT THE ASSOCIATED STORMWATER POLLUTION PREVENTION PLAN (SWPPP) AS REQUIRED BY FEDERAL LAW, AND MONITORED BY THE NEVADA DIVISION OF ENVIRONMENTAL PROTECTION.

NOTE TO CONTRACTOR:  
CONTRACTOR SHALL PROVIDE EROSION CONTROL IN ALL LANDSCAPE AREAS WHERE ROOF DRAINS DISCHARGE TO GRADE UNLESS OTHERWISE NOTED HEREON.

NOTE:  
MODIFICATION OF PAVEMENT CURB & GUTTER AND INSTALLATION OF DROP INLETS AT FIRST STREET AND CASINO CENTER DRIVE TO ELIMINATE VALLEY GUTTERS.

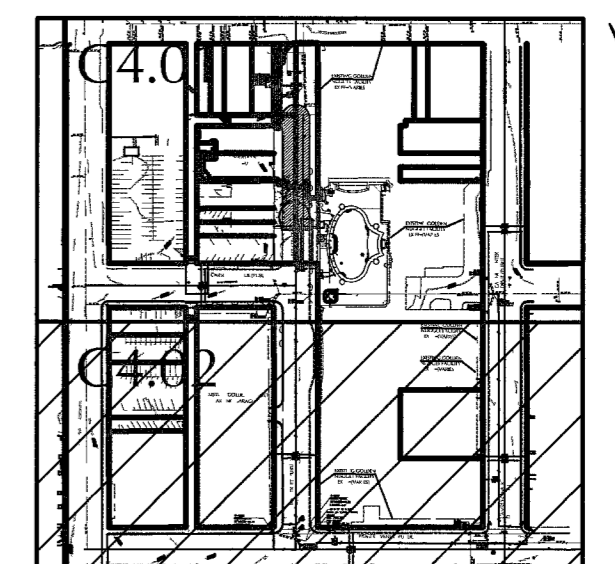
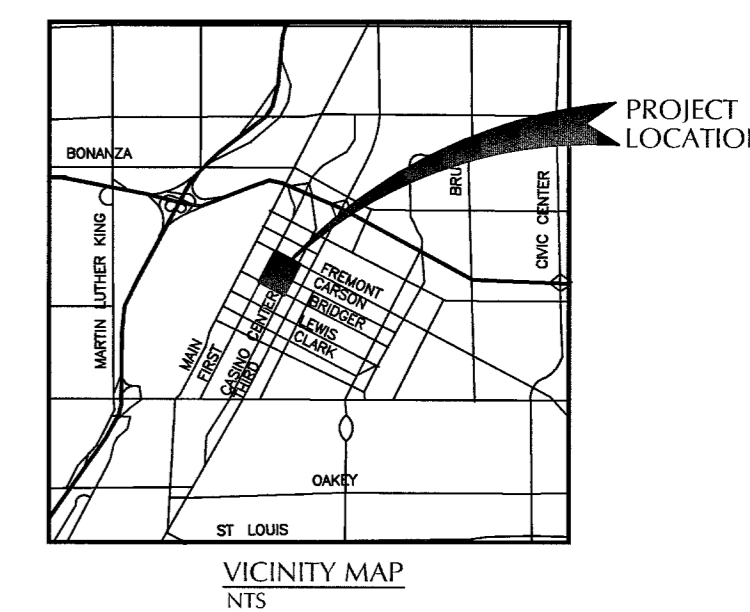

NO.	DESCRIPTION OF REVISIONS	DATE	INITIALS
1	REMOVE VALLEY GUTTER, REPLACE WITH SPECIAL AC MIX DESIGN, REGRADE AS NECESSARY. ADD (2) SD INLETS & 80 LF STORM DRAIN PIPR.	10-11-06	JDM

GNLY CORPORATION  
P.O. BOX 610  
LAS VEGAS NEVADA 89125

MARTIN & MARTIN  
CIVIL ENGINEERS  
2101 S. JONES, SUITE 120  
LAS VEGAS, NV 89125  
PHONE (702) 248-8000  
FAX (702) 248-8070

GRADING PLAN  
GOLDEN NUGGET TOWER ADDITION

DATE: 10/12/06  
JOB NUMBER: 2107.02  
DESIGN BY: J. PATCHETT, E.I.  
DRAWN BY: B. FUNK  
CHECKED BY: R. STRIEGEL, P.E.

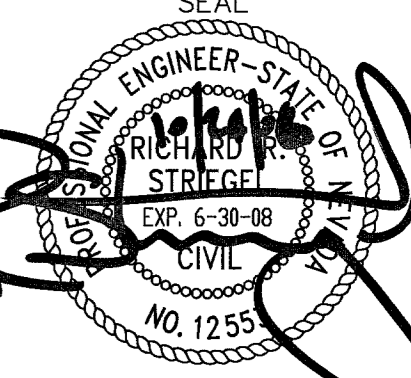

SHEET  
**C4.02**  
SHEET 6 OF 14  
DRAWING NUMBER  
107V4611-2

9738/

AVOID HITTING UNDERGROUND TRAFFIC SIGNAL AND STREET LIGHT SYSTEMS AT ANY COST.

CALL BEFORE YOU DO UNDERGROUND WORK  
CALL 1-702-455-7511

AVOID HITTING OVERHEAD POWER LINES AT ANY COST.

CALL BEFORE YOU DO OVERHEAD WORK  
CALL 1-702-227-2929

AVOID CUTTING UNDERGROUND UTILITY LINES AT ANY COST.

CALL BEFORE YOU DO UNDERGROUND SERVICE (UGS)  
CALL 1-800-227-2600

MARTIN & MARTIN ASSUMES NO RESPONSIBILITY FOR EXISTING UTILITY LOCATIONS AND ELEVATIONS. THE UTILITIES SHOWN ON THIS DRAWING HAVE BEEN PLOTTED FROM THE BEST AVAILABLE INFORMATION. IT IS, HOWEVER, THE CONTRACTOR'S RESPONSIBILITY TO FIELD VERIFY THE LOCATION AND ELEVATION OF ALL UTILITIES PRIOR TO THE COMMENCEMENT OF ANY CONSTRUCTION. CONTRACTOR TO FIELD VERIFY ALL EXISTING SITE CONDITIONS PRIOR TO CONSTRUCTION. IF A CONFLICT EXISTS BETWEEN WHAT IS SHOWN ON THESE DRAWINGS AND WHAT EXISTS IN THE FIELD, THE CONTRACTOR IS TO NOTIFY THE ARCHITECT OR ENGINEER IMMEDIATELY.