

- LEGEND**
- CENTER LINE
 - - - - - R/W LINE
- PROPOSED EXISTING
- CONDUIT □
 □ EMBARQ PULL BOX □
 □ EMBARQ MANHOLE □
- ① 1-2" PVC, DB-60 GRADE (EST. 46')
 ② 2-2" PVC, DB-60 GRADE (EST. 100')
 ③ 3-2" PVC, DB-60 GRADE (EST. 28')
 ④ 4-2" PVC, DB-60 GRADE (EST. 46')
 ⑤ 2-4" PVC, DB-100 GRADE (EST. 308')
 ⑥ 2" RGS 36" 90° BENDS DOUBLE WRAPPED 10 MIL PVC TAPE. (8 EA)
 ⑦ EMBARQ PULL BOX 3'-0"X5'-0"X4'-0" (1 EA)
 ⑧ PLACE 1-2" EMT UP ON BUILDING. (EST. 101')
 ⑨ PLACE JUNCTION BOX. (2)
 ⑩ PLACE LB. (1)

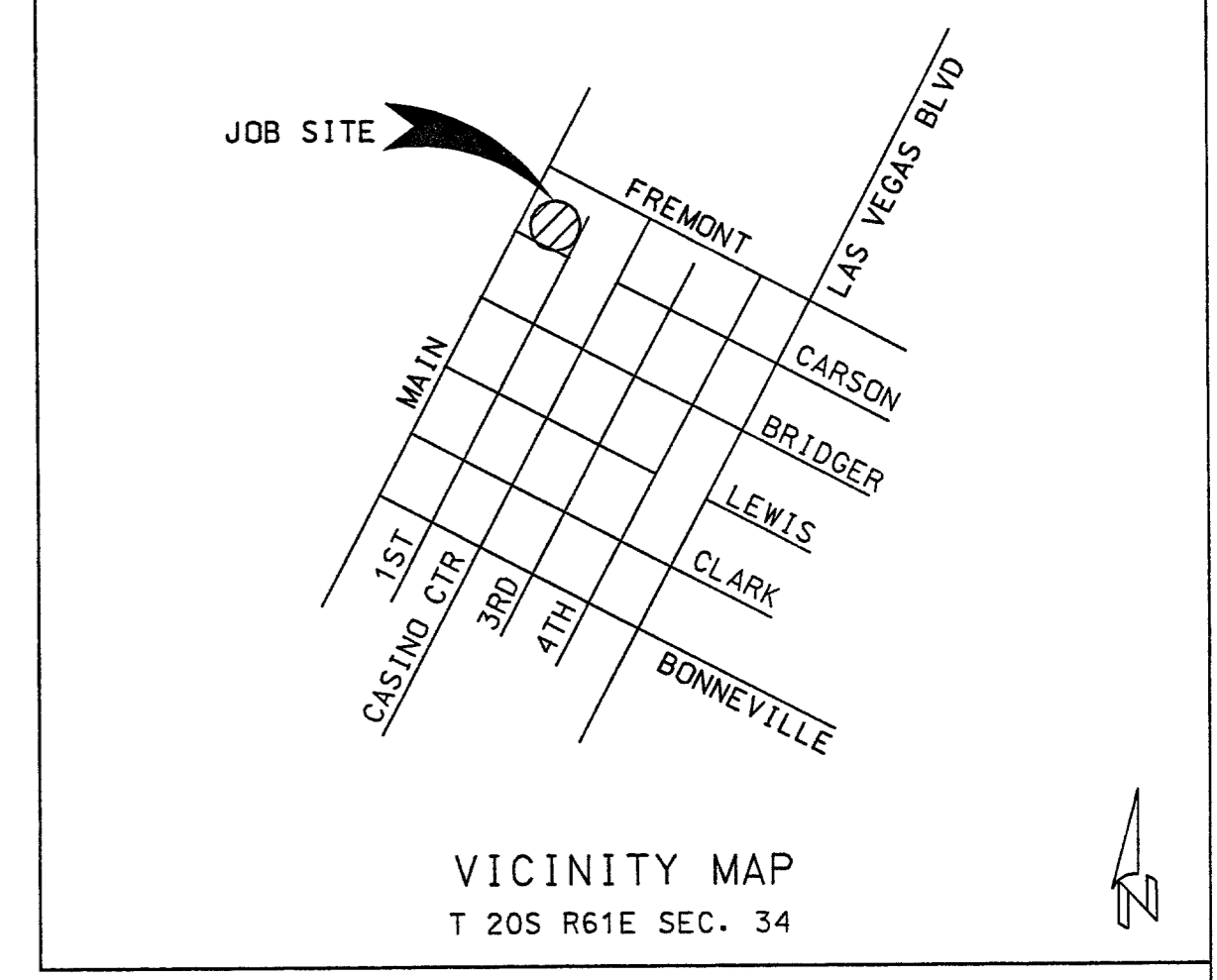

CONSTRUCTION NOTES

SAFETY FIRST - APPLIES TO ALL PHASES OF THIS PROJECT

1. ALL CONSTRUCTION SHALL CONFORM TO EMBARQ UNDERGROUND SPECIFICATIONS.
2. THIS DRAWING SHOWS APPROXIMATE LOCATIONS OF KNOWN UTILITIES IN THE IMMEDIATE VICINITY OF THE WORK TO BE DONE, BUT EMBARQ DOES NOT GUARANTEE OR ASSUME LIABILITY FOR THEIR POSITION OR DEPTH. THE CONTRACTOR SHALL DETERMINE TO HIS SATISFACTION THE ACTUAL POSITION OR DEPTH OF THE EXISTING UTILITIES AND PROVIDE FOR THEIR INTERFERENCE DURING THE TIME OF THE ORIGINAL BID AS HE WILL ASSUME THIS LIABILITY DURING THE PERFORMANCE OF THIS WORK.
3. THE CONTRACTOR SHALL FURNISH ALL LABOR, EQUIPMENT AND MATERIAL NECESSARY FOR THE COMPLETION OF THIS WORK.
4. THE CONTRACTOR SHALL REMOVE, REPLACE AND/OR RELOCATE ANY SURFACE OR SUBSURFACE OBSTRUCTIONS AS REQUIRED AT HIS EXPENSE. (I.E. CURB, ASPHALT, CONCRETE, UTILITIES, ETC.)
5. CALL 244-7811 TO SCHEDULE INSPECTIONS TWENTY FOUR (24) HOURS IN ADVANCE. REQUESTS RECEIVED AFTER 11:00AM MAY NOT BE SCHEDULED FOR THE FOLLOWING WORK DAY.
6. THE CONTRACTOR SHALL INSTALL A TAPERED POLYETHYLENE DUCT PLUG WITH PULL STRING TAB IN ALL CONDUIT, TERMINATED OR CAPPED ASSOCIATED WITH THIS PROJECT.
7. THE CONTRACTOR SHALL PROVIDE AND INSTALL A WATERPROOF 400-LB. TENSILE STRENGTH MEASURING TAPE MARKED IN ONE FOOT INCREMENTS, IN AT LEAST ONE DUCT OF EACH CONDUIT SECTION. ALL OTHER CONDUIT IN A MULTIPLE DUCT SYSTEM SHALL HAVE A 3/32 INCH JETLINE PULL STRING WITH 400-LB. TENSILE STRENGTH.
8. ALL TRENCHES SHALL BE OF A MINIMUM DEPTH TO MAINTAIN A 36 INCH COVER OVER ALL FACILITIES AND A 12 INCH MINIMUM SEPARATION FROM FOREIGN UTILITIES. COMPACT ALL BACKFILL TO 95% COMPACTION AND COMPLY TO ALL GOVERNMENT ENTITY REQUIREMENTS.
9. AN APPROVED SAND ENVELOPE SHALL BE INSTALLED AROUND ALL CONDUIT PRIOR TO BACK FILLING (UNLESS ENCASED IN CONCRETE.)
10. THE CONTRACTOR SHALL PROVE AND MANDREL ALL CONDUIT IN THE PRESENCE OF AN EMBARQ CONDUIT INSPECTOR AND PROVIDE AN AS-BUILT WITH THOSE MEASUREMENTS IN RED WHEN SUBMITTING A FINAL INVOICE FOR COMPLETION OF THIS WORK.
11. THE CONTRACTOR WILL BE RESPONSIBLE TO RESTORE THE WORK AREA BACK TO THE ORIGINAL CONDITION OR BETTER UPON COMPLETION OF THIS PROJECT.
12. ALL CONDUIT SHALL BE DB-100 OR APPROVED EQUAL PER A.S.T.M. SPECIFICATIONS AND JOINED USING AN APPROVED CONTACT CEMENT WITH SURFACE PRIMER.
13. ALL CONDUIT SWEEPS WITH A RADIAL BEND LESS THAN FORTY FEET SHALL BE FACTORY FORMED UNLESS OTHERWISE SPECIFIED.
14. ALL CONDUIT SPLAYS WILL BE A MINIMUM OF 30 FEET IN LENGTH UNLESS SPECIFIED OTHERWISE.
15. THE CONTRACTOR WILL BE REQUIRED TO RETURN AT A LATER DATE TO ADJUST VAULT LIDS TO FINISH GRADE IF ANY ADJUSTMENTS ARE REQUIRED BY A GOVERNMENT ENTITY FOR ROAD IMPROVEMENTS OR EMBARQ CHOOSES TO HAVE THOSE LIDS ADJUSTED FOR ANY REASON.

READ BEFORE BEGINNING CONSTRUCTION!!

ALL EXISTING BUSINESS IN THIS AREA ARE BEING SERVED BY AERIAL FACILITIES. THEREFORE, THIS WORK MUST BE DONE IN PHASES TO ALLOW THE TRANSITION FROM AN OVERHEAD TO UNDERGROUND SYSTEM. THE CONSTRUCTION COMPANY THAT PERFORMS THE TELEPHONE WORK MUST COORDINATE CLOSELY WITH EMBARQ ENGINEERS IN ORDER TO MAINTAIN EXISTING SERVICES.
 FACILITY ENGINEER: LEN BELLOWTS AT 244-7839
 CONDUIT ENGINEER: JANE STOKES AT 244-7806

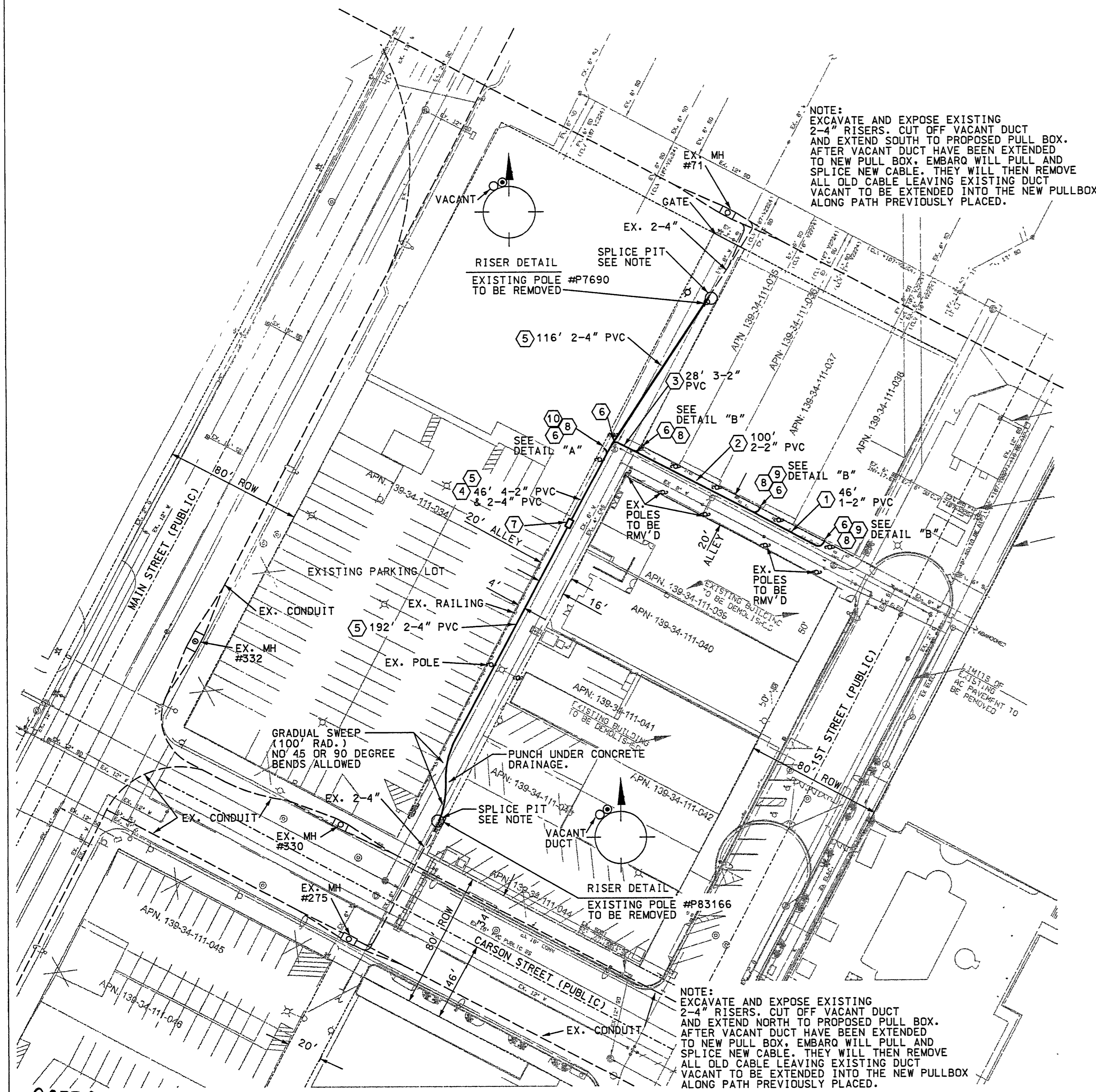
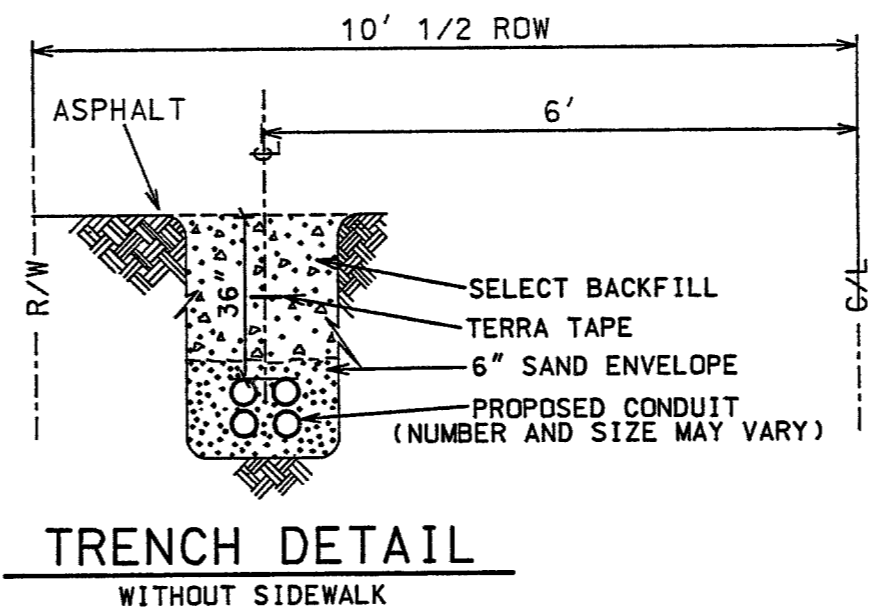

Len Bellows 11/9/06
 REVIEWED BY FACILITY ENGINEER DATE

APPROVED FOR CONSTRUCTION
 THIS APPROVAL IS FOR WORK IN CLV R/W OR CLV EASEMENTS ONLY. OBTAINING PERMSSIONS OR EASEMENTS FOR WORK SHOWN ON PRIVATE PROPERTY IS THE RESPONSIBILITY OF THE UTILITY.

CITY OF LAS VEGAS PERMIT REQUIRED*	
DEVELOPER/CONTRACTOR SHALL OBTAIN A CITY PERMIT BEFORE ANY EXCAVATION WORK WITHIN CITY OF LAS VEGAS RIGHT OF WAY	
* EMBARQ INSPECTOR WILL VERIFY CITY PERMIT FOR WORK DONE WITHIN CITY OF LAS VEGAS RIGHT-OF-WAY	
INSPECTOR:	DATE

EMBARQ PROPRIETARY CONSTRUCTION PERMIT REQUIRED BY CONTRACTOR

Jane Stokes 12/6/06
 APPROVAL DATE

	NO.	REVISION	ENGR.	MGR.	DATE:
<p>Call before you Dig.</p> <p>1-800-227-2600</p> <p>UNDERGROUND SERVICE USA!</p>	TITLE	DESIGNER	W.D.		
	OFF-SITE CONDUIT FEEDER FOR GOLDEN NUGGET TOWER ADDITION RELOCATION	S. PEREZ	24196842		
	L.C.	PHONE 244-1352	C.D. MAIN		
		APPROVED BY J. STOKES	ISSUE DATE		
		SCALE 1" = 40'	SHT. 1 OF 1		