

**PROPOSED SEWER NOTES:**

- 1 SSMH 1 STA 12+56.87 RIM 1780.90 INV OUT= 1775.13
- 2 SSMH 2 STA 11+29.68 RIM 1780.39 INV IN= 1774.38 W INV OUT= 1774.18 S
- 3 SSMH 3 STA 8+13.16 RIM 1777.29 INV IN= 1771.99 N INV OUT= 1771.79 S
- 4 SSMH 4 STA 6+59.04 RIM 1777.98 INV IN= 1770.91 N INV OUT= 1770.71 E
- 5 SSMH 5 STA 1+40 RIM 1778.98 INV IN= 1770.43 W INV OUT= 1770.23 S
- 6 SSMH 6 STA 5+91.02 RIM 1778.38 INV IN= 1771.28 W INV OUT= 1771.08 N
- 7 SSMH 7 STA 4+04.29 RIM 1778.53 INV IN= 1771.95 S INV OUT= 1771.75 N
- 8 SSMH 8 STA 1+69.93 RIM 1775.62 INV OUT= 1772.354
- 9 SSMH 9 STA 25+22.16 RIM 1780.10 INV OUT= 1774.66
- 10 SSMH 10 STA 28+27.16 RIM 1778.70 INV IN= 1773.14 N INV OUT= 1772.94 S
- 11 SSMH 11 STA 29+86.16 RIM 1778.90 INV IN= 1772.14 N INV IN= 1772.14 S INV OUT= 1771.94 E
- 12 SSMH 12 STA 33+53.16 RIM 1778.60 INV OUT= 1773.98
- 13 EXMH TO BE REPLACED RIM 1774.42 INV IN= 1769.76 (INV IN= 1769.71) 8" (INV IN= 1769.78) 8" (INV OUT= 1769.58) 12" E
- 14 SSMH 14 STA 0+24.52 RIM = 1780.04 INV IN= 1769.99 N INV OUT = 1769.79 E

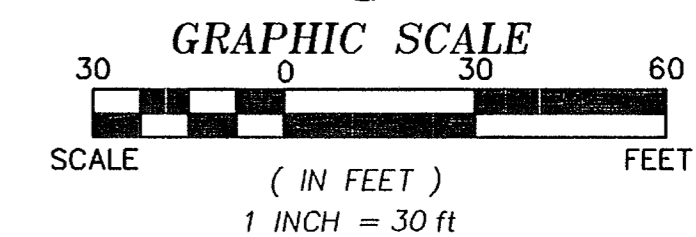
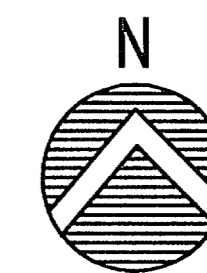
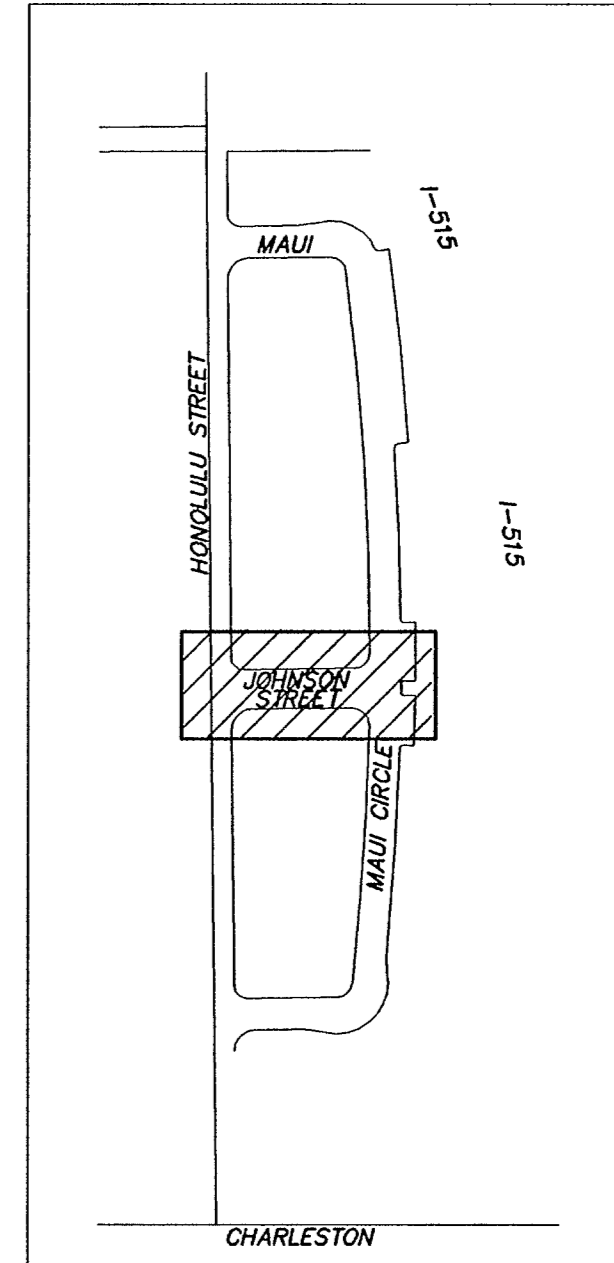

**BASIS OF BEARING**

SOUTH 89°57'23" EAST BEING THE SOUTH LINE OF THE SOUTHWEST QUARTER (SW 1/4) OF SECTION 31, TOWNSHIP 20 SOUTH, RANGE 62 EAST, M.D.M., CITY OF LAS VEGAS, CLARK COUNTY, NEVADA, AS SHOWN BY MAP THEREOF ON FILE IN FILE 68 PAGE 52 OF SURVEYS IN THE CLARK COUNTY RECORDER'S OFFICE, CLARK COUNTY, NEVADA.

**BENCHMARK**

CITY OF LAS VEGAS BENCHMARK # 6002 31SSWS RIVET AND PLATE IN THE TOP OF CURB AT THE NORTHEAST CORNER OF CHARLESTON AND HONOLULU.

ELEVATION:  
541.8569 METERS (NAVD 88)  
1777.74 FEET (NAVD 88)

**CONSTRUCTION NOTES**

- 1 CONSTRUCT 'A' TYPE CURB PER CCASD #219
- 2 CONSTRUCT 'L' TYPE CURB & GUTTER PER CCASD #216
- 3 CONSTRUCT SIDEWALK RAMP PER CCASD #235 CASE 1 OR CASE II WHERE NOTED
- 4 CONSTRUCT SIDEWALK PER CCASD #234
- 5 CONSTRUCT ASPHALT PAVEMENT. SEE DETAIL SHEET C-24
- 6 CONSTRUCT VALLEY GUTTER PER CCASD #229
- 7 MATCH EXISTING ELEVATION
- 8 CONSTRUCT SPANDREL PER CCASD #228
- 9 CONSTRUCT 0" HIGH 'A' TYPE CURB
- 10 CONSTRUCT RIP RAP CHANNEL PER DETAIL "N" SHEET C-25
- 11 CONSTRUCT PAN DRIVEWAY PER CCASD #222
- 12 NOT USED
- 13 CONSTRUCT 10 LF WROUGHT IRON FENCE PER DETAIL "L" SHEET C-25
- 14 CONSTRUCT 30" SIDEWALK UNDERDRAIN PER CCASD #236
- 15 CONSTRUCT 2" SIDEWALK UNDERDRAIN PER CCASD #236
- 16 CONSTRUCT 4" SIDEWALK UNDERDRAIN PER CCASD #236
- 17 CONSTRUCT WROUGHT IRON FENCE PER DETAIL "L" SHEET C-25

**SEWER CONSTRUCTION NOTES (PRIVATE)**

- 1 STUB AND CAP SEWER, FOR CONTINUATION SEE PLUMBING PLANS
- 2 INSTALL 4" SEWER LATERALS PER DCSWCS PLATE SD-18
- 3 INSTALL 10" PVC SEWER MAIN & SEWER TRENCH PER DCSWCS PLATE SD-16B
- 4 INSTALL SEWER 48" MANHOLE PER DCSWCS PLATE SD-1
- 5 REMOVED EX MANHOLE AND INSTALL SEWER 48" MANHOLE PER PLATE SD-1
- 6 INSTALL 8" PVC SEWER MAIN & SEWER TRENCH PER DCSWCS PLATE SD-16B
- 7 INSTALL 8" C-900 SEWER MAIN & SEWER TRENCH PER DCSWCS PLATE SD-16B
- 8 INSTALL CONCRETE SLEEVE ON 8" SEWER PER U.D.A.C.S. PLATE #16

**NOTE:**

ALL PRIVATE DRIVES ARE PUBLIC UTILITY EASEMENT, PRIVATE SEWER EASEMENTS, AND PUBLIC DRAINAGE EASEMENTS TO BE PRIVATELY MAINTAINED BY THE CITY OF LAS VEGAS HOUSING AUTHORITY.

**WATER CONSTRUCTION NOTES**

- 1 STUB AND CAP WATER, FOR CONTINUATION REFERENCE PLUMBING PLANS
- 2 INSTALL 11.25" BEND PER UDACS PL #5. SIZE PER PLAN.
- 3 INSTALL 45" BEND PER UDACS PL #5. SIZE PER PLAN.
- 4 INSTALL 90" BEND PER UDACS PL #5. SIZE PER PLAN.
- 5 INSTALL 3" METER PER UDACS #10
- 6 INSTALL 3" RPPA PER UDACS PL #11B
- 7 CONNECT TO 8" WATERLINE W/ 1" SERVICE SADDLE & CORP. STOP
- 8 INSTALL FIRE HYDRANT PER UDACS PL #7
- 9 INSTALL 8" X 6" REDUCER
- 10 INSTALL 8" X 8" TEE
- 11 INSTALL 6" X 6" TEE
- 12 PROVIDE AND INSTALL 8" DCCA PER UDACS STD. PLATE #11D.
- 13 INSTALL GATE VALVE PER UDACS STD PLATE #3. SIZE PER PLAN.
- 14 INSTALL 5.25" BEND PER UDACS PL #5. SIZE PER PLAN.
- 15 INSTALL 8" X 8" X 6" TEE

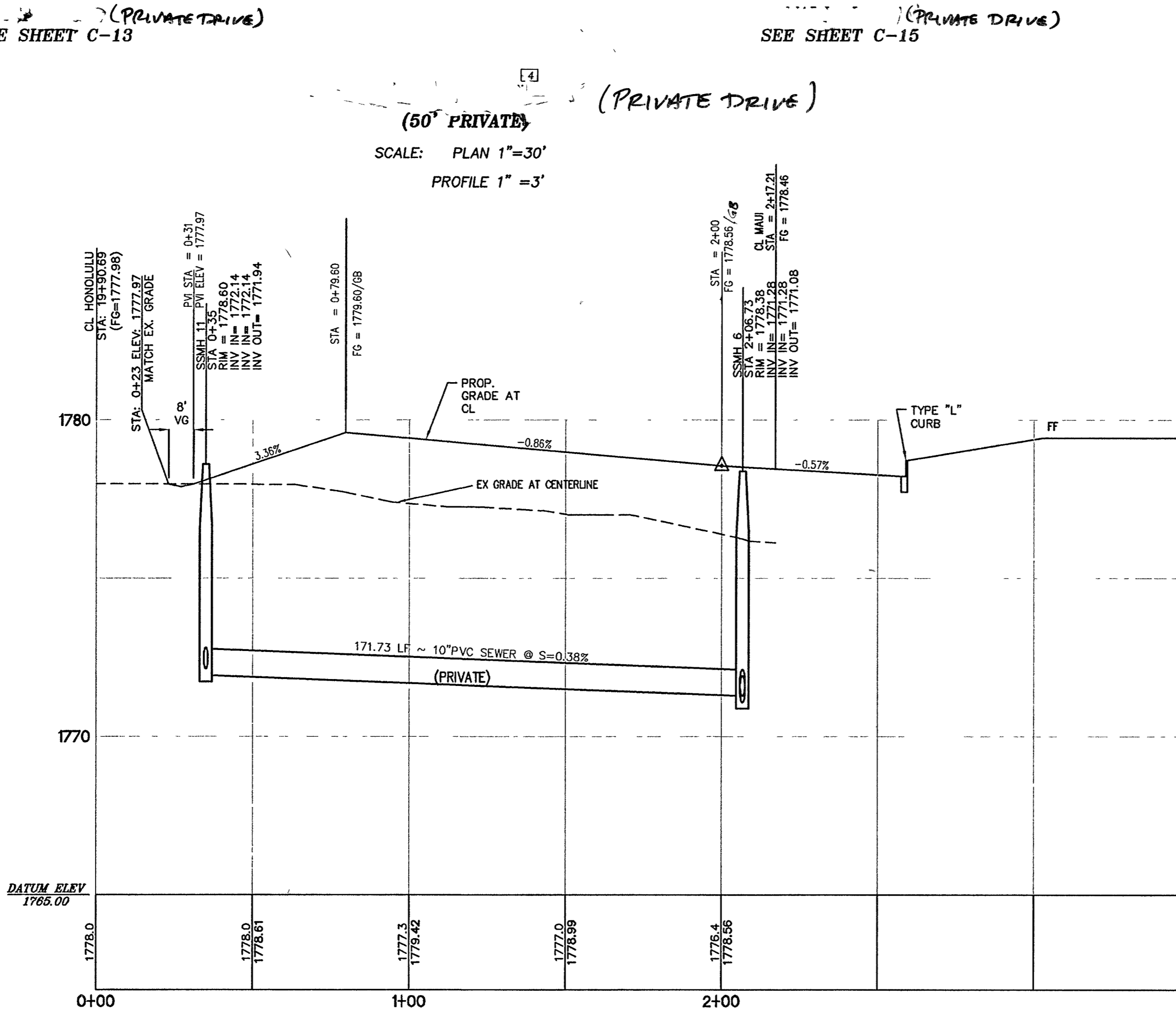

AVOID CUTTING UNDERGROUND UTILITY LINES IT'S COSTLY  
**Call before you Dig**  
 1-800-227-2600

AVOID OVERHEAD POWER LINE CONTACT IT'S COSTLY  
**Call before you Overhead**  
 1-702-593-6111

BEFORE YOU UNDERGROUND  
 1-702-455-7511  
 CLARK COUNTY PUBLIC UTILITIES DEPARTMENT

EXISTING UTILITY LOCATIONS SHOWN HEREON ARE APPROXIMATE ONLY. IT SHALL BE THE CONTRACTOR'S RESPONSIBILITY TO DETERMINE THE EXACT VERTICAL AND HORIZONTAL LOCATION OF ALL EXISTING UNDERGROUND UTILITIES PRIOR TO COMMENCING CONSTRUCTION. NO REPRESENTATION IS MADE THAT ALL EXISTING UTILITIES ARE SHOWN HEREON. THE ENGINEER ASSUMES NO LIABILITY FOR UTILITIES NOT SHOWN OR UTILITIES NOT SHOWN IN THEIR PROPER LOCATION.

88460

**PLAN AND PROFILE (PRIVATE DRIVE)**

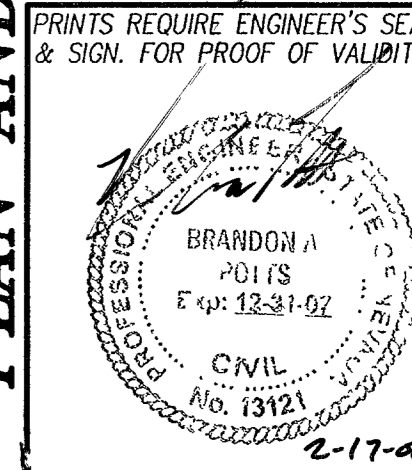

**C-14**  
14 OF 19

CLV # 107V4569

**HONOLULU FAMILY HOUSING @ CHARLESTON & HONOLULU**

OWNER/DEVELOPER: CITY OF LAS VEGAS HOUSING AUTHORITY  
 340 NORTH 11TH STREET  
 LAS VEGAS, NEVADA 89101  
 PH: (702) 922-6800 FAX: (702) 922-6818

**CIVILNOTES**  
 Engineering with "sensible" solutions tailored to your "specific" needs.  
 7625 S. Industrial Rd., Suite #101 • Las Vegas, NV • 89139  
 Office #: (702) 876-3474 • Facsimile #: (702) 876-1323