

FED. ROAD DIV. NO.	STATE	PROJECT NO.	COUNTY	CONTROL SECTION	STATE ROUTE	SHEET NO.	TOTAL SHEETS
7	NEVADA	1-015-1 (23 NO)	CLARK	03-083		50	130

Ref. Sheet OA-3

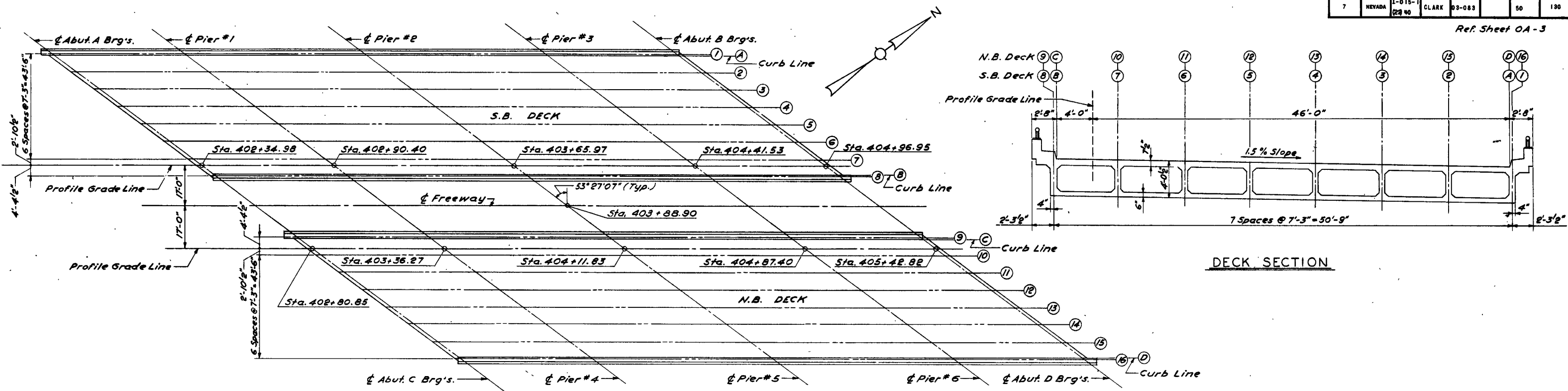

PLAN OF DECK GEOMETRY

LINE	ABUT. A or C	1/4	1/2	3/4	PIER #1 or #4	1/6	1/3	1/2	2/3	5/6	PIER #2 or #5	1/6	1/3	1/2	2/3	5/6	PIER #3 or #6	1/4	1/2	3/4	ABUT. B or D
A	2068.81	2069.04	2069.25	2069.46	2069.65	2069.82	2069.98	2070.13	2070.28	2070.41	2070.54	2070.66	2070.77	2070.86	2070.97	2071.06	2071.14	2071.21	2071.28	2071.34	2071.39
2	2069.07	2069.28	2069.49	2069.69	2069.88	2070.04	2070.20	2070.34	2070.48	2070.61	2070.73	2070.85	2070.95	2071.05	2071.14	2071.22	2071.29	2071.36	2071.43	2071.48	2071.52
3	2069.33	2069.54	2069.74	2069.93	2070.11	2070.27	2070.42	2070.56	2070.69	2070.81	2070.93	2071.04	2071.14	2071.23	2071.31	2071.39	2071.45	2071.52	2071.57	2071.62	2071.65
4	2069.59	2069.79	2069.99	2070.17	2070.35	2070.50	2070.64	2070.77	2070.90	2071.01	2071.12	2071.22	2071.32	2071.40	2071.48	2071.55	2071.61	2071.67	2071.71	2071.75	2071.78
5	2069.84	2070.04	2070.23	2070.40	2070.57	2070.72	2070.85	2070.98	2071.10	2071.21	2071.31	2071.41	2071.49	2071.57	2071.64	2071.70	2071.76	2071.81	2071.85	2071.88	2071.90
6	2070.09	2070.28	2070.46	2070.63	2070.79	270.93	2071.06	2071.18	2071.29	2071.40	2071.49	2071.58	2071.66	2071.74	2071.80	2071.86	2071.90	2071.95	2071.98	2072.00	2072.02
7	2070.34	2070.52	2070.69	2070.86	2071.01	271.14	2071.26	2071.38	2071.48	2071.58	2071.67	2071.75	2071.83	2071.89	2071.95	2072.00	2072.04	2072.08	2072.11	2072.12	2072.13
8	2070.56	2070.74	2070.91	2071.06	2071.21	2071.33	2071.45	2071.56	2071.66	2071.75	2071.84	2071.91	2071.98	2072.04	2072.09	2072.14	2072.17	2072.20	2072.22	2072.23	2072.23
C	2070.99	2071.14	2071.28	2071.42	2071.54	2071.64	2071.73	2071.82	2071.90	2071.97	2072.03	2072.08	2072.13	2072.16	2072.19	2072.21	2072.23	2072.23	2072.23	2072.21	2072.19
10	2070.99	2071.13	2071.27	2071.39	2071.51	2071.61	2071.69	2071.77	2071.85	2071.91	2071.97	2072.01	2072.05	2072.08	2072.11	2072.12	2072.13	2072.13	2072.12	2072.09	2072.06
11	2070.98	2071.12	2071.25	2071.37	2071.48	2071.57	2071.65	2071.72	2071.79	2071.85	2071.89	2071.94	2071.97	2071.99	2072.01	2072.02	2072.02	2072.01	2071.99	2071.96	2071.93
12	2070.97	2071.10	2071.23	2071.34	2071.44	2071.52	2071.60	2071.67	2071.72	2071.78	2071.82	2071.85	2071.88	2071.90	2071.91	2071.91	2071.91	2071.89	2071.86	2071.83	2071.79
13	2070.96	2071.08	2071.20	2071.30	2071.40	2071.47	2071.54	2071.60	2071.66	2071.70	2071.74	2071.77	2071.79	2071.80	2071.80	2071.80	2071.79	2071.76	2071.73	2071.69	2071.65
14	2070.94	2071.06	2071.16	2071.26	2071.35	2071.42	207.48	2071.54	2071.58	2071.62	2071.65	2071.67	2071.69	2071.69	2071.69	2071.68	2071.66	2071.63	2071.60	2071.56	2071.52
15	2070.91	2071.02	2071.12	2071.21	2071.29	2071.36	2071.42	2071.46	2071.50	2071.54	2071.56	2071.58	2071.58	2071.58	2071.58	2071.56	2071.53	2071.50	2071.46	2071.42	2071.38
D	2070.89	2070.99	2071.08	2071.17	2071.24	2071.30	2071.35	2071.39	2071.43	2071.45	2071.47	2071.48	2071.48	2071.48	2071.46	2071.44	2071.41	2071.37	2071.33	2071.29	2071.25

TABLE OF THEORETICAL DECK ELEVATIONS

GENERAL NOTES

DESIGN SPECIFICATIONS: A.A.S.H.O. Standard Specifications for Highway Bridges, 8th edition dated 1961.

CONSTRUCTION SPECIFICATIONS: State of Nevada Department of Highways "Standard Specifications for Road and Bridge Construction 1961", except as noted below, and in the special provisions for this contract.

LIVE LOAD: H20-S16-44 or Alternate Load.

CONCRETE: All concrete to be class A

REINFORCEMENT: All reinforcing bars to be intermediate grade deformed type. $f_y = 20,000$ psi. Dimensions to center of bars unless otherwise shown.

FORMS: Falsework shall not be removed from any span until the concrete in that span and in the contiguous (adjoining) spans has attained a compressive strength not less than 2400 P.S.I.

CAMBER: Falsework to be constructed to provide a camber for dead load deflection as shown in the plans in addition to allowance for shrinkage and settlement.

CONSTRUCTION JOINTS: No construction joints shall be used except by permission of the Engineer or as shown on the plans. Siders, pier caps, and slabs shall be poured in one continuous operation from end to end of individual units between construction joints and edges of slabs.

FOUNDATION: Pier footings designed for an allowable soil pressure of 2 tons/square foot.

CONSTRUCTION TYPE CODE: X221

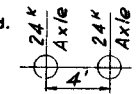

DESIGNED BY E.H.W.
DRAWN BY R.P. RDL.

59274

STATE OF NEVADA
DEPARTMENT OF HIGHWAYS 40
107V3834
OAKY BOULEVARD OVERPASS
H-933N & H-933S
DECK GEOMETRY & ELEVATIONS
DE LEUW, CATHER & COMPANY SCALE