

- LEGEND:**
- DENOTES GLUE DOWN MEDIAN ISLAND
 - DENOTES AC MEDIAN ISLAND PER USDDCA DWG NO 218
 - RIGHT-OF-WAY
 - NDOT RIGHT-OF-WAY
 - EXIST RIGHT-OF-WAY

- CENTERLINE STATIONING:**
- (A) "HD" 21+21.57, 50.00' RT= "HD4A" 166+86.93
 - (J) "HD" 22+12.30= "FRW" 100+00

- CONSTRUCTION NOTES:**
- (4) INSTALL "A" TYPE ISLAND CURB PER USDDCA DWG NO. 219 (STATION & OFFSET TBC)
 - (5) INSTALL GLUE DOWN MEDIAN ISLAND PER DETAIL ON SHEET TYP1 (STATIONING & OFFSET TPFC)
 - (5A) INSTALL 6" PVC IRRIGATION SLEEVE (CAP EACH END OF 6" PVC IRRIGATION SLEEVE)

MEDIAN STATIONING LEGEND:

- | | |
|-----------------------------------|-----------------------------------|
| (A) "GCD" 9+10.99, 9.00' RT, PC | (F) "GCD" 9+10.99, 11.00' RT, PT |
| (B) "GCD" 9+39.23, 9.00' RT, PC | (G) "GCD" 9+39.23, 11.00' RT, PT |
| (C) "GCD" 9+74.63, 22.91' RT, PCC | (H) "GCD" 9+73.27, 24.37' RT, PCC |
| (D) "GCD" 9+82.14, 30.59' RT, PCC | (J) "GCD" 9+80.64, 31.92' RT, PCC |
| (E) "HD" 10+66.60, 3.00' RT, PT | (K) "HD" 10+66.60, 5.00' RT, PT |

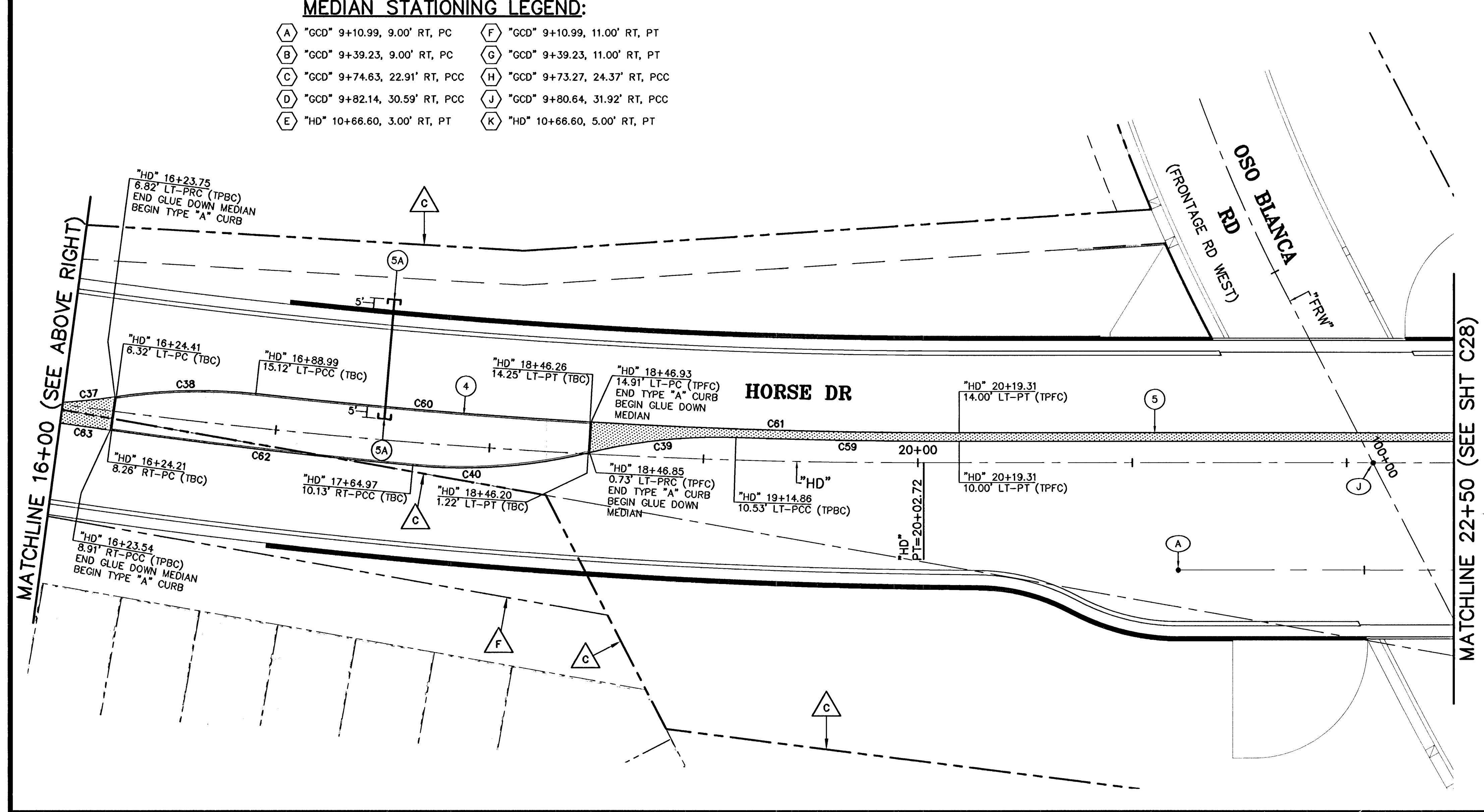

CURVE	LENGTH	RADIUS	TANGENT	DELTA	DESC
CA	38.94'	52.00'	20.43'	42°54'09"	TPFC
CB	10.74'	113.00'	5.38'	5°26'52"	TPFC
CC	39.18'	52.00'	20.56'	43°08'36"	TPFC
CD	37.65'	50.00'	19.77'	43°08'36"	TPFC
CE	10.55'	111.00'	5.28'	5°26'52"	TPFC
CF	37.44'	50.00'	19.65'	42°54'09"	TPFC
C1	3.00'	1.00'	14.09'	171°52'49"	TPFC
C2	28.38'	200.00'	14.21'	8°07'49"	TPFC
C37	81.91'	250.00'	41.32'	18°46'18"	TPFC
C38	65.14'	249.34'	32.75'	14°58'03"	TBC
C39	68.80'	250.00'	34.62'	15°46'04"	TPFC
C40	82.50'	249.34'	41.63'	18°57'30"	TBC
C59	104.15'	2990.00'	52.08'	1°59'45"	TPFC
C60	156.51'	2986.66'	78.27'	3°00'09"	TBC
C61	171.63'	2986.00'	85.84'	3°17'36"	TPFC
C62	141.21'	3008.79'	70.62'	2°41'20"	TBC
C63	144.74'	3009.45'	72.39'	2°45'20"	TPFC

- NOTES:**
- ALL "TBC" OFFSET REFERENCES ARE TO TOP BACK OF CURB
 - ALL "TPFC" OFFSET REFERENCES ARE TO TOP OF PAVEMENT AT FACE OF CURB

Avoid overhead power line contact it's costly
Call before you Overhead
 1-702-227-2929
 NEVADA POWER ENVIRONMENT AND SAFETY SERVICES DEPARTMENT

Call before you Dig
 Avoid cutting underground utility lines. It's costly.
Call 811
 1-800-227-2800
 OR
 CLACK COUNTY TRAFFIC OPERATIONS
 1-702-455-7544

PUBLIC WORKS DEPARTMENT 400 E. STEWART AVE. LAS VEGAS, NV 89101 702-229-6272	CITY OF LAS VEGAS, NV 277 SOUTH RAINBOW BOULEVARD LAS VEGAS, NEVADA 89146-5146 PH. (702) 87-7556 FAX (702) 367-2587 nevada CONSULTING ENGINEERS & PLANNERS & LAND SURVEYORS	REVISION	DATE	BY
		REV	DATE	BY
MEDIAN ISLAND GEOMETRICS "HD" 10+00 TO "HD" 22+50	HORSE DRIVE / US 95 INTERCHANGE	DRAWN BY: 06/20/2008		
		DESIGNED BY: 06/20/2008		
		CHECKED BY: 06/20/2008		
		PROJECT NO: SCALE: 1"=30'		
		EOD: N/A		
		SHEET C28		
		76 OF 153 SHEETS		
		DRAWING NO. 107V3759		

114248