

Russ Davis

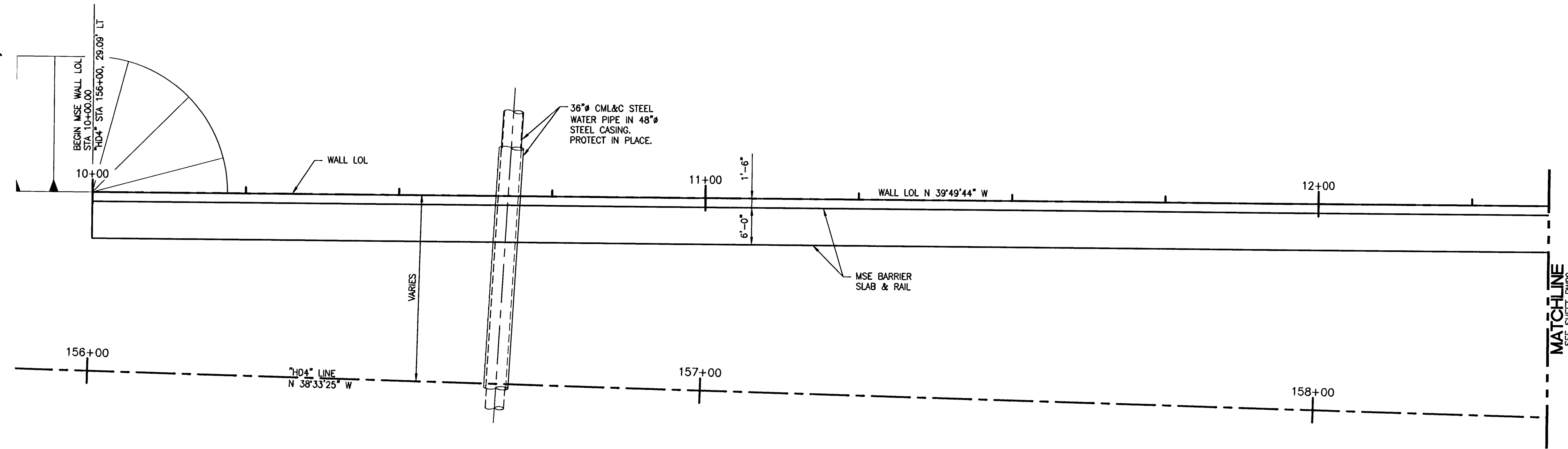

### PARTIAL PLAN

APPROVED

*Joseph Morgan* 7/14/08  
 DATE

LAS VEGAS VALLEY WATER DISTRICT  
 LVVWD PROJECT # H80315

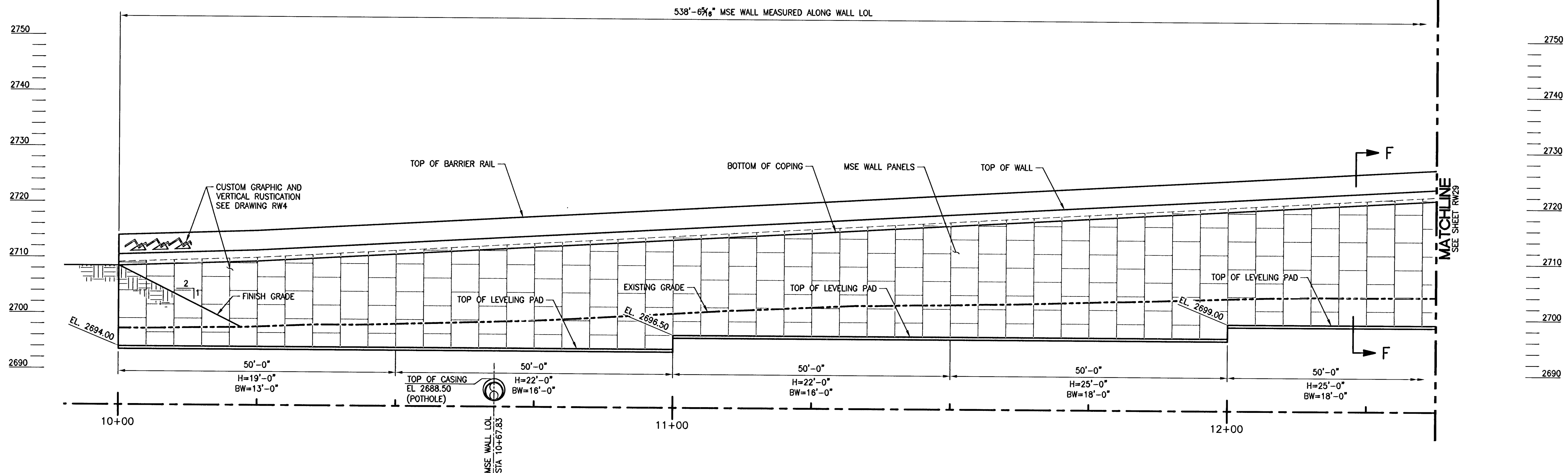

### PARTIAL MIRRORED ELEVATION

NOTES:  
 1. FOR SECTION F-F, REFER TO SHEET RW31.

<b>PUBLIC WORKS DEPARTMENT</b> <small>400 E. STEWART AVE.        LAS VEGAS, NV 89101        702-229-6272</small>	<b>CITY OF LAS VEGAS, NV</b> <small>940 GRIER DRIVE, SUITE 300 • LAS VEGAS, NEVADA • 89119        PHONE (702) 260-7000 • FAX (702) 260-7070</small>	<b>R2H ENGINEERING, INC.</b> <small>CONSULTING STRUCTURAL ENGINEERS        940 GRIER DRIVE, SUITE 300 • LAS VEGAS, NEVADA • 89119        PHONE (702) 260-7000 • FAX (702) 260-7070</small>	<b>MSE RETAINING WALL #6        PARTIAL PLAN &amp; ELEVATION</b> <b>HORSE DRIVE / US 95        INTERCHANGE</b>
DESIGNED BY: A. GRANT 5/30/2008	DRAWN BY: R. DAVIS 6/30/2008	CHECKED BY: R. DAVIS 6/30/2008	PROJECT NO.: 8255
SCALE: 1" = 10' HORIZ. 1" = 10' VERT.			SHEET NO. 444 OF 453 SHEETS <b>RW28</b> DRAWING NO. 107V3759

Tuesday, July 01, 2008 6:15:10 PM

114735

P:\06060374-LONG-RETAINING WALLS\HORSEDR, RW28.DWG