

Russ Davis

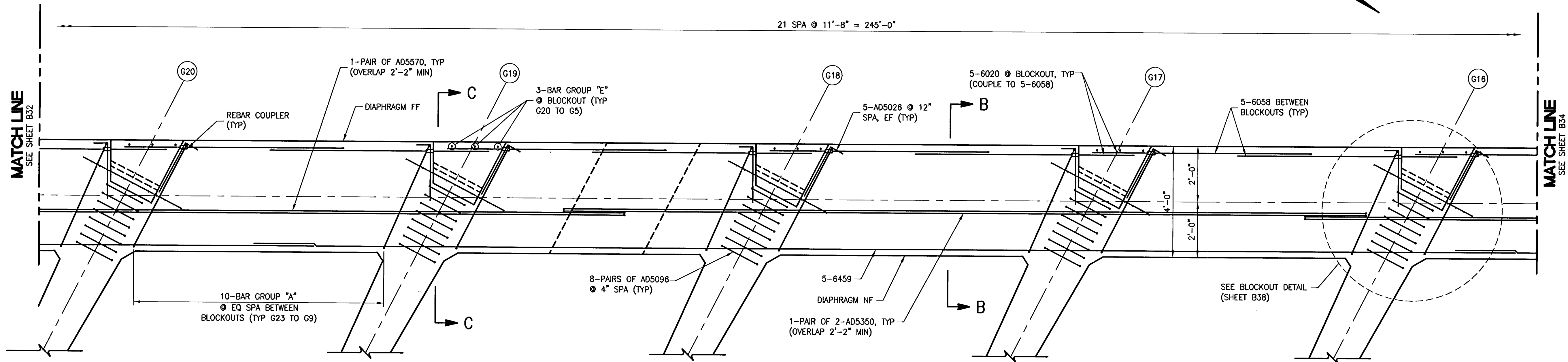

PARTIAL PLAN

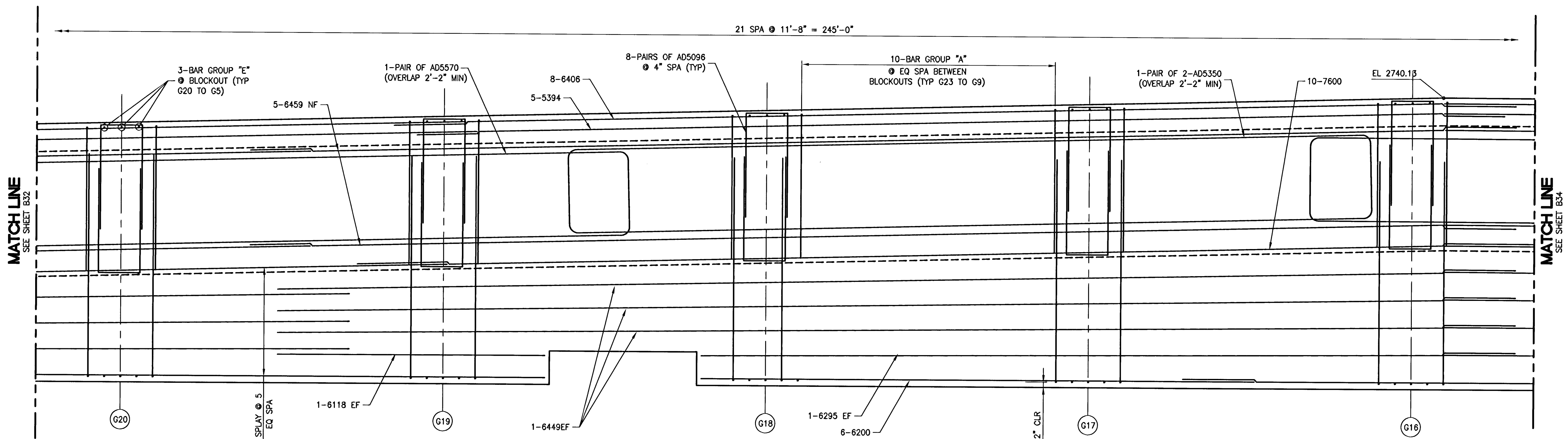

PARTIAL ELEVATION
(LOOKING BACK STATION)

NOTES:

1. FOR SECTION A-A, B-B & C-C SEE SHEET B38.

MINIMUM BAR LAPS:

- NO. 4 BAR TO NO. 4 BAR = 1'-8"
- NO. 5 BAR TO NO. 5 BAR = 2'-2"
- NO. 6 BAR TO NO. 6 BAR = 2'-7"
- NO. 7 BAR TO NO. 7 BAR = 3'-3"
- NO. 8 BAR TO NO. 8 BAR = 4'-3"

114620

Thursday, July 03, 2008 8:03:30 AM

PUBLIC WORKS DEPARTMENT 400 E STEWART AVE. LAS VEGAS, NV 89101 702-228-4272		CITY OF LAS VEGAS, NV	
R&H ENGINEERING, INC. CONSULTING STRUCTURAL ENGINEERS 640 GARDEN DRIVE, SUITE 200, LAS VEGAS, NEVADA 89119 PHONE (702) 380-7000 • FAX (702) 380-7000			
HORSE DRIVE OVER US-95 ABUTMENT DIAPHRAGM 1 PLAN & ELEVATION 3		HORSE DRIVE / US 95 INTERCHANGE	
DESIGNED BY: R. DAVIS	6/30/2008	CHECKED BY: R. DAVIS	6/30/2008
DRAWN BY: A. GRANT	6/30/2008	PROJECT NO.:	06637
SCALE: 1" = 2'		HORIZ. 1" = 2'	
VERT. 1" = 2'		SHEET	
32A		B33	
326		OF 453 SHEETS	
DRAWING NO.		107V3759	
1-2896			

P:\0606374-DWG\0606374-03.DWG