

Russ Davis

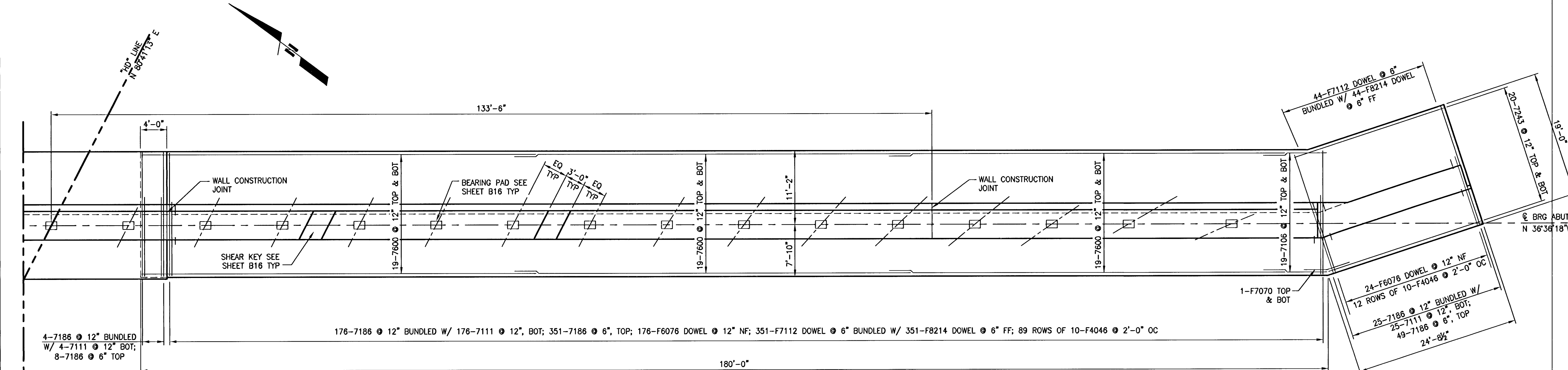

PARTIAL PLAN

MATCHLINE
SEE SHEET B12

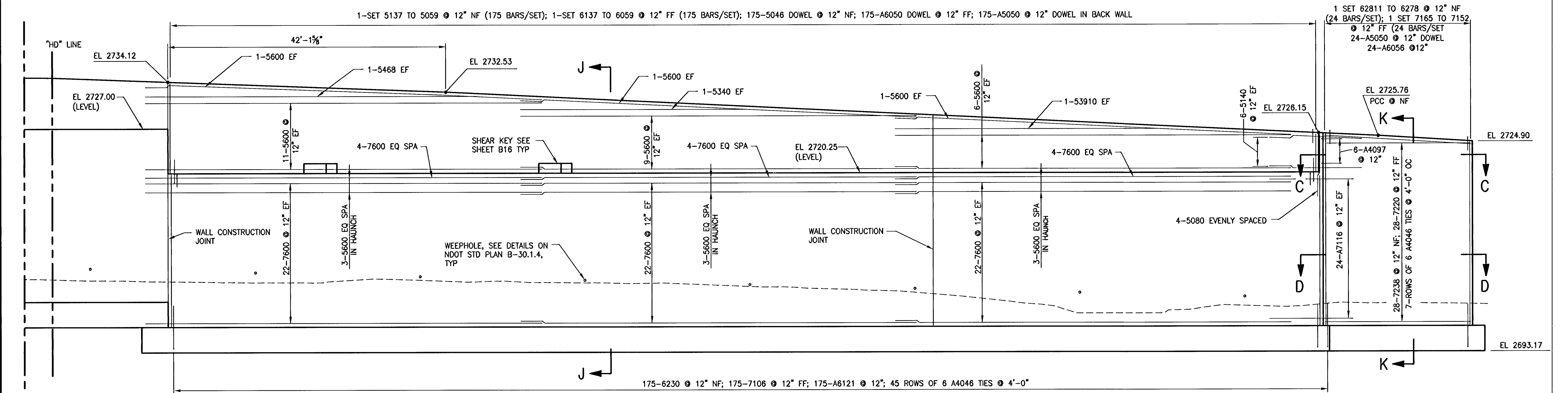

PARTIAL ELEVATION 2

LOOKING AHEAD ON STATION
ELEVATIONS ARE NEAR FACE OF
BACKWALL/WINGWALL

- NOTES:**
- FOR SECTION C-C AND D-D SEE SHEET B15
 - FOR SECTIONS J-J AND K-K SEE SHEET B14

- LEGEND:**
- NF = NEAR FACE
 - FF = FAR FACE
 - EF = EACH FACE
- MINIMUM BAR LAPS**
- NO. 5 BAR TO NO. 5 BAR = 2'-2" LAP
 - NO. 6 BAR TO NO. 6 BAR = 2'-7" LAP
 - NO. 7 BAR TO NO. 7 BAR = 3'-3" LAP

MATCHLINE
SEE SHEET B12

Thursday, July 03, 2008 8:06:17 AM

114 000

PUBLIC WORKS DEPARTMENT		CITY OF LAS VEGAS, NV	
440 S STEWART AVE. LAS VEGAS, NV 89101 702-259-8272		R-H ENGINEERING, INC. CONSULTING STRUCTURAL ENGINEERS 440 GREEN OAKS SUITE 200 • LAS VEGAS, NEVADA • 89119 PHONE (702) 260-7000 • FAX (702) 260-7070	
DESIGNED BY: R. DAVIS	6/30/2008	DRAWN BY: A. GRANT	6/30/2008
CHECKED BY: R. DAVIS	6/30/2008	PROJECT NO: 09037	SCALE: 1" = 6' HORIZ. 1" = 6' VERT.
HORSE DRIVE OVER US-95 ABUTMENT 2 PLAN & ELEVATION 2		HORSE DRIVE / US 95 INTERCHANGE	
		SHEET B13 309 OF 453 SHEETS DRAWING NO. 107V3759	
I-2896		REV. DATE BY	