

LEGEND:

- DENOTES PBS (PLANTMIX BITUMINOUS SURFACE) SEE TYP CROSS SECTIONS
- DENOTES SAWCUT LINE FOR PBS (PLANTMIX BITUMINOUS SURFACE)
- "HD1" DENOTES NEW CL HORSE DR/FT APACHE RD RAMP 1
- EXIST NDOT RIGHT-OF-WAY

CONSTRUCTION NOTES:

- ③ INSTALL GALVANIZED GUARD RAIL (TRIPLE CORRUGATION); GUARD RAIL TRAILING END ANCHOR; GUARD RAIL TERMINAL (FLARED) PER NDOT STD DWG NO. R-8.1.1. CONTRACTOR TO FIELD VERIFY HORIZONTAL & VERTICAL LOCATION OF ANY NEW AND/OR EXISTING UNDERGROUND FACILITIES PRIOR TO INSTALLATION OF GUARD RAIL
- ③A INSTALL GALVANIZED GUARD RAIL PER NDOT STD DWG R-8.1.1

NOTE:
 FOR STORM DRAIN REMOVAL, PROTECT IN PLACE & GRADING INFORMATION SEE SHEET SD1 THRU SD43

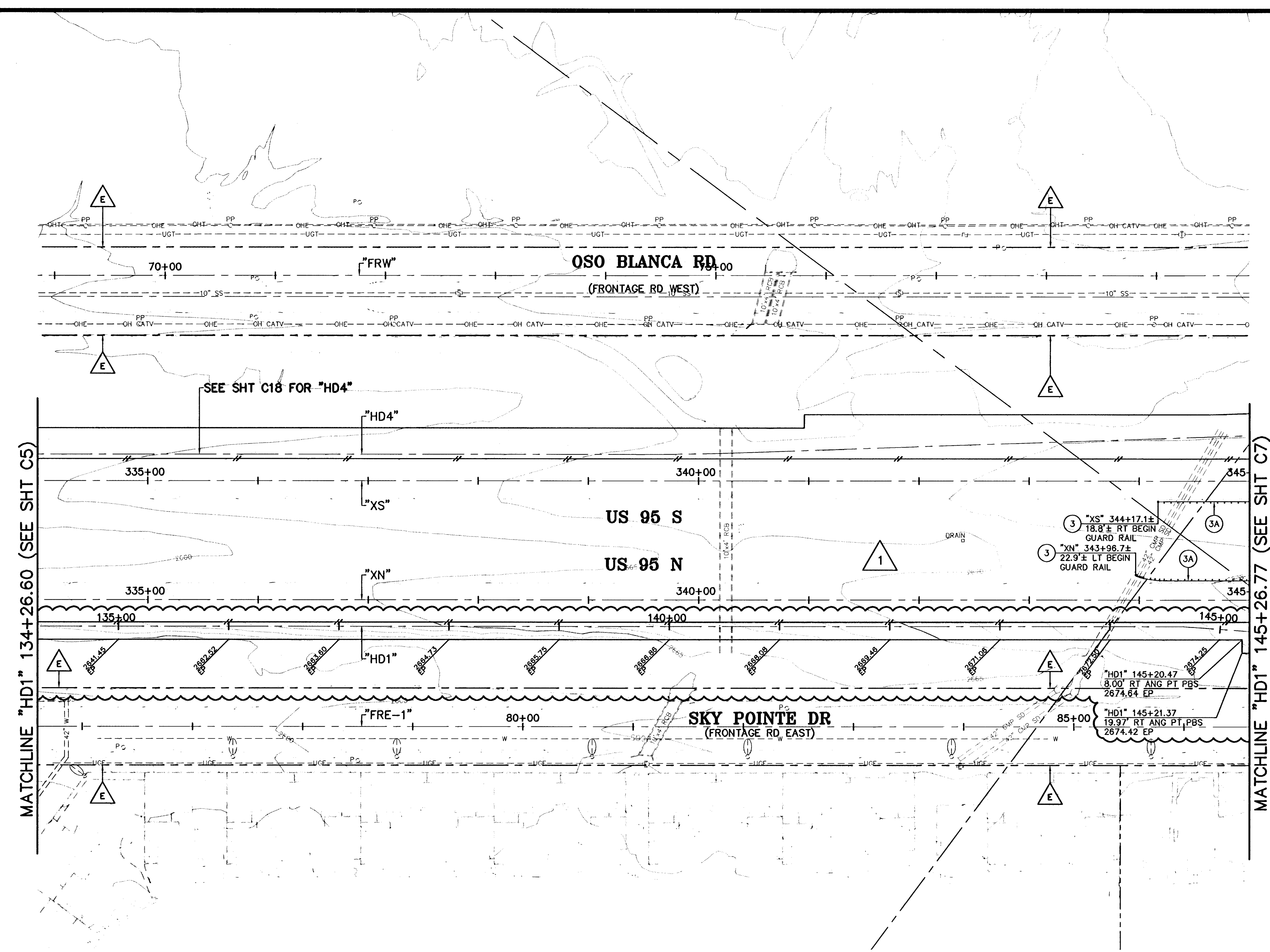

PUBLIC WORKS DEPARTMENT		CITY OF LAS VEGAS, NV	
ROADWAY PLAN		"HDT" 134+26.60 TO "HDT" 145+26.77	
HORSE DRIVE / US 95 INTERCHANGE			
DRAWN BY: DRF	DESIGNED BY: LAW	CHECKED BY: LAW	PROJECT NO: 6500
DATE: 06/20/2008	DATE: 06/20/2008	DATE: 06/20/2008	SCALE: 1"=50' N/A
KEN D. GILBRETH CIVIL No. 9177		SHEET C68 OF SHEETS DRAWING NO. 107V3769	

AVOID OVERHEAD POWER LINE CONTACT IT'S COSTLY

Call before you Overhead
 1-702-227-2929
 NEVADA POWER ENVIRONMENT AND SAFETY SERVICES DEPARTMENT

Call before you Dig
 Avoid cutting underground using lines, it's costly.

Call 811
 OR
 1-800-227-2800
 CLARK COUNTY TRAFFIC OPERATIONS
 1-702-455-7544

115041

E:\6500\DWG\DESIGN\6500-D-RAMP5.dwg