

NOTES:

ALL LANE DIMENSIONS ARE FROM FACE OF BARRIER RAIL OR FACE OF MEDIAN TO LIP OF GUTTER OR EDGE OF PAVEMENT.

WHERE PPM, PMF AND RPM ARE CALLED OUT TO BE CONSTRUCTED IN ACCORDANCE WITH THE USDCCA, ALL MATERIALS USED IN THE INSTALLATION SHALL BE IN ACCORDANCE WITH NDOT QPL.

ABBREVIATIONS:

NDOT = NEVADA DEPARTMENT OF TRANSPORTATION
 PMF = PAVEMENT MARKING FILM
 PPM = POLYUREA PAVEMENT MARKINGS
 RPM = RAISED PAVEMENT MARKINGS
 QPL = QUALIFIED PRODUCTS LIST

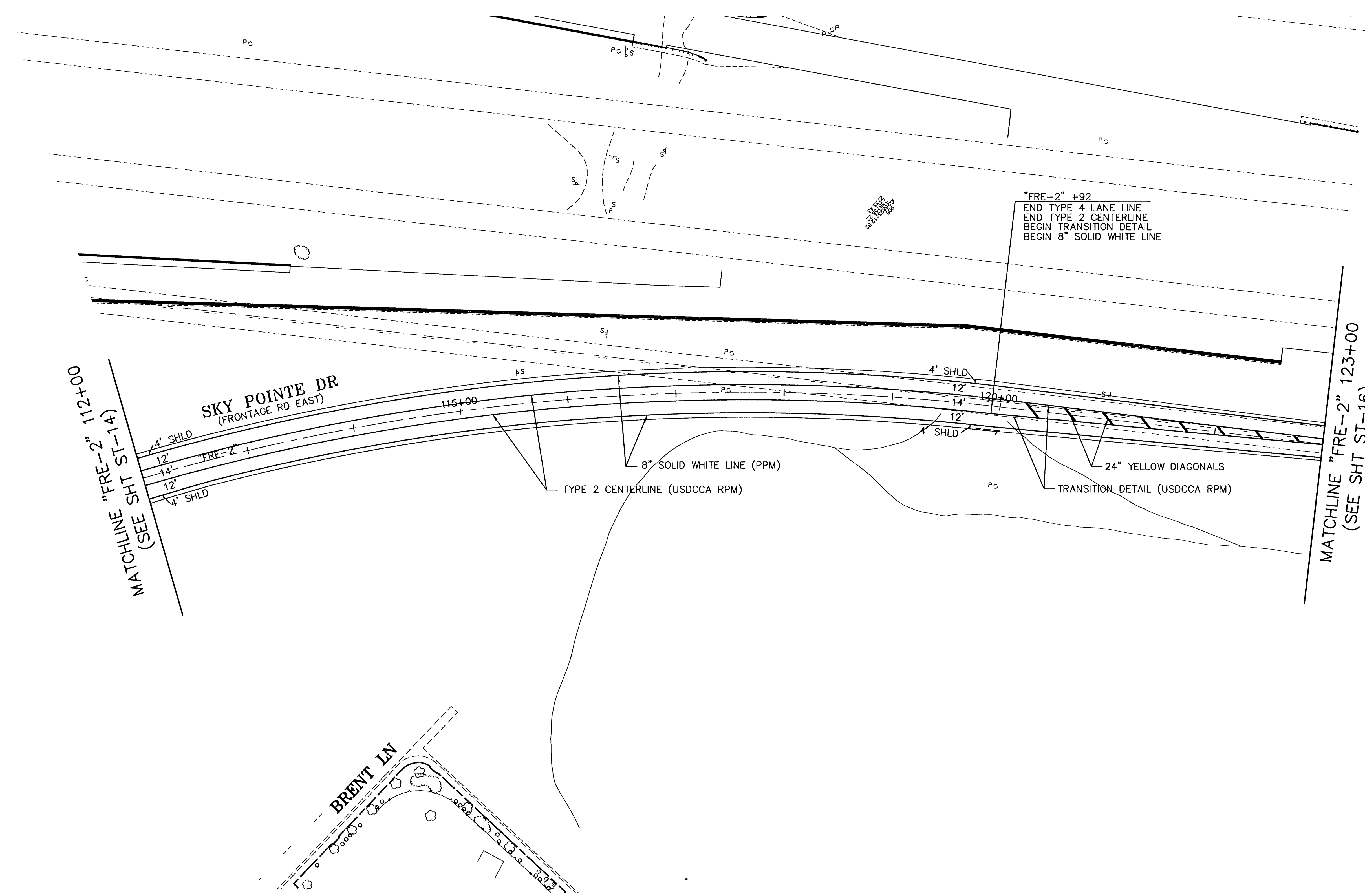
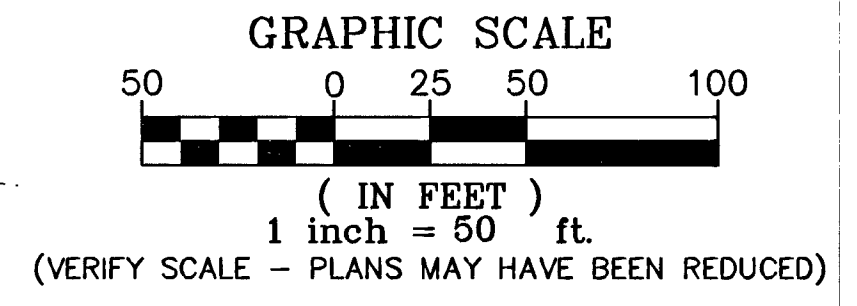
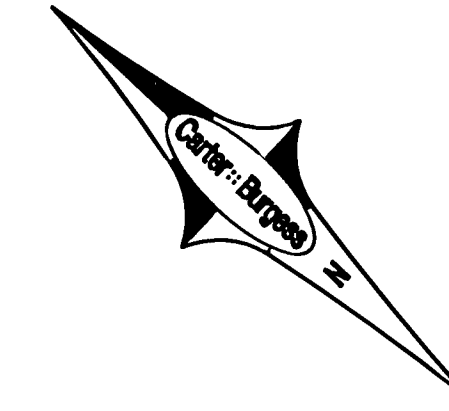

PUBLIC WORKS DEPARTMENT 400 E. STEWART AVE. LAS VEGAS, NV 89101 CITY OF LAS VEGAS, NV		Carter Burgess Consultants in Planning, Engineering, and Public Services 2400 Mountain Road Las Vegas, Nevada 89102 Tel: 702.253.8272 Fax: 702.253.8272	
STRIPING PLAN "FRE-2" 112+00 TO "FRE-2" 123+00		HORSE DRIVE / US 95 INTERCHANGE	
DRAWN BY: LR	07/03/2008	DESIGNED BY: SM	07/03/2008
CHECKED BY: LH	07/03/2008	PROJECT NO.:	241767
SCALE: 1"=50'		VERT.:	
N/A		N/A	
SHEET ST-16 OF 4 SHEETS DRAWING NO. 107V3769			
REV	DATE	BY	REVISION

114551

SHEET STRIPING.DWG