

**GRAPHIC SCALE**

( IN FEET )

HORIZ 1 inch = 30 ft.  
VERTICAL 1 inch = 3 ft.

**BASIS OF BEARING**

THE BASIS OF BEARINGS FOR THIS PROJECT IS GRID NORTH AS DEFINED BY THE NEVADA COORDINATE SYSTEM OF 1983 (NCCS3), EAST ZONE, (2701), DETERMINED BY GIS CONTROL POINTS, 804 AND 808, AS SHOWN ON A RECORD OF SURVEY ON FILE IN THE CLARK COUNTY, NEVADA RECORDER'S OFFICE, IN FILE 88 OF SURVEYS, AT PAGE 53.

**BENCHMARK**

BENCHMARK # 23  
RIVET AND SQUARE ALUMINUM PLATE IN CONCRETE MONUMENT, 50 FT. SOUTH AND 40 FT. WEST OF CENTENNIAL PKWY. AND EL CAPITAN WAY.

**CAUTION**

EXISTING UTILITIES ARE LOCATED ON THE PLANS FROM A SEARCH OF AVAILABLE RECORDS. CONTRACTOR TO VERIFY LOCATIONS AND DEPTHS PRIOR TO CONSTRUCTION.

- KEY NOTES**
- CONSTRUCTION ITEMS**
1. INSTALL A 48" TYPE I SANITARY SEWER MANHOLE PER C.C.A.U.S.D. NO. 483
  2. INSTALL WATER QUALITY "C900" SANITARY SEWER PIPE PER C.C.A.U.S.D. NO. 483
  3. INSTALL A 60" TYPE I SANITARY SEWER MANHOLE PER C.C.A.U.S.D. NO. 483
  4. CONSTRUCTION OF SANITARY SEWER FACILITIES SHALL BE IN ACCORDANCE WITH "DESIGN AND CONSTRUCTION STANDARDS FOR WASTE WATER COLLECTION SYSTEMS" AS ADOPTED BY THE CITY OF LAS VEGAS.
  5. EXISTING SANITARY SEWER MANHOLE. CONTRACTOR TO ADJUST RIM TO NEW FINISH GRADE ELEVATION.
  6. SANITARY SEWER LATERAL. REFER TO SHEETS SS10 AND SS11 FOR LATERAL PROFILES AND ADDITIONAL INFORMATION.
  7. INSTALL WATER QUALITY "C900" SANITARY SEWER PIPE PER C.C.A.U.S.D. NO. 483
  8. PROPOSED 18" C900 SANITARY SEWER TO REPLACE EXISTING 12" SANITARY SEWER. REFER TO DEMOLITION PLANS FOR SAWCUT LOCATIONS OF AC PAVEMENT & EXISTING CURB.
  9. INSTALL 8" C900 SANITARY SEWER STUB FOR FUTURE EXTENSION BY OTHERS.
  10. CONTRACTOR SHALL REMOVE AND REPLACE MEDIAN ISLAND TYPE "A" CURB AS NECESSARY TO CONSTRUCT UNDERGROUND SANITARY SEWER. REPLACE CURB PER CCAUSD STD DWG #219.
  11. CONTRACTOR TO REFER TO CONTRACT DOCUMENTS ON HOW TO MITIGATE EXISTING SANITARY SEWER FLOWS DURING CONSTRUCTION OF 18" SEWER MAIN.
  12. EXISTING 12" WATERLINE TO BE REMOVED AND/OR CUT & CAP TO ABANDON IN PLACE. REFER TO SHEET W1 FOR LOCATIONS AND ADDITIONAL INFORMATION.

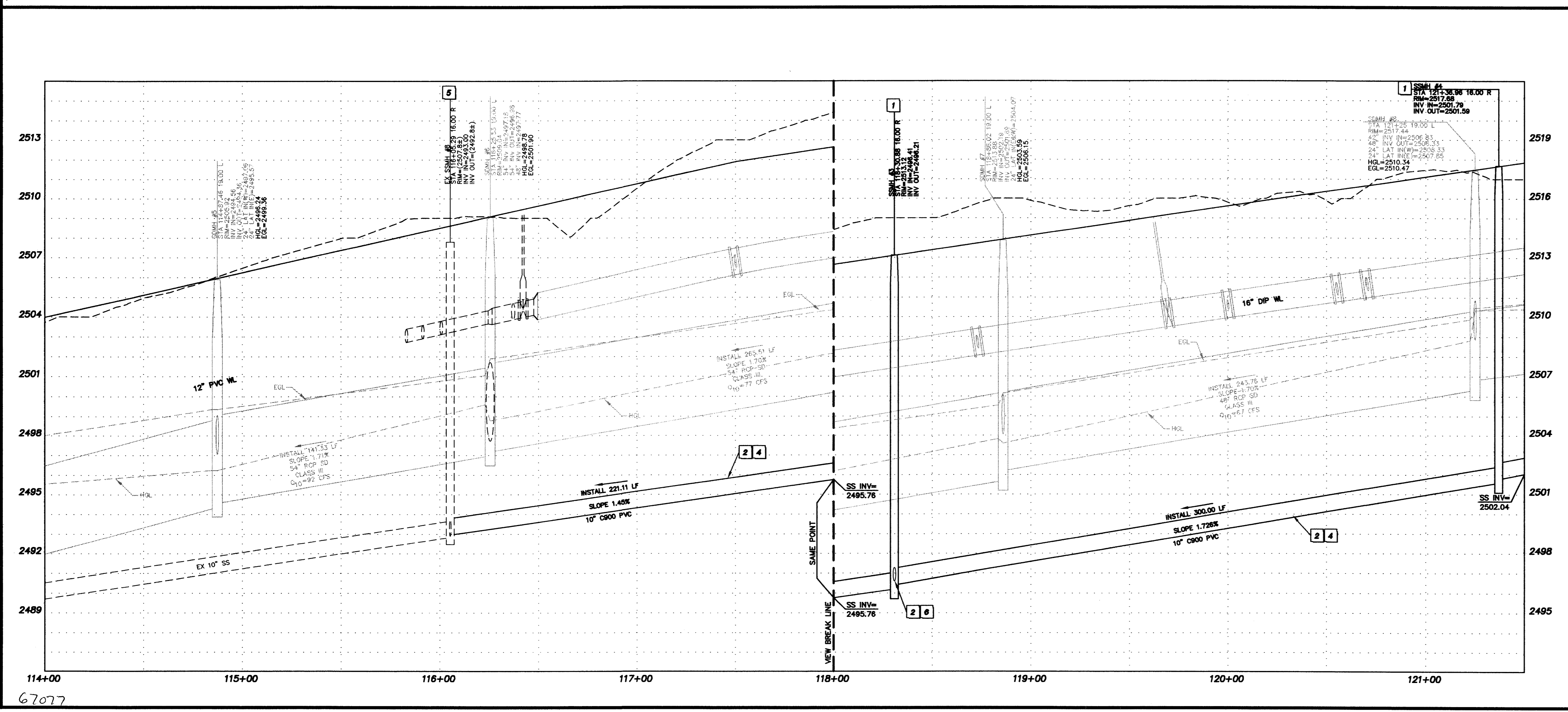

**SANITARY SEWER CONSTRUCTION NOTE:**

1. SEE SHEET SS12 FOR NORTHING & EASTING LOCATIONS OF MANHOLES.
2. REFER TO SHEETS H1 THROUGH H4 FOR CL DIMENSION INFORMATION.

**Call before you Dig.**

**Call before you OVERHEAD.**

1-702-455-7511  
1-702-229-6611

1-800-227-2600  
UNDERGROUND SERVICE ALERT (USA)

1-702-227-2929  
NEVADA POWER AND SAFETY SERVICES DEPARTMENT

**REVISIONS**

NO.	DATE	DESCRIPTION

**ENGINEERING DESIGN SECTION**

DRAWN BY: J. GREGORY  
CHECKED BY: V. HARKINS  
DATE: 02-27-04

**PBS&J**

2270 Corporate Center  
Suite 300  
Las Vegas, NV 89102  
Telephone: 702.263.7274  
Facsimile: 702.263.7200

ENGINEERING - PLANNING - SURVEYING - CONSTRUCTION SERVICES

**Department of Public Works**

**GRAND MONTECITO PARKWAY IMPROVEMENTS**  
**SANITARY SEWER PLAN AND PROFILES**  
**STA 114+00.00 TO STA 121+50.00**

DRAWING No. 37  
SS3  
PLAN# 107V3701 61