

**GRAPHIC SCALE**  
 30 0 15 30 60 90 120  
 (IN FEET)  
 1 inch = 30 ft.

**BASIS OF BEARING**  
 THE BASIS OF BEARINGS FOR THIS PROJECT IS GRID NORTH AS DEFINED BY THE NEVADA COORDINATE SYSTEM OF 1983 (NCS83), EAST ZONE, (2701), DETERMINED BY G.S. CONTROL POINTS, 804 AND 805, AS SHOWN ON A RECORD OF SURVEY ON FILE IN THE CLARK COUNTY, NEVADA RECORDER'S OFFICE, IN FILE 88 OF SURVEYS, AT PAGE 53.

**BENCHMARK**  
 BENCHMARK # 23  
 RIVET AND SQUARE ALUMINUM PLATE IN CONCRETE MONUMENT, 50 FT. SOUTH AND 40 FT. WEST OF CENTENNIAL PKWY. AND EL CAPITAN WAY

**CAUTION:**  
 EXISTING UTILITIES ARE LOCATED ON THE PLANS FROM A SEARCH OF AVAILABLE RECORDS. CONTRACTOR TO VERIFY LOCATIONS AND DEPTHS PRIOR TO CONSTRUCTION.

REVISIONS		NO.		DATE		DESCRIPTION	
1	ADD TWO DRIVEWAYS	18	4/17				
2	REVISE CURB, GUTTER AND ST. LIGHT NOTE	18	4/17				
3	RELOCATE STREETLIGHT SERVICE PEDESTAL	18	4/17				
4	REVISE DIMS. FOR PHASED CONSTRUCTION	18	4/17				

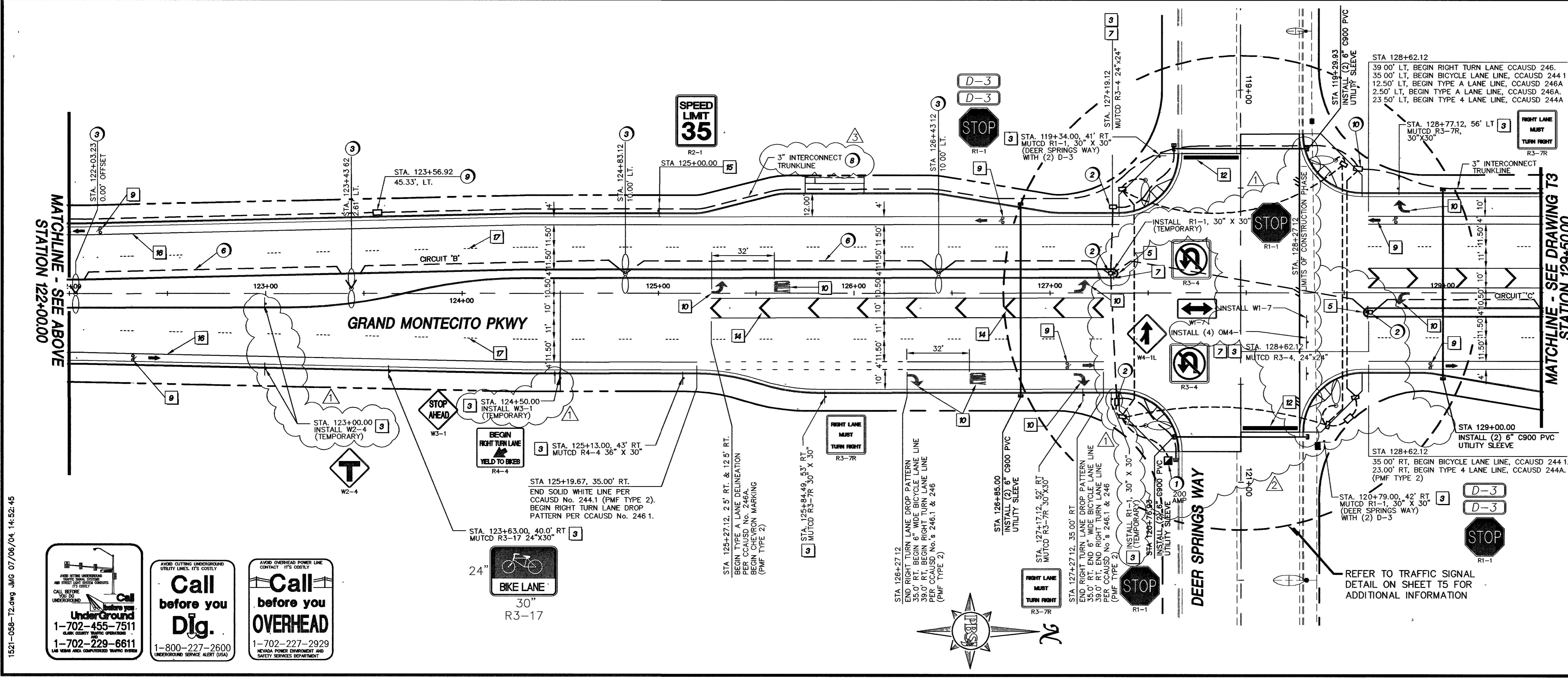

- SIGNING AND STRIPING NOTES**
- 1 RELOCATE EXISTING SIGN AS INDICATED ON THE PLAN
  - 2 REMOVE EXISTING SIGN
  - 3 INSTALL NEW SIGN AS SHOWN
  - 4 PROTECT EXISTING SIGN IN PLACE
  - 5 INSTALL MEDIAN NOSE MARKINGS PER CCAUSD #248.
  - 6 INSTALL STORAGE LANE LINE PER CCAUSD NO 246 (R.P.M.'S)
  - 7 INSTALL NO U-TURN SIGN R3-4 (24"x24") PER MUTCD SECTION 2B.17
  - 8 INSTALL TRANSITION STRIPING PER CCAUSD NO. 245
  - 9 INSTALL BIKE LANE DELINEATION PER CCAUSD NO. 244.1A & 246.1 USING PMF TYPE 1.
  - 10 INSTALL COLD POLYMER ARROW SYMBOL & "ONLY" LEGEND PER CCAUSD NO. 246 & 246A USING PMF TYPE 1.
  - 11 INSTALL 4" COLD POLYMER EDGELINE
  - 12 INSTALL 24" WIDE COLD POLYMER STOP BAR USING PMF TYPE 1
  - 13 INSTALL R4-7 (24"x30") PER MUTCD SECTION 2B.28
  - 14 INSTALL 24" CHEVRON MARKING USING PMF TYPE 1 AT 25.0' O.C.
  - 15 INSTALL R2-1, 35 MPH
  - 16 INSTALL 6" SOLID WHITE LINE PER C.C.A.U.S.D. NO. 244.1 (PMF TYPE 2)
  - 17 INSTALL TYPE 4 LANE LINE PER C.C.A.U.S.D. NO. 244A (R.P.M.'S)

- STREETLIGHT AND SIGNAL NOTES**
- 1 NEW STREETLIGHT SERVICE PEDESTAL, 200 AMP
  - 2 INSTALL #3 1/2 STREETLIGHT PULLBOX
  - 3 INSTALL DECORATIVE STREET LIGHT POLE WITH DUAL MAST ARMS AND 250 WATT H.P.S. GARCO CA-22.2.3 FIXTURE ASSEMBLIES. NO OTHER FIXTURE IS ACCEPTABLE UNLESS APPROVED BY CIV. TRAFFIC ENGINEER. SEE DETAIL DWG T5 STREETLIGHT FOUNDATION FOR AMERON TYPE 6C-1230 POLE.
  - 4 INSTALL #5 TRAFFIC SIGNAL PULLBOX
  - 5 INSTALL #7 TRAFFIC SIGNAL PULLBOX
  - 6 INSTALL 2" STREETLIGHT CONDUIT w/2-#4, 1-#8 THW (TYP.) PER C.C.A.U.S.D. NO. 404.1419. SEE DETAIL ON SHEET T5 FOR ADDITIONAL INFORMATION.
  - 7 INSTALL TYPICAL TRAFFIC SIGNAL CONDUIT LAYOUT WITH STREETLIGHT CONDUIT PER C.C.A.U.S.D. NO. 404.1306 REFER TO DETAIL ON SHEET T5
  - 8 INSTALL 3" INTERCONNECT CONDUIT PER C.C.A.U.S.D. NO. 404.1419. SEE DETAIL SHEET T5 FOR ADDITIONAL INFORMATION. TO BE INSTALLED 6" OFF BACK OF CURB.
  - 9 INSTALL P30 INTERCONNECT PULLBOX (500' MAX SPACING)
  - 10 INSTALL TYPE 200 INTERCONNECT PULLBOX
  - 11 INSTALL A TYPE L FOUNDATION WITH A XX-A TRAFFIC SIGNAL POLE WITH A 400 WATT H.P.S. STREET LIGHT HEAD ASSEMBLY W/RED "EMPTY" SIGNAL CABINET
  - 12 CONDUIT FROM TRANSFORMER TO NEW SERVICE POINT IS 2" WITH 2- 4/0 THW AND 1- 4/0 THW
- NOTES: (1) ALL STREETLIGHT CONDUIT TO BE 2" PVC WITH 2-#4, 1-#8 THW (TYP.)  
 (2) ALL INTERCONNECT CONDUIT TO BE 3" PVC WITH #8 THW GREEN AND PULL STRINGS FOR FUTURE INTERCONNECT CABLE. ALL CONDUITS SHALL ENTER STRAIGHT INTO P30 OR TYPE 200 BOXES

**LEGEND**

---	INTERCONNECT CONDUIT
---	STREETLIGHT CONDUIT
---	TRAFFIC SIGNAL CONDUIT

**Department of Public Works**

**GRAND MONTECITO PARKWAY IMPROVEMENTS STRIPING, SIGNING AND LIGHTING PLAN**

**STA 114+50.00 TO STA 129+50.00**

**REVISIONS**

**ENGINEERING DESIGN SECTION**  
 V. HARRIS  
 02-27-04

**DESIGNED BY**  
 V. HARRIS

**CHECKED BY**  
 V. HARRIS

**DATE**  
 02-27-04

**PROJECT NO.**  
 107V3701

**DRAWING NO.**  
 T2 RE-LOT

**SCALE**  
 AS SHOWN

**APPROVED**

**CITY OF LAS VEGAS**

1521-058-72.dwg 07/08/04 14:52:45

**Call before you Dig.**  
 1-800-227-2600

**Call before you OVERHEAD**  
 1-702-229-2929

**Underground**  
 1-702-455-7511

**Overhead**  
 1-702-229-6611