

**SEVERANCE LANE  
PLAN**  
HORIZONTAL 1"=40'

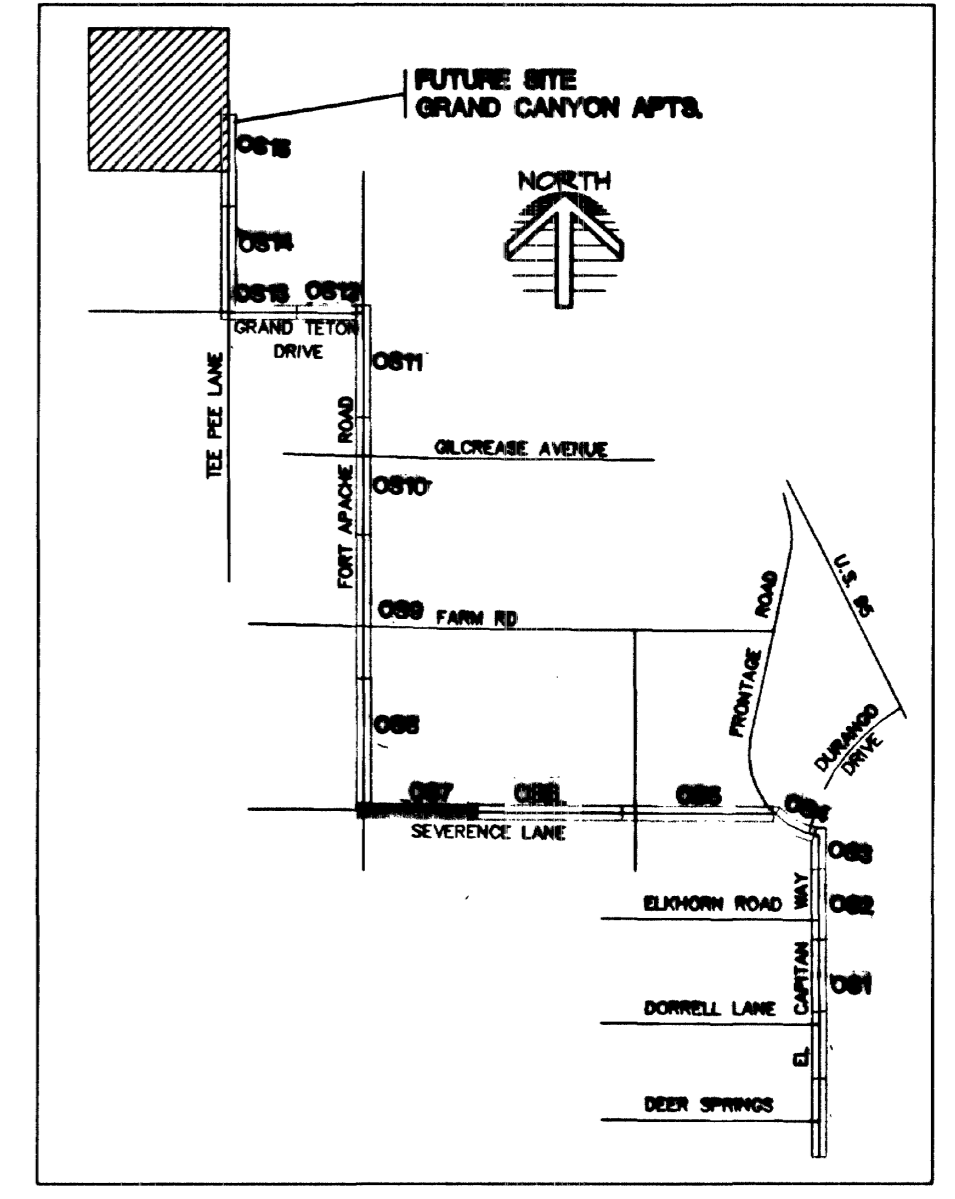

**VICINITY MAP**  
N.T.S.

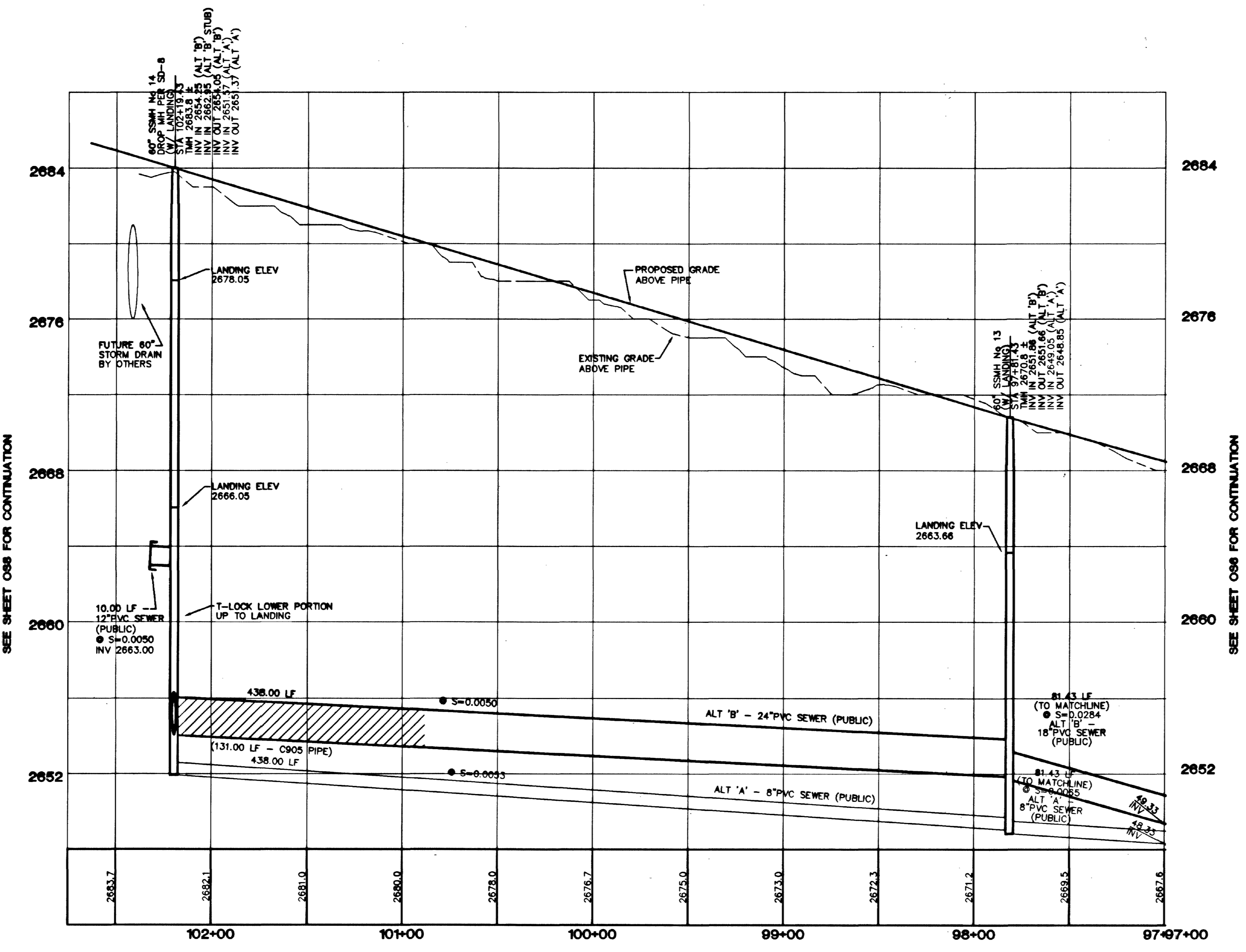

**PROFILE**  
HORIZONTAL 1"=40'  
VERTICAL 1"=4'

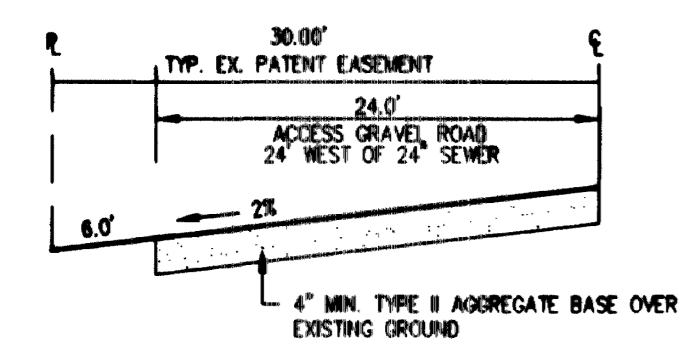

**ACCESS GRAVEL ROAD**  
NOT TO SCALE

**NOTE**  
FOR MANHOLE DEPTHS OVER 16', SEE DETAIL SHEET OS3.

**NOTE**  
MANHOLES SHALL HAVE AN APPROVED LOCKING COVER PER PARAGRAPH 2.2.9 OF THE DESIGN AND CONSTRUCTION STANDARDS FOR WASTEWATER COLLECTION SYSTEMS.

**NOTE**  
ALTERNATE 'A' SEWER DESIGN IS FOR BIDDING PURPOSES ONLY. ALT 'B' TO BE CONSTRUCTED.

**BENCHMARK**  
PROJECT DATUM: NORTH AMERICAN VERTICAL DATUM OF 1988 (NAVD88)  
CLARK COUNTY BENCHMARK: 00901786  
NAVD88 ELEVATION: 799.117 METERS (2621.77 FEET)  
RIVET AND SQUARE ALUMINUM PLATE IN TOP CENTER OF HEADWALL ON THE WEST SIDE OF U.S. 95 NEAR MILE MARKER 90.15.

**BASIS OF BEARING:**  
N 89°19'50" W - BEING THE BEARING OF THE SOUTH LINE OF THE SOUTHEAST QUARTER (SE 1/4) OF SECTION 7, TOWNSHIP 19 SOUTH, RANGE 59 EAST, M.D.M., CLARK COUNTY, NEVADA, AS SHOWN BY THAT RECORD OF SURVEY ON FILE IN THE OFFICE OF THE COUNTY RECORDER, CLARK COUNTY, NEVADA, IN BOOK 114 OF SURVEYS, AT FILE 57.

**NOTE**  
EXISTING UTILITY LOCATIONS SHOWN HEREIN ARE APPROXIMATE ONLY. IT SHALL BE THE CONTRACTOR'S RESPONSIBILITY TO DETERMINE THE EXACT VERTICAL AND HORIZONTAL LOCATION OF ALL EXISTING UNDERGROUND UTILITIES PRIOR TO COMMENCING CONSTRUCTION. NO REPRESENTATION IS MADE THAT ALL EXISTING UTILITIES ARE SHOWN HEREON. THE ENGINEER ASSUMES NO RESPONSIBILITY FOR UTILITIES NOT SHOWN OR UTILITIES NOT SHOWN IN THEIR PROPER LOCATIONS. CALL BEFORE YOU DIG: 1 (800) 227-2600.  
CONTRACTOR SHALL VERIFY HORIZONTAL AND VERTICAL LOCATION OF EXISTING UTILITIES AND NOTIFY THE DESIGN ENGINEER IMMEDIATELY OF ANY DISCREPANCIES PRIOR TO CONSTRUCTION.

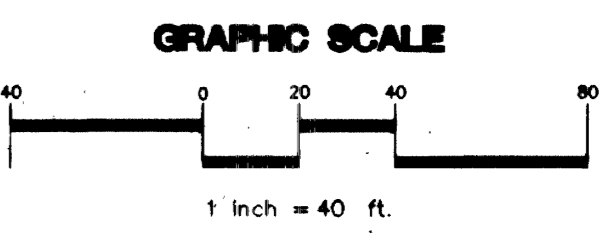
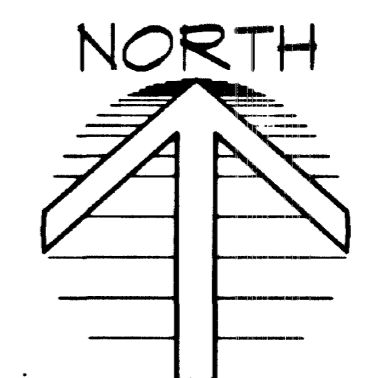

Avoid cutting underground utility lines. It's costly.  
**Call before you Dig**  
1-800-227-2600

Avoid overhead power line contact. It's costly.  
**Call before you Overhead**  
1-702-593-6111

**GRAND CANYON PARTNERS, LLC.**  
3320 NORTH BUFFALO DRIVE SUITE 203  
LAS VEGAS, NEVADA 89129  
(702)398-2000

**nevada**  
2727 SOUTH RAINBOW BOULEVARD LAS VEGAS, NEVADA 89146-5148  
PH. (702) 873-7550 FAX (702) 862-2597

**SEVERANCE LANE**  
STA: 97+00.00 - 102+31.02

**GRAND CANYON APARTMENTS**  
GRAND OFF-SITE SEWER

DRAWN BY: JAN 2002  
DESIGNED BY: JULY 2001  
CHECKED BY:

PROJECT NO: 6036-05  
SCALE: 1"=40' HORIZ.  
1"=4' VERT.

EXPIRES 06-30-03

**PROFESSIONAL ENGINEER STATE OF NEVADA**  
DANIEL HOOK  
NO. 72811  
CIVIL  
9.25.02

SHEET  
**OS7**  
10 OF 18 SHEETS  
DRAWING NO.  
107-V3625-05

REVISION  
DATE  
BY

PLANNERS • LAND SURVEYORS