

SEVERANCE LANE PLAN
HORIZONTAL 1"=40'

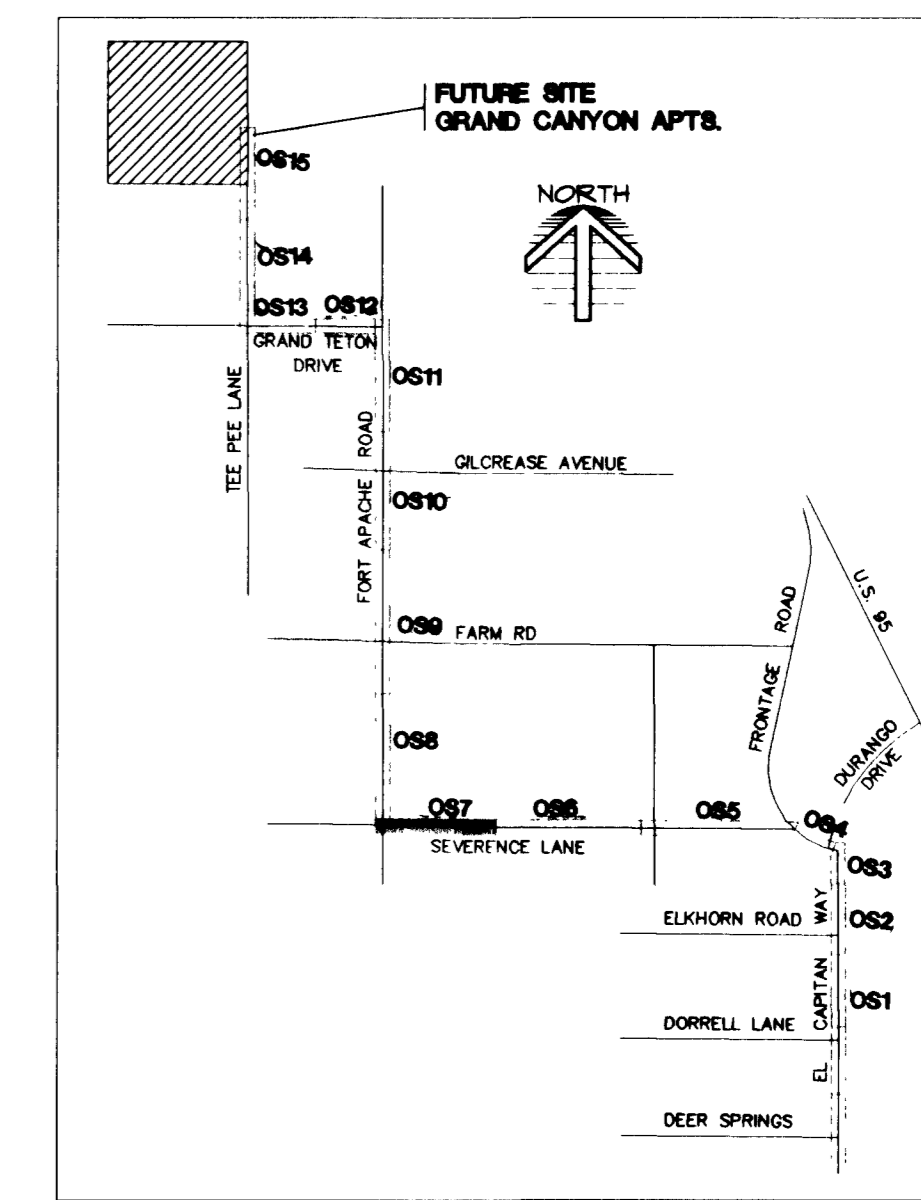

VICINITY MAP
N.T.S.

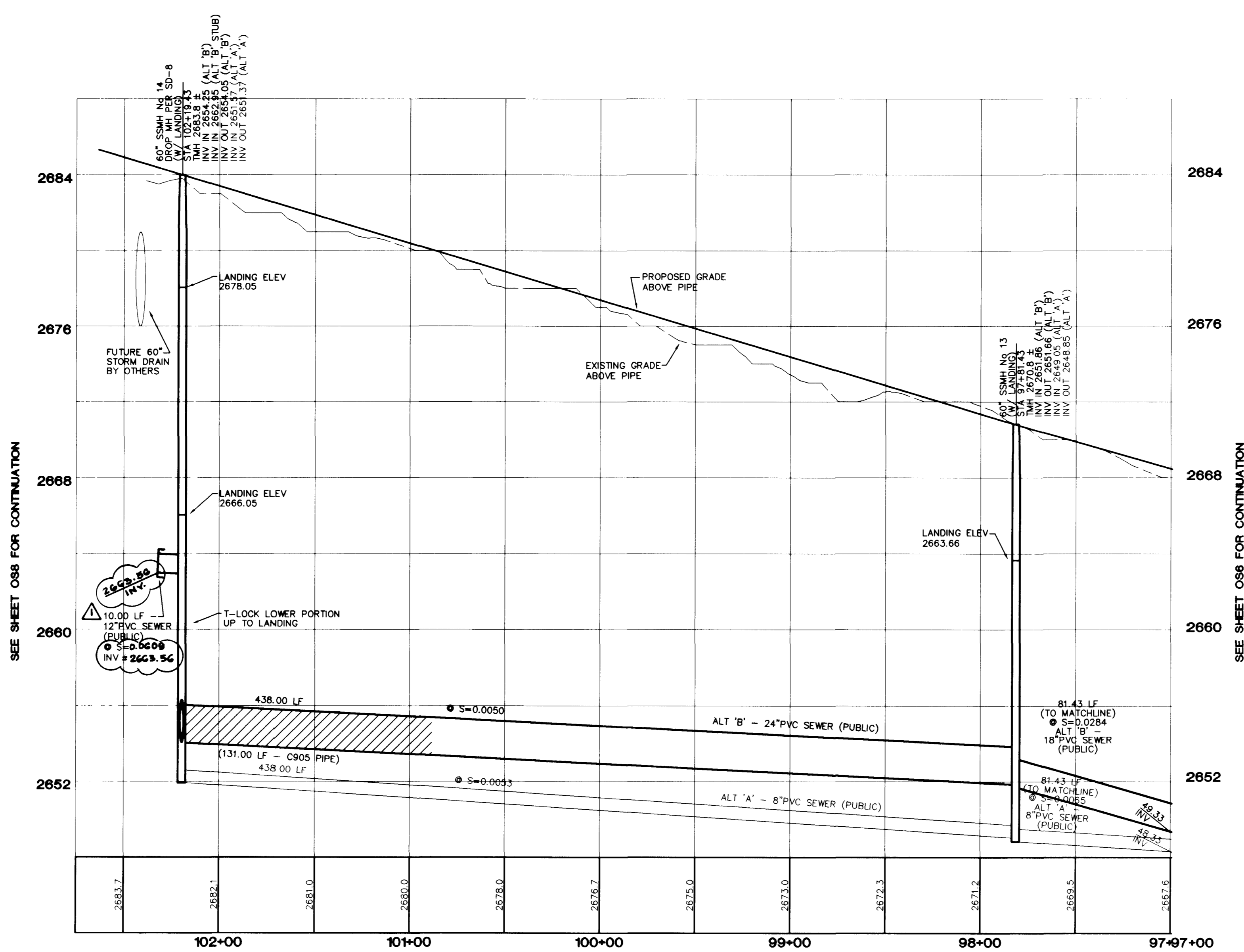

PROFILE
HORIZONTAL 1"=40'
VERTICAL 1"=4'

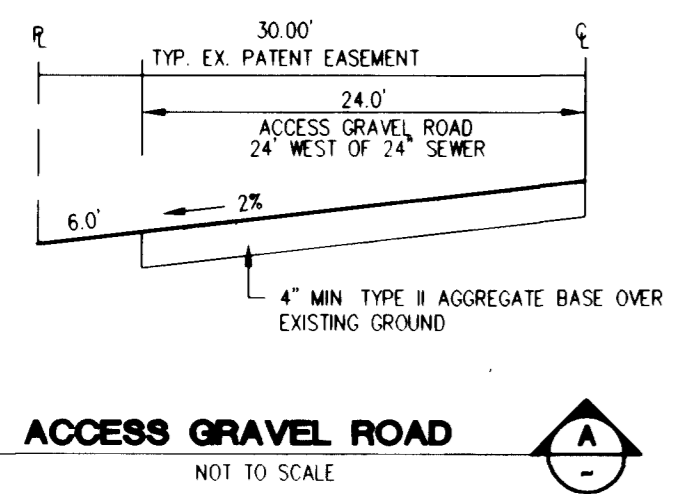

ACCESS GRAVEL ROAD
NOT TO SCALE

NOTE
FOR MANHOLE DEPTHS OVER 18', SEE DETAIL SHEET OS3.

NOTE
MANHOLES SHALL HAVE AN APPROVED LOCKING COVER PER PARAGRAPH 2.2.9 OF THE DESIGN AND CONSTRUCTION STANDARDS FOR WASTEWATER COLLECTION SYSTEMS.

NOTE
ALTERNATE 'A' SEWER DESIGN IS FOR BIDDING PURPOSES ONLY. ALT 'B' TO BE CONSTRUCTED.

BENCHMARK
PROJECT DATUM: NORTH AMERICAN VERTICAL DATUM OF 1988 (NAVD88)
CLARK COUNTY BENCHMARK: 0C8017N6
NAVD88 ELEVATION: 799.117 METERS (2621.77 FEET)
RIVET AND SQUARE ALUMINUM PLATE IN TOP CENTER OF HEADWALL ON THE WEST SIDE OF U.S. 95 NEAR MILE MARKER 90.15.

BASIS OF BEARING:
N 89°09'50" W—BEING THE BEARING OF THE SOUTH LINE OF THE SOUTHEAST QUARTER (SE 1/4) OF SECTION 7, TOWNSHIP 19 SOUTH, RANGE 59 EAST, M.D.M., CLARK COUNTY, NEVADA, AS SHOWN BY THAT RECORD OF SURVEY ON FILE IN THE OFFICE OF THE COUNTY RECORDER, CLARK COUNTY, NEVADA, IN BOOK 114 OF SURVEYS, AT FILE 57.

GC WALLACE
John Stank
Exp 1/21/04
FOR REVISION ONLY
10/31/02

NOTE:
EXISTING UTILITY LOCATIONS SHOWN HEREIN ARE APPROXIMATE ONLY. IT SHALL BE THE CONTRACTOR'S RESPONSIBILITY TO DETERMINE THE EXACT VERTICAL AND HORIZONTAL LOCATION OF ALL EXISTING UNDERGROUND UTILITIES PRIOR TO COMMENCING CONSTRUCTION. NO REPRESENTATION IS MADE THAT ALL EXISTING UTILITIES ARE SHOWN HEREON. THE ENGINEER ASSUMES NO RESPONSIBILITY FOR UTILITIES NOT SHOWN OR UTILITIES NOT SHOWN IN THEIR PROPER LOCATIONS.
CALL BEFORE YOU DIG: 1 (800) 227-2600.
CONTRACTOR SHALL VERIFY HORIZONTAL AND VERTICAL LOCATION OF EXISTING UTILITIES AND NOTIFY THE DESIGN ENGINEER IMMEDIATELY OF ANY DISCREPANCIES PRIOR TO CONSTRUCTION.

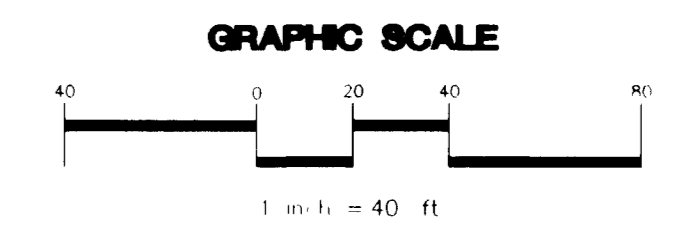
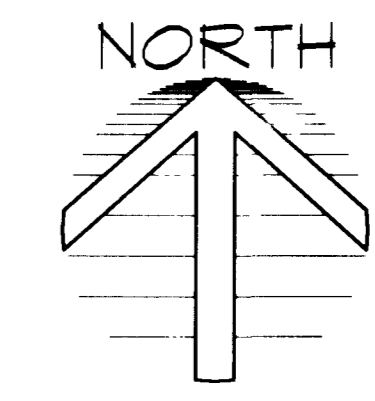

Avoid cutting underground utility lines. It's costly.
Call before you Dig
1-800-227-2600

Avoid overhead power lines. It's costly.
Call before you Overhead
1-702-593-6111

GRAND CANYON PARTNERS, L.L.C. 3320 NORTH BUFFALO DRIVE SUITE 203 LAS VEGAS, NEVADA 89128 (702) 395-2650		CITY OF LAS VEGAS	
SEVERANCE LANE STA: 97+00.00 - 102+31.02		GRAND CANYON APARTMENTS OFF-SITE SEWER	
DRAWN BY: JAN 2002	DESIGNED BY: JULY 2001	CHECKED BY:	PROJECT NO: 6036-05
SCALE: 1"=40' HORIZ.		SCALE: 1"=4' VERT.	
EXPIRES 06-30-03			
SHEET OS7			
10 OF 18 SHEETS			
DRAWING NO. 107-V3625-05			