

Call before you Dig
1-800-227-2600
Nevada Power Environment and Safety Services Department

Call before you Overhead
1-702-593-6111
Nevada Power Environment and Safety Services Department

NOTE: PROTECT WATERLINES IN PLACE. WHENEVER A WATERLINE IS WITHIN 18" ABOVE A STORM DRAIN OR SEWER, OR WHERE COMPACTION REQUIREMENTS UNDER A WATERLINE CANNOT BE MET, BACKFILL TRENCH WITH CONTROL LOW STRENGTH MATERIAL (CLSM) TO THE SPRINGLINE OF THE WATERLINE. THIS REQUIREMENT IS FOR STRUCTURAL SUPPORT ONLY. ADDITIONAL HEALTH REQUIREMENTS MAY APPLY PER UDACS 2.19

NOTE: FINISHED GRADE ELEVATIONS FOR MANHOLES AND DROP INLETS ARE AT THE CENTER OF MANHOLE LIDS AND T.O.C. AT THE CENTER OF DROP INLETS. SET FINISHED GRADE ELEVATIONS FOR THE EDGES OF MANHOLE LIDS AND T.O.C. AT DROP INLETS PER STREET SLOPES.

NOTE: THE DISTRICT CAN NOT GUARANTEE A WATERTIGHT SHUTDOWN WHERE CONNECTIONS OR REPAIRS TO EXISTING FACILITIES ARE REQUIRED. THE CONTRACTOR SHALL ENSURE ALL LABOR AND EQUIPMENT IS AVAILABLE TO REMOVE FUGITIVE WATER WHICH MAY IMPEDE CONSTRUCTION AT ALL TIMES. COORDINATION WITH INSPECTION DIVISION MUST TAKE PLACE PRIOR TO ANY SHUTDOWN. CONTRACTOR TO INSTALL TEMPORARY SERVICE TO ENSURE PROPER SHUTDOWN IN THE EVENT NO OTHER APPURTENANCES ARE AVAILABLE, THE COST OF WHICH IS INCIDENTAL TO THE WORK.

NOTE: APPLY POLYURETHANE ELASTOMERIC SEAL TO THE NEAREST 10 FOOT RCP JOINT (BOTH SIDES) OF WATER LINE CROSSING (INSIDE APPLICATION ONLY).

NOTE: AT STA 137+33.55 START TO ROLL DOWN (3) 45° BENDS TO MAKE A 90° TURN. LINE UP WITH PROPOSED 12" WET TAP AT STA 137+25.32.

NOTE: FOR UTILITY CROSSINGS, STORM DRAIN AND LATERALS, SEE SHEETS C317 TO C324

NOTE: RUBBER GASKETED JOINTS SHALL BE USED FOR ALL STORM DRAIN PIPE JOINTS

SERVICE LATERAL KEYNOTES

- INSTALL WATER SERVICE LATERAL, CAP AND BLOWOFF ASSEMBLY PER UDACS PLATE #6B AND #4A.
- INSTALL PVC SANITARY SEWER PER DETAIL 'D' DWG C330.
- INSTALL 12"x6" TEE W/6" GATE VALVES AS SHOWN W/THRUST BLOCKS & ANCHOR BLOCKS PER UDACS PLATES 3# AND #5
- INSTALL 12"x12" TEE W/12" GATE VALVES AS SHOWN W/THRUST BLOCKS & ANCHOR BLOCKS PER UDACS PLATES 3# AND #5

WATER LINE KEYNOTES

- INSTALL 2" SERVICE SADDLE W/ 2" CORPORATION STOP FOR TESTING FIELD LOCATE PER LVVWD. ABANDON CORPORATION STOP AFTER TESTING IS COMPLETED PER LVVWD.
- INSTALL 2" SERVICE SADDLE W/ 2" CORPORATION STOP FOR TESTING FIELD LOCATE PER LVVWD. CORPORATION STOP TO BE USED FOR TESTING OF NEW & EXISTING 12" WATER LINE. ABANDON CORPORATION STOP ONLY AFTER ALL TESTING HAVE BEEN DONE PER LVVWD.

NOTE: APPROVAL OF THESE PLANS FOR THE WATER STUBOUT INSTALLATION WILL NOT BE CONSTRUED AS A COMMITMENT FOR WATER SERVICE TO THIS PROPERTY.

137 NPD 6/02/04
L.V.V.W.D. DATE 3/14/05

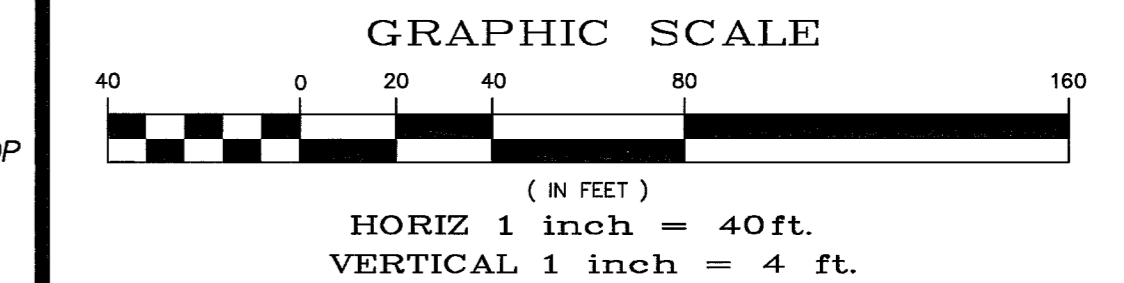
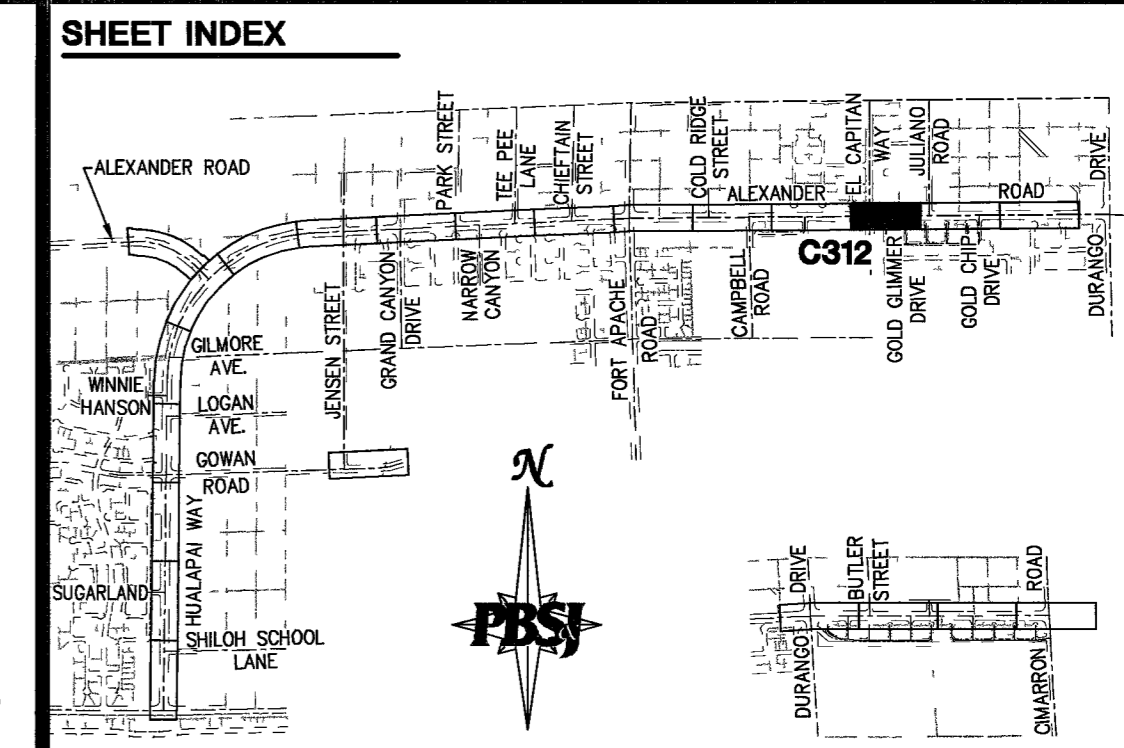

BASIS OF BEARING
THE BASIS OF BEARINGS FOR THIS PROJECT IS GRID NORTH AS DEFINED BY THE NEVADA COORDINATE SYSTEM OF 1983 (NCS83), EAST ZONE, (2701), DETERMINED BY GIS CONTROL POINTS, "80B" AND "877" AS SHOWN ON A RECORD OF SURVEY ON FILE IN THE CLARK COUNTY RECORDER'S OFFICE, IN FILE 88 OF SURVEYS, AT PAGE 53.

BENCHMARK
CITY OF LAS VEGAS BENCHMARK NO. 9LV00 7N4 - RIVET AND PLATE IN TOP OF CURB SOUTHEAST CORNER OF ALEXANDER ROAD AND GRAND CANYON DRIVE.
NAVD 1988 DATUM
ELEVATION = 792.858 METERS
2601.24 FEET

CAUTION:
EXISTING UTILITIES ARE LOCATED ON THE PLANS FROM A SEARCH OF AVAILABLE RECORDS. CONTRACTOR TO VERIFY LOCATIONS AND DEPTHS PRIOR TO CONSTRUCTION.

KEY NOTES

- REMOVE EXISTING MANHOLE.
- REMOVE EXISTING DROP INLET/BEEHIVE INLET.
- REMOVE EXISTING 36" STORM DRAIN PIPE.
- REMOVE EXISTING 66" STORM DRAIN PIPE.
- ABANDON IN PLACE EXISTING 18" STORM DRAIN PIPE.
- INSTALL TYPE I MANHOLE PER STD. DWG. #403.
- INSTALL TYPE II MANHOLE PER STD. DWG. #405.
- INSTALL TYPE III MANHOLE PER STD. DWG. #406.
- INSTALL JUNCTION MANHOLE TYPE 1 PER DETAIL 'A', DWG. C327.
- INSTALL PRECAST TEE W/48" RISER PER DETAIL 'B', DWG. C331 (W/ 30" MIN. ACCESS).
- INSTALL TYPE 'CM' DROP INLET PER DETAIL 'A', DWG. C329.
- INSTALL TYPE 'E' DROP INLET PER DETAIL 'A', DWG. C328.
- INSTALL TYPE 'F' DROP INLET PER DETAIL 'A', DWG. C328.
- INSTALL NDOT TYPE 3 DROP INLET WITH BACK WALL OPENING PER DETAIL 'D' AND DETAIL 'E', DWG. C332.
- INSTALL SWALE INLET PER DETAIL 'B', DWG. C329.
- CONSTRUCT NDOT TYPE II HEADWALL PER NDOT STANDARD PLAN SHEET B-20.1-A.
- INSTALL ANWA 8" C900 DRAINLINE.
- INSTALL ANWA 12" C900 DRAINLINE.
- INSTALL 12" RCP SD PER TRENCH DETAIL 'B', DWG. C330.
- INSTALL 18" RCP SD PER TRENCH DETAIL 'B', DWG. C330.
- INSTALL 24" RCP SD PER TRENCH DETAIL 'B', DWG. C330.
- INSTALL 30" RCP SD PER TRENCH DETAIL 'B', DWG. C330.
- INSTALL 36" RCP SD PER TRENCH DETAIL 'B', DWG. C330.
- INSTALL 42" RCP SD PER TRENCH DETAIL 'B', DWG. C330.
- INSTALL 48" RCP SD PER TRENCH DETAIL 'B', DWG. C330.
- INSTALL 54" RCP SD PER TRENCH DETAIL 'B', DWG. C330.
- INSTALL 60" RCP SD PER TRENCH DETAIL 'B', DWG. C330.
- INSTALL 66" RCP SD PER TRENCH DETAIL 'B', DWG. C330.
- INSTALL 72" RCP SD PER TRENCH DETAIL 'B', DWG. C330.
- INSTALL 78" RCP SD PER TRENCH DETAIL 'B', DWG. C330.
- INSTALL 34"x53" HE RCP SD PER TRENCH DETAIL 'B', DWG. C330.
- INSTALL 3" HIGH x 6" WIDE RCB SD PER TRENCH DETAIL 'B', DWG. C330.
- INSTALL 5" HIGH x 6" WIDE RCB SD PER TRENCH DETAIL 'B', DWG. C330.
- RELOCATE EXISTING WATERLINE PER DETAIL 'E', DWG. C330.
- RELOCATE EXISTING GAS (BY OTHERS).
- RELOCATE EXISTING UNDERGROUND POWER (BY NEVADA POWER COMPANY).
- RELOCATE EXISTING UNDERGROUND TELEPHONE (BY SPRINT TELEPHONE COMPANY).
- RELOCATE EXISTING UNDERGROUND CATV (BY COX COMMUNICATIONS LAS VEGAS, INC.).
- CONCRETE ENCASUREMENT PER DETAIL 'A', DWG. C330.
- PERMANENT ASPHALT PATCH PER DETAIL 'B', DWG. C330.
- PIPE PENETRATION PER DETAIL 'A' DWG. C332.
- CONNECT TO EXISTING STORM DRAIN PIPE PER DETAIL 'C', DWG. C330.
- 45° BEND ROLLED DOWN

DEPARTMENT OF PUBLIC WORKS
ENGINEERING DESIGN SECTION
CITY ENGINEER: CHARLES KAJKOWSKI JR., P.E.
CITY PROJECT ENGINEER: MARVIN STINE, P.E.
PROJECT MANAGER: AL ZENHARI, P.E.
DESIGN BY: WHJ
DRAWN BY: LSB/WHJ
CHECK BY: LSB
DATE: FEB. 11, 2004

ALEXANDER ROAD/HUALAPAI WAY
ROAD IMPROVEMENTS PROJECT
CHEYENNE AVENUE TO DURANGO DRIVE
ALEXANDER ROAD STORM DRAIN PLAN
AND PROFILE, WATER AND SEWER LATERAL
AND STA 135+00.00 TO STA 143+00.00
SHEET: C312
65 of 124
DRAWING# 107-V-3594

