

SIGHT VISIBILITY ZONE NOTE
 NO WALLS, FENCES SHRUBS, UTILITY APPURTENANCES OR ANY OTHER OBJECT, OTHER THAN TRAFFIC CONTROL DEVICES, FIRE HYDRANTS, TREES, AND STREET LIGHT POLES, MAY BE CONSTRUCTED OR INSTALLED WITHIN THE SIGHT VISIBILITY ZONE UNLESS SAID OBJECT IS MAINTAINED AT LESS THAN 24 INCHES IN HEIGHT, MEASURED FROM TOP OF CURB, OR WHERE NO CURB EXISTS, A HEIGHT OF 27 INCHES MEASURED FROM THE TOP OF ADJACENT ASPHALT, GRAVEL OR PAVEMENT STREET SURFACE. THIS RESTRICTION EXTENDS ALONG THE SIGHT VISIBILITY LINE THROUGH LANDSCAPED MEDIANS.

DISCLAIMER NOTE
 PLEASE REFER TO TRAFFIC SHEET C10 FOR SIGHT VISIBILITY ZONE DIMENSIONS.

UNDERGROUND UTILITIES AS SHOWN HEREON HAVE BEEN LOCATED FROM OBSERVED FIELD SURVEY EVIDENCE AND EXISTING DRAWINGS, INCLUDING BUT NOT LIMITED TO THE FOLLOWING, PLANS PROVIDED BY THE CLIENT, UTILITY COMPANIES, AND MUNICIPAL AGENCIES. THE SURVEYOR MAKES NO GUARANTEE THAT THE UNDERGROUND UTILITIES SHOWN COMPRISE ALL SUCH UTILITIES IN THE AREA, EITHER IN SERVICE OR ABANDONED. THE SURVEYOR FURTHER DOES NOT WARRANT THAT THE UNDERGROUND UTILITIES SHOWN ARE IN THE EXACT LOCATION INDICATED ALTHOUGH HE DOES CERTIFY THAT THEY ARE LOCATED AS ACCURATELY AS POSSIBLE FROM INFORMATION AVAILABLE. THE SURVEYOR HAS NOT PHYSICALLY LOCATED THE UNDERGROUND UTILITIES.

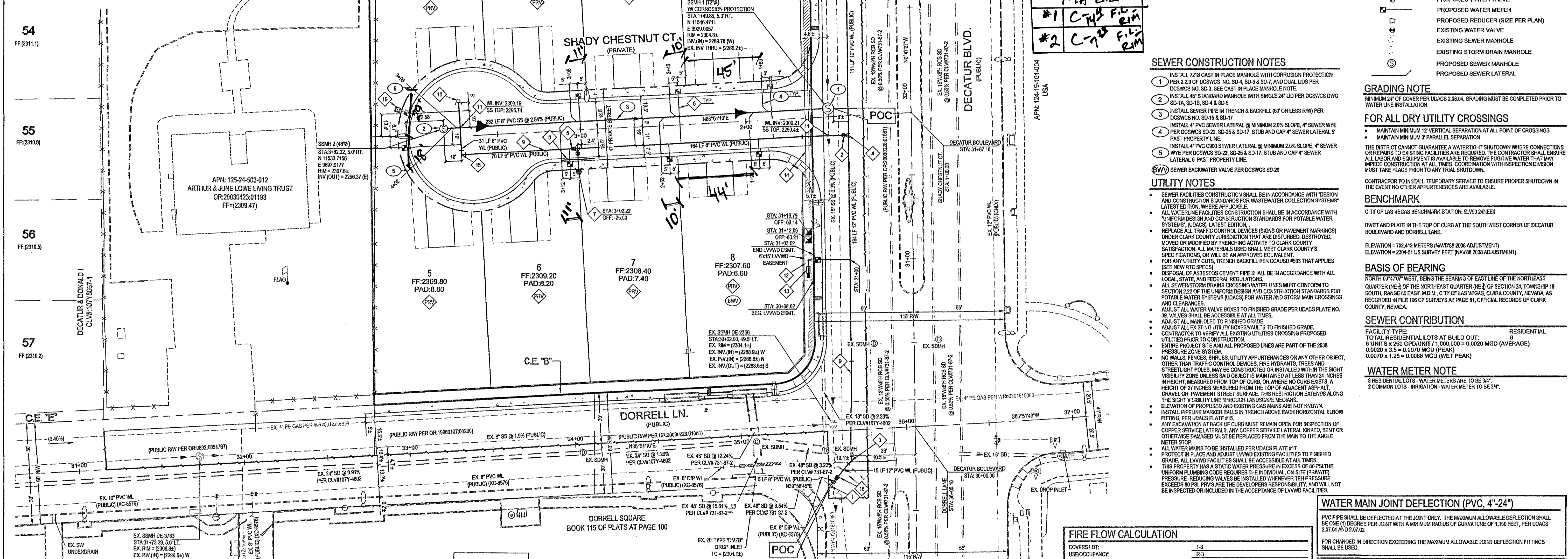

- WATER CONSTRUCTION NOTES**
- INSTALL 8" X 12" TAPPING SLEEVE W TAPPING VALVE PER UDACS PLATE #34 AND SECTION 2.24.01A
 - INSTALL 8" GATE VALVE PER UDACS PLATES #30 AND #31
 - INSTALL 45° BEND WITH RESTRAINED FITTING AND JOINTS PER UDACS #31
 - INSTALL 8" X 12" TEE W THRUST BLOCK PER UDACS PLATE #31
 - INSTALL 6" X 12" REDUCER W THRUST BLOCK PER UDACS PLATE #30
 - INSTALL 3/4" WATER METER (DOMESTIC) COMPLETE WITH 1" COPPER WATER SERVICE LINE WITH SERVICE SADDLE & CORPORATION STOP PER UDACS PLATE #4 AND DETAIL "A"
 - INSTALL FIRE HYDRANT ASSEMBLY PER UDACS #30, 38 AND 40
 - PAINT CURB ADJACENT TO FIRE HYDRANT PER SECTION 5.7.2 SOUTHERN NEVADA FIRE CODE W ORDINANCE #633.
 - INSTALL WATER PIPE IN TRENCH AND BACKFILL PER UDACS PLATE #17
 - INSTALL CAP WITH 2" BLOW-OFF ASSEMBLY PER UDACS PLATE #36
 - MAINTAIN SEPARATION BETWEEN WATER MAIN AND SANITARY SEWER PIPE PER UDACS STANDARD 2.22.02
 - INSTALL 3/4" WATER METER (IRRIGATION) COMPLETE WITH 1" COPPER WATER SERVICE LINE WITH SERVICE SADDLE & CORPORATION STOP PER UDACS PLATE #4 AND DETAIL "A"
 - INSTALL 1" RPPA (IRRIGATION) PER UDACS PLATE #8 AND DETAIL "A"
 - INSTALL 2" - 6" IRRIGATION SLEEVES
 - INSTALL 90° BEND W THRUST BLOCK PER UDACS PLATE #30
 - INSTALL 8" X 12" REDUCER W THRUST BLOCK PER UDACS PLATE #30
 - INSTALL 12" X 12" TEE W THRUST BLOCK PER UDACS PLATE #31
 - INSTALL 12" GATE VALVE PER UDACS PLATES #30 AND #30
 - INSTALL FLUSHING VALVE ASSEMBLY PER DETAIL H, SHEET C4
 - PRESSURE REDUCER VALVE

- SEWER CONSTRUCTION NOTES**
- INSTALL 22" CAST IN PLACE MANHOLE WITH CORROSION PROTECTION PER 2.2.5 OF DCSWCS NO. SD-4, SD-5 & SD-7, AND DUAL LIDS PER DCSWCS NO. SD-3. SEE CAST IN PLACE MANHOLE NOTE.
 - INSTALL 48" STANDARD MANHOLE WITH SINGLE 24" LID PER DCSWCS DWG SD-1A, SD-1B, SD-4 & SD-5
 - INSTALL SEWER PIPE IN TRENCH & BACKFILL (60% OR LESS R/W) PER DCSWCS NO. SD-15 & SD-17
 - INSTALL 4" PVC SEWER LATERAL @ MINIMUM 2.0% SLOPE, 4" SEWER WYE PER DCSWCS SD-22, SD-25 & SD-17. STUB AND CAP 4" SEWER LATERAL 5' PAST PROPERTY LINE.
 - INSTALL 4" PVC C900 SEWER LATERAL @ MINIMUM 2.0% SLOPE, 4" SEWER WYE PER DCSWCS SD-22, SD-25 & SD-17. STUB AND CAP 4" SEWER LATERAL 5' PAST PROPERTY LINE.

- UTILITY NOTES**
- SEWER FACILITIES CONSTRUCTION SHALL BE IN ACCORDANCE WITH "DESIGN AND CONSTRUCTION STANDARDS FOR WASTEWATER COLLECTION SYSTEMS" LATEST EDITION, WHERE APPLICABLE.
 - ALL WATERLINE FACILITIES CONSTRUCTION SHALL BE IN ACCORDANCE WITH "UNIFORM DESIGN AND CONSTRUCTION STANDARDS FOR POTABLE WATER SYSTEMS" UDACS LATEST EDITION.
 - REPLACE ALL TRAFFIC CONTROL DEVICES (SIGNS OR PAVEMENT MARKINGS) UNDER CLARK COUNTY JURISDICTION THAT ARE DISTURBED, DESTROYED, MOVED OR MODIFIED BY TRENCHING ACTIVITY TO CLARK COUNTY SATISFACTION. ALL MATERIALS USED SHALL MEET CLARK COUNTY SPECIFICATIONS OR WILL BE AN APPROVED EQUIVALENT.
 - FOR ANY UTILITY CUTS, TRENCH BACKFILL PER COALS #503 THAT APPLIES (SEE NEW RTO SPEC).
 - DISPOSAL OF ASBESTOS CEMENT PIPE SHALL BE IN ACCORDANCE WITH ALL LOCAL, STATE, AND FEDERAL REGULATIONS.
 - ALL SEWER STORM DRAINS CROSSING WATER LINES MUST CONFORM TO SECTION 2.22 OF THE UNIFORM DESIGN AND CONSTRUCTION STANDARDS FOR POTABLE WATER SYSTEMS (UDACS) FOR WATER AND STORM MAIN CROSSINGS AND CLEARANCES.
 - ADJUST ALL WATER VALVE BOXES TO FINISHED GRADE PER UDACS PLATE NO. 38. VALVES SHALL BE ACCESSIBLE AT ALL TIMES.
 - ADJUST ALL MANHOLES TO FINISHED GRADE.
 - ADJUST ALL EXISTING UTILITY BOXES/VALVES TO FINISHED GRADE.
 - CONTRACTOR TO VERIFY ALL EXISTING UTILITIES CROSSING PROPOSED UTILITIES PRIOR TO CONSTRUCTION.
 - ENTIRE PROJECT SITE AND ALL PROPOSED LINES ARE PART OF THE 2538 PRESSURE ZONE SYSTEM.
 - NO WALLS, FENCES, SHRUBS, UTILITY APPURTENANCES OR ANY OTHER OBJECT, OTHER THAN TRAFFIC CONTROL DEVICES, FIRE HYDRANTS, TREES AND STREET LIGHT POLES, MAY BE CONSTRUCTED OR INSTALLED WITHIN THE SIGHT VISIBILITY ZONE UNLESS SAID OBJECT IS MAINTAINED AT LESS THAN 24 INCHES IN HEIGHT, MEASURED FROM TOP OF CURB, OR WHERE NO CURB EXISTS, A HEIGHT OF 27 INCHES MEASURED FROM THE TOP OF ADJACENT ASPHALT, GRAVEL OR PAVEMENT STREET SURFACE. THIS RESTRICTION EXTENDS ALONG THE SIGHT VISIBILITY LINE THROUGH LANDSCAPED MEDIANS.
 - ELEVATION OF PROPOSED AND EXISTING GROUND LINES ARE NOT KNOWN. INSTALL ALL PIPELINE MARKERS SHALL IN TRENCH ABOVE EACH HORIZONTAL ELBOW FITTING, PER UDACS PLATE #15.
 - ANY EXCAVATION WORK SHALL BE KEPT OPEN FOR INSPECTION OF COPPER SERVICE LATERALS. ANY COPPER SERVICE LATERAL, KNICKED, BENT OR OTHERWISE DAMAGED MUST BE REPLACED FROM THE MAIN TO THE ANGLE METER STOP.
 - ALL WATER MAINS TO BE INSTALLED PER UDACS PLATE #17
 - PROTECT IN PLACE AND ADJUST LWWD EXISTING FACILITIES TO FINISHED GRADE. ALL LWWD FACILITIES SHALL BE ACCESSIBLE AT ALL TIMES.
 - THIS PROPERTY HAS A STATIC WATER PRESSURE IN EXCESS OF 80 PSI THE UNIFORM PLUMBING CODE REQUIRES THE INDIVIDUAL, ON SITE (PRIVATE), PRESSURE-REDUCING VALVES BE INSTALLED WHENEVER THE PRESSURE EXCEEDS 80 PSI. PRVs ARE THE DEVELOPERS RESPONSIBILITY, AND WILL NOT BE INSPECTED OR INCLUDED IN THE ACCEPTANCE OF LWWD FACILITIES.

- UTILITY NOTES**
- SEWER FACILITIES CONSTRUCTION SHALL BE IN ACCORDANCE WITH "DESIGN AND CONSTRUCTION STANDARDS FOR WASTEWATER COLLECTION SYSTEMS" LATEST EDITION, WHERE APPLICABLE.
 - ALL WATERLINE FACILITIES CONSTRUCTION SHALL BE IN ACCORDANCE WITH "UNIFORM DESIGN AND CONSTRUCTION STANDARDS FOR POTABLE WATER SYSTEMS" UDACS LATEST EDITION.
 - REPLACE ALL TRAFFIC CONTROL DEVICES (SIGNS OR PAVEMENT MARKINGS) UNDER CLARK COUNTY JURISDICTION THAT ARE DISTURBED, DESTROYED, MOVED OR MODIFIED BY TRENCHING ACTIVITY TO CLARK COUNTY SATISFACTION. ALL MATERIALS USED SHALL MEET CLARK COUNTY SPECIFICATIONS OR WILL BE AN APPROVED EQUIVALENT.
 - FOR ANY UTILITY CUTS, TRENCH BACKFILL PER COALS #503 THAT APPLIES (SEE NEW RTO SPEC).
 - DISPOSAL OF ASBESTOS CEMENT PIPE SHALL BE IN ACCORDANCE WITH ALL LOCAL, STATE, AND FEDERAL REGULATIONS.
 - ALL SEWER STORM DRAINS CROSSING WATER LINES MUST CONFORM TO SECTION 2.22 OF THE UNIFORM DESIGN AND CONSTRUCTION STANDARDS FOR POTABLE WATER SYSTEMS (UDACS) FOR WATER AND STORM MAIN CROSSINGS AND CLEARANCES.
 - ADJUST ALL WATER VALVE BOXES TO FINISHED GRADE PER UDACS PLATE NO. 38. VALVES SHALL BE ACCESSIBLE AT ALL TIMES.
 - ADJUST ALL MANHOLES TO FINISHED GRADE.
 - ADJUST ALL EXISTING UTILITY BOXES/VALVES TO FINISHED GRADE.
 - CONTRACTOR TO VERIFY ALL EXISTING UTILITIES CROSSING PROPOSED UTILITIES PRIOR TO CONSTRUCTION.
 - ENTIRE PROJECT SITE AND ALL PROPOSED LINES ARE PART OF THE 2538 PRESSURE ZONE SYSTEM.
 - NO WALLS, FENCES, SHRUBS, UTILITY APPURTENANCES OR ANY OTHER OBJECT, OTHER THAN TRAFFIC CONTROL DEVICES, FIRE HYDRANTS, TREES AND STREET LIGHT POLES, MAY BE CONSTRUCTED OR INSTALLED WITHIN THE SIGHT VISIBILITY ZONE UNLESS SAID OBJECT IS MAINTAINED AT LESS THAN 24 INCHES IN HEIGHT, MEASURED FROM TOP OF CURB, OR WHERE NO CURB EXISTS, A HEIGHT OF 27 INCHES MEASURED FROM THE TOP OF ADJACENT ASPHALT, GRAVEL OR PAVEMENT STREET SURFACE. THIS RESTRICTION EXTENDS ALONG THE SIGHT VISIBILITY LINE THROUGH LANDSCAPED MEDIANS.
 - ELEVATION OF PROPOSED AND EXISTING GROUND LINES ARE NOT KNOWN. INSTALL ALL PIPELINE MARKERS SHALL IN TRENCH ABOVE EACH HORIZONTAL ELBOW FITTING, PER UDACS PLATE #15.
 - ANY EXCAVATION WORK SHALL BE KEPT OPEN FOR INSPECTION OF COPPER SERVICE LATERALS. ANY COPPER SERVICE LATERAL, KNICKED, BENT OR OTHERWISE DAMAGED MUST BE REPLACED FROM THE MAIN TO THE ANGLE METER STOP.
 - ALL WATER MAINS TO BE INSTALLED PER UDACS PLATE #17
 - PROTECT IN PLACE AND ADJUST LWWD EXISTING FACILITIES TO FINISHED GRADE. ALL LWWD FACILITIES SHALL BE ACCESSIBLE AT ALL TIMES.
 - THIS PROPERTY HAS A STATIC WATER PRESSURE IN EXCESS OF 80 PSI THE UNIFORM PLUMBING CODE REQUIRES THE INDIVIDUAL, ON SITE (PRIVATE), PRESSURE-REDUCING VALVES BE INSTALLED WHENEVER THE PRESSURE EXCEEDS 80 PSI. PRVs ARE THE DEVELOPERS RESPONSIBILITY, AND WILL NOT BE INSPECTED OR INCLUDED IN THE ACCEPTANCE OF LWWD FACILITIES.

- UTILITY NOTES**
- SEWER FACILITIES CONSTRUCTION SHALL BE IN ACCORDANCE WITH "DESIGN AND CONSTRUCTION STANDARDS FOR WASTEWATER COLLECTION SYSTEMS" LATEST EDITION, WHERE APPLICABLE.
 - ALL WATERLINE FACILITIES CONSTRUCTION SHALL BE IN ACCORDANCE WITH "UNIFORM DESIGN AND CONSTRUCTION STANDARDS FOR POTABLE WATER SYSTEMS" UDACS LATEST EDITION.
 - REPLACE ALL TRAFFIC CONTROL DEVICES (SIGNS OR PAVEMENT MARKINGS) UNDER CLARK COUNTY JURISDICTION THAT ARE DISTURBED, DESTROYED, MOVED OR MODIFIED BY TRENCHING ACTIVITY TO CLARK COUNTY SATISFACTION. ALL MATERIALS USED SHALL MEET CLARK COUNTY SPECIFICATIONS OR WILL BE AN APPROVED EQUIVALENT.
 - FOR ANY UTILITY CUTS, TRENCH BACKFILL PER COALS #503 THAT APPLIES (SEE NEW RTO SPEC).
 - DISPOSAL OF ASBESTOS CEMENT PIPE SHALL BE IN ACCORDANCE WITH ALL LOCAL, STATE, AND FEDERAL REGULATIONS.
 - ALL SEWER STORM DRAINS CROSSING WATER LINES MUST CONFORM TO SECTION 2.22 OF THE UNIFORM DESIGN AND CONSTRUCTION STANDARDS FOR POTABLE WATER SYSTEMS (UDACS) FOR WATER AND STORM MAIN CROSSINGS AND CLEARANCES.
 - ADJUST ALL WATER VALVE BOXES TO FINISHED GRADE PER UDACS PLATE NO. 38. VALVES SHALL BE ACCESSIBLE AT ALL TIMES.
 - ADJUST ALL MANHOLES TO FINISHED GRADE.
 - ADJUST ALL EXISTING UTILITY BOXES/VALVES TO FINISHED GRADE.
 - CONTRACTOR TO VERIFY ALL EXISTING UTILITIES CROSSING PROPOSED UTILITIES PRIOR TO CONSTRUCTION.
 - ENTIRE PROJECT SITE AND ALL PROPOSED LINES ARE PART OF THE 2538 PRESSURE ZONE SYSTEM.
 - NO WALLS, FENCES, SHRUBS, UTILITY APPURTENANCES OR ANY OTHER OBJECT, OTHER THAN TRAFFIC CONTROL DEVICES, FIRE HYDRANTS, TREES AND STREET LIGHT POLES, MAY BE CONSTRUCTED OR INSTALLED WITHIN THE SIGHT VISIBILITY ZONE UNLESS SAID OBJECT IS MAINTAINED AT LESS THAN 24 INCHES IN HEIGHT, MEASURED FROM TOP OF CURB, OR WHERE NO CURB EXISTS, A HEIGHT OF 27 INCHES MEASURED FROM THE TOP OF ADJACENT ASPHALT, GRAVEL OR PAVEMENT STREET SURFACE. THIS RESTRICTION EXTENDS ALONG THE SIGHT VISIBILITY LINE THROUGH LANDSCAPED MEDIANS.
 - ELEVATION OF PROPOSED AND EXISTING GROUND LINES ARE NOT KNOWN. INSTALL ALL PIPELINE MARKERS SHALL IN TRENCH ABOVE EACH HORIZONTAL ELBOW FITTING, PER UDACS PLATE #15.
 - ANY EXCAVATION WORK SHALL BE KEPT OPEN FOR INSPECTION OF COPPER SERVICE LATERALS. ANY COPPER SERVICE LATERAL, KNICKED, BENT OR OTHERWISE DAMAGED MUST BE REPLACED FROM THE MAIN TO THE ANGLE METER STOP.
 - ALL WATER MAINS TO BE INSTALLED PER UDACS PLATE #17
 - PROTECT IN PLACE AND ADJUST LWWD EXISTING FACILITIES TO FINISHED GRADE. ALL LWWD FACILITIES SHALL BE ACCESSIBLE AT ALL TIMES.
 - THIS PROPERTY HAS A STATIC WATER PRESSURE IN EXCESS OF 80 PSI THE UNIFORM PLUMBING CODE REQUIRES THE INDIVIDUAL, ON SITE (PRIVATE), PRESSURE-REDUCING VALVES BE INSTALLED WHENEVER THE PRESSURE EXCEEDS 80 PSI. PRVs ARE THE DEVELOPERS RESPONSIBILITY, AND WILL NOT BE INSPECTED OR INCLUDED IN THE ACCEPTANCE OF LWWD FACILITIES.

- UTILITY NOTES**
- SEWER FACILITIES CONSTRUCTION SHALL BE IN ACCORDANCE WITH "DESIGN AND CONSTRUCTION STANDARDS FOR WASTEWATER COLLECTION SYSTEMS" LATEST EDITION, WHERE APPLICABLE.
 - ALL WATERLINE FACILITIES CONSTRUCTION SHALL BE IN ACCORDANCE WITH "UNIFORM DESIGN AND CONSTRUCTION STANDARDS FOR POTABLE WATER SYSTEMS" UDACS LATEST EDITION.
 - REPLACE ALL TRAFFIC CONTROL DEVICES (SIGNS OR PAVEMENT MARKINGS) UNDER CLARK COUNTY JURISDICTION THAT ARE DISTURBED, DESTROYED, MOVED OR MODIFIED BY TRENCHING ACTIVITY TO CLARK COUNTY SATISFACTION. ALL MATERIALS USED SHALL MEET CLARK COUNTY SPECIFICATIONS OR WILL BE AN APPROVED EQUIVALENT.
 - FOR ANY UTILITY CUTS, TRENCH BACKFILL PER COALS #503 THAT APPLIES (SEE NEW RTO SPEC).
 - DISPOSAL OF ASBESTOS CEMENT PIPE SHALL BE IN ACCORDANCE WITH ALL LOCAL, STATE, AND FEDERAL REGULATIONS.
 - ALL SEWER STORM DRAINS CROSSING WATER LINES MUST CONFORM TO SECTION 2.22 OF THE UNIFORM DESIGN AND CONSTRUCTION STANDARDS FOR POTABLE WATER SYSTEMS (UDACS) FOR WATER AND STORM MAIN CROSSINGS AND CLEARANCES.
 - ADJUST ALL WATER VALVE BOXES TO FINISHED GRADE PER UDACS PLATE NO. 38. VALVES SHALL BE ACCESSIBLE AT ALL TIMES.
 - ADJUST ALL MANHOLES TO FINISHED GRADE.
 - ADJUST ALL EXISTING UTILITY BOXES/VALVES TO FINISHED GRADE.
 - CONTRACTOR TO VERIFY ALL EXISTING UTILITIES CROSSING PROPOSED UTILITIES PRIOR TO CONSTRUCTION.
 - ENTIRE PROJECT SITE AND ALL PROPOSED LINES ARE PART OF THE 2538 PRESSURE ZONE SYSTEM.
 - NO WALLS, FENCES, SHRUBS, UTILITY APPURTENANCES OR ANY OTHER OBJECT, OTHER THAN TRAFFIC CONTROL DEVICES, FIRE HYDRANTS, TREES AND STREET LIGHT POLES, MAY BE CONSTRUCTED OR INSTALLED WITHIN THE SIGHT VISIBILITY ZONE UNLESS SAID OBJECT IS MAINTAINED AT LESS THAN 24 INCHES IN HEIGHT, MEASURED FROM TOP OF CURB, OR WHERE NO CURB EXISTS, A HEIGHT OF 27 INCHES MEASURED FROM THE TOP OF ADJACENT ASPHALT, GRAVEL OR PAVEMENT STREET SURFACE. THIS RESTRICTION EXTENDS ALONG THE SIGHT VISIBILITY LINE THROUGH LANDSCAPED MEDIANS.
 - ELEVATION OF PROPOSED AND EXISTING GROUND LINES ARE NOT KNOWN. INSTALL ALL PIPELINE MARKERS SHALL IN TRENCH ABOVE EACH HORIZONTAL ELBOW FITTING, PER UDACS PLATE #15.
 - ANY EXCAVATION WORK SHALL BE KEPT OPEN FOR INSPECTION OF COPPER SERVICE LATERALS. ANY COPPER SERVICE LATERAL, KNICKED, BENT OR OTHERWISE DAMAGED MUST BE REPLACED FROM THE MAIN TO THE ANGLE METER STOP.
 - ALL WATER MAINS TO BE INSTALLED PER UDACS PLATE #17
 - PROTECT IN PLACE AND ADJUST LWWD EXISTING FACILITIES TO FINISHED GRADE. ALL LWWD FACILITIES SHALL BE ACCESSIBLE AT ALL TIMES.
 - THIS PROPERTY HAS A STATIC WATER PRESSURE IN EXCESS OF 80 PSI THE UNIFORM PLUMBING CODE REQUIRES THE INDIVIDUAL, ON SITE (PRIVATE), PRESSURE-REDUCING VALVES BE INSTALLED WHENEVER THE PRESSURE EXCEEDS 80 PSI. PRVs ARE THE DEVELOPERS RESPONSIBILITY, AND WILL NOT BE INSPECTED OR INCLUDED IN THE ACCEPTANCE OF LWWD FACILITIES.

- UTILITY NOTES**
- SEWER FACILITIES CONSTRUCTION SHALL BE IN ACCORDANCE WITH "DESIGN AND CONSTRUCTION STANDARDS FOR WASTEWATER COLLECTION SYSTEMS" LATEST EDITION, WHERE APPLICABLE.
 - ALL WATERLINE FACILITIES CONSTRUCTION SHALL BE IN ACCORDANCE WITH "UNIFORM DESIGN AND CONSTRUCTION STANDARDS FOR POTABLE WATER SYSTEMS" UDACS LATEST EDITION.
 - REPLACE ALL TRAFFIC CONTROL DEVICES (SIGNS OR PAVEMENT MARKINGS) UNDER CLARK COUNTY JURISDICTION THAT ARE DISTURBED, DESTROYED, MOVED OR MODIFIED BY TRENCHING ACTIVITY TO CLARK COUNTY SATISFACTION. ALL MATERIALS USED SHALL MEET CLARK COUNTY SPECIFICATIONS OR WILL BE AN APPROVED EQUIVALENT.
 - FOR ANY UTILITY CUTS, TRENCH BACKFILL PER COALS #503 THAT APPLIES (SEE NEW RTO SPEC).
 - DISPOSAL OF ASBESTOS CEMENT PIPE SHALL BE IN ACCORDANCE WITH ALL LOCAL, STATE, AND FEDERAL REGULATIONS.
 - ALL SEWER STORM DRAINS CROSSING WATER LINES MUST CONFORM TO SECTION 2.22 OF THE UNIFORM DESIGN AND CONSTRUCTION STANDARDS FOR POTABLE WATER SYSTEMS (UDACS) FOR WATER AND STORM MAIN CROSSINGS AND CLEARANCES.
 - ADJUST ALL WATER VALVE BOXES TO FINISHED GRADE PER UDACS PLATE NO. 38. VALVES SHALL BE ACCESSIBLE AT ALL TIMES.
 - ADJUST ALL MANHOLES TO FINISHED GRADE.
 - ADJUST ALL EXISTING UTILITY BOXES/VALVES TO FINISHED GRADE.
 - CONTRACTOR TO VERIFY ALL EXISTING UTILITIES CROSSING PROPOSED UTILITIES PRIOR TO CONSTRUCTION.
 - ENTIRE PROJECT SITE AND ALL PROPOSED LINES ARE PART OF THE 2538 PRESSURE ZONE SYSTEM.
 - NO WALLS, FENCES, SHRUBS, UTILITY APPURTENANCES OR ANY OTHER OBJECT, OTHER THAN TRAFFIC CONTROL DEVICES, FIRE HYDRANTS, TREES AND STREET LIGHT POLES, MAY BE CONSTRUCTED OR INSTALLED WITHIN THE SIGHT VISIBILITY ZONE UNLESS SAID OBJECT IS MAINTAINED AT LESS THAN 24 INCHES IN HEIGHT, MEASURED FROM TOP OF CURB, OR WHERE NO CURB EXISTS, A HEIGHT OF 27 INCHES MEASURED FROM THE TOP OF ADJACENT ASPHALT, GRAVEL OR PAVEMENT STREET SURFACE. THIS RESTRICTION EXTENDS ALONG THE SIGHT VISIBILITY LINE THROUGH LANDSCAPED MEDIANS.
 - ELEVATION OF PROPOSED AND EXISTING GROUND LINES ARE NOT KNOWN. INSTALL ALL PIPELINE MARKERS SHALL IN TRENCH ABOVE EACH HORIZONTAL ELBOW FITTING, PER UDACS PLATE #15.
 - ANY EXCAVATION WORK SHALL BE KEPT OPEN FOR INSPECTION OF COPPER SERVICE LATERALS. ANY COPPER SERVICE LATERAL, KNICKED, BENT OR OTHERWISE DAMAGED MUST BE REPLACED FROM THE MAIN TO THE ANGLE METER STOP.
 - ALL WATER MAINS TO BE INSTALLED PER UDACS PLATE #17
 - PROTECT IN PLACE AND ADJUST LWWD EXISTING FACILITIES TO FINISHED GRADE. ALL LWWD FACILITIES SHALL BE ACCESSIBLE AT ALL TIMES.
 - THIS PROPERTY HAS A STATIC WATER PRESSURE IN EXCESS OF 80 PSI THE UNIFORM PLUMBING CODE REQUIRES THE INDIVIDUAL, ON SITE (PRIVATE), PRESSURE-REDUCING VALVES BE INSTALLED WHENEVER THE PRESSURE EXCEEDS 80 PSI. PRVs ARE THE DEVELOPERS RESPONSIBILITY, AND WILL NOT BE INSPECTED OR INCLUDED IN THE ACCEPTANCE OF LWWD FACILITIES.

- UTILITY NOTES**
- SEWER FACILITIES CONSTRUCTION SHALL BE IN ACCORDANCE WITH "DESIGN AND CONSTRUCTION STANDARDS FOR WASTEWATER COLLECTION SYSTEMS" LATEST EDITION, WHERE APPLICABLE.
 - ALL WATERLINE FACILITIES CONSTRUCTION SHALL BE IN ACCORDANCE WITH "UNIFORM DESIGN AND CONSTRUCTION STANDARDS FOR POTABLE WATER SYSTEMS" UDACS LATEST EDITION.
 - REPLACE ALL TRAFFIC CONTROL DEVICES (SIGNS OR PAVEMENT MARKINGS) UNDER CLARK COUNTY JURISDICTION THAT ARE DISTURBED, DESTROYED, MOVED OR MODIFIED BY TRENCHING ACTIVITY TO CLARK COUNTY SATISFACTION. ALL MATERIALS USED SHALL MEET CLARK COUNTY SPECIFICATIONS OR WILL BE AN APPROVED EQUIVALENT.
 - FOR ANY UTILITY CUTS, TRENCH BACKFILL PER COALS #503 THAT APPLIES (SEE NEW RTO SPEC).
 - DISPOSAL OF ASBESTOS CEMENT PIPE SHALL BE IN ACCORDANCE WITH ALL LOCAL, STATE, AND FEDERAL REGULATIONS.
 - ALL SEWER STORM DRAINS CROSSING WATER LINES MUST CONFORM TO SECTION 2.22 OF THE UNIFORM DESIGN AND CONSTRUCTION STANDARDS FOR POTABLE WATER SYSTEMS (UDACS) FOR WATER AND STORM MAIN CROSSINGS AND CLEARANCES.
 - ADJUST ALL WATER VALVE BOXES TO FINISHED GRADE PER UDACS PLATE NO. 38. VALVES SHALL BE ACCESSIBLE AT ALL TIMES.
 - ADJUST ALL MANHOLES TO FINISHED GRADE.
 - ADJUST ALL EXISTING UTILITY BOXES/VALVES TO FINISHED GRADE.
 - CONTRACTOR TO VERIFY ALL EXISTING UTILITIES CROSSING PROPOSED UTILITIES PRIOR TO CONSTRUCTION.
 - ENTIRE PROJECT SITE AND ALL PROPOSED LINES ARE PART OF THE 2538 PRESSURE ZONE SYSTEM.
 - NO WALLS, FENCES, SHRUBS, UTILITY APPURTENANCES OR ANY OTHER OBJECT, OTHER THAN TRAFFIC CONTROL DEVICES, FIRE HYDRANTS, TREES AND STREET LIGHT POLES, MAY BE CONSTRUCTED OR INSTALLED WITHIN THE SIGHT VISIBILITY ZONE UNLESS SAID OBJECT IS MAINTAINED AT LESS THAN 24 INCHES IN HEIGHT, MEASURED FROM TOP OF CURB, OR WHERE NO CURB EXISTS, A HEIGHT OF 27 INCHES MEASURED FROM THE TOP OF ADJACENT ASPHALT, GRAVEL OR PAVEMENT STREET SURFACE. THIS RESTRICTION EXTENDS ALONG THE SIGHT VISIBILITY LINE THROUGH LANDSCAPED MEDIANS.
 - ELEVATION OF PROPOSED AND EXISTING GROUND LINES ARE NOT KNOWN. INSTALL ALL PIPELINE MARKERS SHALL IN TRENCH ABOVE EACH HORIZONTAL ELBOW FITTING, PER UDACS PLATE #15.
 - ANY EXCAVATION WORK SHALL BE KEPT OPEN FOR INSPECTION OF COPPER SERVICE LATERALS. ANY COPPER SERVICE LATERAL, KNICKED, BENT OR OTHERWISE DAMAGED MUST BE REPLACED FROM THE MAIN TO THE ANGLE METER STOP.
 - ALL WATER MAINS TO BE INSTALLED PER UDACS PLATE #17
 - PROTECT IN PLACE AND ADJUST LWWD EXISTING FACILITIES TO FINISHED GRADE. ALL LWWD FACILITIES SHALL BE ACCESSIBLE AT ALL TIMES.
 - THIS PROPERTY HAS A STATIC WATER PRESSURE IN EXCESS OF 80 PSI THE UNIFORM PLUMBING CODE REQUIRES THE INDIVIDUAL, ON SITE (PRIVATE), PRESSURE-REDUCING VALVES BE INSTALLED WHENEVER THE PRESSURE EXCEEDS 80 PSI. PRVs ARE THE DEVELOPERS RESPONSIBILITY, AND WILL NOT BE INSPECTED OR INCLUDED IN THE ACCEPTANCE OF LWWD FACILITIES.

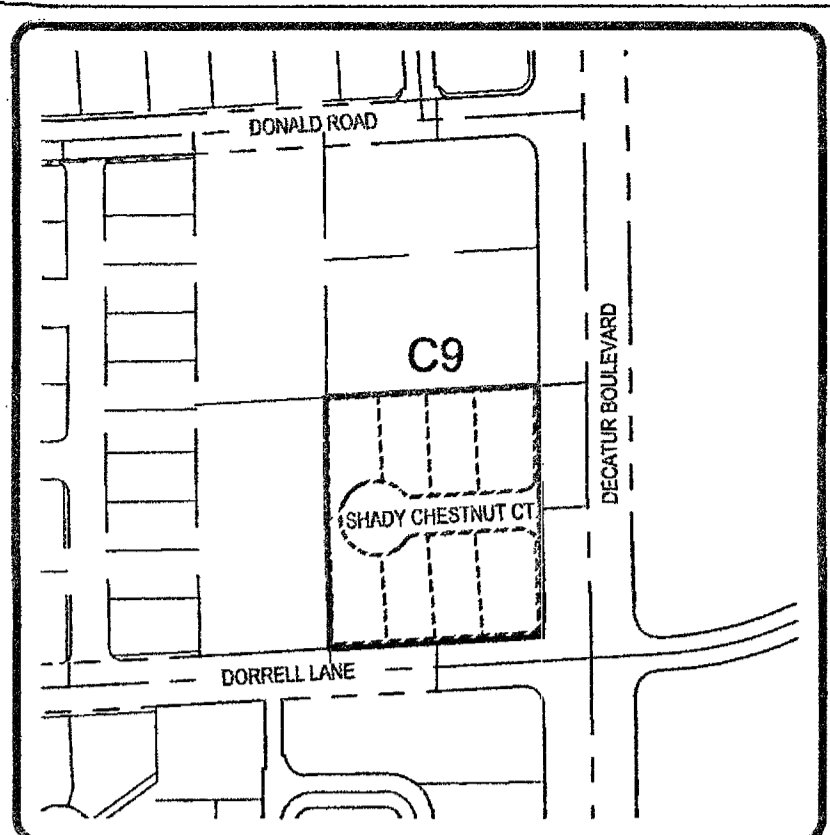

- UTILITY LEGEND**
- EXISTING RIGHT-OF-WAY/PROPERTY LINE
 - PROPOSED RIGHT-OF-WAY/PROPERTY LINE
 - EX. WATER LINE
 - EXISTING WATER LINE (SIZE PER PLAN)
 - EX. SEWER LINE
 - EXISTING SEWER LINE (SIZE PER PLAN)
 - EX. SD
 - EXISTING STORM DRAIN LINE (SIZE PER PLAN)
 - PROPOSED WATER LINE (SIZE PER PLAN)
 - PROPOSED SANITARY SEWER LINE (SIZE PER PLAN)
 - PROPOSED FIRE HYDRANT
 - PROPOSED WATER VALVE
 - PROPOSED WATER METER
 - PROPOSED REDUCER (SIZE PER PLAN)
 - EXISTING WATER MANHOLE
 - EXISTING SEWER MANHOLE
 - EXISTING STORM DRAIN MANHOLE
 - PROPOSED SEWER MANHOLE
 - PROPOSED SEWER LATERAL

GRADING NOTE
 MINIMUM 2" OF COVER PER UDACS 2.08.04. GRADING MUST BE COMPLETED PRIOR TO WATER LINE INSTALLATION.

FOR ALL DRY UTILITY CROSSINGS

- MAINTAIN MINIMUM 12" VERTICAL SEPARATION AT ALL POINTS OF CROSSINGS
- MAINTAIN MINIMUM 3" PARALLEL SEPARATION

THE DISTRICT CANNOT GUARANTEE A WATERTIGHT SHUTDOWN WHERE CONNECTIONS OR REPAIRS TO EXISTING FACILITIES ARE REQUIRED. THE CONTRACTOR SHALL ENSURE ALL LABOR AND EQUIPMENT IS AVAILABLE TO REMOVE FUGITIVE WATER THAT MAY INFEDE CONSTRUCTION AT ALL TIMES. COORDINATION WITH INSPECTION DIVISION MUST TAKE PLACE PRIOR TO ANY TRIAL SHUTDOWN.

CONTRACTOR TO INSTALL TEMPORARY SERVICE TO ENSURE PROPER SHUTDOWN IN THE EVENT NO OTHER APPURTENANCES ARE AVAILABLE.

BENCHMARK
 CITY OF LAS VEGAS BENCHMARK STATION: 51920.000EES

RIVET AND PLATE IN THE TOP OF CURB AT THE SOUTH-WEST CORNER OF DECATUR BOULEVARD AND DORRELL LANE.

ELEVATION = 702.412 METERS (NAV98 2008 ADJUSTMENT)
 ELEVATION = 2304.51 US SURVEY FEET (NAV98 2008 ADJUSTMENT)

BASIS OF BEARING
 NORTH 00°47'00" WEST, BEING THE BEARING OF EAST LINE OF THE NORTHEAST QUARTER (NE 1/4) OF THE NORTHEAST QUARTER (NE 1/4) OF SECTION 24, TOWNSHIP 19 SOUTH, RANGE 60 EAST, 10M. CITY OF LAS VEGAS, CLARK COUNTY, NEVADA, AS RECORDED IN FILE 108 OF SURVEYS AT PAGE 81, OFFICIAL RECORDS OF CLARK COUNTY, NEVADA.

SEWER CONTRIBUTION

FACILITY TYPE: RESIDENTIAL

TOTAL RESIDENTIAL LOTS AT BUILD OUT: 8 UNITS

8 UNITS x 250 GPD/UNIT 1,000,000 = 0.0020 MGD (AVERAGE)

0.0020 x 3.5 = 0.0070 MGD (PEAK)

0.0070 x 1.25 = 0.0088 MGD (WET PEAK)

WATER METER NOTE

8 RESIDENTIAL LOTS - WATER METERS ARE TO BE 3/4"

2 COMMON LOTS - IRRIGATION - WATER METER TO BE 3/4"

WATER MAIN JOINT DEFLECTION (PVC, 4" - 24")

PVC PIPE SHALL BE DEFLECTED AT THE JOINT ONLY. THE MAXIMUM ALLOWABLE DEFLECTION SHALL BE ONE (1) DEGREE PER JOINT WITH A MINIMUM RADIUS OF CURVATURE OF 1,150 FEET, PER UDACS 2.07.01 AND 2.07.02

FOR CHANGED IN DIRECTION EXCEEDING THE MAXIMUM ALLOWABLE JOINT DEFLECTION FITTINGS SHALL BE USED.

APPROVAL

THE DISTRICT CANNOT GUARANTEE A WATERTIGHT SHUTDOWN WHERE CONNECTIONS OR REPAIRS TO EXISTING FACILITIES ARE REQUIRED. THE CONTRACTOR SHALL ENSURE ALL LABOR AND EQUIPMENT IS AVAILABLE TO REMOVE FUGITIVE WATER THAT MAY INFEDE CONSTRUCTION AT ALL TIMES. COORDINATION WITH INSPECTION DIVISION MUST TAKE PLACE PRIOR TO ANY TRIAL SHUTDOWN.

CONTRACTOR TO INSTALL TEMPORARY SERVICE TO ENSURE PROPER SHUTDOWN IN THE EVENT NO OTHER APPURTENANCES ARE AVAILABLE.

DATE: 7/20/18

DESIGNED: RWF

CHECKED: ALW/DCL

PROJECT #: B2R011803

SHEET TITLE: UTILITY

SHEET NUMBER: C9

M.H. ELEV.

#1	C-7	F.L.	R.I.M.
#2	C-7	F.L.	R.I.M.

SANITARY SEWER MANHOLE TABLE

M#	COORDINATES	STATION/OFFSET	RIM ELEV.	INVERTS (IN/OUT)
SSMH 1	N: 11548.4711 E: 9929.0057	STA: 31+80.10 OFF: 60.09' LT.	RIM: 2304.86 INV: 2289.23 (N&S)	INV: 2289.40 (W)
SSMH 2	N: 11533.7158 E: 9997.0177	STA: 3+82.22 OFF: 5.00' RT.	RIM: 2307.61 INV: 2298.37 (S)	

CAST-IN-PLACE SEWER MANHOLE BASE

CAST-IN-PLACE MANHOLE BASE REQUIRED TO CURE FOR A MINIMUM OF 7 DAYS BEFORE MANHOLE COMPONENTS CAN BE SET.

REDUCED PRESSURE PRINCIPLE ASSEMBLY

(1) (IRRIGATION)

APPROVED REDUCED PRESSURE PRINCIPLE ASSEMBLY(S) SHALL BE INSTALLED PER THE UDACS PLATE #8. NO WATER SHALL BE TAKEN FROM A SERVICE REQUIRING BACKFLOW PREVENTION UNTIL THE REDUCED PRESSURE PRINCIPLE ASSEMBLY HAS BEEN SUCCESSFULLY TESTED BY THE LWWD.

ANY BLOCK WALL OR OTHER FENCE MATERIAL SHALL BE DESIGNED AND CONSTRUCTED AROUND THE OUTSIDE OF THE EASEMENT(S) TO ALLOW THE DISTRICT DIRECT ACCESS FROM THE ADJACENT RIGHT OF WAY.

EASEMENTS SHALL BE CLEARLY MARKED OR STAKED PRIOR TO THE START OF CONSTRUCTION.

PRIVATE STREET NOTE

ALL PRIVATE STREETS ARE P.U.E. PUBLIC SEWER EASEMENTS, AND PUBLIC DRAINAGE EASEMENTS TO BE PRIVATELY MAINTAINED BY THE HOA.

CONTROLLED LOW STRENGTH MATERIAL (CLSM)

PROTECT WATERLINES IN PLACE. WHEREVER A WATERLINE IS ABOVE STORM DRAIN OR SEWER WHERE COMPACTOR REQUIREMENTS UNDER A WATERLINE CANNOT BE MET, BACKFILL TRENCH WITH CLASS II CONTROLLED LOW STRENGTH MATERIAL (CLSM) TO THE SPRINGLINE OF THE WATERLINE. THIS REQUIREMENT IS FOR STRUCTURAL SUPPORT ONLY. ADDITIONAL HEALTH REGULATIONS MAY APPLY PER UDACS 2.22.

FIRE FLOW CALCULATION

COVERS LOT:	1-2
USE/OCCUPANCY:	R-3
TYPE OF CONSTRUCTION:	V-B
FIRE FLOW:	1750 GPM @ 20 PSI RESIDUAL
AUTOMATIC FIRE SPRINKLERS:	NO
NFPA 15:	NO
ANTICIPATED FIRE SPRINKLER FLOW DEMAND:	0 GPM
HOMES ABOVE 4,800 S.F. REQUIRES NFPA 150 SYSTEM IF FIRE FLOW AVAILABILITY INSUFFICIENT.	
AUTOMATIC FIRE SPRINKLER SYSTEM (NFPA15):	NO
SQUARE FOOTAGE:	NO
HOMES ABOVE 4800 SF REQUIRE NFPA 150 SYSTEM:	NO
BUILDING HEIGHT:	NO
# OF STORIES INCLUDING BASEMENT:	NO
HIGH PILED COMBUSTIBLE STORAGE:	NO
# OF HYDRANTS INSTALLED:	2

APPROVED FOR CONSTRUCTION

LAS VEGAS VALLEY WATER DISTRICT ENGINEERING SERVICES

PROJECT NO. 135002 FIRST APPROVED DATE: 10/16/18

LWWD APPROVED FIRE FLOW 1750 GPM AT 20 PSI RESIDUAL
 MAXIMUM AVAILABLE FLOW: FIRE SPRINKLER FLOW 0 GPM

SHEETS: C1, C2, C4 THRU C9

Call before you Dig
 Avoid hitting overhead power lines. It's costly.

Call before you Dig
 Avoid hitting overhead power lines. It's costly.

Call before you Dig
 Avoid hitting overhead power lines. It's costly.

Underground
 1-702-432-5300

OR

1-800-227-2600

1-702-227-2929

ACTUS
 3203 E. Warm Springs Rd., Suite 400
 Las Vegas, NV 89120
 www.actus-nv.com
 (702) 986-9286
 Engineering - Surveying - Consulting - Planning

UTILITY PLAN

DECATUR DONALD II

BEAZER HOMES

CITY OF LAS VEGAS, NEVADA

DATE: 07/19/2018

DRAWN: RWF

CHECKED: ALW/DCL

PROJECT #: B2R011803

SHEET TITLE: UTILITY

SHEET NUMBER: C9

L18-00903
 107Y5067-2

PROJ: 135002-A QS: 25-24-NE
 SHT: 9 OF 10