

LEGEND

1	INSTALL B-36 PULL BOX (24"X36"X24")
2	EXISTING B-36 PULL BOX (24"X36"X24")
3	INSTALL B-50 PULL BOX (13"X24"X24")
4	EXISTING B-50 PULL BOX (13"X24"X24")
5	INSTALL B-100 PULL BOX (24"X36"X24")
6	EXISTING B-100 PULL BOX (24"X36"X24")
7	INSTALL T-200 CATV VAULT (30"X48"X36")
8	EXISTING T-200 CATV VAULT (30"X48"X36")
9	INSTALL T-400 CATV VAULT (36"X60"X36")
10	EXISTING T-400 CATV VAULT (36"X60"X36")
11	INSTALL T-600 CATV VAULT (48"X72"X36")
12	EXISTING T-600 CATV VAULT (48"X72"X36")
13	INSTALL NEW CATV PEDESTAL
14	EXISTING CATV PEDESTAL
15	R&R S/W SLAB(S)
16	POTHOLE
17	SIDEWALK/DIRT TRENCH INSTALL WITH FIBER/COAX PULL
18	ASPHALT MITIGATION/STREET TRENCH WITH FIBER/COAX PULL
19	PROPOSED BORE WITH FIBER/COAX PULL
20	EXISTING CATV CONDUIT(S)
21	OHC PROPOSED OVERHEAD FIBER OPTIC CABLE OR COAX INSTALL
22	XOHC EXISTING OVERHEAD FIBER OPTIC CABLE OR COAX
23	U.G. FIBER/COAX PULL THROUGH EXISTING CONDUIT
24	RIGHT OF WAY LINE
25	LOT/PROPERTY LINE
26	EDGE OF PAVEMENT/SIDEWALK/CONCRETE
27	P EXISTING NVE PULL BOX
28	T EXISTING TELCO PULL BOX
29	TM EXISTING COMMUNICATION MANHOLE
30	T EXISTING TELCO POLE
31	EXISTING NVE POLE
32	NVE EXISTING NVE TRANSMISSION POLE
33	EXISTING JOINT POLE
34	EXISTING JOINT POLE WITH TRANSFORMER
35	POLE ANCHOR
36	EXISTING NVE TRANSFORMER TRANSFORMER PAD
37	TS SNWA TEST STATION
38	COX POWER SUPPLY (49"X24"X52")
39	CB CABINET (RHINO,ODN,OLM)
40	RISER POLE/QUADRANT DETAIL RISER OWNERSHIP NOTED
41	RAILROAD
42	MH EXISTING MANHOLE (SS),(SD)...ECT
43	1in CONDUIT LATERAL
44	STORMWATER ASSETS
45	

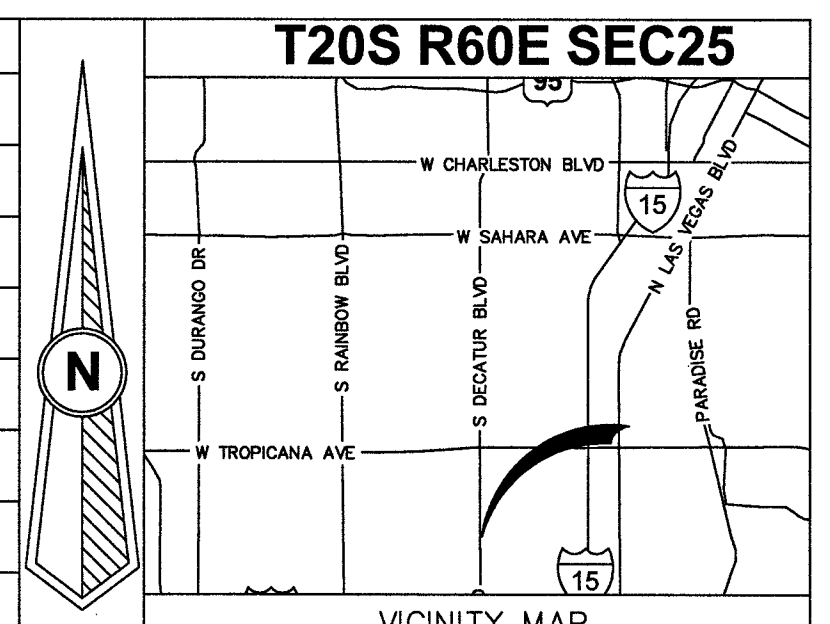

REVISIONS

REV	DESCRIPTION	DATE	BY
1	ENTIRE ROUTE CHANGED FROM AERIAL TO UNDERGROUND	10-10-19	MM
2	CHANGE BORE TO 2-3" CONDUIT	1-31-20	MM

ALL CONSTRUCTION AND MATERIALS SHALL BE IN ACCORDANCE WITH THE "UNIFORM STANDARD SPECIFICATIONS FOR PUBLIC WORKS CONSTRUCTION OFF-SITE IMPROVEMENTS, CLARK COUNTY AREA NEVADA" LATEST ISSUE; THE "UNIFORM STANDARD DRAWINGS FOR PUBLIC WORKS CONSTRUCTION, CLARK COUNTY AREA NEVADA", LATEST ISSUE; AND OTHER APPLICABLE APPROVED STANDARDS ISSUED BY THE CONTROLLING AGENCY; ALL LOCAL CITY CODES AND ORDINANCES APPLICABLE.

APPROVED FOR CONSTRUCTION
 THIS APPROVAL IS FOR WORK IN CLV RW OR CLV EASEMENT ONLY. OBTAINING PERMISSION OR EASEMENT FOR WORK SHOWN IN PRIVATE PROPERTY IS THE RESPONSIBILITY OF THE UTILITY.

APPROVAL: *Deann Butts* DATE: 2/23/20

PERMIT #	149601-OB1-REV2
DRAWN BY:	MM
DATE:	1/31/2020
SCALE:	1:30
NODE:	149601
PROJECT #:	405201900000149601
TECH #:	N/A
APPROVED BY:	YON HARRIS

COX
 BRINGING US CLOSER
 1700 VEGAS DRIVE
 LAS VEGAS, NEVADA 89106
 PHONE: (702) 545-2606
 FAX: (702) 545-2606

CITY OF LAS VEGAS
 333 N. RANCHO DRIVE
 LAS VEGAS, NEVADA 89106
 (702) 229-6885

PROJECT LOCATION:
 DECATUR BLVD & WASHINGTON AVE

SUB-CONTRACTOR:
 CLOVER CABLE

ENTITY NOTES:
 24 HOUR/EMERGENCY # FOR CLOVER CABLE: 702-210-7244

SHEET No: **1**

Sheet 1 of 1

DISCLAIMER NOTE

UTILITY LOCATIONS SHOWN HEREON ARE APPROXIMATE ONLY. IT SHALL BE THE CONTRACTOR'S RESPONSIBILITY TO DETERMINE THE EXACT HORIZONTAL AND VERTICAL LOCATION OF ALL EXISTING UNDERGROUND AND OVERHEAD UTILITIES PRIOR TO COMMENCING CONSTRUCTION. NO REPRESENTATION IS MADE THAT ALL EXISTING UTILITIES ARE SHOWN HEREON. THE ENGINEER ASSUMES NO RESPONSIBILITY FOR UTILITIES NOT SHOWN OR UTILITIES NOT SHOWN IN THEIR PROPER LOCATIONS.

BEFORE YOU DIG
 OR 1-800-227-2600
 UNDERGROUND SERVICE USA

BEFORE YOU OVERHEAD
 1-702-227-2929
 NEVADA POWER ENVIRONMENT AND SAFETY SERVICE DEPARTMENT

COX
 1-702-455-7911
 CLARK COUNTY TRAFFIC OPERATIONS AND
 1-702-452-5300
 LAS VEGAS AREA COMPUTERIZED SYSTEM

BEFORE YOU DIG
 OR 1-800-227-2600
 UNDERGROUND SERVICE USA

BEFORE YOU OVERHEAD
 1-702-227-2929
 NEVADA POWER ENVIRONMENT AND SAFETY SERVICE DEPARTMENT

TOTAL BORE 493'
 TOTAL DIRT TRENCH 5'
 TOTAL ASPHALT TRENCH 0'
 TOTAL TRENCH 5'
SIDEWALK REMOVAL/REPAIR
 TOTAL S/W PANELS 16
 TOTAL LINEAR FOOTAGE 80'

L19-00943-R002 0 2/04/2020