

LEGEND

- 1 ■ INSTALL B-36 PULL BOX (24"X36"X24")
- 2 ▨ EXISTING B-36 PULL BOX (24"X36"X24")
- 3 □ INSTALL B-50 PULL BOX (13"X24"X24")
- 4 ▨ EXISTING B-50 PULL BOX (13"X24"X24")
- 5 ■ INSTALL B-100 PULL BOX (24"X36"X24")
- 6 ▨ EXISTING B-100 PULL BOX (24"X36"X24")
- 7 ■ INSTALL T-200 CATV VAULT (30"X48"X36")
- 8 ▨ EXISTING T-200 CATV VAULT (30"X48"X36")
- 9 ■ INSTALL T-400 CATV VAULT (36"X60"X36")
- 10 ▨ EXISTING T-400 CATV VAULT (36"X60"X36")
- 11 ■ INSTALL T-600 CATV VAULT (48"X72"X36")
- 12 ▨ EXISTING T-600 CATV VAULT (48"X72"X36")
- 13 ▲ INSTALL NEW CATV PEDESTAL
- 14 ▽ EXISTING NEW CATV PEDESTAL
- 15 □ R&R S/W SLAB(S)
- 16 ○ POTHOLE
- 17 -c-c-c- SIDEWALK/DIRT TRENCH INSTALL WITH FIBER/COAX PULL
- 18 -c-c-c- ASPHALT MITIGATION/STREET TRENCH WITH FIBER/COAX PULL
- 19 -b-b- PROPOSED BORE WITH FIBER/COAX PULL
- 20 -x-x- EXISTING CATV CONDUIT(S)
- 21 -ohc- PROPOSED OVERHEAD FIBER OPTIC CABLE OR COAX INSTALL
- 22 -xohc- EXISTING OVERHEAD FIBER OPTIC CABLE OR COAX
- 23 - - - U.G. FIBER/COAX PULL
- 24 - - - RIGHT OF WAY LINE
- 25 - - - LOT/PROPERTY LINE
- 26 - - - EDGE OF PAVEMENT
- 27 [P] EXISTING NVE PULL BOX
- 28 [T] EXISTING TELCO PULL BOX
- 29 [TM] EXISTING TELCO MANHOLE
- 30 [T] EXISTING TELCO POLE
- 31 [●] EXISTING NVE POLE
- 32 [NVE] EXISTING NVE TRANSMISSION POLE
- 33 [X] EXISTING JOINT POLE
- 34 [X] EXISTING JOINT POLE WITH TRANSFORMER
- 35 [A] POLE ANCHOR
- 36 [T] EXISTING NVE TRANSFORMER TRANSFORMER PAD
- 37 [TS] SNWA TEST STATION
- 38 [S] COX POWER SUPPLY (49"X24"X52")
- 39 [RC] INSTALL RHINO CABINET
- 40 [R] RISER POLE/QUADRANT DETAIL RISER OWNERSHIP NOTED
- 41 [||||] RAILROAD
- 42 [MT] EXISTING MANHOLE (SS),(SD)...ECT
- 43 [---] 1in CONDUIT LATERAL
- 44 [||||] STORMWATER ASSETS
- 45 []

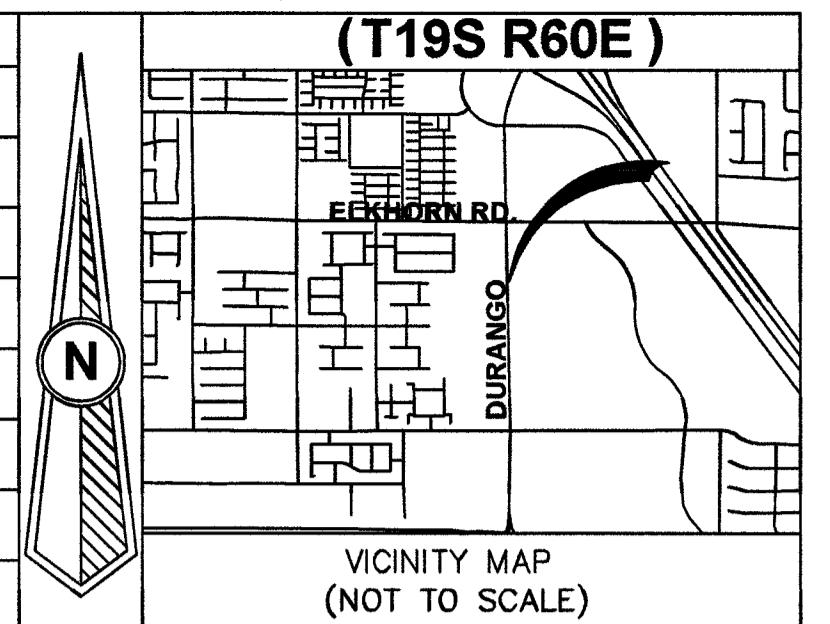

REVISIONS

REV	DESCRIPTION	DATE	BY
1	BORE TO TRENCH	4/24	WTB
	PK 6 5 19		

ALL CONSTRUCTION AND MATERIALS SHALL BE IN ACCORDANCE WITH THE "UNIFORM STANDARD SPECIFICATION FOR PUBLIC WORKS CONSTRUCTION OFF-SITE IMPROVEMENTS, CLARK COUNTY AREA NEVADA" LATEST ISSUE; THE "UNIFORM STANDARD DRAWINGS FOR PUBLIC WORKS CONSTRUCTION, CLARK COUNTY AREA NEVADA" LATEST ISSUE; AND OTHER APPLICABLE APPROVED STANDARDS ISSUED BY THE CONTROLLING AGENCY; ALL LOCAL CITY CODES AND ORDINANCES APPLICABLE.

APPROVED FOR CONSTRUCTION
 THIS APPROVAL IS FOR WORK IN CLV RW OR CLV EASEMENT ONLY. OBTAINING PERMISSION OR EASEMENT FOR WORK SHOWN IN PRIVATE PROPERTY IS THE RESPONSIBILITY OF THE UTILITY.

APPROVAL: [Signature] DATE: 6 5 19

PERMIT #	147601
DRAWN BY:	MM
DATE:	4/24/2019
SCALE:	1:30
NODE:	147601
PROJECT #:	405201800000147601
TECH #:	N/A
APPROVED BY:	ART LLOYD

COX
 1700 VEGAS DRIVE
 LAS VEGAS, NEVADA 89106
 PHONE: (702) 545-1606
 FAX: (702) 545-2606

DISCLAIMER NOTE
 UTILITY LOCATIONS SHOWN HEREON ARE APPROXIMATE ONLY. IT SHALL BE THE CONTRACTOR'S RESPONSIBILITY TO DETERMINE THE EXACT HORIZONTAL AND VERTICAL LOCATION OF ALL EXISTING UNDERGROUND AND OVERHEAD UTILITIES PRIOR TO COMMENCING CONSTRUCTION. NO REPRESENTATION IS MADE THAT ALL EXISTING UTILITIES ARE SHOWN HEREON. THE ENGINEER ASSUMES NO RESPONSIBILITY FOR UTILITIES NOT SHOWN OR UTILITIES NOT SHOWN IN THEIR PROPER LOCATIONS.

AVOID CUTTING UNDERGROUND UTILITY LINES. IT'S COSTLY!
CALL 811 BEFORE YOU DIG
 OR 1-800-227-2600 UNDERGROUND SERVICE (USA)

AVOID OVERHEAD POWER LINE CONTACT
CALL BEFORE YOU OVERHEAD
 1-702-227-2929 NEVADA POWER ENVIRONMENT AND SAFETY SERVICE DEPARTMENT

CITY OF LAS VEGAS
 333 N. RANCHO DRIVE
 LAS VEGAS, NEVADA 89106
 (702) 229-6885

CITY/ENTITY: CITY OF LAS VEGAS
PROJECT LOCATION: DURANGO DR & DORRELL LN
SUB-CONTRACTOR: TRUENET
ENTITY NOTES: 24 HOUR/EMERGENCY # FOR TRUENET: 702-502-1515

SHEET No: 1
 Sheet 1 of 1

TOTAL BORE	0'
TOTAL DIRT TRENCH	0'
TOTAL ASPHALT TRENCH	107'
TOTAL TRENCH	107'
SIDEWALK REMOVAL/REPAIR	
TOTAL S/W PANELS	4
TOTAL LINEAR FOOTAGE	20'

L19-00358-R001 4/24/19
 TrueNet# 13355