

Plotted By: Jialyn, Jalynn, Sheet: Set: KHA, Layout: TSI, December 04, 2018 07:30:59am, W. 81153 - AURICH/DWG/CONSULTANTS/ENGLH TRAFFIC/20181130 - HUALAPAI PED. PLAN/Final\_09-61153-TSI.dwg  
 This document, together with the contracts and designs prepared hereon, is an instrument of service, is intended only for the specific purpose and use stated herein, and is not to be used for any other purpose without the written consent of the engineer of record. No part of this document shall be reproduced or transmitted in any form or by any means, electronic, mechanical, photocopying, recording, or by any information storage and retrieval system, without the prior written permission of the engineer of record.

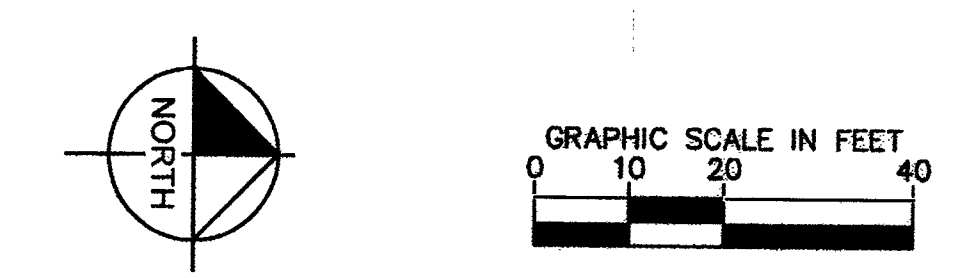

| TRAFFIC SIGNAL CONSTRUCTION NOTES |   |
|-----------------------------------|---|
| NO                                | ITEM  |
| 1                                 | INSTALL DOUBLE STACKED NO. 5 PULL BOX PER CCAUSD 329 & 706.   |
| 2                                 | INSTALL P30 PULL BOX PER CCAUSD 710, 711 & 761.   |
| 3                                 | INSTALL TRAFFIC SIGNAL POLE LUMINAIRES. PROPOSED LUMINAIRES SHALL CONFORM CURRENT (AS OF THE DATE OF INSPECTION) CITY STANDARDS AND SPECIFICATIONS. |
| 4                                 | EXISTING PULL BOX TO BE REMOVED.  |
| 5                                 | EXISTING PULL BOX TO REMAIN, PROTECT IN PLACE.  |
| 6                                 | EXISTING TRAFFIC SIGNAL POLE AND EQUIPMENT TO REMAIN, PROTECT IN PLACE.   |
| 7                                 | CONTRACTOR SHALL COORDINATE WITH CITY TRAFFIC INSPECTOR REGARDING THE REPROGRAMMING OF TRAFFIC SIGNAL VIDEO DETECTION ZONES.                        |
| 8                                 | EXISTING R3-4 (U-TURN PROHIBITED) TO BE REMOVED. INSTALL MODIFIED R3-4 (U-TURN PERMITTED).  |
| 9                                 | RELOCATE EXISTING R3-4R SIGN TO POLE D. SIGN TO BE MOUNTED ABOVE POLE MOUNTED SIGNAL HEAD.  |

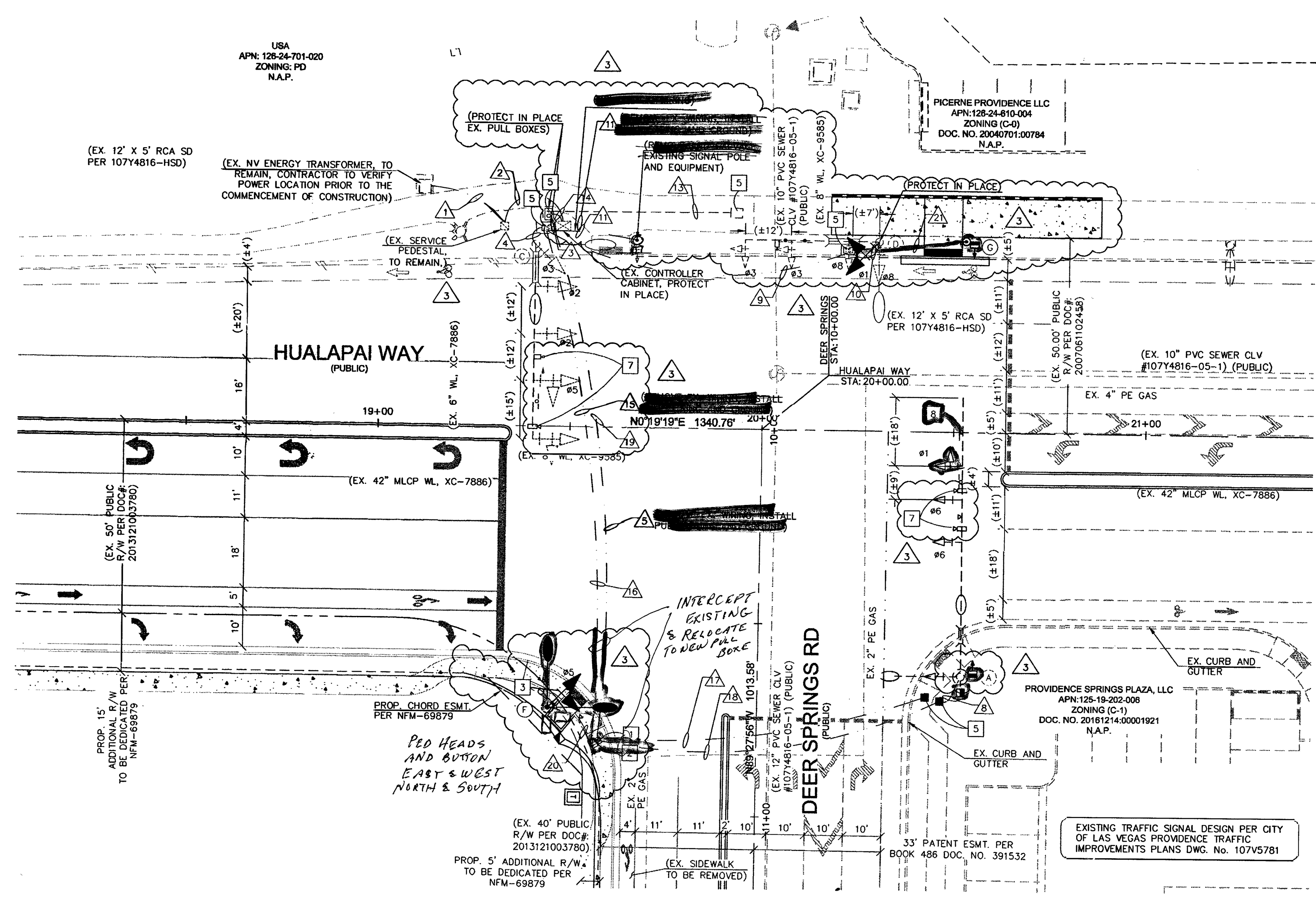
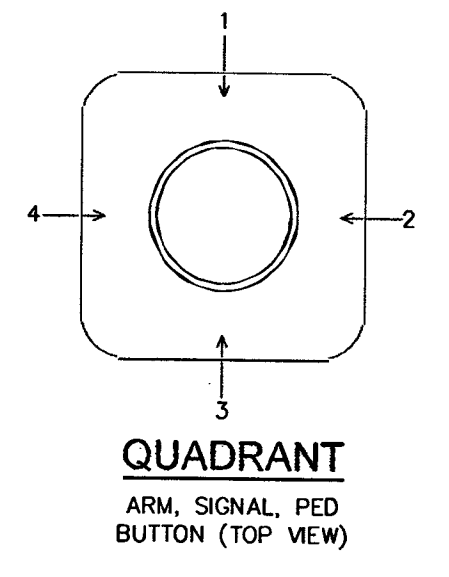
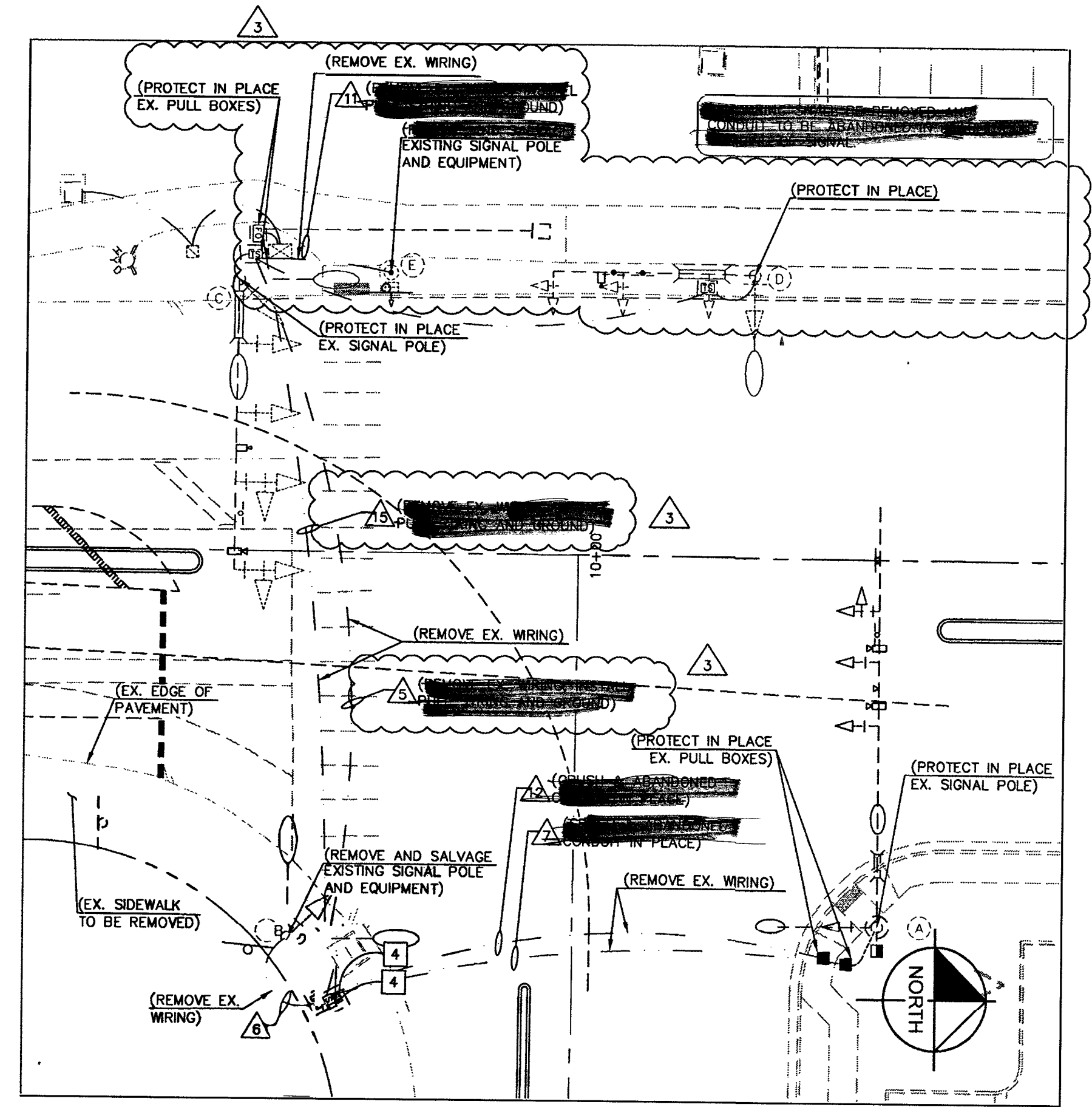
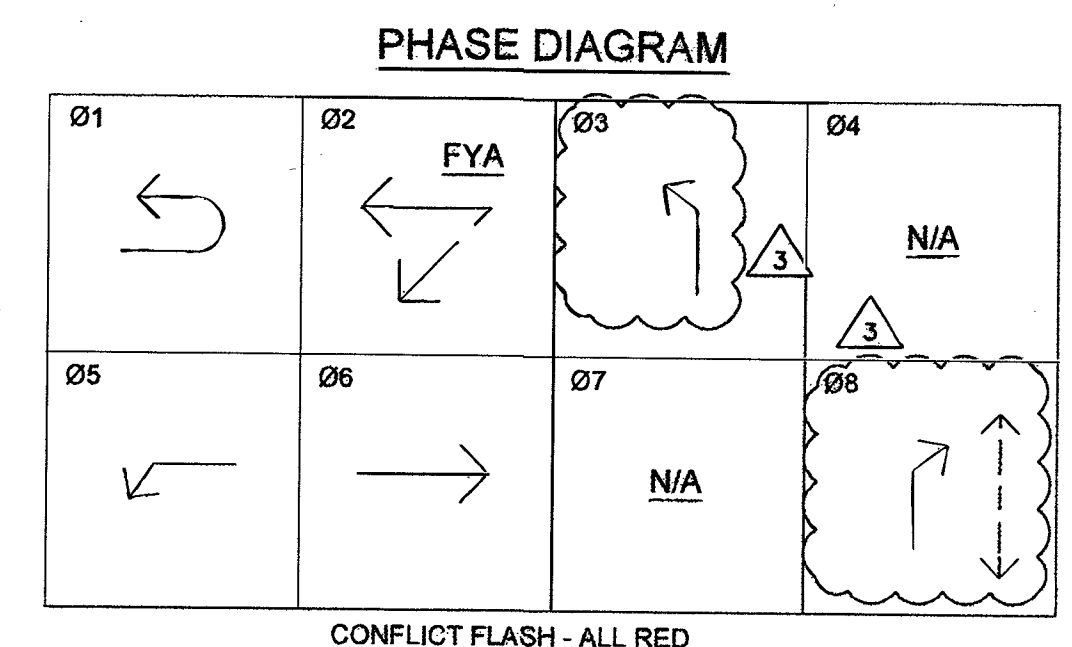

- SIGNAL GENERAL NOTES:**
- CONTRACTOR SHALL CONTACT CITY OF LAS VEGAS TRAFFIC OPERATIONS AT 229-6075 TO SCHEDULE CITY TRAFFIC STAFF TO LOCATE UNDERGROUND STREETLIGHTING AND SIGNAL FACILITIES IN THE PROJECT AREA. A MINIMUM OF 48 HOURS NOTICE IS REQUIRED PRIOR TO THEIR OPERATION.  
 HOURS OF OPERATION ARE: 6:30AM-3:00PM, MONDAY THROUGH FRIDAY, EXCLUDING HOLIDAYS.
  - REPLACE ALL TRAFFIC CONTROL DEVICES (SIGNS OR PAVEMENT MARKINGS) UNDER CITY OF LAS VEGAS JURISDICTION THAT ARE DISTURBED, DESTROYED, MOVED OR MODIFIED BY TRENCHING ACTIVITY TO CITY OF LAS VEGAS SATISFACTION. ALL MATERIALS USED SHALL MEET CITY OF LAS VEGAS' SPECIFICATIONS, OR WILL BE AN APPROVED EQUIVALENT.
  - EXISTING TRAFFIC SIGNAL SHALL REMAIN IN OPERATION THROUGHOUT CONSTRUCTION.
  - CONTRACTOR TO REVIEW UNDERGROUND CONSTRUCTION PER THIS PLAN AND CITY OF LAS VEGAS PROVIDENCE TRAFFIC IMPROVEMENTS DWG. NO. 107V5781 SET PRIOR TO CONSTRUCTION OF ANY TRAFFIC CONTROL DEVICES.
  - CONDUIT ROUTING AND PULLBOX PLACEMENT LOCATIONS ARE SHOWN SCHEMATICALLY ON THE PLANS AND MAY VARY IN THE FIELD.
  - COORDINATE WITH CITY INSPECTOR ON RETURN OF SALVAGED TRAFFIC SIGNAL EQUIPMENT.
  - CONTRACTOR SHALL MAINTAIN EXISTING TRAFFIC SIGNAL PHASING.

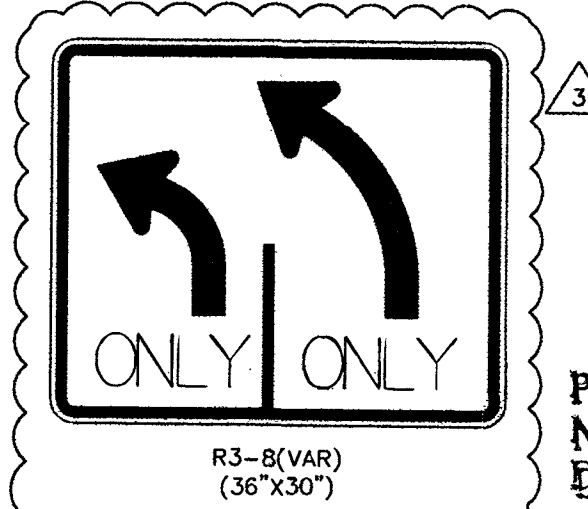

**FAST TRAC ELECTRIC AS BUILT**  
 PRINT FOR JOB #  
 NAME: *Jason Mark*  
 DATE: *4-15-19* INT: *WLL*

**NOTE**  
 REFER TO SHEET TS2 FOR CONDUIT, WIRE & POLE SCHEDULE & CITY TRAFFIC SIGNAL NOTES

**BASIS OF BEARINGS**  
 NORTH 89°47'00" WEST, BEING THE SOUTH LINE OF THE SOUTHWEST QUARTER (SW 1/4) OF THE SOUTHWEST QUARTER (SW 1/4) SECTION 19, TOWNSHIP 19 SOUTH, RANGE 60 EAST, M.D.M., COUNTY OF CLARK, STATE OF NEVADA

**BENCHMARK**  
 BENCHMARK: 12LV99 24E4: A RIVET AND ROUND ALUMINUM PLATE IN THE TOP OF CURB AT THE NORTHWEST CORNER OF HUALAPAI WAY AND DEER SPRINGS WAY = 858.066m = 2815.17ft. (NAVD 88)

CALL BEFORE YOU DIG  
 1-702-227-2929

**FAST**  
 Call before you UnderGround  
 1-702-432-5300

Call before you DIG  
 CALL  
 1-800-227-2600

CLV#: 107V7168 CC#: PW17-41363-CMF  
 CLV#: 67712

| NO | REVISIONS  | DATE    | BY |
|----|--|---------|----|
| 3  | UPDATED TRAFFIC SIGNAL & BACKGROUND TO REMOVE SOUTH PED ADD CURB, SW CONDUIT CROSSING & ADD NORTH PED CROSSING | 12-1-18 | EB |

**Kimley»Horn**  
 6671 LAS VEGAS BLVD. S., SUITE 320, LAS VEGAS, NV 89119  
 PHONE: 702-862-3600  
 WWW.KIMLEY-HORN.COM

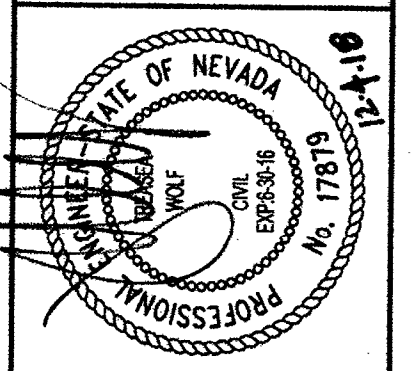

|                |          |
|----------------|----------|
| KHA PROJECT    | 61153.52 |
| DATE           | 12/4/18  |
| SCALE AS SHOWN |          |
| DESIGNED BY MS |          |
| DRAWN BY MS    |          |
| CHECKED BY TA  |          |

TRAFFIC SIGNAL PLAN  
 SHEET 1 OF 2

COMMERCIAL SUBDIVISION  
 @ SEC DEER SPRINGS & HUALAPAI