

LEGEND

1	INSTALL B-36 PULL BOX (24\"X36\"X24\")
2	EXISTING B-36 PULL BOX (24\"X36\"X24\")
3	INSTALL B-50 PULL BOX (13\"X24\"X24\")
4	EXISTING B-50 PULL BOX (13\"X24\"X24\")
5	INSTALL B-100 PULL BOX (24\"X36\"X24\")
6	EXISTING B-100 PULL BOX (24\"X36\"X24\")
7	INSTALL T-200 CATV VAULT (30\"X48\"X36\")
8	EXISTING T-200 CATV VAULT (30\"X48\"X36\")
9	INSTALL T-400 CATV VAULT (36\"X60\"X36\")
10	EXISTING T-400 CATV VAULT (36\"X60\"X36\")
11	INSTALL T-600 CATV VAULT (48\"X72\"X36\")
12	EXISTING T-600 CATV VAULT (48\"X72\"X36\")
13	INSTALL NEW CATV PEDESTAL/CABINET
14	EXISTING NEW CATV PEDESTAL/CABINET
15	R&R S/W SLAB(S)
16	POTHOLE
17	SIDEWALK/DIRT TRENCH INSTALL WITH FIBER/COAX PULL
18	ASPHALT MITIGATION/STREET TRENCH WITH FIBER/COAX PULL
19	PROPOSED BORE WITH FIBER/COAX PULL
20	EXISTING CATV CONDUIT(S)
21	PROPOSED OVERHEAD FIBER OPTIC CABLE OR COAX INSTALL
22	EXISTING OVERHEAD FIBER OPTIC CABLE OR COAX
23	U.G. FIBER/COAX PULL
24	RIGHT OF WAY LINE
25	LOT/PROPERTY LINE
26	EDGE OF PAVEMENT
27	P EXISTING NVE PULL BOX
28	T EXISTING TELCO PULL BOX
29	TM EXISTING TELCO MANHOLE
30	T EXISTING TELCO POLE
31	EXISTING NVE POLE
32	NVE EXISTING NVE TRANSMISSION POLE
33	EXISTING JOINT POLE
34	EXISTING JOINT POLE WITH TRANSFORMER
35	POLE ANCHOR
36	EXISTING NVE TRANSFORMER TRANSFORMER PAD
37	TS SNWA TEST STATION
38	COX POWER SUPPLY (49\"X24\"X52\")
39	RC INSTALL RHINO CABINET
40	RISER POLE/QUADRANT DETAIL RISER OWNERSHIP NOTED
41	RAILROAD
42	MH EXISTING MANHOLE (SS),(SD)...ECT
43	1in CONDUIT LATERAL
44	STORMWATER ASSETS
45	

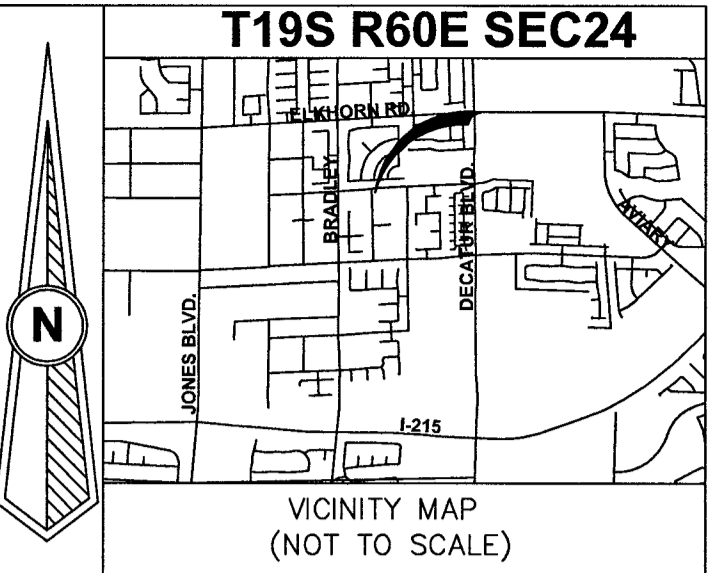

REVISIONS

REV	DESCRIPTION	DATE	BY
1			
2			
3			
4			
5			
6			
7			
8			
9			
10			
11			
12			
13			
14			
15			
16			
17			
18			
19			
20			
21			
22			
23			
24			
25			
26			
27			
28			
29			
30			
31			
32			
33			
34			
35			
36			
37			
38			
39			
40			
41			
42			
43			
44			
45			

ALL CONSTRUCTION AND MATERIALS SHALL BE IN ACCORDANCE WITH THE "UNIFORM STANDARD SPECIFICATIONS FOR PUBLIC WORKS CONSTRUCTION OFF-SITE IMPROVEMENTS, CLARK COUNTY AREA NEVADA" LATEST ISSUE; THE "UNIFORM STANDARD DRAWINGS FOR PUBLIC WORKS CONSTRUCTION, CLARK COUNTY AREA NEVADA" LATEST ISSUE; AND OTHER APPLICABLE APPROVED STANDARDS ISSUED BY THE CONTROLLING AGENCY; ALL LOCAL CITY CODES AND ORDINANCES APPLICABLE.

APPROVED FOR CONSTRUCTION
 THIS APPROVAL IS FOR WORK IN CLV R/W OR CLV EASEMENT ONLY. OBTAINING PERMISSION OR EASEMENT FOR WORK SHOWN IN PRIVATE PROPERTY IS THE RESPONSIBILITY OF THE UTILITY.

Thomas Tallant 4/11/19
 APPROVAL DATE

PERMIT # 151038
 DRAWN BY: WTB
 DATE: 2/28/2019
 SCALE: 1:30
 NODE: 146078
 PROJECT #: 4050518000CCWEXP
 TECH # N/A
 APPROVED BY: Thomas Tallant

COX
 1700 VEGAS DRIVE
 LAS VEGAS, NEVADA 89106
 PHONE: (702) 545-1606
 FAX: (702) 545-2606

CITY/ENTITY:
CITY OF LAS VEGAS
 333 N. RANCHO DRIVE
 LAS VEGAS, NEVADA 89106
 (702) 229-6885

PROJECT LOCATION:
 DECATUR & DONALD III

SUB-CONTRACTOR:
 DBA: COX COMMUNICATIONS.COM

ENTITY NOTES:

DISCLAIMER NOTE

UTILITY LOCATIONS SHOWN HEREON ARE APPROXIMATE ONLY. IT SHALL BE THE CONTRACTOR'S RESPONSIBILITY TO DETERMINE THE EXACT HORIZONTAL AND VERTICAL LOCATION OF ALL EXISTING UNDERGROUND AND OVERHEAD UTILITIES PRIOR TO COMMENCING CONSTRUCTION. NO REPRESENTATION IS MADE THAT ALL EXISTING UTILITIES ARE SHOWN HEREON. THE ENGINEER ASSUMES NO RESPONSIBILITY FOR UTILITIES NOT SHOWN OR UTILITIES NOT SHOWN IN THEIR PROPER LOCATIONS.

AVOID CUTTING UNDERGROUND UTILITY LINES. IT'S COSTLY.
CALL BEFORE YOU DIG
 OR 1-800-227-2600
 UNDERGROUND SERVICE (USA)

AVOID OVERHEAD POWER LINE CONTACT
CALL BEFORE YOU OVERHEAD
 1-702-227-2929
 NEVADA POWER ENVIRONMENT AND SAFETY SERVICE DEPARTMENT

TOTAL BORE	0'
TOTAL DIRT TRENCH	0'
TOTAL ASPHALT TRENCH	0'
TOTAL TRENCH	0'
SIDEWALK REMOVAL/REPAIR	0'
TOTAL S/W PANELS	0
TOTAL LINEAR FOOTAGE	0'

10745088-UTL
 L18-00852-U001