

### LEGEND

1	INSTALL B-36 PULL BOX (24"X36"X24")
2	EXISTING B-36 PULL BOX (24"X36"X24")
3	INSTALL B-50 PULL BOX (13"X24"X24")
4	EXISTING B-50 PULL BOX (13"X24"X24")
5	INSTALL B-100 PULL BOX (24"X36"X24")
6	EXISTING B-100 PULL BOX (24"X36"X24")
7	INSTALL T-200 CATV VAULT (30"X48"X36")
8	EXISTING T-200 CATV VAULT (30"X48"X36")
9	INSTALL T-400 CATV VAULT (36"X60"X36")
10	EXISTING T-400 CATV VAULT (36"X60"X36")
11	INSTALL T-600 CATV VAULT (48"X72"X36")
12	EXISTING T-600 CATV VAULT (48"X72"X36")
13	INSTALL NEW CATV PEDESTAL
14	EXISTING NEW CATV PEDESTAL
15	R&R S/W SLAB(S)
16	POTHOLE
17	SIDEWALK/DIRT TRENCH INSTALL WITH FIBER/COAX PULL
18	ASPHALT MITIGATION/STREET TRENCH WITH FIBER/COAX PULL PROPOSED BORE
19	WITH FIBER/COAX PULL
20	EXISTING CATV CONDUIT(S)
21	PROPOSED OVERHEAD FIBER OPTIC CABLE OR COAX INSTALL
22	EXISTING OVERHEAD FIBER OPTIC CABLE OR COAX
23	U.G. FIBER/COAX PULL
24	RIGHT OF WAY LINE
25	LOT/PROPERTY LINE
26	EDGE OF PAVEMENT
27	EXISTING NVE PULL BOX
28	EXISTING TELCO PULL BOX
29	EXISTING TELCO MANHOLE
30	EXISTING TELCO POLE
31	EXISTING NVE POLE
32	EXISTING NVE TRANSMISSION POLE
33	EXISTING JOINT POLE
34	EXISTING JOINT POLE WITH TRANSFORMER
35	POLE ANCHOR
36	EXISTING NVE TRANSFORMER TRANSFORMER PAD
37	SNWA TEST STATION
38	COX POWER SUPPLY (49"X24"X52")
39	INSTALL RHINO CABINET
40	RISER POLE/QUADRANT DETAIL RISER OWNERSHIP NOTED
41	RAILROAD
42	EXISTING MANHOLE (SS)(SD)...ECT
43	1in CONDUIT LATERAL
44	STORMWATER ASSETS
45	

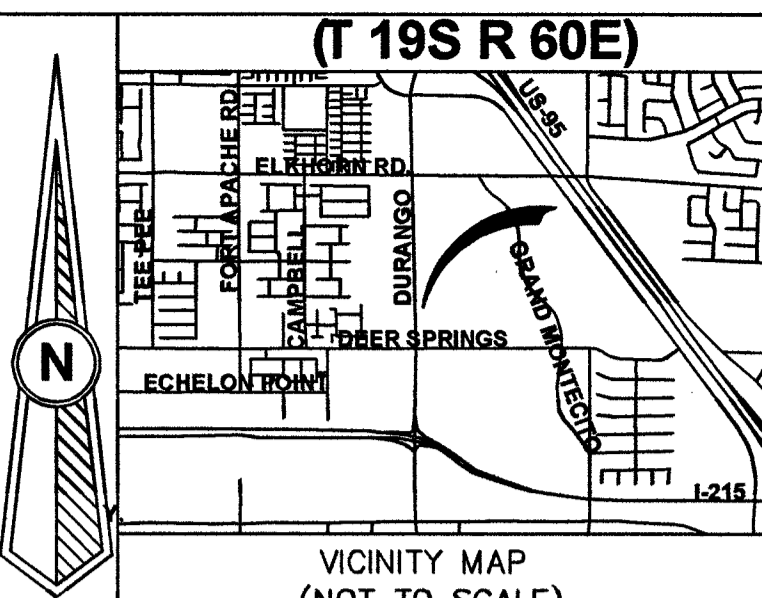

### REVISIONS

REV	DESCRIPTION	DATE	BY

ALL CONSTRUCTION AND MATERIALS SHALL BE IN ACCORDANCE WITH THE "UNIFORM STANDARD SPECIFICATIONS FOR PUBLIC WORKS CONSTRUCTION OFF-SITE IMPROVEMENTS, CLARK COUNTY AREA NEVADA" LATEST ISSUE; THE "UNIFORM STANDARD DRAWINGS FOR PUBLIC WORKS CONSTRUCTION, CLARK COUNTY AREA NEVADA" LATEST ISSUE; AND OTHER APPLICABLE APPROVED STANDARDS ISSUED BY THE CONTROLLING AGENCY; ALL LOCAL CITY CODES AND ORDINANCES APPLICABLE.

**APPROVED FOR CONSTRUCTION**  
 THIS APPROVAL IS FOR WORK IN CLV RW OR CLV EASEMENT ONLY. OBTAINING PERMISSION OR EASEMENT FOR WORK SHOWN IN PRIVATE PROPERTY IS THE RESPONSIBILITY OF THE UTILITY.

APPROVAL: *[Signature]* DATE: 4 8 19

PERMIT #	147607
DRAWN BY	WTB
DATE	2/21/2019
SCALE	1:30
PROJECT #	405201800000147607
TECH #	N/A
APPROVED BY	ART LLOYD

### DISCLAIMER NOTE

UTILITY LOCATIONS SHOWN HEREON ARE APPROXIMATE ONLY. IT SHALL BE THE CONTRACTOR'S RESPONSIBILITY TO DETERMINE THE EXACT HORIZONTAL AND VERTICAL LOCATION OF ALL EXISTING UNDERGROUND AND OVERHEAD UTILITIES PRIOR TO COMMENCING CONSTRUCTION. NO REPRESENTATION IS MADE THAT ALL EXISTING UTILITIES ARE SHOWN HEREON. THE ENGINEER ASSUMES NO RESPONSIBILITY FOR UTILITIES NOT SHOWN OR UTILITIES NOT SHOWN IN THEIR PROPER LOCATIONS.

**BEFORE YOU DIG**  
 OR 1-800-227-2600  
 UNDERGROUND SERVICE (USA)

**BEFORE YOU OVERHEAD**  
 1-702-227-2929  
 NEVADA POWER ENVIRONMENT AND SAFETY SERVICE DEPARTMENT

**AVOID CUTTING UNDERGROUND UTILITY LINES. IT'S COSTLY.**

**AVOID OVERHEAD POWER LINE CONTACT**

**BEFORE YOU UNDERGROUND**  
 CALL BEFORE YOU DO UNDERGROUND

**BEFORE YOU OVERHEAD**  
 CALL BEFORE YOU OVERHEAD

**TOTAL BORE** 125'  
**TOTAL DIRT TRENCH** 20'  
**TOTAL ASPHALT TRENCH** 0'  
**TOTAL TRENCH** 20'  
**SIDEWALK REMOVAL/REPAIR**  
**TOTAL S/W PANELS** 10  
**TOTAL LINEAR FOOTAGE** 50'

CITY/ENTITY: CITY OF LAS VEGAS

CITY OF LAS VEGAS  
 333 N. RANCHO DRIVE  
 LAS VEGAS, NEVADA 89106  
 (702) 229-6885

PROJECT LOCATION: DURANGO DR & HITT FAMILY CT

SUB-CONTRACTOR: TRUENET

ENTITY NOTES: SHEET No: 1

Sheet 1 of 1

119-00363 2/25/19

TrueNet# 13337