

BORE 107'
PLACE 1-2" CONDUIT WITH FIBER/COAX
BORE DEPTH 36"-48" +/- 10% VARIANCE

R&R 2 S/W SLAB
PER RTC GUIDELINE #234
PLACE B200 VAULT
PLACE BORE PIT
CONTINUE TO AT&T CELL POLE

7100 N DURANGO DR
125-20-510-015

7105 N DURANGO DR
125-20-117-005

7095 N DURANGO DR
125-20-114-004

EXISTING B200 VAULT
PULL NEW FIBER/COAX
START OF PULL

7045 N DURANGO DR
125-20-114-007

POTHOLE STREET LIGHTS 50' WEST OF C/L
POTHOLE SEWER DRAIN 40' WEST OF C/L
POTHOLE WATER 15' WEST OF C/L
POTHOLE SEWER SYSTEM 5' WEST OF C/L
POTHOLE WATER 40' EAST OF C/L
POTHOLE NVE 50' EAST OF C/L
POTHOLE CENTURY LINK 55' EAST OF C/L
PER RTC GUIDELINE #506

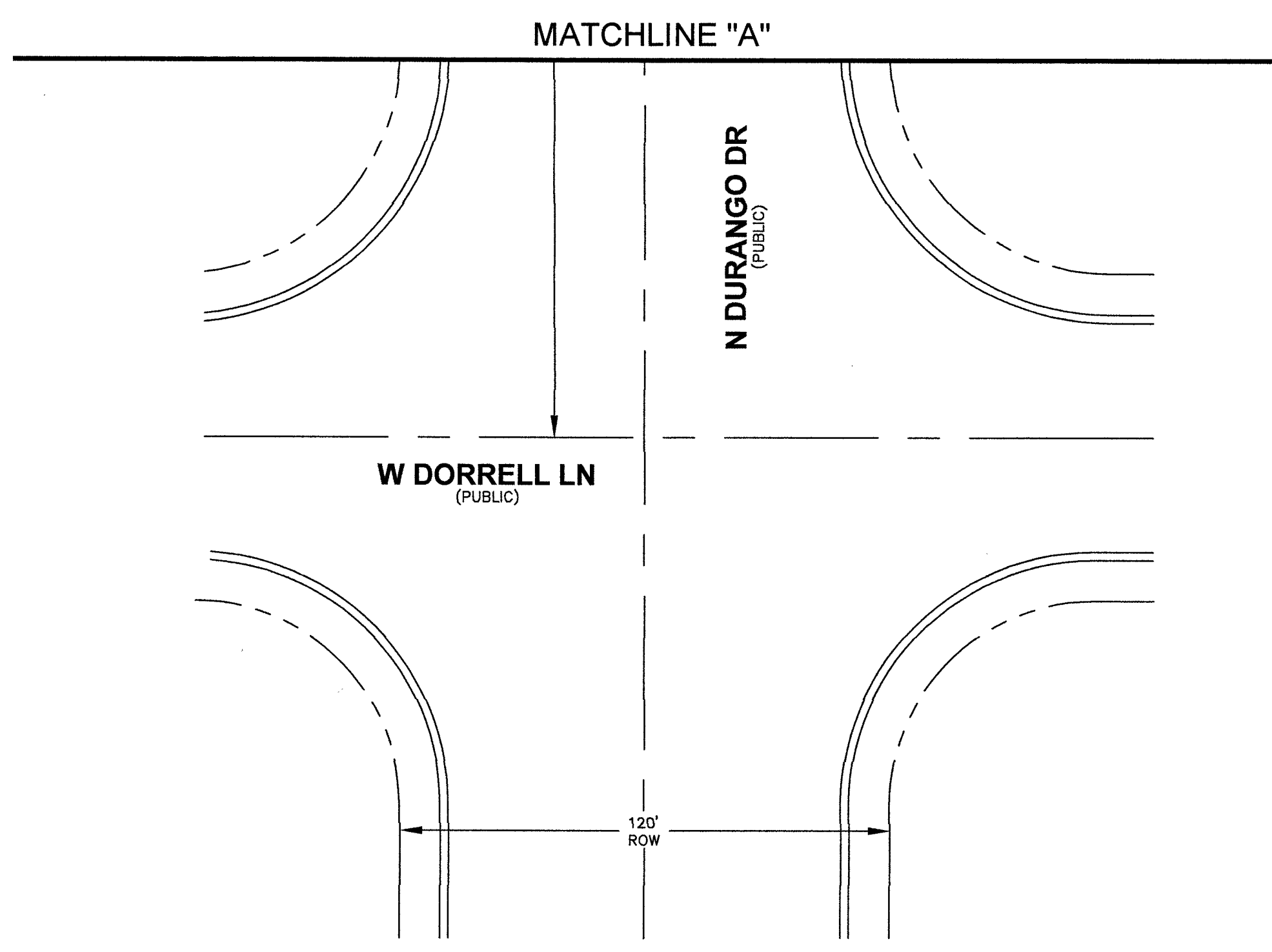

LEGEND	
1	INSTALL B-36 PULL BOX (24"x36"x24")
2	EXISTING B-36 PULL BOX (24"x36"x24")
3	INSTALL B-50 PULL BOX (13"x24"x24")
4	EXISTING B-50 PULL BOX (13"x24"x24")
5	INSTALL B-100 PULL BOX (24"x36"x24")
6	EXISTING B-100 PULL BOX (24"x36"x24")
7	INSTALL T-200 CATV VAULT (30"x48"x36")
8	EXISTING T-200 CATV VAULT (30"x48"x36")
9	INSTALL T-400 CATV VAULT (36"x60"x36")
10	EXISTING T-400 CATV VAULT (36"x60"x36")
11	INSTALL T-600 CATV VAULT (48"x72"x36")
12	EXISTING T-600 CATV VAULT (48"x72"x36")
13	INSTALL NEW CATV PEDESTAL
14	EXISTING NEW CATV PEDESTAL
15	R&R S/W SLAB(S)
16	POTHOLE
17	SIDEWALK/DIRT TRENCH INSTALL WITH FIBER/COAX PULL
18	ASPHALT MITIGATION/STREET TRENCH WITH FIBER/COAX PULL PROPOSED BORE
19	WITH FIBER/COAX PULL
20	EXISTING CATV CONDUIT(S)
21	PROPOSED OVERHEAD FIBER OPTIC CABLE OR COAX INSTALL
22	EXISTING OVERHEAD FIBER OPTIC CABLE OR COAX
23	U.G. FIBER/COAX PULL
24	RIGHT OF WAY LINE
25	LOT/PROPERTY LINE
26	EDGE OF PAVEMENT
27	EXISTING NVE PULL BOX
28	EXISTING TELCO PULL BOX
29	EXISTING TELCO MANHOLE
30	EXISTING TELCO POLE
31	EXISTING NVE POLE
32	EXISTING NVE TRANSMISSION POLE
33	EXISTING JOINT POLE
34	EXISTING JOINT POLE WITH TRANSFORMER
35	POLE ANCHOR
36	EXISTING NVE TRANSFORMER TRANSFORMER PAD
37	SNWA TEST STATION
38	COX POWER SUPPLY (49"x24"x52")
39	INSTALL RHINO CABINET
40	RISER POLE/QUADRANT DETAIL RISER OWNERSHIP NOTED
41	RAILROAD
42	EXISTING MANHOLE (SS),(SD)...ECT
43	1in CONDUIT LATERAL
44	STORMWATER ASSETS
45	

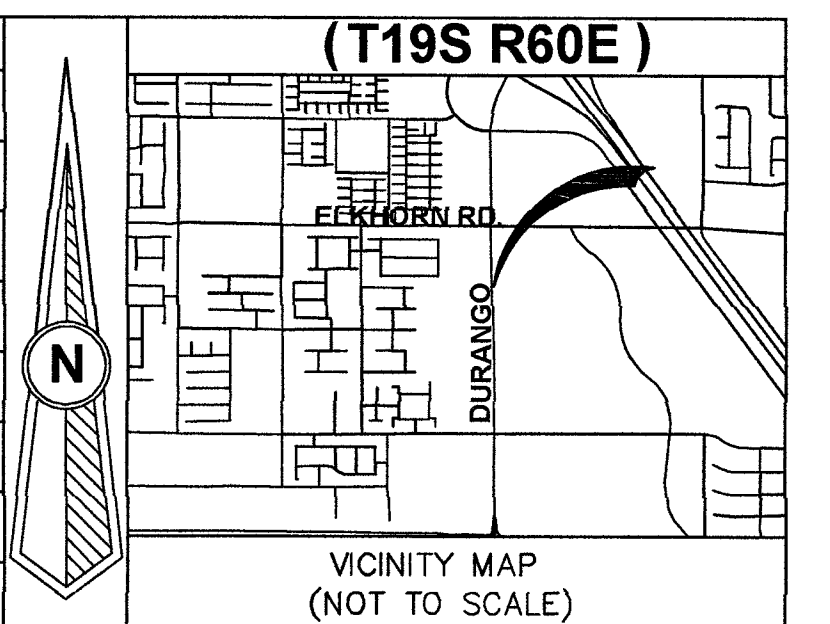

REVISIONS			
REV	DESCRIPTION	DATE	BY

ALL CONSTRUCTION AND MATERIALS SHALL BE IN ACCORDANCE WITH THE "UNIFORM STANDARD SPECIFICATIONS FOR PUBLIC WORKS CONSTRUCTION OFF-SITE IMPROVEMENTS, CLARK COUNTY AREA NEVADA" LATEST ISSUE, THE "UNIFORM STANDARD DRAWINGS FOR PUBLIC WORKS CONSTRUCTION, CLARK COUNTY AREA NEVADA" LATEST ISSUE, AND OTHER APPLICABLE APPROVED STANDARDS ISSUED BY THE CONTROLLING AGENCY, ALL LOCAL CITY CODES AND ORDINANCES APPLICABLE.

APPROVED FOR CONSTRUCTION
THIS APPROVAL IS FOR WORK IN CLV R/W OR CLV EASEMENT ONLY. OBTAINING PERMISSION OR EASEMENT FOR WORK SHOWN IN PRIVATE PROPERTY IS THE RESPONSIBILITY OF THE UTILITY.

APPROVAL: [Signature] DATE: 4/6/19

PERMIT # 147601
DRAWN BY: MM
DATE: 11/26/2018
SCALE: 1:30
NODE: 147601
PROJECT # 405201800000147601
TECH # N/A
APPROVED BY: ART LLOYD

COX
1700 VEGAS DRIVE
LAS VEGAS, NEVADA 89106
PHONE: (702) 545-1606
FAX: (702) 545-2606

DISCLAIMER NOTE
UTILITY LOCATIONS SHOWN HEREON ARE APPROXIMATE ONLY. IT SHALL BE THE CONTRACTOR'S RESPONSIBILITY TO DETERMINE THE EXACT HORIZONTAL AND VERTICAL LOCATION OF ALL EXISTING UNDERGROUND AND OVERHEAD UTILITIES PRIOR TO COMMENCING CONSTRUCTION. NO REPRESENTATION IS MADE THAT ALL EXISTING UTILITIES ARE SHOWN HEREON. THE ENGINEER ASSUMES NO RESPONSIBILITY FOR UTILITIES NOT SHOWN OR UTILITIES NOT SHOWN IN THEIR PROPER LOCATIONS.

BEFORE YOU DIG
OR 1-800-227-2600
UNDERGROUND SERVICE (USA)

BEFORE YOU OVERHEAD
1-702-455-1511
CLARK COUNTY TRAFFIC OPERATIONS
1-702-432-4300
LAS VEGAS AREA COMPUTERIZED SYSTEM

AVOID CUTTING UNDERGROUND UTILITY LINES. IT'S COSTLY.

AVOID OVERHEAD POWER LINE CONTACT

CITY/ENTITY: CITY OF LAS VEGAS
333 N. RANCHO DRIVE
LAS VEGAS, NEVADA 89106
(702) 229-6885

PROJECT LOCATION: DURANGO DR & DORRELL LN

SUB-CONTRACTOR: DBA: COX COMMUNICATIONS

ENTITY NOTES: [Blank]

SHEET No: **1**

Sheet 1 of 1

TOTAL BORE	107'
TOTAL DIRT TRENCH	0'
TOTAL ASPHALT TRENCH	0'
TOTAL TRENCH	0'
TOTAL S/W PANELS	4
TOTAL LINEAR FOOTAGE	20'

L19-00358 2/21/19

TrueNet# 13335