

REVERENCE PARKWAY
PUBLIC STREET
SCALE: HORIZ. 1"=40'

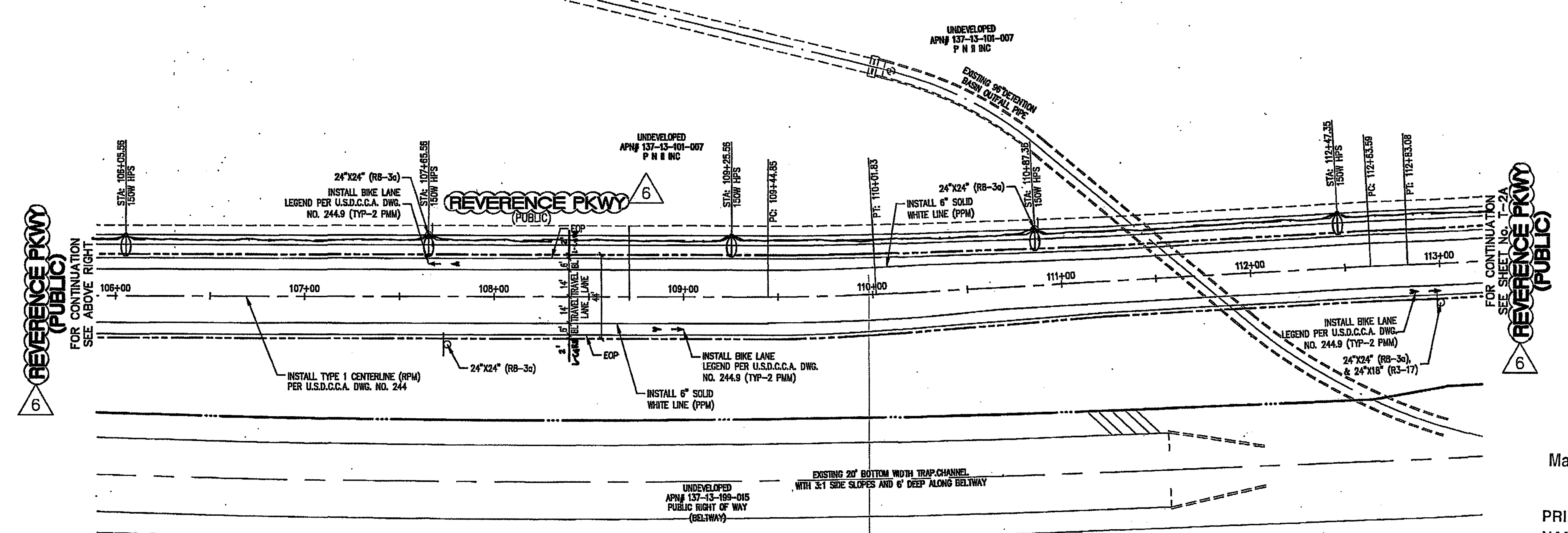
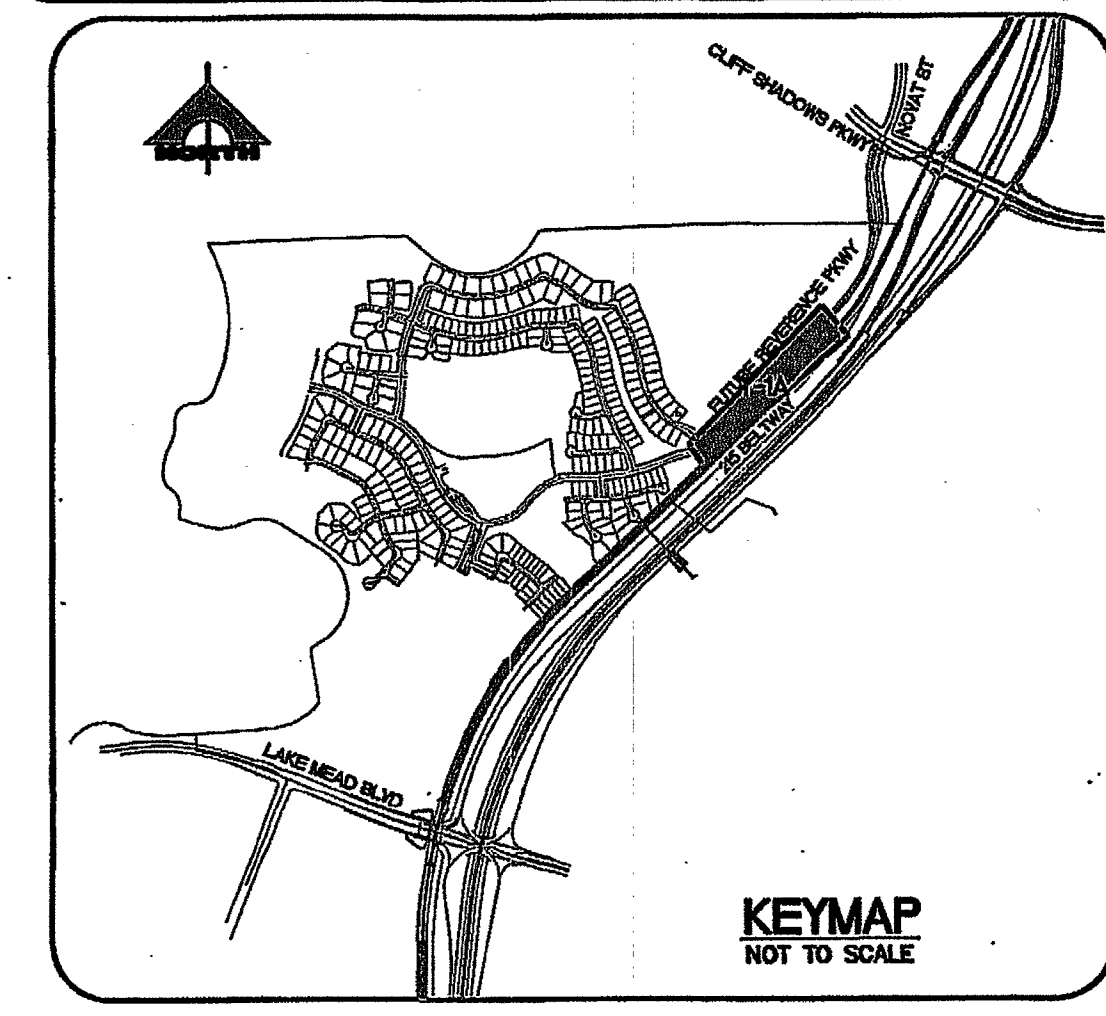
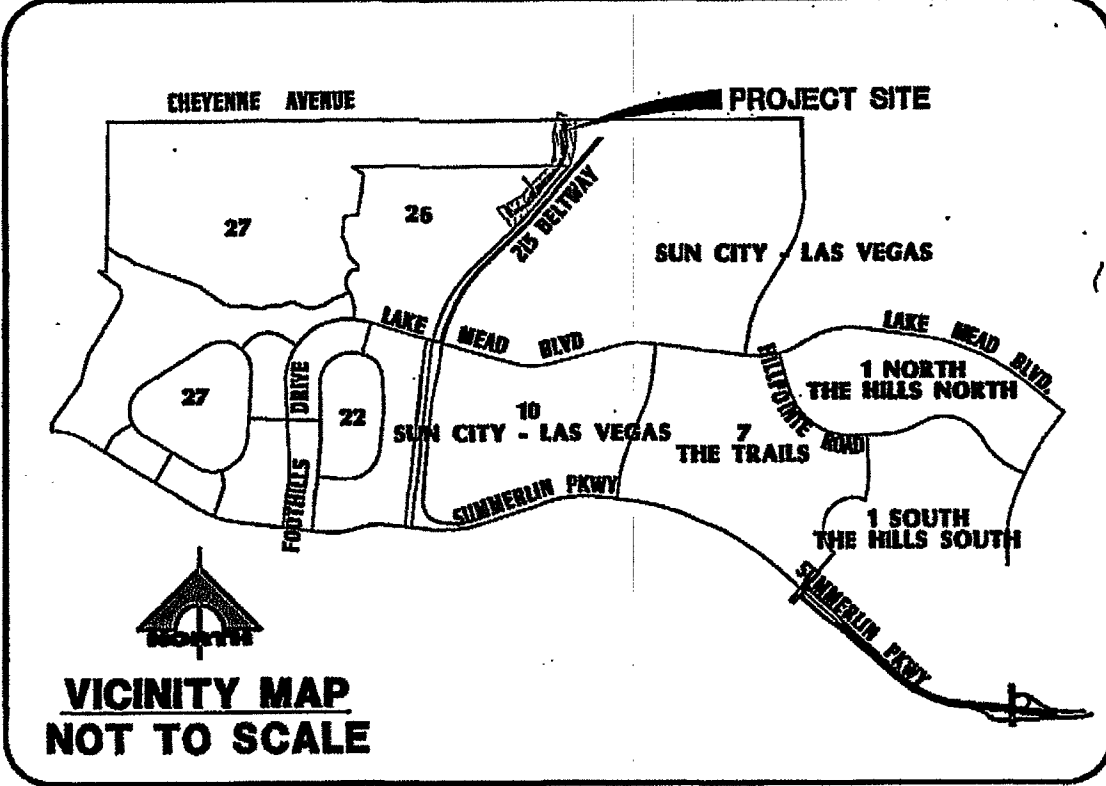
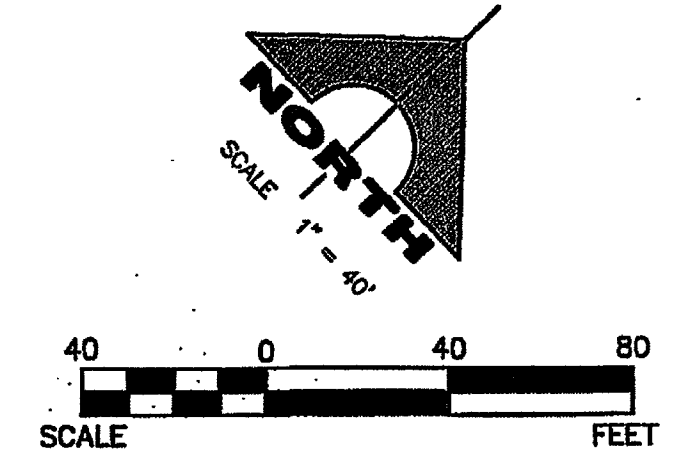

REVERENCE PARKWAY
PUBLIC STREET
SCALE: HORIZ. 1"=40'

Mammoth Underground, LLC
AS BUILT
PRINT FOR JOB # _____
NAME Jose Marco Flores
DATE 12/11/2018 INIT _____

BENCHMARK
PROJECT DATUM: SUMMERLIN VILLAGE 28 - REVERENCE PROJECT MODIFIED DATUM
CLARK COUNTY VERTICAL CONTROL POINT: SLVD9 1456
SUMMERLIN VILLAGE 28 - REVERENCE PROJECT MODIFIED DATUM: 3227.64 FEET
NAVD88 DATUM: 983.659 METERS (3227.22 FEET)
RIVET & PLATE IN HEAD WALL WEST OF CC215 +/-250' NORTH OF LAKE MEAD.
TO OBTAIN SUMMERLIN VILLAGE 28 - REVERENCE PROJECT MODIFIED DATUM ADD 0.42 FEET TO NAVD88 DATUM.

BASIS OF BEARING
SOUTH 89°39'55" EAST, BEING THE BEARING OF THE NORTH LINE OF THE NORTHWEST QUARTER (NW 1/4) OF THE NORTHWEST QUARTER (NW 1/4) OF SECTION 13, TOWNSHIP 20 SOUTH, RANGE 59 EAST, M.D.M., AS SHOWN IN FILE 112, PAGE 94 OF PARCEL MAPS ON FILE AT THE CLARK COUNTY, NEVADA RECORDER'S OFFICE.

LEGEND

9" STREET NAME SIGN (0-3, 2 PER POLE)	400W HPS STREET LIGHT
STOP SIGN W/ POST (30" R1-1)	TRAFFIC SIGNAL (150W HPS STREET LIGHT)
TRAFFIC SIGN (AS INDICATED)	2" CONDUIT
SIGHT VISIBILITY ZONE NO IMPROVEMENTS OVER 24" IN HEIGHT, EXCEPT TRAFFIC CONTROL DEVICES	200 AMP PAD MOUNT SERVICE PEDESTAL
REMOVE CONFLICTING STRIPING	1/4" CONDUIT

NOTE:
ALL STREET LIGHTS TO BE CITY OF LAS VEGAS STANDARD STREET LIGHTS.

NOTE:
INSTALL STREET NAME SIGNS AS PER CLV SUBDIVISION ORDINANCE 18.12.105 & 18.12.100.
STREET NAME SIGNS FOR PRIVATE STREETS SHALL BEAR THE WORDS "PRIVATELY MAINTAINED" AND SHALL BE A COLOR AND DESIGN ESTABLISHED BY THE CITY AND IN CONFORMANCE WITH THE MANUAL OF UNIFORM TRAFFIC CONTROL DEVICES. THE COLOR OF SUCH A SIGN MUST DIFFER DISTINCTLY FROM THE USED IN CONNECTION WITH PUBLIC STREETS.
COLOR FOR STREET NAME SIGNS SHALL BE WHITE LETTERS ON BROWN BACKGROUND.

NOTE:
PRIVATE STREETS ARE P.U.E.S., CLV PUBLIC SEWER EASEMENTS AND PUBLIC DRAINAGE EASEMENT TO BE PRIVATELY MAINTAINED.

ABBREVIATION
RPM - RAISED PAVEMENT MARKERS
PMM - PAVEMENT MARKING MATERIAL
PPM - POLYUREA PAINT MARKING

Call before you Dig
811
OR
1-800-227-2800

FAST
Call before you Under Ground
1-702-432-5300
PREPAY AND AUTOMATIC SYSTEM OF TRANSPORTATION

CALL BEFORE YOU DIG OVERHEAD
1-702-227-2929

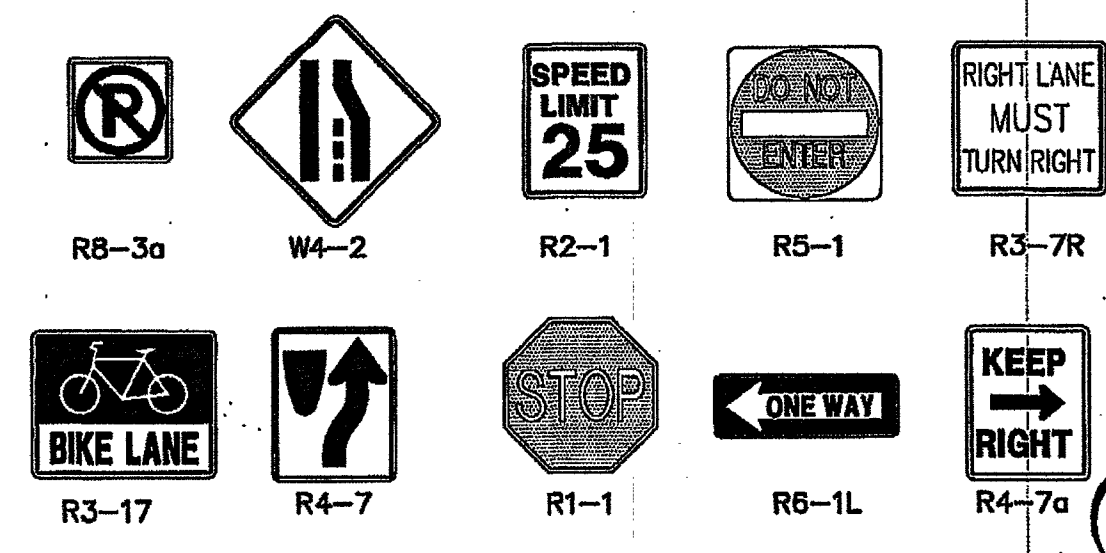

H# 65338 18837 CLV DWG# 107Y4950-AR

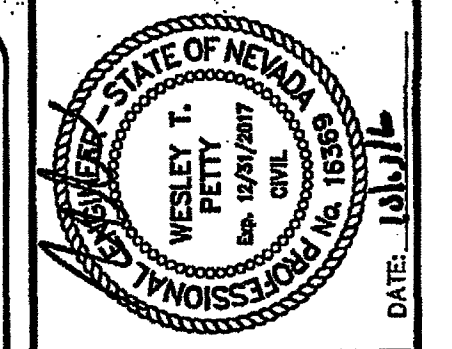

PROJECT NO.	764-204-018
DESIGNER	HN
DRAWN	HN
CHECKED	WP
DATE	12-12-18
REVISION	1
DESCRIPTION	REVISION TO MATCH REVISION 1

GCV
ENGINEERS & SURVEYORS
1555 S. RAINBOW BLVD.
LAS VEGAS, NV 89146
T: 702.804.2000
F: 702.804.2299
gcvengineering.com

DESERT HOPE DRIVE - ACCESS ROAD - (L.A.N.) REVERENCE PARKWAY
REVERENCE (VILLAGE 26)
PULTE HOMES
STREET LIGHT, TRAFFIC AND SIGNAGE PLAN
REVERENCE PARKWAY
DRAWING
T-1A
20A OF 26 SHEETS

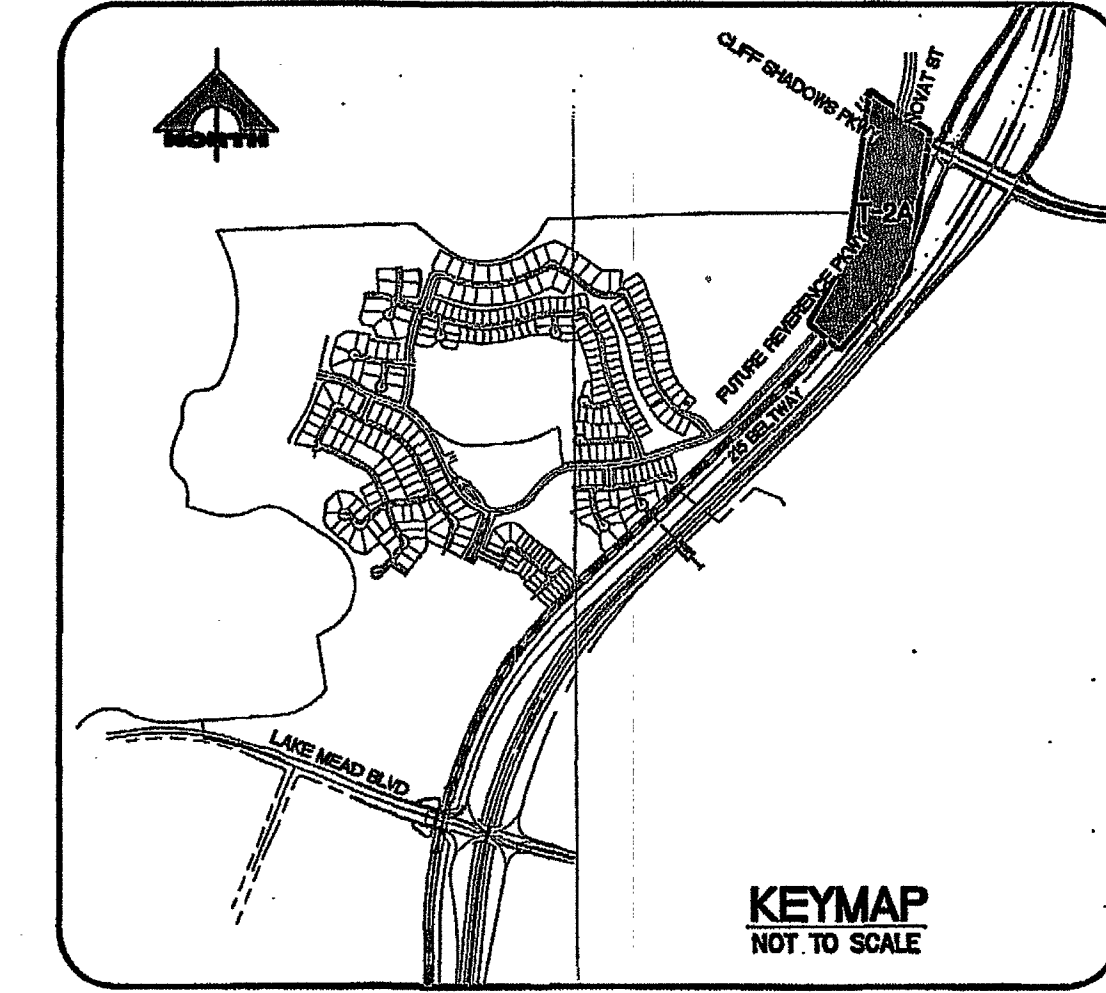
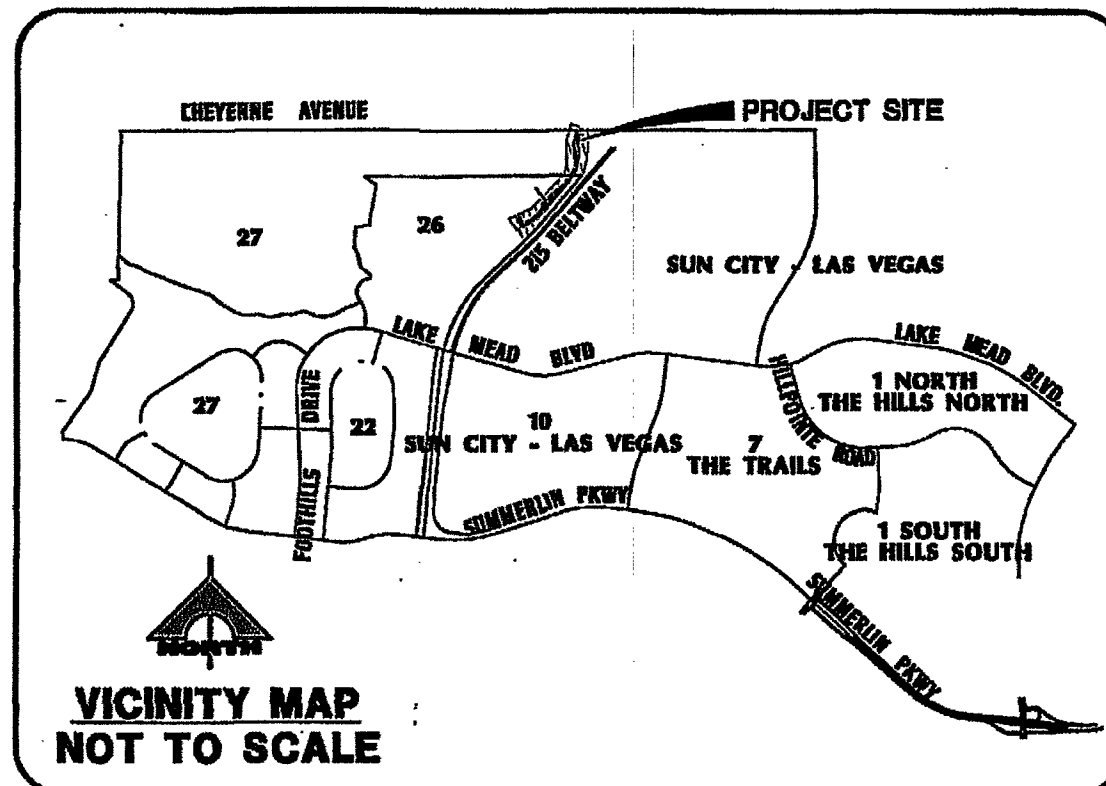
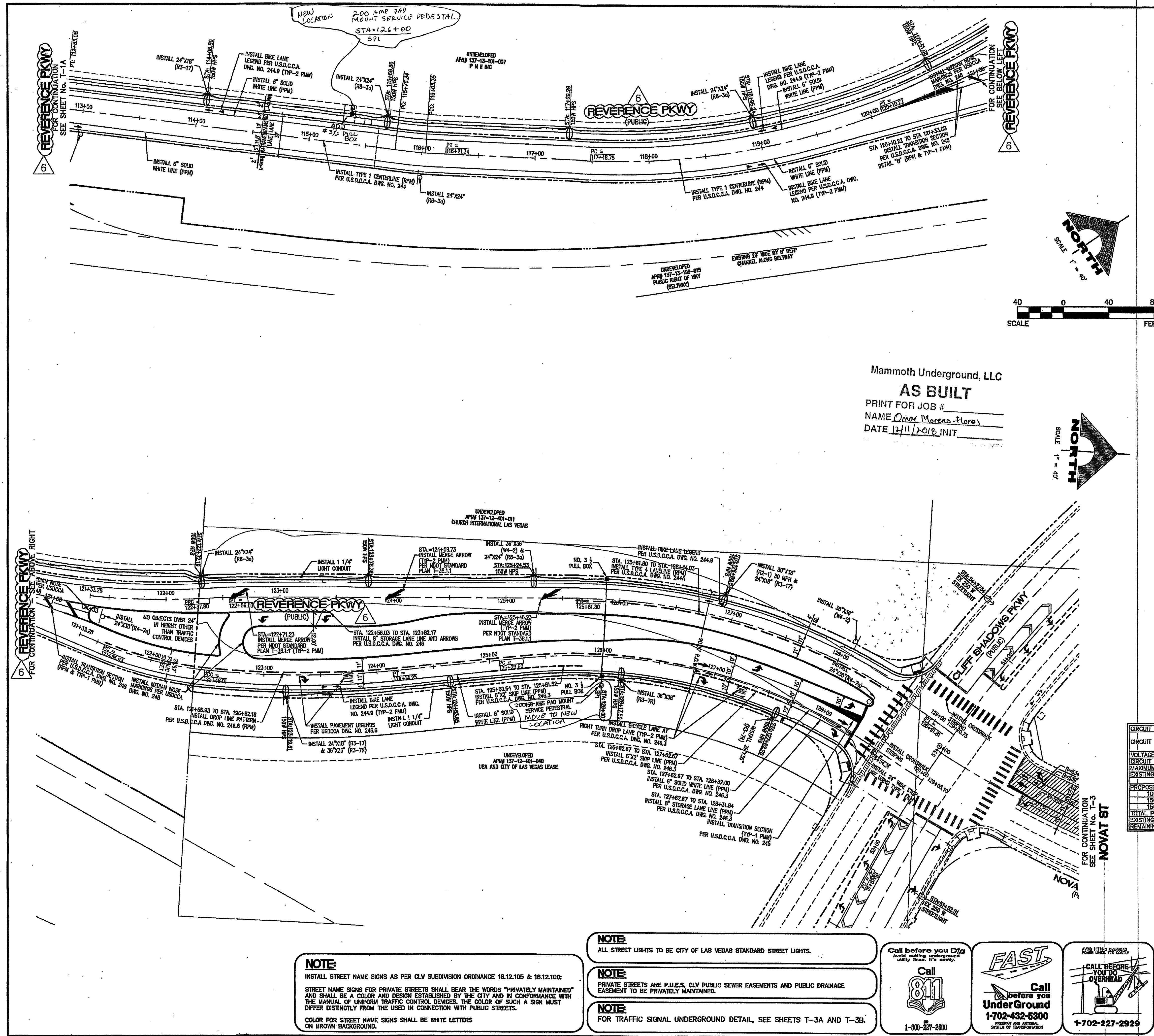

Mammoth Underground, LLC
AS BUILT
 PRINT FOR JOB # _____
 NAME Orion Moreno Flores
 DATE 12/11/2019 INIT _____

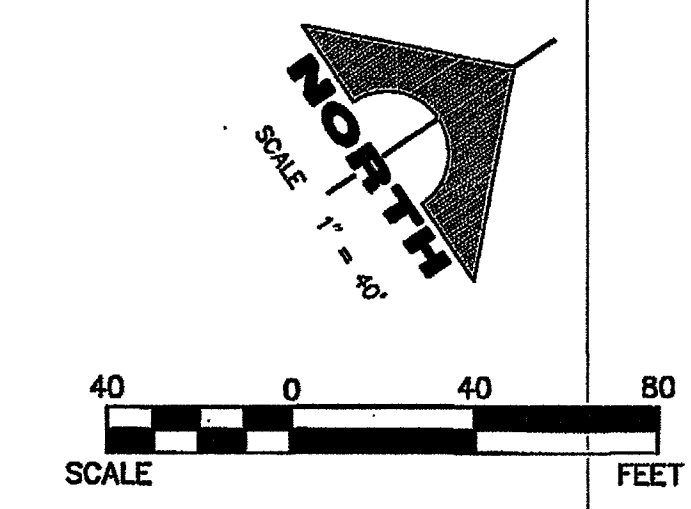

BENCHMARK
 PROJECT DATUM: SUMMERLIN VILLAGE 26 - REVERENCE PROJECT MODIFIED DATUM
 CLARK COUNTY VERTICAL CONTROL POINT: SLV09 1486
 SUMMERLIN VILLAGE 26 - REVERENCE PROJECT MODIFIED DATUM: 3227.64 FEET
 NAVD83 DATUM: 983.659 METERS (3227.22 FEET)
 RIVET & PLATE IN HEAD WALL WEST OF CC215 +/- 250' NORTH OF LAKE MEAD.
 TO OBTAIN SUMMERLIN VILLAGE 26 - REVERENCE PROJECT MODIFIED DATUM ADD 0.42 FEET TO NAVD83 DATUM.

BASIS OF BEARING
 SOUTH 89°39'55" EAST, BEING THE BEARING OF THE NORTH LINE OF THE NORTHWEST QUARTER (NW 1/4) OF SECTION 13, TOWNSHIP 20 SOUTH, RANGE 59 EAST, M.D.M., AS SHOWN IN FILE 112, PAGE 94 OF PARCEL MAPS ON FILE AT THE CLARK COUNTY, NEVADA RECORDER'S OFFICE.

LEGEND

9" STREET NAME SIGN (0-3, 2 PER POLE)	400W HPS STREET LIGHT
STOP SIGN W/ POST (30)	TRAFFIC SIGNAL
TRAFFIC SIGN (AS INDICATED)	150W HPS STREET LIGHT
SIGHT VISIBILITY ZONE NO IMPROVEMENTS OVER 24" IN HEIGHT, EXCEPT TRAFFIC CONTROL DEVICES	#3 1/2 PULL BOX
REMOVE CONFLICTING STRIPING	150 AMP PAD MOUNT SERVICE PEDESTRAL
	1 1/4" CONDUIT
	2" CONDUIT

CIRCUIT NAME	SP1
CIRCUIT TYPE	STREET LIGHTING
VOLTAGE:	150 3/2/2
CIRCUIT CAPACITY:	60
MAXIMUM CONTINUOUS CURRENT DRAW IS 80% OF CIRCUIT CAPACITY:	48
EXISTING CIRCUIT LOAD AMPS =	0.0
PROPOSED CIRCUIT LOAD AMPS =	30
TOTAL PROPOSED LOAD AMPS =	30
EXISTING PLUS PROPOSED LOAD AMPS =	30
REMAINING AVAILABLE LOAD AMPS = MAXIMUM - EXISTING - PROPOSED =	18

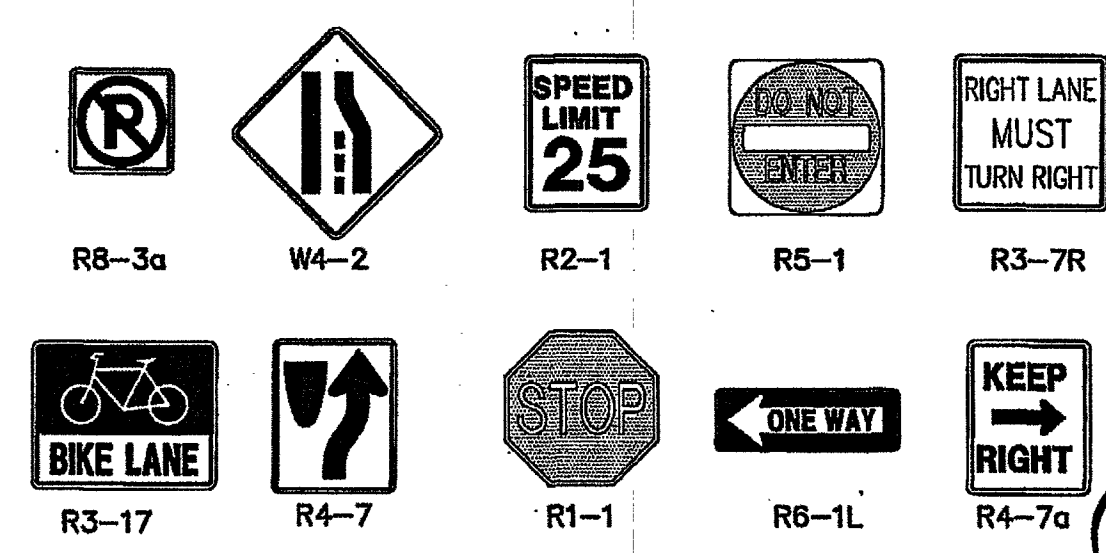

NOTE:
 INSTALL STREET NAME SIGNS AS PER CLV SUBDIVISION ORDINANCE 18.12.105 & 18.12.100;
 STREET NAME SIGNS FOR PRIVATE STREETS SHALL BEAR THE WORDS "PRIVATELY MAINTAINED" AND SHALL BE A COLOR AND DESIGN ESTABLISHED BY THE CITY AND IN CONFORMANCE WITH THE MANUAL OF UNIFORM TRAFFIC CONTROL DEVICES. THE COLOR OF SUCH A SIGN MUST DIFFER DISTINCTLY FROM THE USED IN CONNECTION WITH PUBLIC STREETS.
 COLOR FOR STREET NAME SIGNS SHALL BE WHITE LETTERS ON BROWN BACKGROUND.

NOTE:
 ALL STREET LIGHTS TO BE CITY OF LAS VEGAS STANDARD STREET LIGHTS.

NOTE:
 PRIVATE STREETS ARE P.U.E.S, CLV PUBLIC SEWER EASEMENTS AND PUBLIC DRAINAGE EASEMENT TO BE PRIVATELY MAINTAINED.

NOTE:
 FOR TRAFFIC SIGNAL UNDERGROUND DETAIL, SEE SHEETS T-3A AND T-3B.

Call before you Dig
 Avoid hitting underground utility lines. It's easy.

FAST
 Call before you UnderGround
 1-702-432-5800
 DIVISION OF INSPECTION

AVOID HITTING UNDERGROUND POWER LINES. IT'S EASY.
 CALL BEFORE YOU DO OVERHEAD
 1-702-227-2929

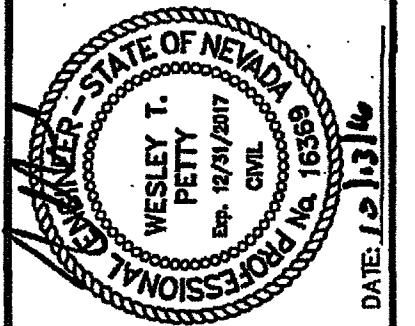

NO.	DATE	BY	DESCRIPTION
1	12/11/19	WTP	ISSUED FOR PERMIT
2	12/11/19	WTP	ISSUED FOR PERMIT
3	12/11/19	WTP	ISSUED FOR PERMIT
4	12/11/19	WTP	ISSUED FOR PERMIT
5	12/11/19	WTP	ISSUED FOR PERMIT
6	12/11/19	WTP	ISSUED FOR PERMIT
7	12/11/19	WTP	ISSUED FOR PERMIT
8	12/11/19	WTP	ISSUED FOR PERMIT
9	12/11/19	WTP	ISSUED FOR PERMIT
10	12/11/19	WTP	ISSUED FOR PERMIT
11	12/11/19	WTP	ISSUED FOR PERMIT
12	12/11/19	WTP	ISSUED FOR PERMIT
13	12/11/19	WTP	ISSUED FOR PERMIT
14	12/11/19	WTP	ISSUED FOR PERMIT
15	12/11/19	WTP	ISSUED FOR PERMIT
16	12/11/19	WTP	ISSUED FOR PERMIT
17	12/11/19	WTP	ISSUED FOR PERMIT
18	12/11/19	WTP	ISSUED FOR PERMIT
19	12/11/19	WTP	ISSUED FOR PERMIT
20	12/11/19	WTP	ISSUED FOR PERMIT

PROJECT NO.
784-204-013

DESIGNER: RN
 DRAWN: RN
 CHECKED: WTP

PLOT DATE: 10-12-19
 PLOT TIME: 11:12:20

1555 S. RAINBOW BLVD.
 LAS VEGAS, NV 89146
 T: 702.804.2000
 F: 702.804.2299
 gowengineering.com

GCW
 ENGINEERS & SURVEYORS

DESERT HOPE DRIVE - ACCESS ROAD - (N/R REVERENCE VILLAGE 26) REVERENCE PARKWAY

PULTE HOMES

STREET LIGHT, TRAFFIC AND SIGNAGE PLAN
 (REVERENCE PARKWAY)

DRAWING
T-2A
 21A OF 26 SHTS