

- MISCELLANEOUS CONSTRUCTION NOTES:**
- 1 ABANDON 21" SS PER SPECIFICATION SECTION 630 (800 LF THIS SHEET)
 - 2 ABANDON SSMH PER SPECIFICATION SECTION 630
N = 644838.96, E = 237808.08
N = 644833.27, E = 237983.52
 - 3 EXISTING 21" SS (PROTECT IN-PLACE DURING SS CONST. THEN TO BE ABANDONED ONCE RELIEF SEWER IS ACTIVE)
 - 4 EXISTING SSMH (PROTECT IN-PLACE DURING SS CONST. THEN TO BE ABANDONED ONCE RELIEF SEWER IS ACTIVE)
 - 5 REMOVE 7" OF 8" SS ACROSS SSMH
 - 6 ABANDON 8" SS PER SPECIFICATION SECTION 630 (30 LF)
 - 7 EXISTING POWER POLE (PROTECT IN-PLACE PER SPECIFICATION SECTION 650)
 - 8 EXISTING STREET LIGHT (PROTECT IN-PLACE)
 - 9 EXISTING CURB, GUTTER, AND SIDEWALK (PROTECT IN-PLACE OR REMOVE AND REPLACE AS NECESSARY FOR CONSTRUCTION AT NO ADDITIONAL COST TO THE OWNER)

SURVEY MONUMENTS*

CAP	NORTHING	EASTING	SHEET	LOCATION
(A)	646269.054	235982.787	D4	DURANGO
(B)	644890.462	236003.688	D4/SS2/SS3	DURANGO/CHEYENNE
(C)	644850.889	237356.533	SS4	SOARING GULLS/CHEYENNE
(D)	644822.546	238370.795	SS6	CHEYENNE
(E)	644813.051	238708.917	SS6	CHEYENNE
(F)	644793.793	239384.528	SS7	CHEYENNE
(G)	644784.194	239722.379	SS7	CHEYENNE
(H)	644774.532	240060.098	SS8	CIMARRON/CHEYENNE

*SEE CITY OF LAS VEGAS GENERAL NOTE #13 ON SHEET G3

- NOTES:**
1. CONTRACTOR SHALL VERIFY ALL HORIZONTAL AND VERTICAL LOCATIONS OF EXISTING FACILITIES BEING TIED INTO OR CROSSING PRIOR TO ANY WORK BEING DONE. CONTRACTOR SHALL COORDINATE ANY DISCREPANCIES WITH THE ENGINEER.
 2. LINEAR FOOTAGE (LF), SLOPES, AND INVERTS OF SANITARY SEWER PIPES AS SHOWN ON THE PLANS ARE CALCULATED HORIZONTALLY FROM CENTERLINE OF MANHOLE TO CENTERLINE OF MANHOLE.
 3. SEE PR1-PR4 & D3 SHEETS FOR PAVEMENT, CURB, GUTTER, SIDEWALK, MEDIAN AND LANDSCAPING REMOVAL/REPLACEMENT LIMITS
 4. ALL WATERLINES CROSSING TRENCH WIDTHS GREATER THAN 6 FT. SHALL HAVE A PIPE SUPPORT DETAIL SUBMITTED TO THE DISTRICT FOR APPROVAL PRIOR TO EXCAVATION.

APPROVED FOR CONSTRUCTION
[Signature]
 Las Vegas Valley Water District Engineering Services Manager
 Date: 2/12/14 Project No. 115833

FAST
 Call before you UnderGround
 1-702-432-5300
 FREEWAY AND ARTERIAL SYSTEM OF TRANSPORTATION

AVOID OVERHEAD POWER LINE CONTACT. IT'S COSTLY.
 Call before you Dig
 Call before you Overhead
 1-702-227-2929
 NV ENERGY ENVIRONMENT AND SAFETY SERVICES DEPARTMENT

Call before you Dig
 Call 811
 HANSEN #29930

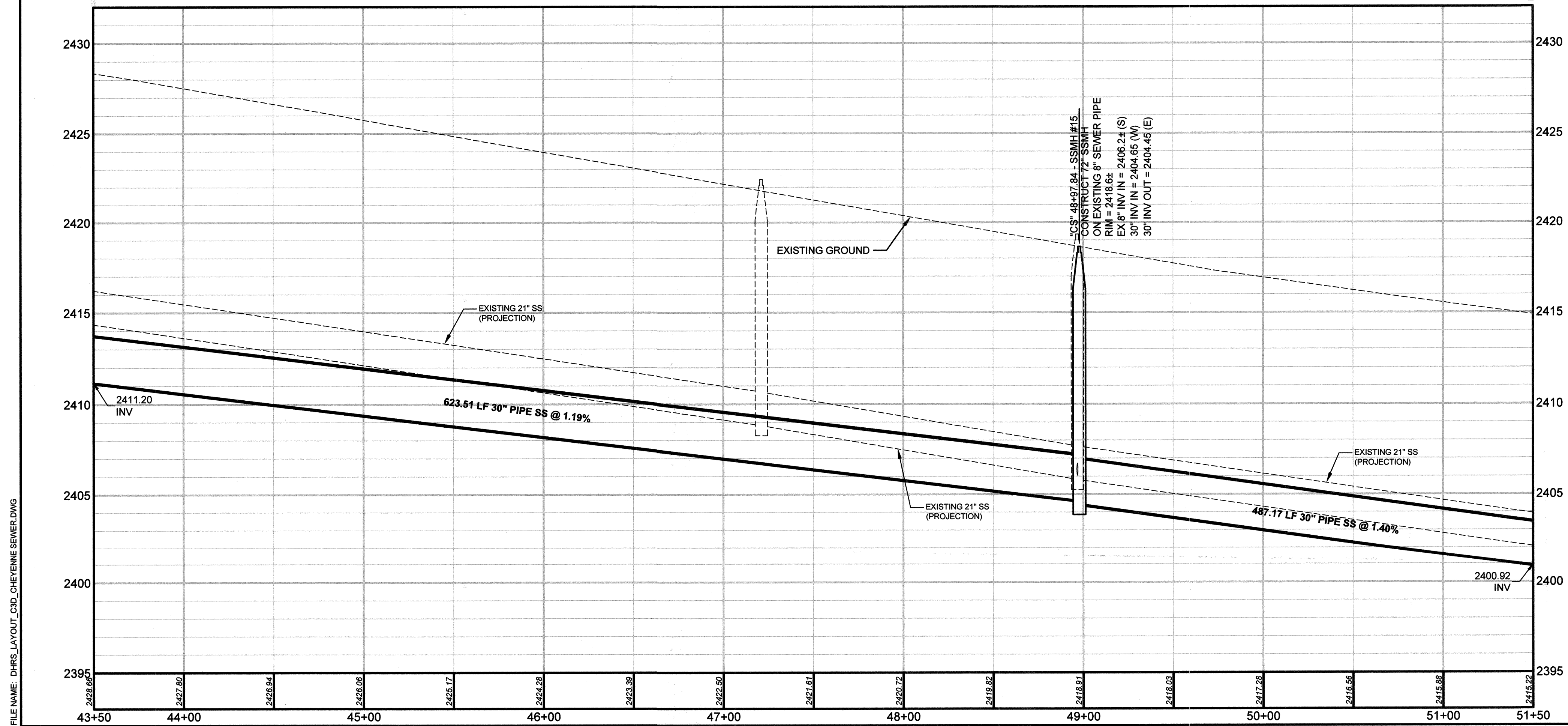

DEPARTMENT OF PUBLIC WORKS											
ENGINEERING DESIGN SECTION											
CITY ENGINEER : DAVID N. BOWERS, P.E. PROJECT MANAGER : GINA VENGLOSS, P.E.											
DURANGO HILLS RELIEF SEWER PROJECT											
CH2MHILL											
2488 VILLAGE VIEW DRIVE, SUITE 350, HENDERSON, NV 89074 PHONE 702-398-9175, CH2M HILL Project #240986											
SANITARY SEWER DESIGN PLAN AND PROFILE "CS" 43+50 TO "CS" 51+50											
Sheet SS5 9 of 35											
DATE April 2014 DWG NO. 307V1045											