

2/6/12 C:\P\WORKING\PROJECT\USE\REVIEWS\DOT15\CD1\B000.DWG

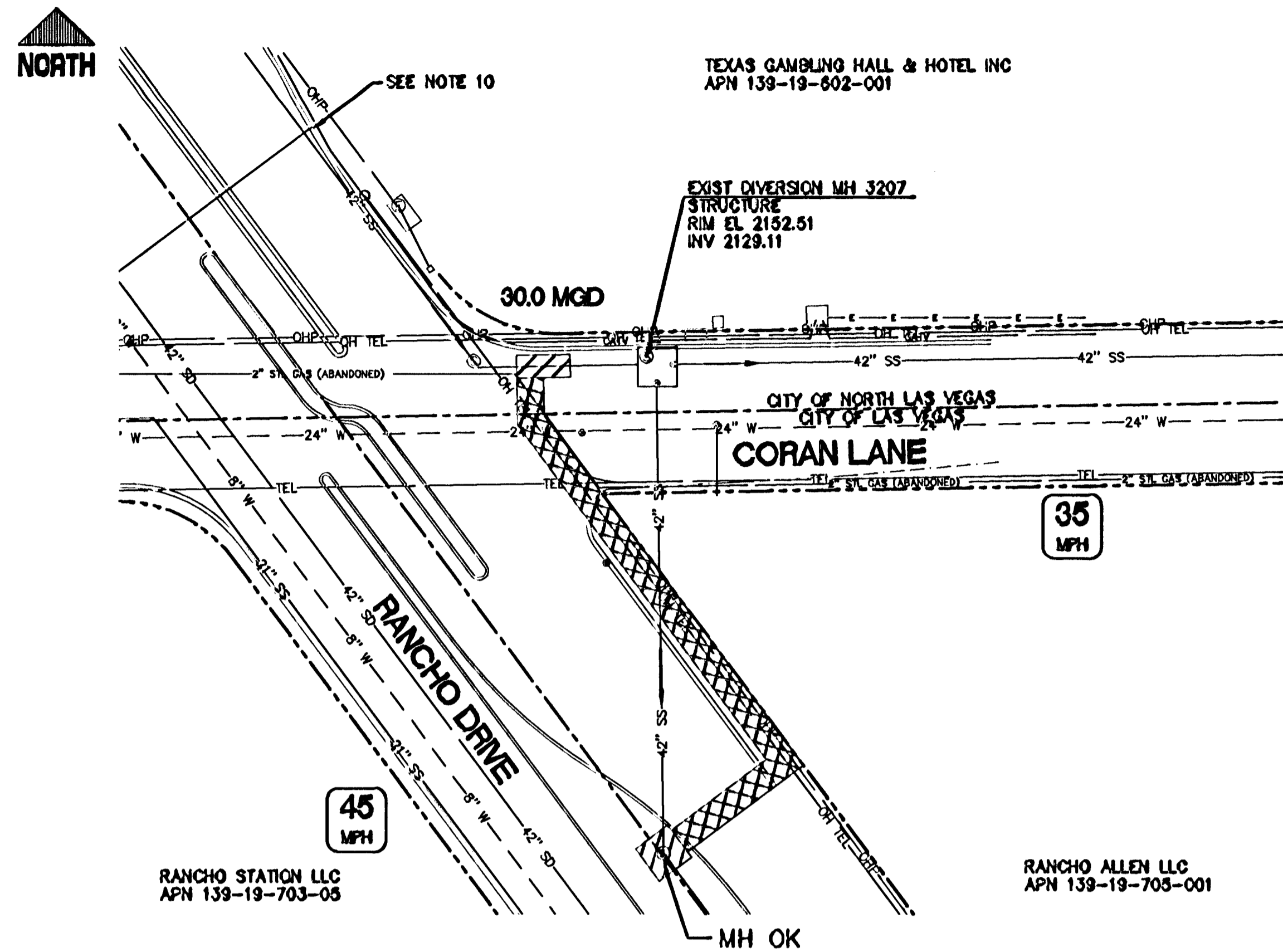

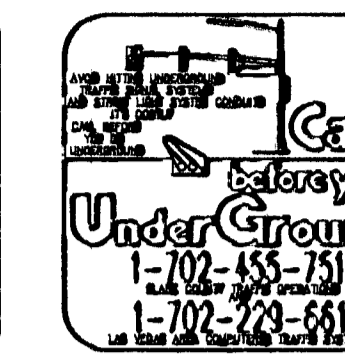



GRAPHIC SCALE
(IN FEET)
1 inch = 40 ft.

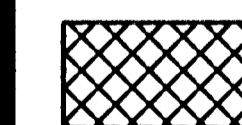

CONSTRUCTION BYPASS NOTES

1. THE CONTRACTOR SHALL BE RESPONSIBLE FOR THE SEWER BYPASS DESIGN FOR DEWATERING OF THE PIPE DURING REHABILITATION. THIS INCLUDES ALL PUMPING EQUIPMENT, PIPING AND FITTINGS, POWER, COLLECTION AND DISTRIBUTION ELEMENTS TO ACHIEVE THE BYPASSING OF THE EXISTING SEWAGE FROM INTAKE POINT TO DISCHARGE POINT.
2. THE CONTRACTOR SHALL PREPARE AND SUBMIT A TEMPORARY BYPASS PLAN (TBP) FOR THE BYPASS OPERATION (SEE SPECIAL PROVISIONS SECTION 695). THE CONTRACTOR MUST HAVE AN APPROVED TBP PRIOR TO ANY PIPE LINING.
3. THE CONTRACTOR SHALL BYPASS ALL MAINLINE AND LATERAL FLOWS. QUANTITY OF SEWAGE TO BE BYPASSED FROM POINT TO POINT SHALL BE THE SUM OF ALL THE FLOWS ENTERING THE PIPELINE BEFORE POINT OF DISCHARGE.
4. THE CONTRACTOR SHALL PREPARE AND SUBMIT A TRAFFIC CONTROL PLAN (TCP) TO THE CITY OF LAS VEGAS TRAFFIC ENGINEERING DIVISION, CLARK COUNTY PUBLIC WORKS, AND NDOT FOR THE WORK (SEE SPECIAL PROVISIONS SECTION 024). THE CONTRACTOR MUST HAVE AN APPROVED TCP PRIOR TO ANY CONSTRUCTION.
5. STANDARD DETAILS FOR TRENCH EXCAVATION, TRENCH PLATING, AND FINISHED ROAD CROSS SECTIONS ARE SHOWN IN DETAILS ON SHEET CD-1 AND CD-2. CHANGES TO THESE DETAILS WILL REQUIRE APPROVAL FROM THE CITY OF LAS VEGAS TRAFFIC ENGINEERING DIVISION.
6. REMOVE AND REINSTALL MANHOLE FRAME, COVER, GRADE RINGS, AND CONE PER SD-4 OF THE DESIGN CONSTRUCTION STANDARDS FOR WASTEWATER COLLECTION SYSTEMS (2009).
7. THE CONTRACTOR SHALL MAINTAIN DRIVEWAY ACCESS TO ALL ADJOINING PROPERTIES ACCESSIBLE TO THE PUBLIC AND EMERGENCY VEHICLES. DESIGNS FOR MAINTAINING ACCESS WILL BE PREPARED BY THE CONTRACTOR AND SUBMITTED TO THE CONTROLLING AGENCY FOR REVIEW AND APPROVAL. SEE DETAIL 2 / SHEET CD-1 FOR DRIVEWAY RAMP.
8. ALL BYPASS OPERATIONS ARE TO OCCUR WITHIN THE BYPASS CORRIDOR SHOWN ON THE BYPASS DRAWINGS. IF THE CONTRACTOR REQUIRES AN ADDITIONAL CLOSURE AREA THEY MUST OBTAIN ADDITIONAL APPROVAL FROM THE CITY OF LAS VEGAS TRAFFIC ENGINEERING DIVISION.
9. THE CONTRACTOR SHALL BE RESPONSIBLE FOR ESTABLISHING STAGING AREAS FOR THEIR WORK.
10. CONTRACTOR SHALL MAINTAIN STORM FLOW TO EXISTING DROP INLETS. DESIGNS FOR MAINTAINING FLOW WILL BE PREPARED BY THE CONTRACTOR AND INCLUDED IN THE TEMPORARY BYPASS PLAN (TBP).
11. BYPASS PIPING THROUGH SIGNALIZED AND/OR MAJOR INTERSECTIONS SHALL BE INSTALLED USING CUT AND COVER METHODS AS SHOWN ON SHEET CD-1.

LEGEND

-  BYPASS CORRIDOR
-  SUCTION/DISCHARGE PIT AND PUMP STAGING AREA
-  POSTED SPEED LIMIT
-  25 MGD PROJECTED PEAK FLOW



| REVISIONS | NO. | DATE | DESCRIPTION | APP'D |
|-----------|-----|------|-------------|-------|
| | | | | |
| | | | | |
| | | | | |

**DEPARTMENT OF PUBLIC WORKS
CAPITAL PROJECT MANAGEMENT**

CITY ENGINEER: CHERI L. EDWARDS, P.E.
PROGRAM MANAGER: TIM PARKS, PE

DESIGNED BY: GAG
DRAWN BY: PAT
CHECKED BY: IT

DATE: NOVEMBER 2010

**DOWNTOWN INTERCEPTOR
SEWER REHABILITATION**

**RANCHO DRIVE
BYPASS PLAN**

TITLE: _____
SHEET: _____

** ORIGINAL STAMPED BY GREG A. GOULD 11/8/10 15499 **

Sheet **B-9**
30 of 34
DRAWING NO. 307V1050