

MEDIAN STRIP - BACK CURB DATA				
CURVE NO.	Δ	R	T	L
1	12°50'19"	200	22.50	44.82
2	12°50'19"	200	22.50	44.82
3	24°50'00"	150	33.03	65.01
4	12°34'15"	150	16.52	32.91
5	142°35'45"	4	-	9.96

NOTE:
CUT TO BE EVENLY SLOPED FROM SHOULDER TO A POINT 70' WEST OF $\frac{1}{2}$ BETWEEN ELDORA & SAHARA

Construct Asphaltic Concrete Pavement
See Typical Cross Section - Sheet No. 2

(FUTURE)
B.C.R. = 60.00'
Δ = 91°00'02"
T = 61.06'
L = 95.30'

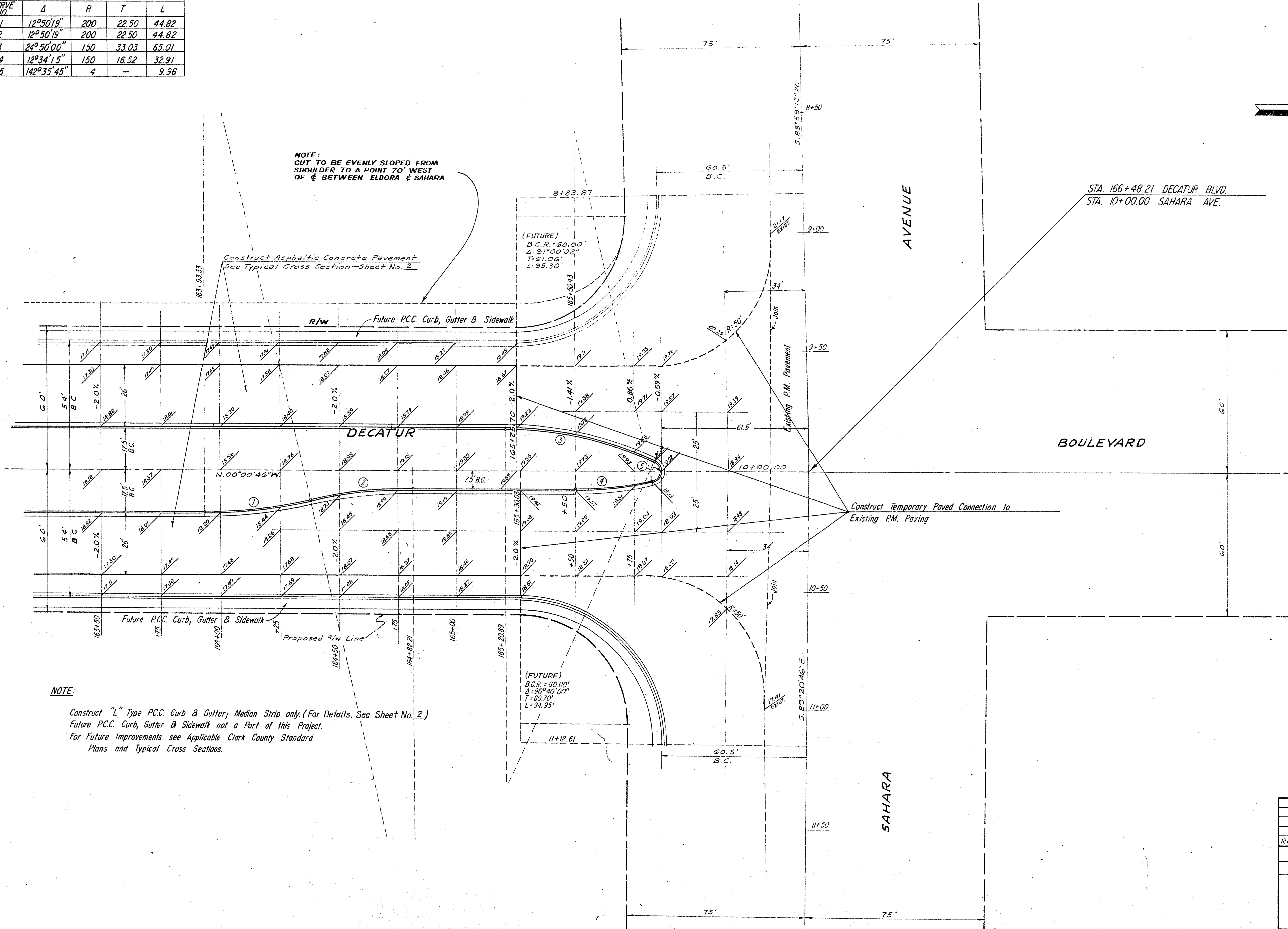

NOTE:

Construct "L" Type P.C.C. Curb & Gutter; Median Strip only. (For Details, See Sheet No. 2.)
Future P.C.C. Curb, Gutter & Sidewalk not a Part of this Project.
For Future Improvements see Applicable Clark County Standard Plans and Typical Cross Sections.

REV. NO.	DATE	REVISION	APPROVED
CLARK COUNTY NEVADA COUNTY ENGINEERING DEPARTMENT			
DECATUR BLVD. SPRING MOUNTAIN ROAD TO SAHARA AVE. CONSTRUCTION DETAILS STA. 163+50 TO SAHARA			
DESIGN: G.A.G.	APPROVED	DATE	SCALE: 1" = 20'
DRAWN: E.E.	CHECKED: J.B.	COUNTY ENGINEER	SHEET 15 of 16
RECOMM:			DWG. NO. L-629

20-4-107

107-V879