

FOR ACCESS ROAD
SEE SHEET G-4

| CURVE TABLE | | | | |
|-------------|-----------|--------|--------|---------|
| CURVE | DELTA | RADIUS | LENGTH | TANGENT |
| C1 | 65°00'12" | 300.00 | 340.36 | 191.13 |
| C2 | 50°46'40" | 360.00 | 319.05 | 170.85 |
| C3 | 57°20'02" | 330.00 | 330.22 | 180.42 |
| C4 | 73°01'26" | 210.00 | 267.65 | 155.46 |
| C5 | 41°51'00" | 336.00 | 245.42 | 128.47 |
| C6 | 72°12'15" | 56.00 | 70.57 | 40.84 |

| LINE TABLE | | |
|------------|--------|-------------|
| LINE | LENGTH | BEARING |
| L1 | 21.43' | S14°35'36"W |

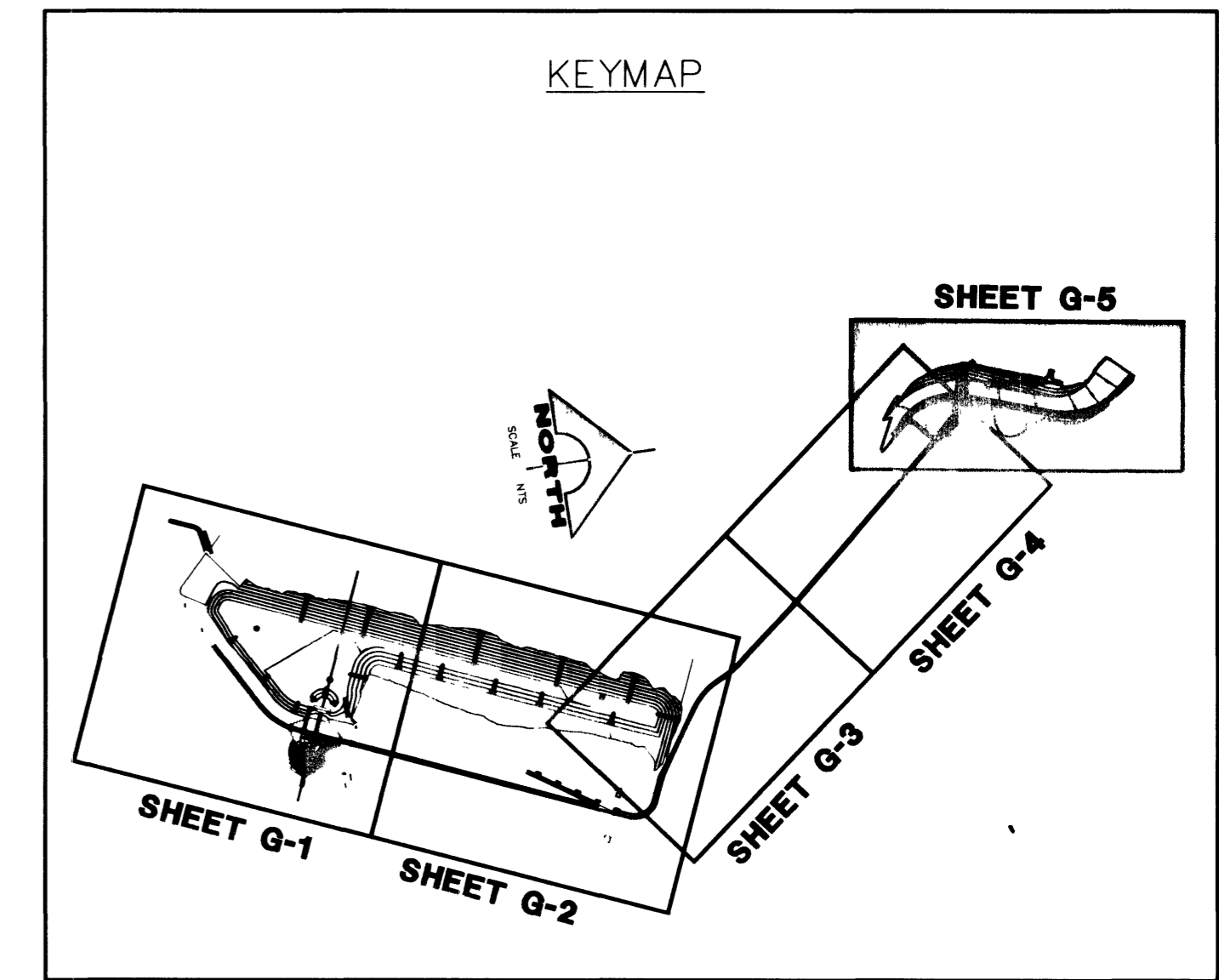
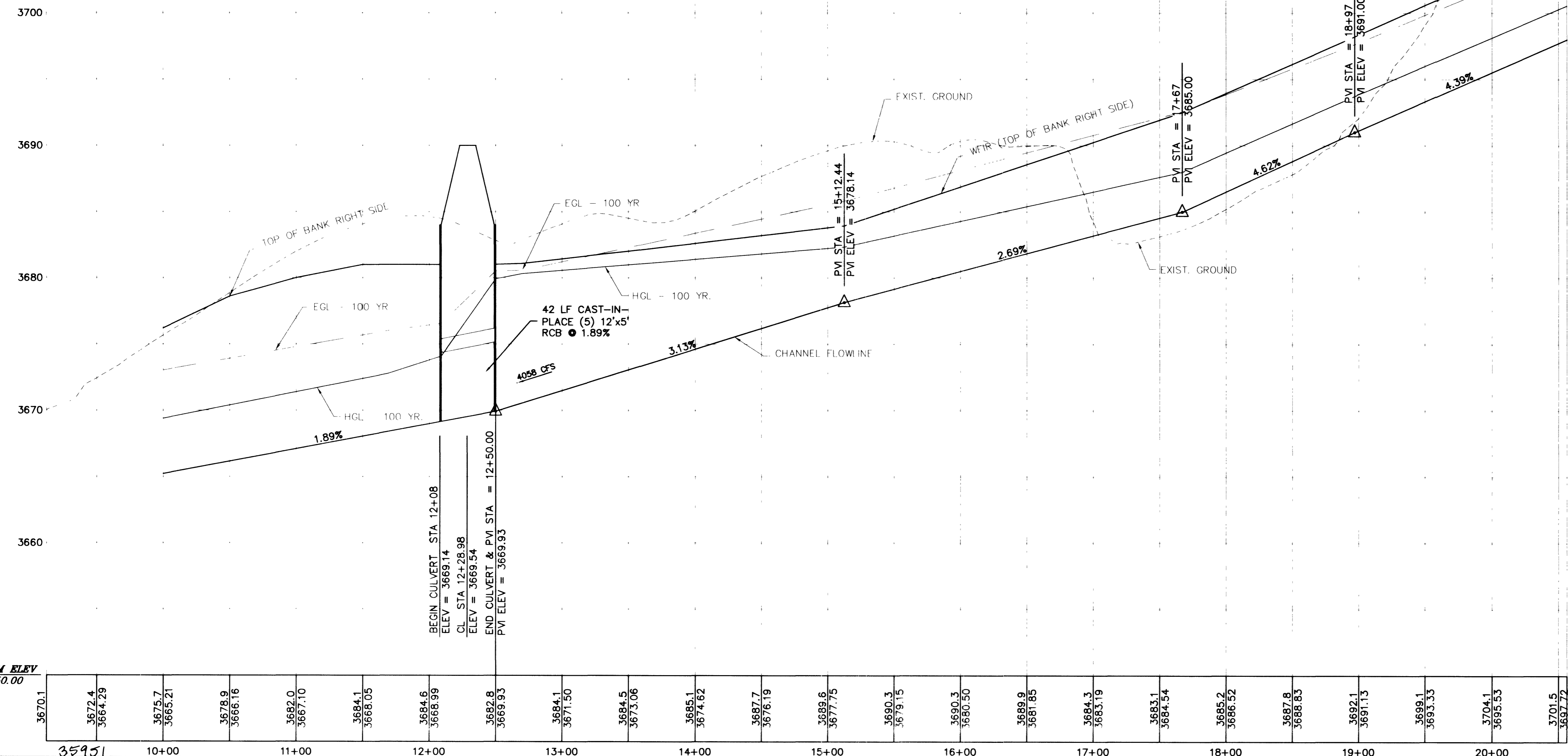

PROFILE VIEW
HORZ.: 1"=50'
VERT.: 1"=5'



| BENCHMARK | | | |
|-----------|----------|---------------|---------------|
| ID # | DESC. | NAVD 88 DATUM | NAVD 88 DATUM |
| 3209.81 | 978.3511 | (FEET) | (METERS) |

NOTE: THIS SET OF DRAWINGS IS BASED UPON NAVD 88 DATUM. PREVIOUS DRAWINGS MAY BE BASED ON SUMNERLIN DATUM AND CARE SHOULD BE OBSERVED WHEN UTILIZING THIS SET OF DRAWINGS.

BASIS OF BEARINGS
NORTH 89°54'38" EAST, BEING THE SOUTH LINE OF THE SOUTHEAST QUARTER (SE 1/4) OF SECTION 35, TOWNSHIP 20 SOUTH, RANGE 59 EAST, M.D.M. AS SHOWN BY MAP THEREOF ON FILE IN FILE 87, PAGE 73 OF SURVEYS IN THE CLARK COUNTY RECORDER'S OFFICE, CLARK COUNTY, NEVADA.

DATUM ELEV
3650.00

Call before you Dig.
1-800-227-2600
UNDERGROUND SERVICE ALERT (USA)

RESION: AF/LAG
DRAWN: LAG
CHECK: AF
ISSUE DATE:
ISSUE EDITOR:
PLOT DATE: 05-23-01
PLOT TIME: 14:28:15

1996 ACQUISITION MAPS & 24" RCP

100% COMPLETE

ISSUE DATE:

THE HOWARD HUGHES CORPORATION
DETENTION BASIN NO. 5 EXPANSION AND DIVERSION BERM
GRADING PLAN / PLAN AND PROFILE
DIVERSION BERM

G.C. WALLACE, INC.
Engineering/Architecture
1555 SOUTH RAINBOW BLVD., LAS VEGAS, NEVADA, 89146
TELEPHONE: (702) 804-2000 • FAX: (702) 804-2299
C-82052-1001-0001-0005-0005-0005

SHEET
G-5
10 OF 24 SHEETS