

Avoid cutting underground utility lines. It's costly.

Call before you Dig

1-800-227-2600

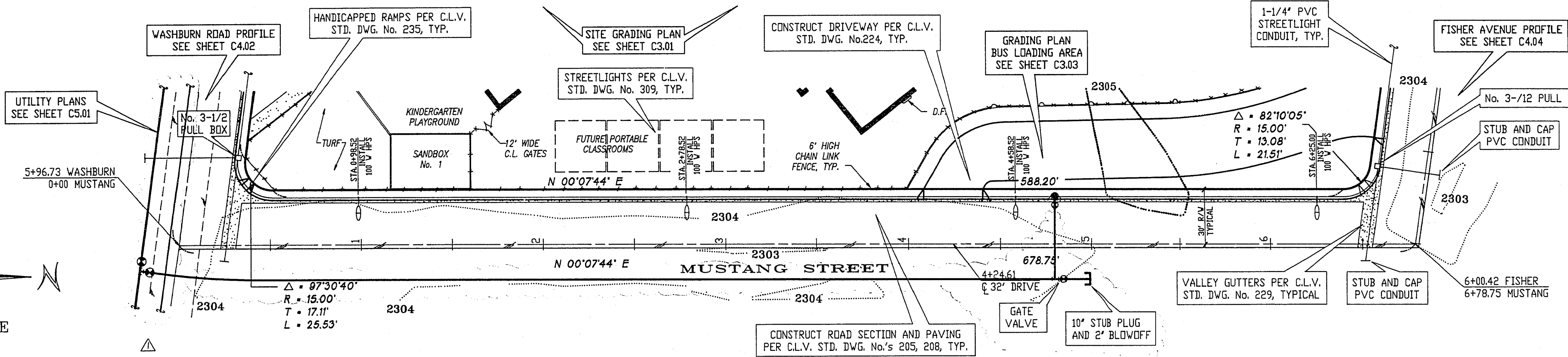
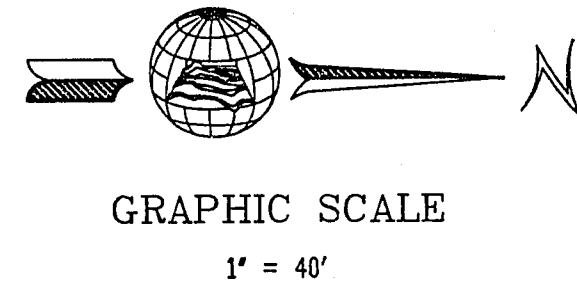

PLAN -- MUSTANG STREET  
Horiz. 1"=40'

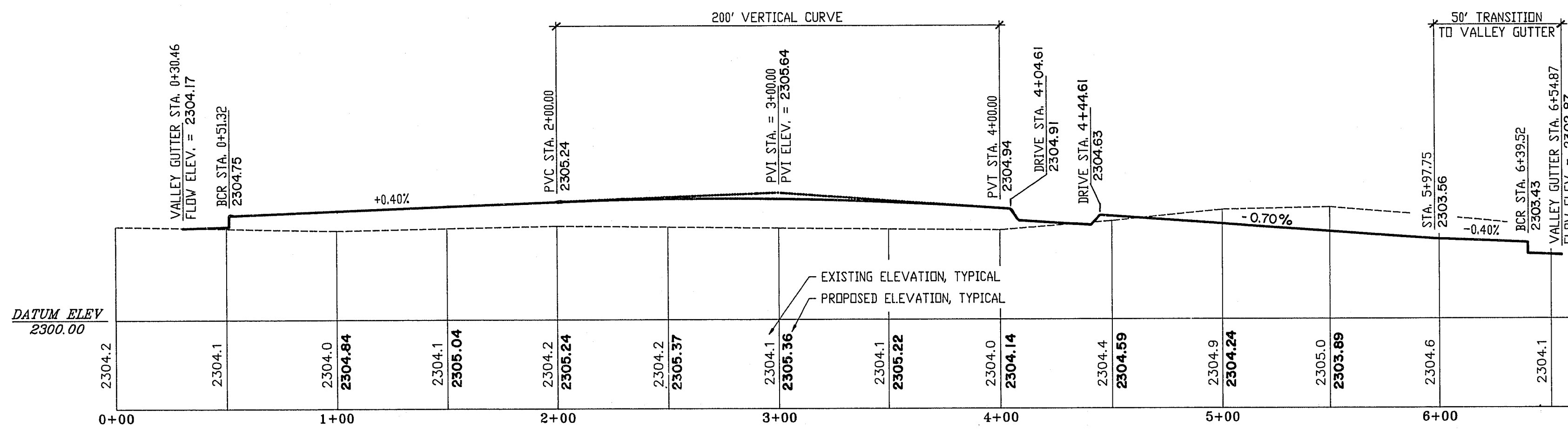

WEST CURB PROFILE -- MUSTANG STREET  
Horiz. 1"=40'  
Vert. 1"=4'

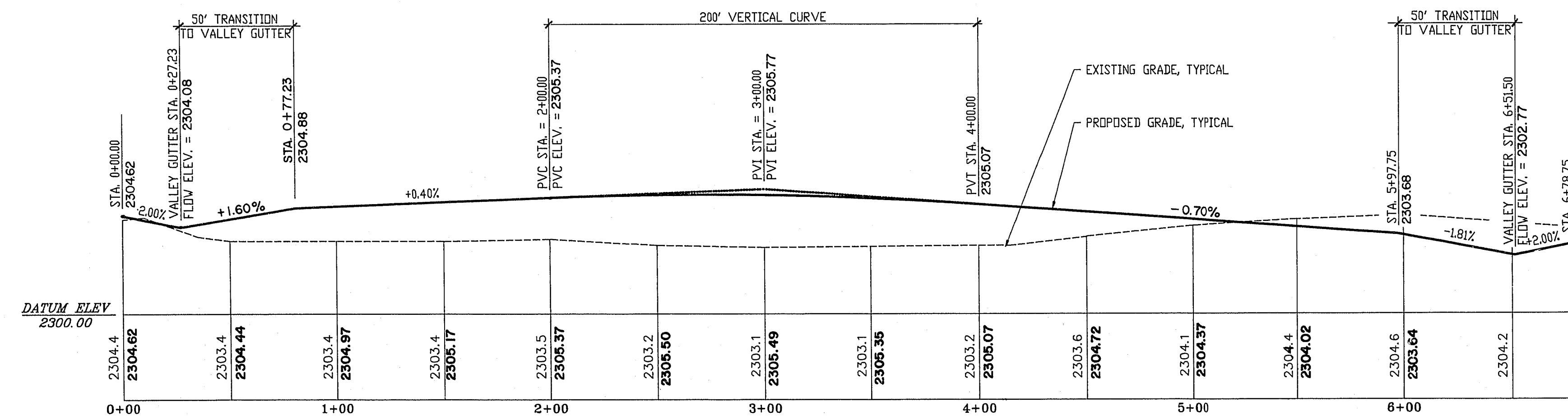

NOTE: TO EQUATE ELEVATIONS TO DESERT DREAM ESTATES BY E.J. WOJCIK ENGINEERING ADD .59' TO ALL ELEVATIONS.

CENTERLINE PROFILE -- MUSTANG STREET  
Horiz. 1"=40'  
Vert. 1"=4'

BENCHMARK  
ELEVATION = 2258.894  
SET DRIVE RIVET IN A 2"x2" ALUMINUM PLATE, IN THE TOP OF THE SOUTHWEST PORTION OF A GAS COMPANY VAULT, LOCATED AT THE NORTHEAST CORNER OF THE INTERSECTION OF CRAIG ROAD AND JONES BOULEVARD, 8.5 FEET SOUTHWEST OF POWER POLE No. SNT. CO 3322.

QUANTITIES (this sheet)

Table listing quantities for 3' A.C. PAVEMENT, TYPE I AGGREGATE BASE, TYPE II AGGREGATE BASE, 100V H.P.S. STREETLIGHTS, 1" TYPE CURB AND GUTTER, COMMERCIAL DRIVEWAY (C), 1-1/4" PVC CONDUIT, No. 3-1/2" PULL BOX, and 5' WIDE SIDEWALK.

STREET LIGHT NOTE:

ALL HAND HOLE COVERS MUST BE INSTALLED, POLE CAPS POURED, AND PULL BOX LIDS BOLTED DOWN PRIOR TO ENERGIZING CIRCUIT. ALL WIRE MUST HAVE THW INSULATION.

Signature of George A. Jacoby, dated 10-15-90, Las Vegas Valley Water District.

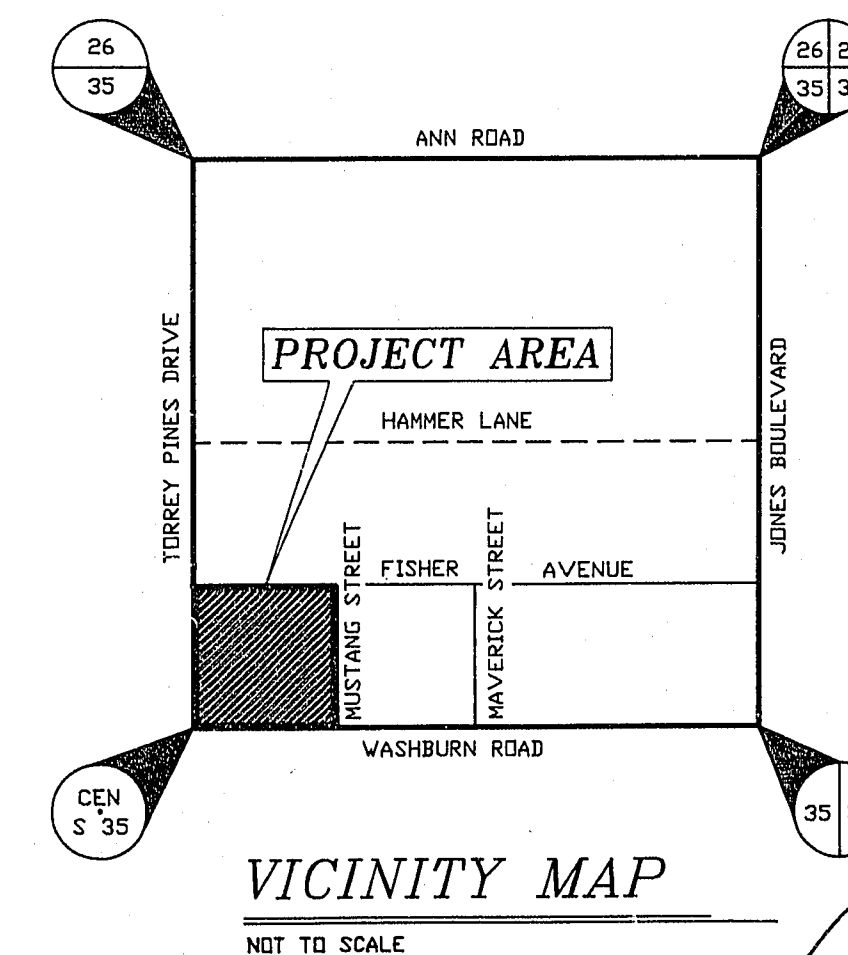

Project information including title 'ERNEST J. MAY ELEMENTARY SCHOOL', drawing number '2084.03', scale 'AS SHOWN', and a table of revisions.

Prepared in the office of Church Engineering, Inc. Consulting Engineers Planners Surveyors

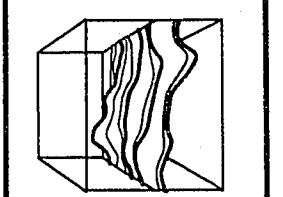

Job Number 7108.208, Sheet Number CA.03, Date 7-06-90.