

MATCHLINE - SEE SHEET C5.01 FOR CONTINUATION

NOTE: A LIMITED FIRE FLOW OF 2000 GPM WILL BE AVAILABLE TO THIS SITE WHEN THE FOLLOWING PROJECTS ARE WITHIN 30 DAYS OF BEING OPERATIONAL: 1. CONT. 1060 (JONES 2538 ZONE PIPELINE PHASE 2.) 2. PROJECT #25082 (IRON MOUNTAIN RANCH HORSE/THOM/DECATUR WATER LINE.) 3. PROJECT #25879 (IRON MOUNTAIN RANCH HORSE/THOM/DECATUR INFRASTRUCTURE.) THE REQUIRED 3000 GPM FIRE FLOW WILL BE AVAILABLE WHEN CONTRACT 1028 (JONES 2538 ZONE PIPELINE PHASE 1) IS OPERATIONAL.

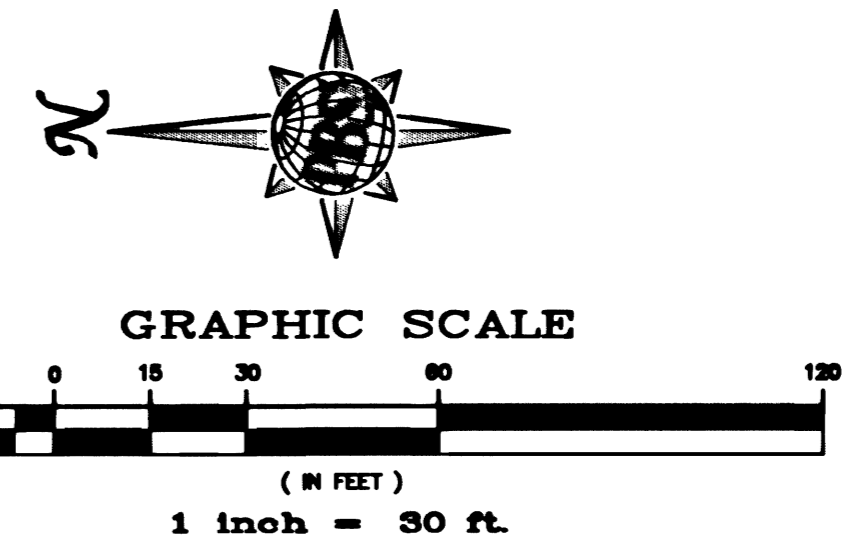

GENERAL UTILITY CONSTRUCTION NOTES

- 1. WATER LINES TO HAVE THRUST BLOCKS CONSTRUCTED PER UDACS PLATE NO. 5
2. NET TAPS TO BE CONSTRUCTED IN CONFORMANCE WITH UDACS PLATE NO. 22
3. TRENCH BACKFILL FOR WATER LINES TO BE CONSTRUCTED PER UDACS PLATE NO. 6A, 6B & 6C WHERE APPLICABLE
4. TRENCH BACKFILL FOR SEWER LINES TO BE CONSTRUCTED PER D.C.S.W.C.S. 30-16, SD-16A & SD-16B WHERE APPLICABLE
5. CONTRACTOR TO LOCATE AND VERIFY SIZE, LINE TYPE, CONDITION, DEPTH, PRESSURE, AND LOCATION OF ALL EXISTING UTILITY LINES WITHIN THE CONSTRUCTION AREA PRIOR TO CONSTRUCTION. THE CIVIL ENGINEER SHALL BE CONTACTED ONCE THE UTILITY LINE IS LOCATED.
6. THESE DRAWINGS MAY NOT INDICATE ALL EXISTING BURIED UTILITY LINES. CONTRACTOR IS TO EXERCISE GREAT CARE DURING EXCAVATION IN ORDER TO AVOID MAKING CONTACT WITH ANY EXISTING UTILITY LINES. IF UTILITY LINES ARE DAMAGED BY THE CONTRACTOR, SUCH DAMAGE SHALL BE REPLACED TO THE SATISFACTION OF THE OWNER AT THE CONTRACTOR'S EXPENSE.
7. CONTRACTOR TO SAWCUT AND REMOVE EXISTING ASPHALT AND CONCRETE AS NECESSARY FOR UTILITY TRENCHES, BACKFILL AND PATCH ALL TRENCHES AS INDICATED IN DETAILS AND/OR ACCORDING TO THE GOVERNING ENTITY, (CITY OF LAS VEGAS)
8. INSTALLATION OF ALL UTILITY LINES SHALL BE COORDINATED WITH THE CLARK COUNTY SCHOOL DISTRICT.
9. CONTRACTOR/OWNER TO OBTAIN A C.L.V. OFF-SITE IMPROVEMENT PERMIT FOR ALL WORK WITHIN PUBLIC RIGHT-OF-WAY.
10. ALL DIMENSIONS TO UTILITIES ARE TO CENTERLINE OF PIPE UNLESS INDICATED OTHERWISE
11. ONLY SEWER LINES AND LATERALS MAY BE INSTALLED IN TRENCHES EXCAVATED FOR SEWER LINES, SEE DCSWCS 2.2.15 (TYP.)
12. WATER AND SEWER SEPARATION OF TRENCHES MUST BE AT LEAST 10' MIN. (TYP.). SEE DCSWCS 2.2.21 "A1", DDACS 2.19.01 "A"
13. ALL WATER FACILITIES CONSTRUCTION SHALL BE IN ACCORDANCE WITH THE "UNIFORM CONSTRUCTION STANDARDS FOR WATER DISTRIBUTION SYSTEMS" (UDACS), LATEST EDITION.
14. WATER AND SEWER SERVICE LATERALS SHALL BE A MINIMUM OF FORTY-EIGHT (48) INCHES APART IN SEPARATE TRENCHES. WATER LATERALS SHALL BE A MINIMUM OF TWELVE (12) INCHES ABOVE THE SEWER LATERAL (REF. UNIFORM PLUMBING CODE).

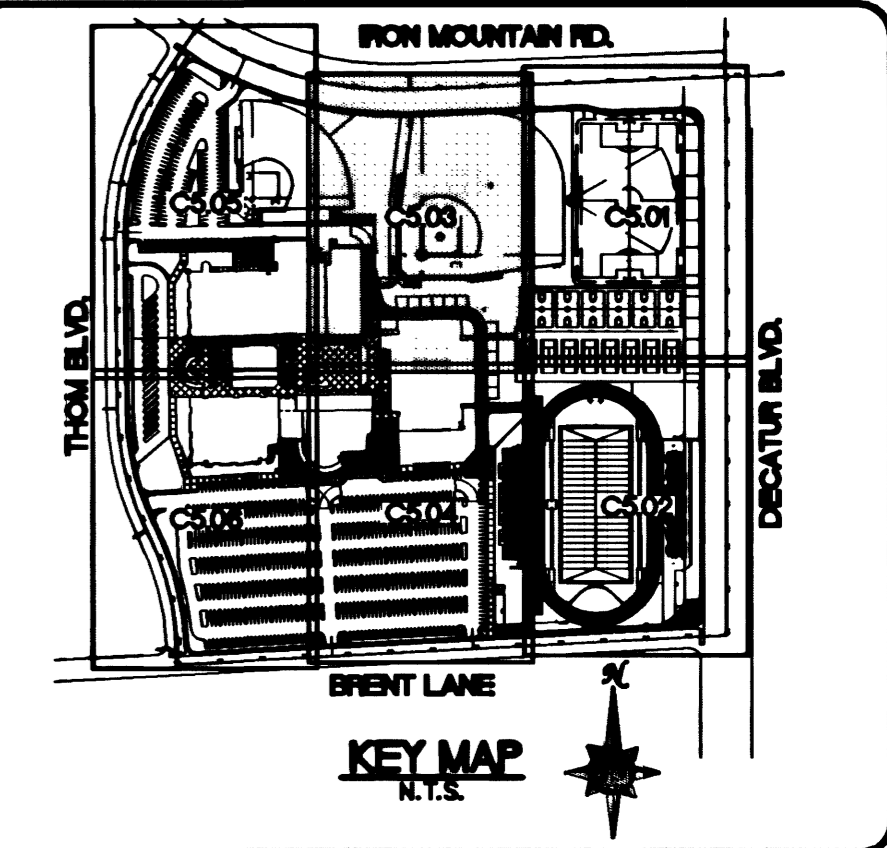

Call before you DIG 1-800-277-2800
Call before you OVERHEAD 1-702-583-6111

Professional Engineer Seal for Clark County, Nevada, License No. 98018, dated 11/21/12.

PBS ARCHITECTS logo and contact information.

CLARK COUNTY SCHOOL DISTRICT
CONSTRUCTION MANAGEMENT DEPARTMENT
4828 S. PEARL STREET 790-7600 LAS VEGAS, NEVADA 89121
DECATUR / IRON MOUNTAIN HIGH SCHOOL
CITY OF LAS VEGAS
ON-SITE UTILITY PLAN

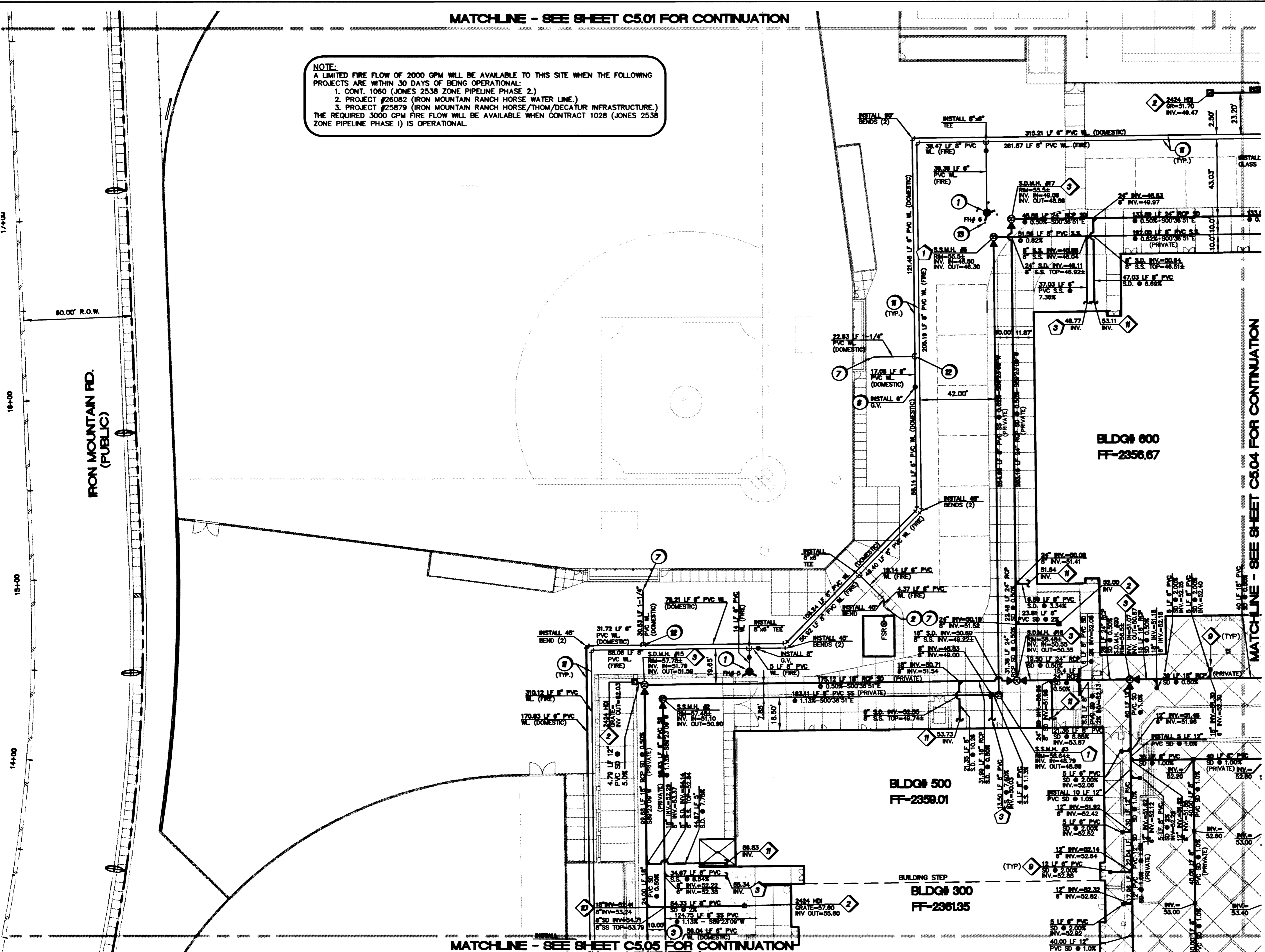

- WATER NOTES
1. INSTALL 6" FIRE HYDRANT ASSEMBLY (INCLUDES 8"x8" TEE AND 6" GATE VALVE) PER U.D.A.C.S. PLATE NO. 7 & 8
2. SEE FIRE SAFETY CONTRACTOR NOTE ON THIS SHEET
3. PROVIDE A MINIMUM OF 18" CLEARANCE BETWEEN WATER AND SEWER OR STORM DRAIN LINES WITH SEWER OR STORM DRAIN LINES BEING BELOW WATER LINES.
4. 4" TURBO METER AND VAULT, PER U.D.A.C.S. PLATE 18A AND C-475.
5. DIP WATERLINE BELOW SEWER/STORM DRAIN PER DETAIL "D" ON SHEET C6.01
6. INSTALL 8" DOUBLE CHECK DETECTOR ASSEMBLY ABOVE FG. PER U.D.A.C.S. PLATE NO. 20B. VALVES TO BE OS&Y TYPE.
7. REFER TO MECHANICAL/PLUMBING PLANS FOR LOCATION AND ADDITIONAL INFORMATION.
8. INSTALL GATE VALVE PER UDACS PLATE NO. 8
9. REFER TO LANDSCAPE PLANS FOR CONTINUATION.
10. INSTALL A 4" RPPA PER U.D.A.C.S. PLATE NO. 11B.
11. CONTRACTOR TO PROVIDE A MINIMUM OF 3.5" OF COVER ABOVE TOP OF PIPE, BASED ON FINISH GRADE.
12. INSTALL 1-1/4" SERVICE SADDLE W/ CORP. STOP.
13. INSTALL BOLLARDS (4 TOTAL) PER DETAIL "S" ON SHEET C6.02

- STORM DRAIN NOTES
1. CONSTRUCT 48" TYPE 1 MANHOLE PER CCAUSD NO. 403. ALL ON-SITE MANHOLE COVERS TO BE PAINTED GRAY.
2. INSTALL JENSEN PRECAST 2424 HDI DROP INLET W/ PEDESTRIAN GRATE PER DETAIL "P" ON SHEET C6.02 OR EQUIVALENT.
3. CONSTRUCT 60" TYPE 1 MANHOLE PER CCAUSD NO. 403. ALL ON-SITE MANHOLE COVERS TO BE PAINTED GRAY.
4. INSTALL WATER QUALITY PIPE (C900) MEETING OR EXCEEDING ASTM STANDARD D2985-04
5. INSTALL JENSEN PRECAST 4848 HDI DROP INLET W/ PEDESTRIAN GRATE PER DETAIL "Q" ON SHEET C6.02 OR EQUIVALENT.
6. CONSTRUCT STORM DRAIN OUTLET AT WALL PER DETAIL "L" ON SHEET C6.02.
7. CONSTRUCT STORM DRAIN OUTLET AT WALL PER DETAIL "V" ON SHEET C6.03.
8. CONSTRUCT 3" CONCRETE VALLEY GUTTER W/ DRAIN PER DETAIL "E" ON SHEET C6.01.
9. INSTALL FLOOR DRAIN PER DETAIL "F" ON SHEET C6.02.
10. CONSTRUCT DEEP LATERAL CONNECTION PER DCSWCS DWG. NO. SD-18
11. REFER TO MECHANICAL/PLUMBING PLANS FOR LOCATION AND ADDITIONAL INFO.

- SANITARY SEWER NOTES
1. CONSTRUCT STANDARD ECCENTRIC MANHOLE (48") PER D.C.S.W.C.S. DRAWING NO. SD-1. ALL ON-SITE MANHOLE COVERS TO BE PAINTED GRAY.
2. INSTALL WATER QUALITY PIPE (C900)
3. REFER TO MECHANICAL/PLUMBING PLANS FOR LOCATION AND ADDITIONAL INFORMATION.
4. CONSTRUCT DEEP LATERAL CONNECTION PER DCSWCS DWG NO. SD-18
NOTE: ALL ON-SITE STORM-DRAIN AND SANITARY SEWER IS PRIVATELY OWNED AND MAINTAINED

Tables for Storm Drain N/E Location, Fire Hydrant N/E Location, and Sanitary Sewer N/E Location with columns for SMH#, North (Y), and East (X) coordinates.

INSTALLATION OF METER AND VAULT - (1-4" TURBINE)
THE METER(S) AND VAULT(S) WITH NON-TRAFFIC BEARING COVER(S) SHALL BE INSTALLED IN ACCORDANCE WITH THE UDACS PLATE NO. 18A AND WITH STANDARD VAULT DRAWING C-475, LATEST REVISION.
INSTALLATION OF DOUBLE CHECK DETECTOR ASSEMBLY - (2-6")
THE DOUBLE CHECK DETECTOR ASSEMBLIES SHALL BE INSTALLED IN ACCORDANCE WITH THE UDACS PLATE 20B.
REDUCED PRESSURE PRINCIPLE ASSEMBLY - (2-2") (1-4")
APPROVED REDUCED PRESSURE PRINCIPLE ASSEMBLY(S) SHALL BE INSTALLED PER THE U.D.A.C.S. PLATE NO. 11A & 11B. NO WATER SHALL BE TAKEN FROM SERVICE REQUIRING BACKFLOW PREVENTION UNTIL THE REDUCED PRESSURE PRINCIPLE ASSEMBLY HAS BEEN SUCCESSFULLY TESTED BY THE L.V.V.W.D.

APPROVALS
LAS VEGAS FIRE DEPARTMENT
FIRE FLOW IS: 3000 GPM AT 20 PSI RESIDUAL PRESSURE
BASED ON: TYPE II - 1 HR. BLDG. CONSTRUCTION
SQUARE FOOTAGE: SEE SHEET C5.07
AREA BETWEEN 4-HR SEPARATION WALLS: NONE
BUILDING HEIGHT: 46'-6" TO PARAPET
NUMBER OF STORIES: SEE SHEET C5.07
OCCUPANCY: E-1 UNLESS SPECIFIED DIFFERENTLY ON THIS SHEET.
FULL AUTOMATIC FIRE SYSTEM: YES

BASIS OF BEARINGS: NORTH 02°20'31" WEST, BEING THE WEST LINE OF THE SOUTHWEST QUARTER (SW1/4) OF SECTION 12, TOWNSHIP 19 SOUTH, RANGE 60 EAST, M.D.M., CLARK COUNTY, NEVADA AS SHOWN ON THE MAP IN FILE 73 OF SURVEY, PAGE 14 OFFICIAL RECORDS, CLARK COUNTY.

BENCHMARK: CITY OF LAS VEGAS BENCHMARK No. 11V90 11E4 BLM BRASS CAP, 2" ABOVE GROUND, JONES BOULEVARD AND HORSE DRIVE. REVISION DATE: 5/7/93 ELEV = 722.9994 m/2372.04 FEET (NAVD88)

12/13/13.dwg RRB 08/15/02 18:17:37